

1:10 Electric 4WD Climbing car



Caution: This model is not a toy, it is designed for user over 14 years of age.

Please use this instruction and the R/C system instruction at the same time.

The instruction is suitable for a type of model whose number is 104019

Safety and caution	1-2
Troubleshooting • Product introduction	2-3
Instruction of common tools and installation the electronic part...	4-5
Practice and maintenance.....	5-7
Assemble exploded view	8-17
Fittings view	18-23

Safety and Cautions

- *Never run the model on public roads or streets, as it could endanger traffic.
- *Never run the model in crowded areas, near or toward people or animals, to prevent property damage and/or personal injury.
- *Never run the model near rivers, ponds or lakes as to prevent R/C car from dropping into the water.
- *Make sure that no one else is using the same frequency as yours in your running area. Using the same frequency at the same time, whether it is driving, flying or sailing, can cause loss of control with R/C model, resulting in serious accidents.
- *To avoid a runaway R/C model or loss of control, always follow the procedure below:
 1. Fully extend transmitter antenna.
 2. Switch on transmitter.
 3. Switch on R/C model.
- *Follow reverse procedure to shut down.
- *Never touch or hinder rotating tire.
- *Never run R/C model in the rain or let run over puddles, as water may cause trouble with R/C model.
- *Motor and battery get very hot after running. Take care when handle them.
- *Retract transmitter antenna when not in use.
- *Remove the batteries from model and transmitter when they are not in use.

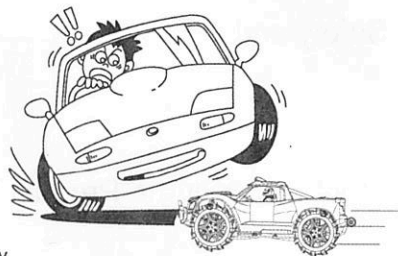

Cautions when handling batteries

- *Do not dismantle the battery or charger and do not cut any battery cables. This may cause short-circuit and/or damage to the product.
- *Change battery with compatible charger following proper procedure that is called out in the instructions. Do not modify charger or charge battery in improper way.
- *Do not recharge battery that is still warm from use as it may damage the battery. Allow the battery to cool off prior to recharging.
- *Make sure to disconnect charger cables from R/C model and electric outlet when not in use.
- *Remove transmitter battery when not using it for a long time as it may leak and damage transmitter when left for a long period.
- *Never incinerate used batteries, as they can explode causing serious accidents.



Safety precautions

Do not operate the model on public roads, in crowded places or near infants, it may cause accidents or injury.

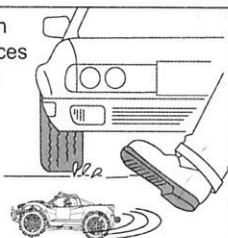

As the product includes small and sharp parts, assemble and store this product only in places out of the reach of children.



As the front end of the antenna may be dangerous, do not aim it toward faces.



During the car running and after, the motor will be hot. Please do not touch it until it has had time to cool down.



Don't use the same frequency with others at the same time. Or the car will lose control or even lead to serious accidents.



Troubleshooting

Description	Cause	Solution
The car does not operate at all.	Transmitter or receiver is off.	Turn on both transmitter and receiver.
	Batteries are not placed properly in the transmitter.	Place batteries in the transmitter properly.
	The drive battery is not charged enough.	Charge the drive battery.
The car does not follow your operation and control distance not enough long.	Someone else is using the same radio frequency as you are using.	Charge your radio frequency to the one no one else is using, wait until the driver using the same radio frequency finishes driving, or drive your car at a different place.
	There is not enough power in the transmitter or receiver batteries.	Replace the transmitter batteries with new ones and charge the drive battery.
	Not tighten antenna on the transmitter/not fully extend antenna.	Make sure insert antenna into the transmitter and fully extend antenna.



CAUTION

- * Please observe the operation manual or packing explanation to install and use, and some parts should be installed by adults.
- * The product contains small part, it may cause swallow or choke.
- * Never run an R/C model in the seeper or rain, moisture areas, or it may cause the parts malfunction.
- * Please throw the wrapper in time to avoid danger for the children.
- * Regularly examine for damage to the charge, wire, plug, bodyshell or other parts. In the event of any damage, it must not be used until the damage has been repaired.
- * The charge, battery box and battery must insert with the appointed power source of product symbol same.
- * This product must only be used with the original collocation charger.
- * The product is contains the functional outshoots are may be dangerous to the children.

- * Apart the charger and toy before clean.
- * As the front end of the antenna may be dangerous, do not aim it toward anyone's body, face or eyes.
- * Batteries are to be inserted with the correct polarity.
- * Use the "AA" non-rechargeable or "AA" rechargeable batteries.
- * Non-rechargeable batteries are not to be recharged.
- * Rechargeable batteries should only be charged under adult supervision.
- * Rechargeable batteries must be removed from model before charger.
- * Different types of batteries or old and new batteries are not to be mixed.
- * Exhausted batteries are to be removed in time.
- * The supply terminals are not to be short-circuited.
- * Never short circuit the batteries. throw it in a fire or attempt to open their outer casings.
- * Please remove the batteries when not in use.
- * Please retain these instructions for future reference.

Product Introduction

- ★ Type: 1:10 Electric 4WD Climbing car
- ★ Product size: 380*275*195mm
- ★ Wheelbase: 230mm
- ★ The minimum distance of front and rear wheel: 125mm
- ★ Ground clearance: 50mm
- ★ Transmission ratio: 1:10.28
- ★ Tire diameter: 105MM; wheel width: 52mm
- ★ ESC receiving server: Independent receiver
- ★ Motor: 3660 Brushless motor
- ★ Remote control: 2.4G Remote control
- ★ Remote control distance: ≥100M
- ★ Remote control battery: 4AA batteries (not included)
- ★ Battery: Lithium battery 7.4V 2200 mAh
- ★ Charger: lipo balance
- ★ Charging time: 3 hours
- ★ Use time: 8 minutes
- ★ Server: 6kg servos
- ★ Car shell: antiknock PVC printing car shell, beautiful Crashworthiness
- ★ Driving speed: 55km/h.

Proportional R/C Using Instruction

- ① Turn left the steering wheel, the car will turn left. Turning left angle can be adjusted by the degree of wheel twisting.

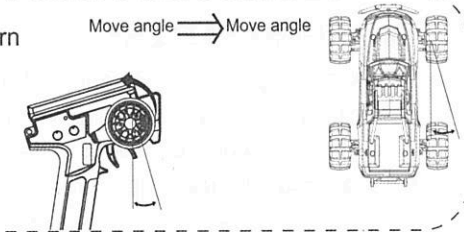

- ② Turn right the steering wheel, the car will turn right. Turning right angle can be adjusted by the degree of wheel twisting.

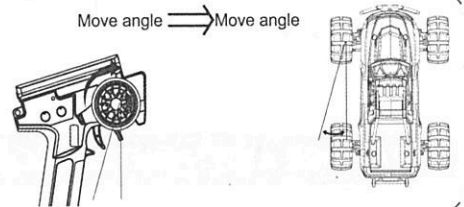

- ③ Pull the throttle trigger backward, the car will forward. Adjusting the angle of throttle trigger can adjust forward speed of the car. During the car forward, quickly push the trigger forward to stop it.

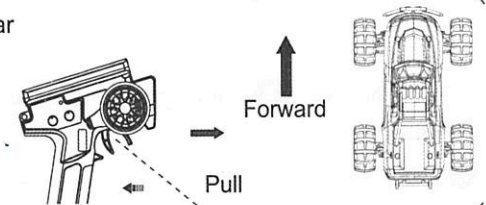

- ④ Loosen the trigger to make it return the neutral position when brake. Push the throttle trigger forward, the car will backward. Adjusting forward angle of throttle trigger adjust backward speed of the car.

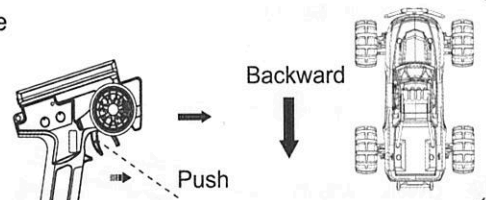

Introduce the common tools and assemble the electron parts

Tools needed for assembly

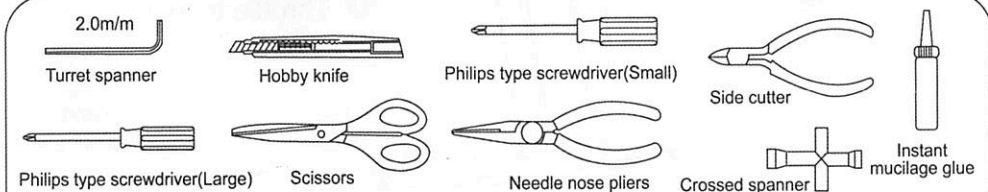

Charge caution

CHARGING BATTERY

- 1) Please firstly check and confirm input voltage of the charge is consistent with local voltage, output voltage of the charge is consistent with battery voltage.
- 2) Battery must be used up before you charge, Charging time is not more than 3 hours.
- 3) Be careful to make sure there is adult to control when charging.

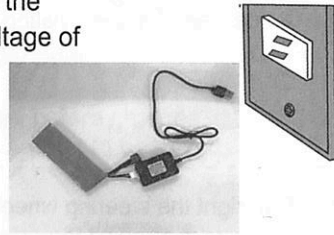

PRACTICE AND MAINTENANCE

Operating program

- 1> Turn on the switch ① of transmitter and make sure the power indicator is
② steady light, then turn on the car.
- 2> Slip the trigger ③ of transmitter slowly, you can observe the car whether it can go ahead or go back.

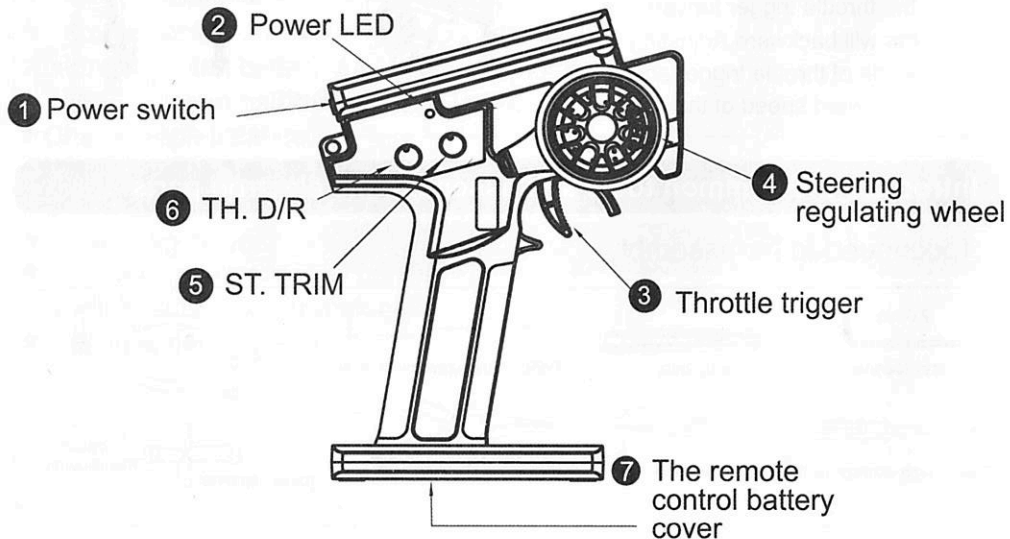

- 3> Turn steering regulating wheel ④ of transmitter to left or right, and make sure the steering of front wheels follow the instruction.

- 4> Put the car on the ground and stand behind the back of the car. Squeeze the throttle trigger ③ of transmitter gently. If the car does not move in a straight line, you can adjust the trim ⑤ of transmitter until the car moves in a straight line.

- 5> Throttle trim key ⑥, turn clockwise, the car became faster and faster; counterclockwise rotation, the speed will slow down.

- 6> OK, ready to run

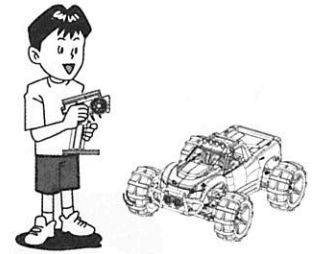
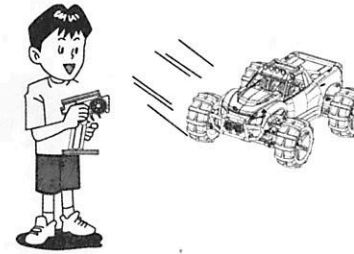
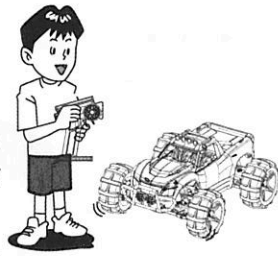

Practice

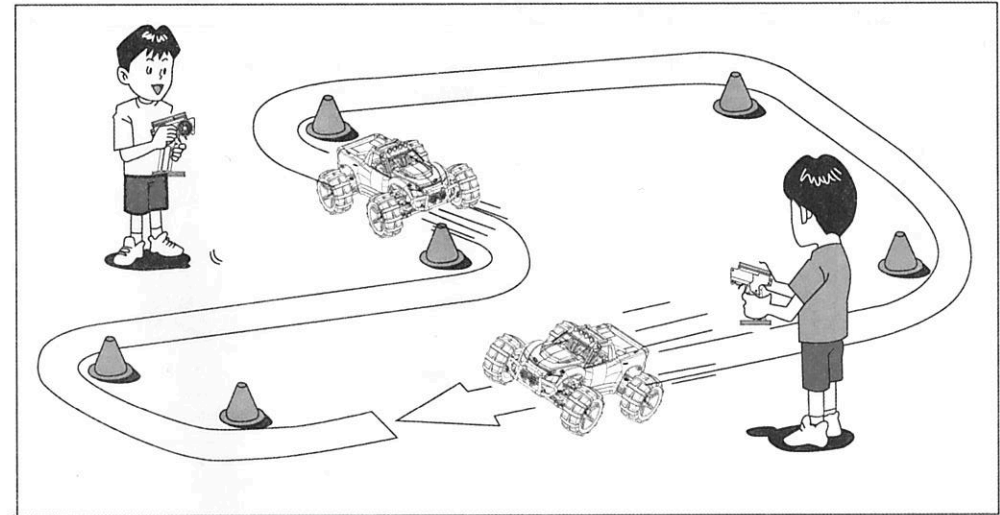

Let's practice! Make R/C car circuit at a wide and safe location using corner pylons (separately available), empty cans or such. Running fast at straight section and slow down at curved section is a basic speed control technique useful when driving R/C car.

Maintain

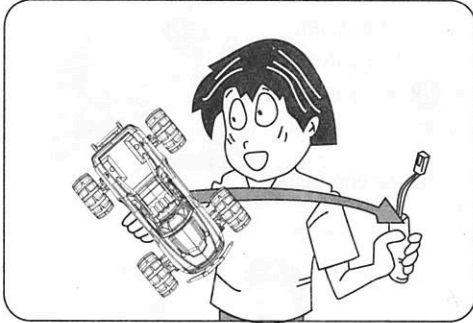

When the car is not in use, you should remove the battery from the car.

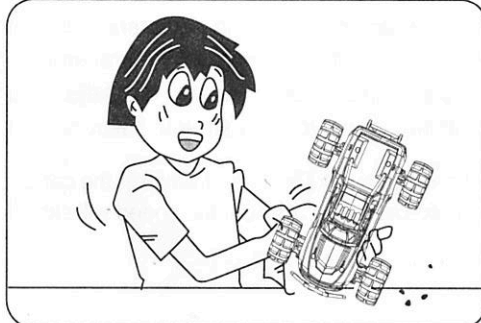

Completely remove sand, mud, dirt etc.

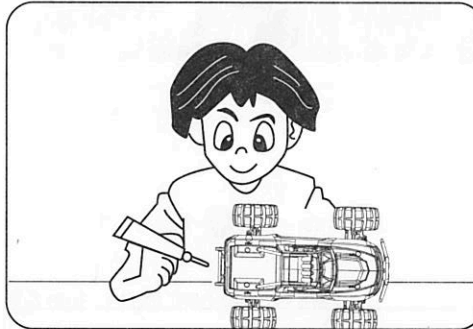

Metal outside should apply the rust prevention oil.

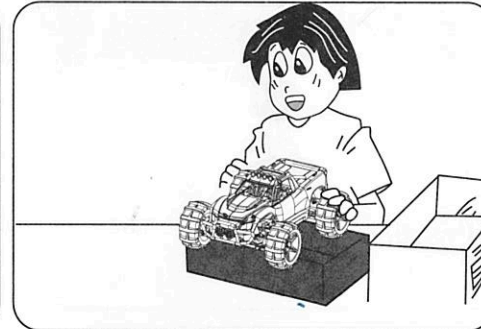

Store the car and batteries separately when not in use.

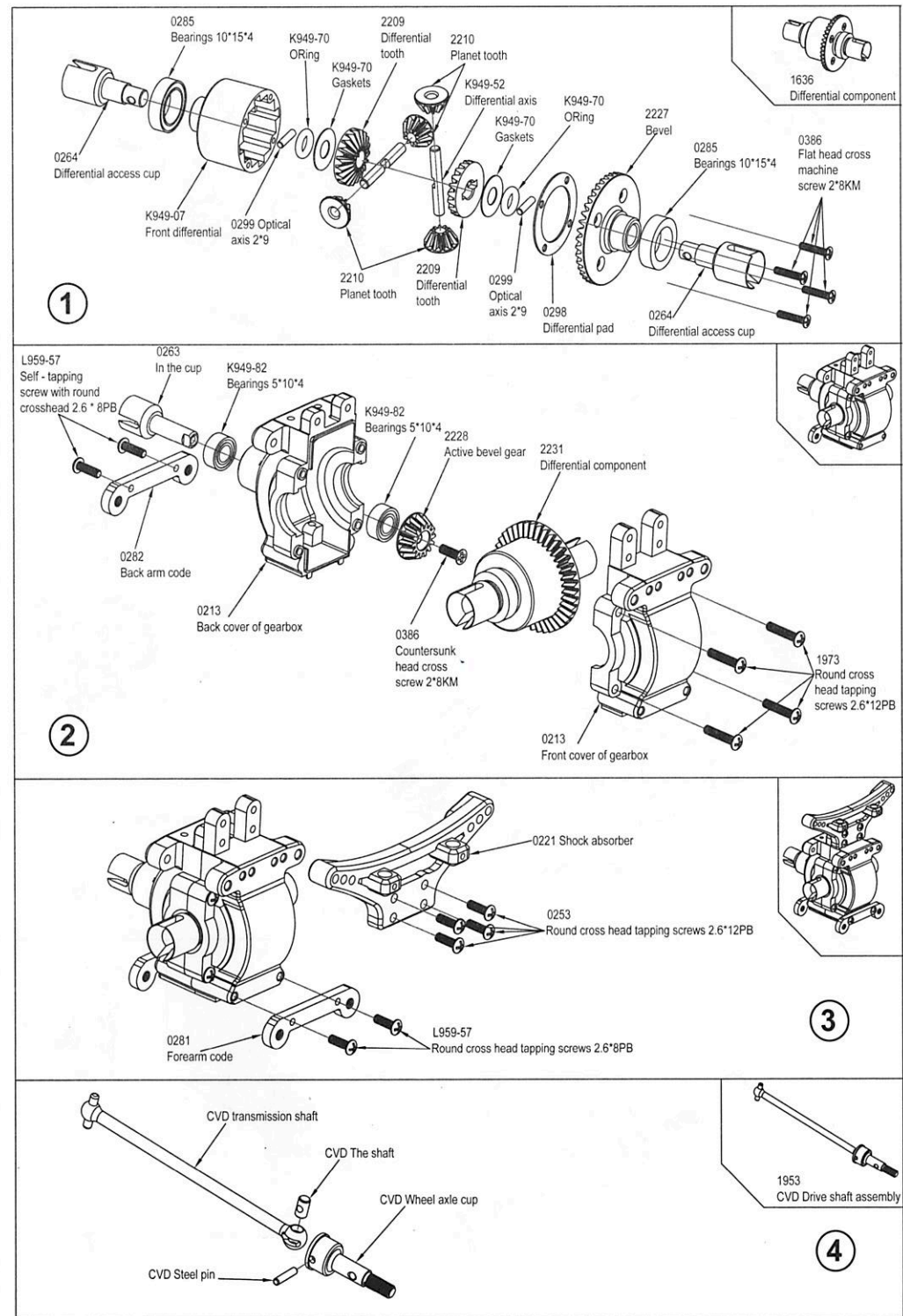

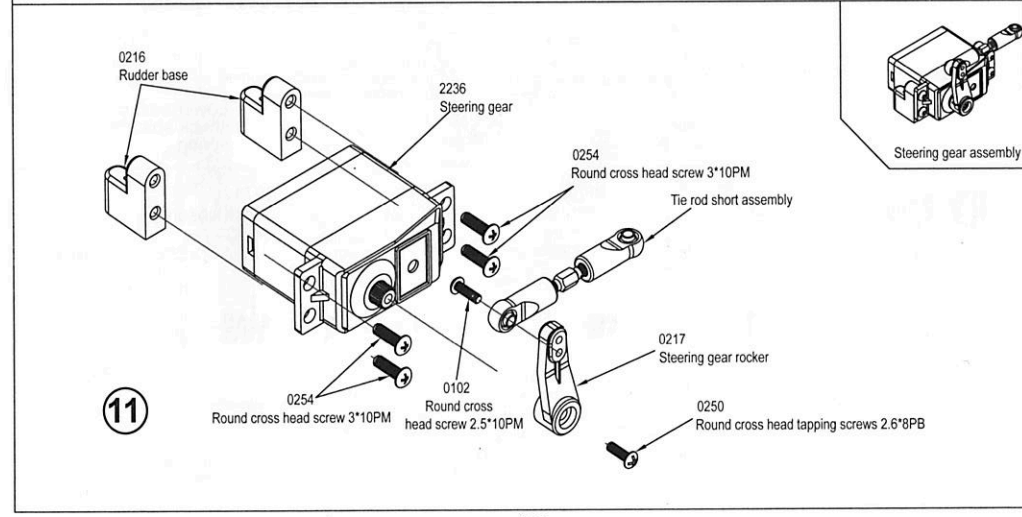
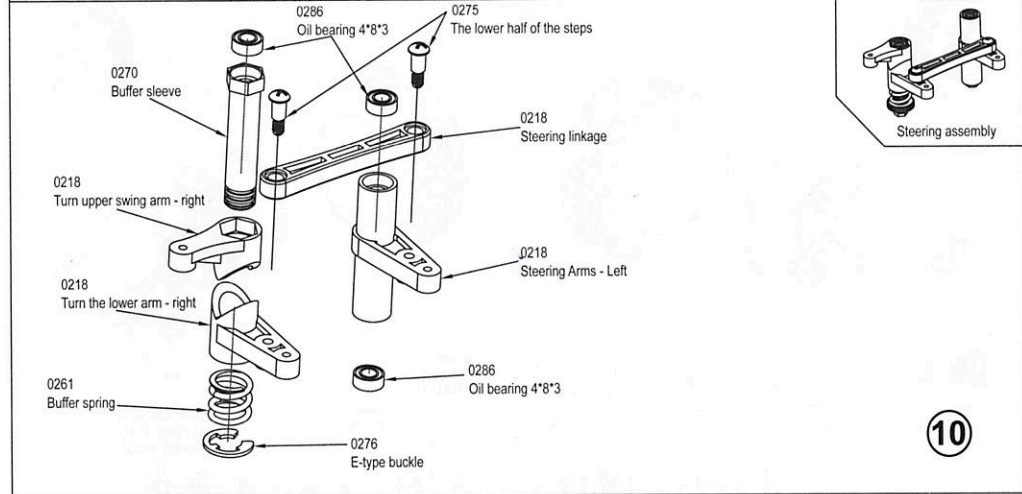
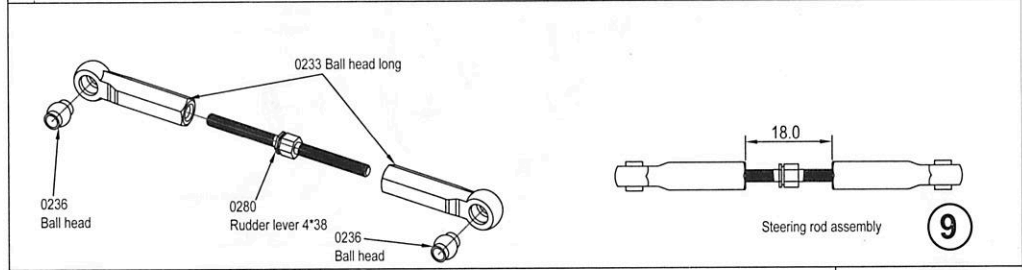
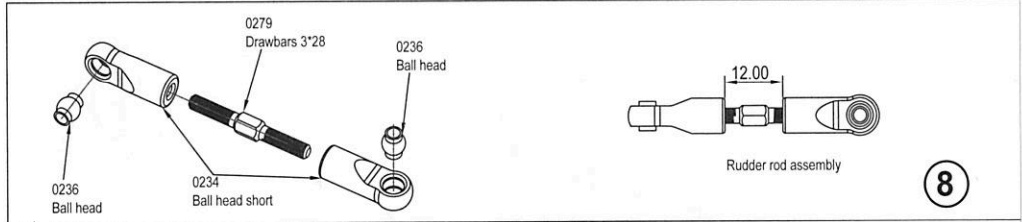
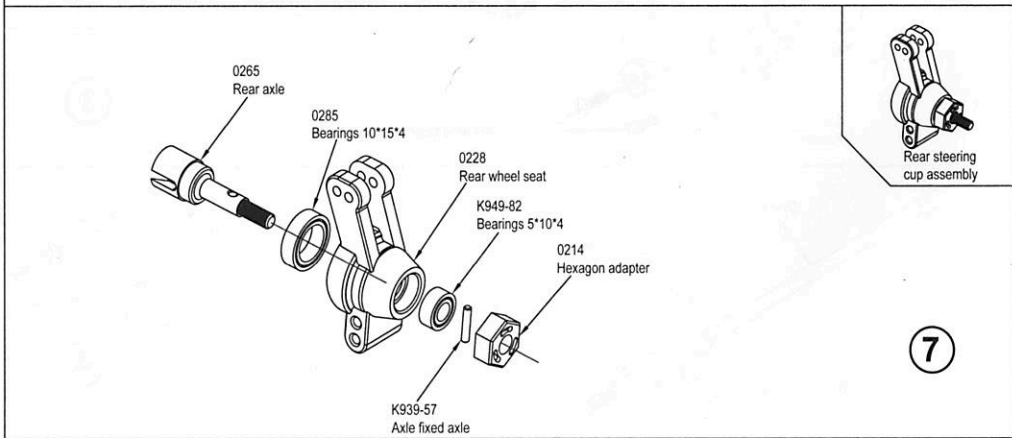
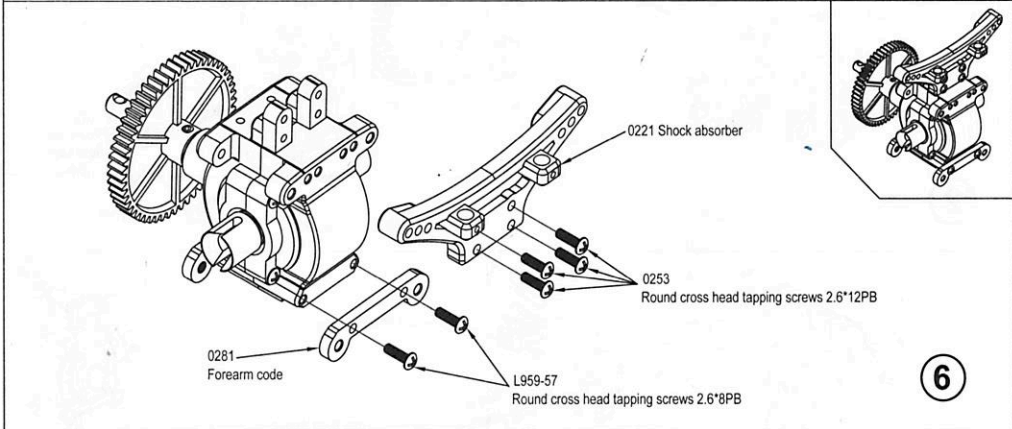
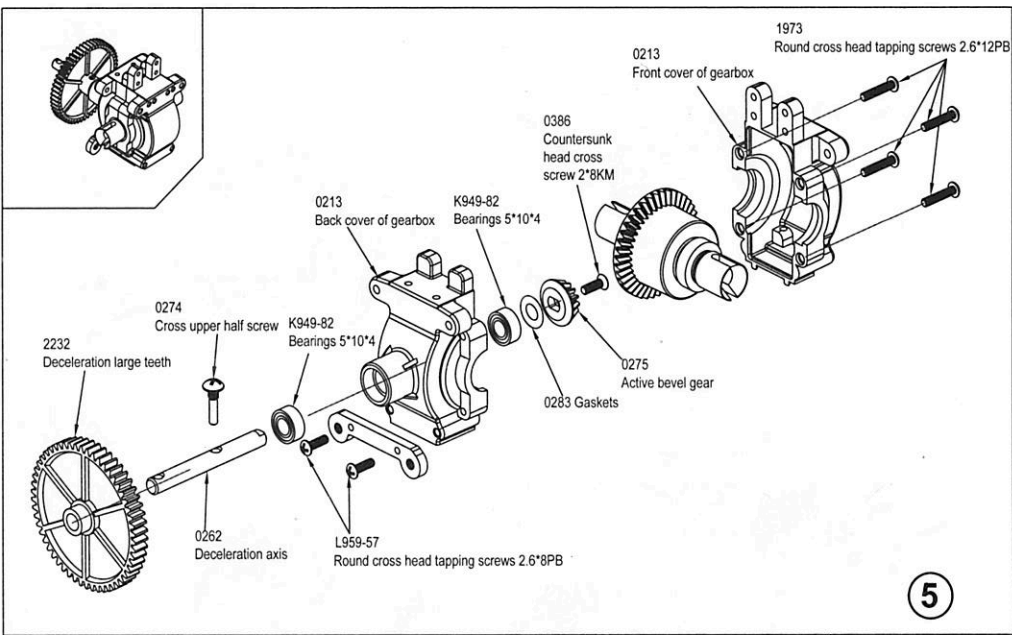

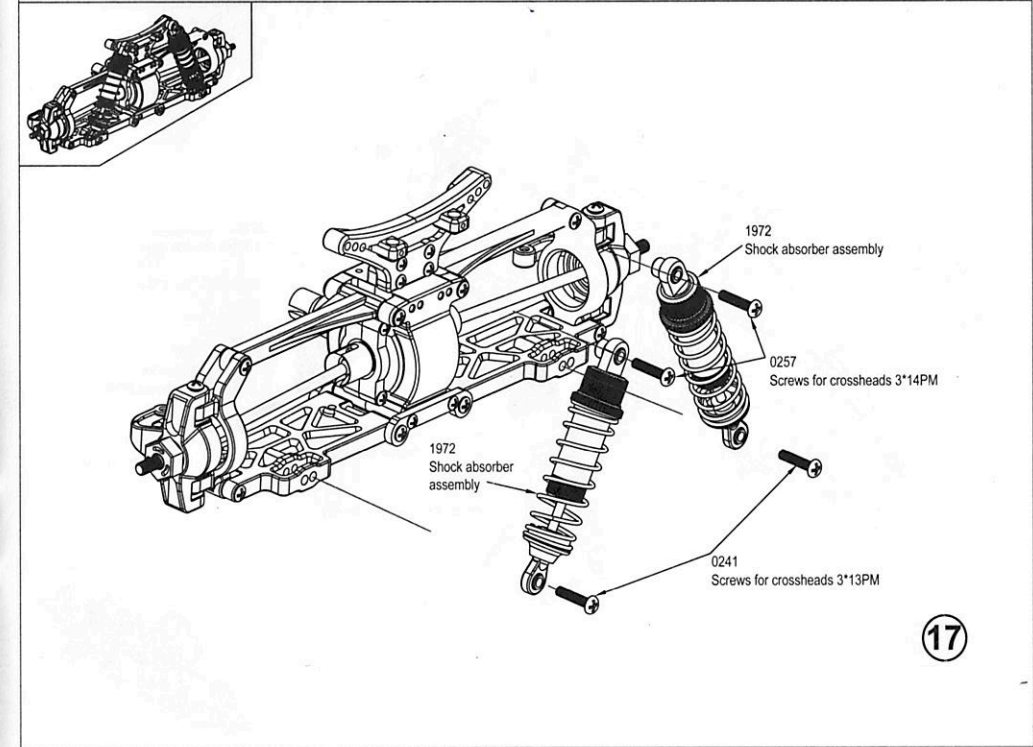
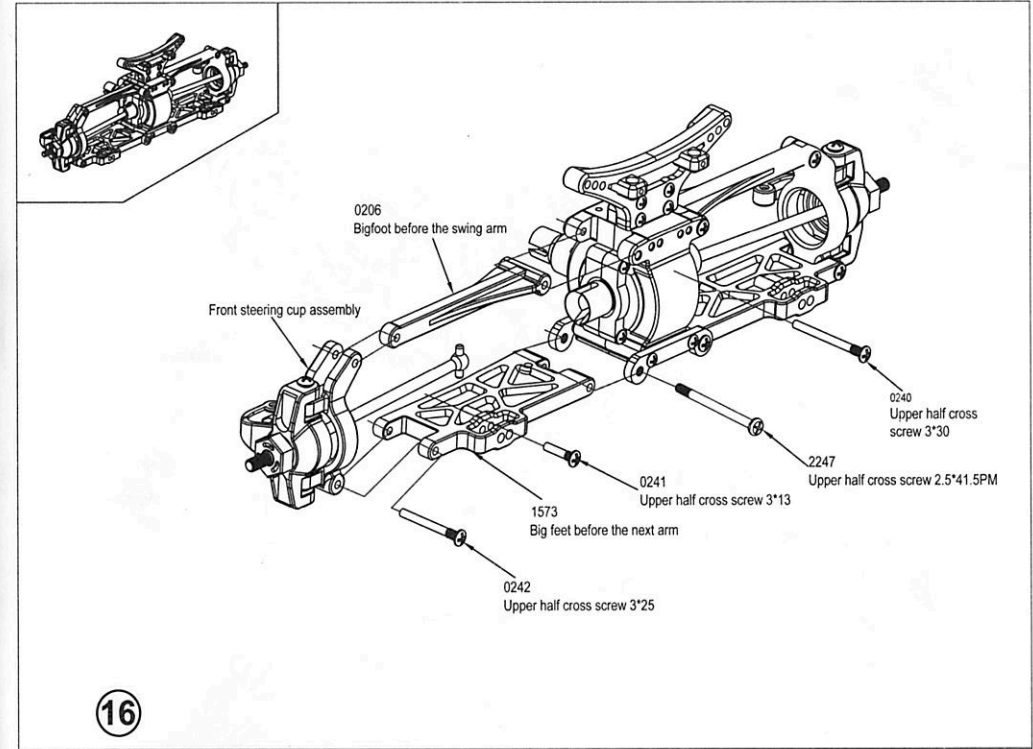
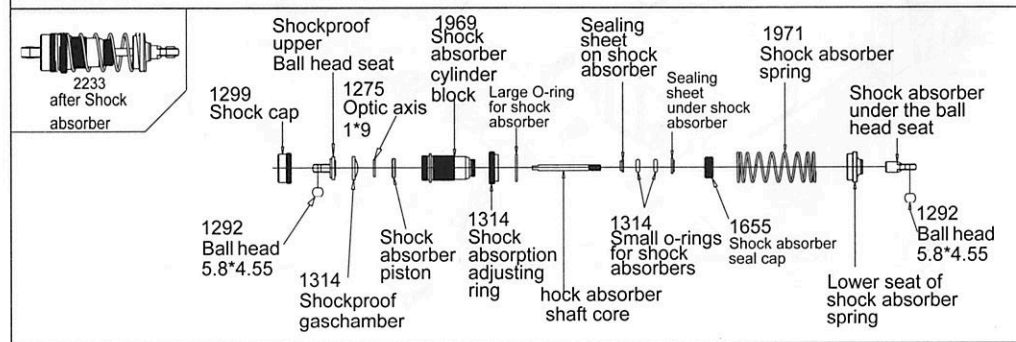
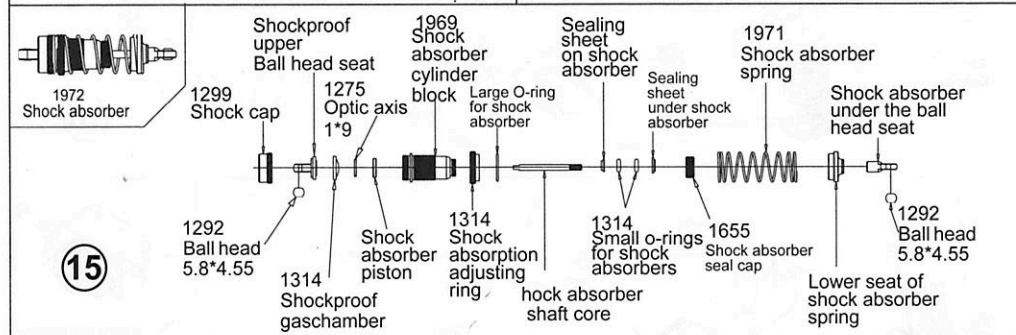
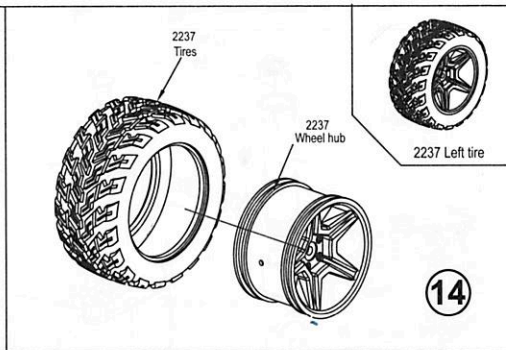
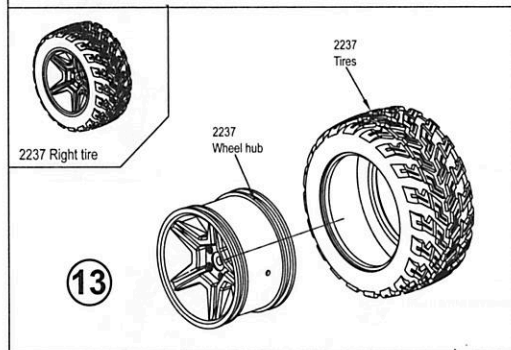
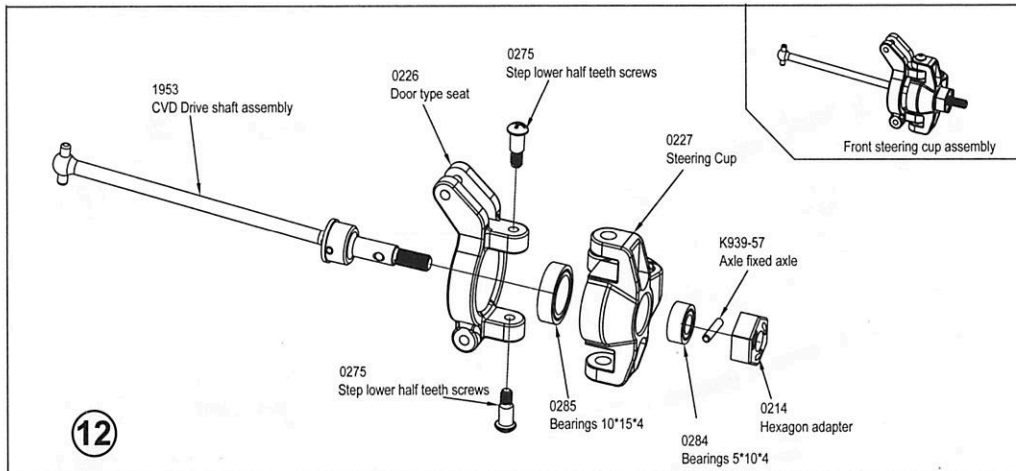

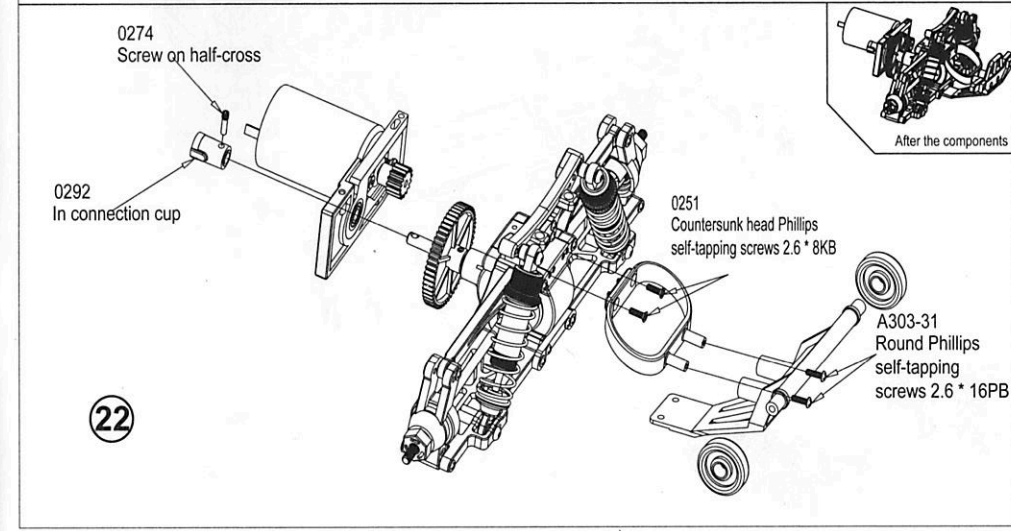
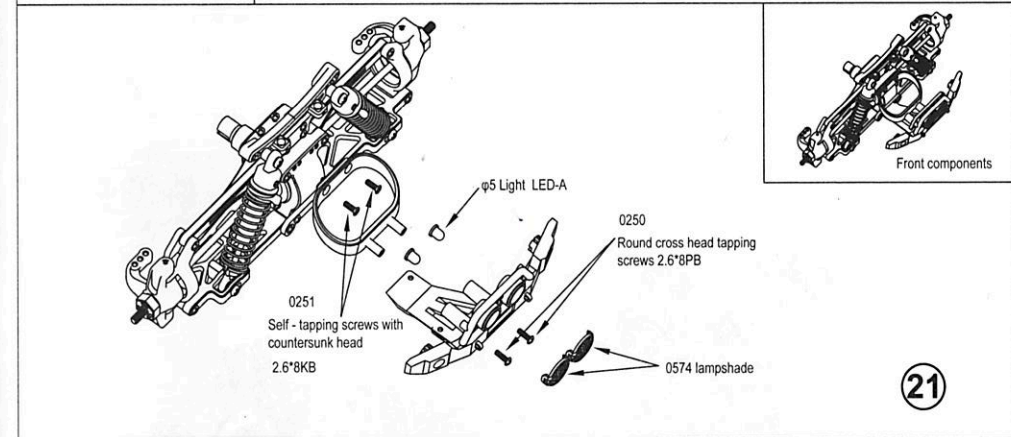
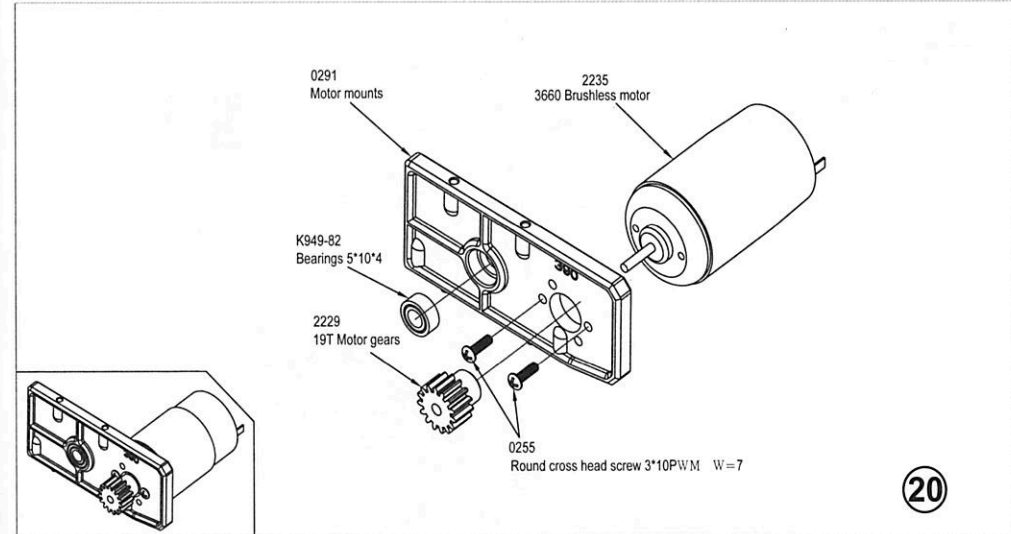
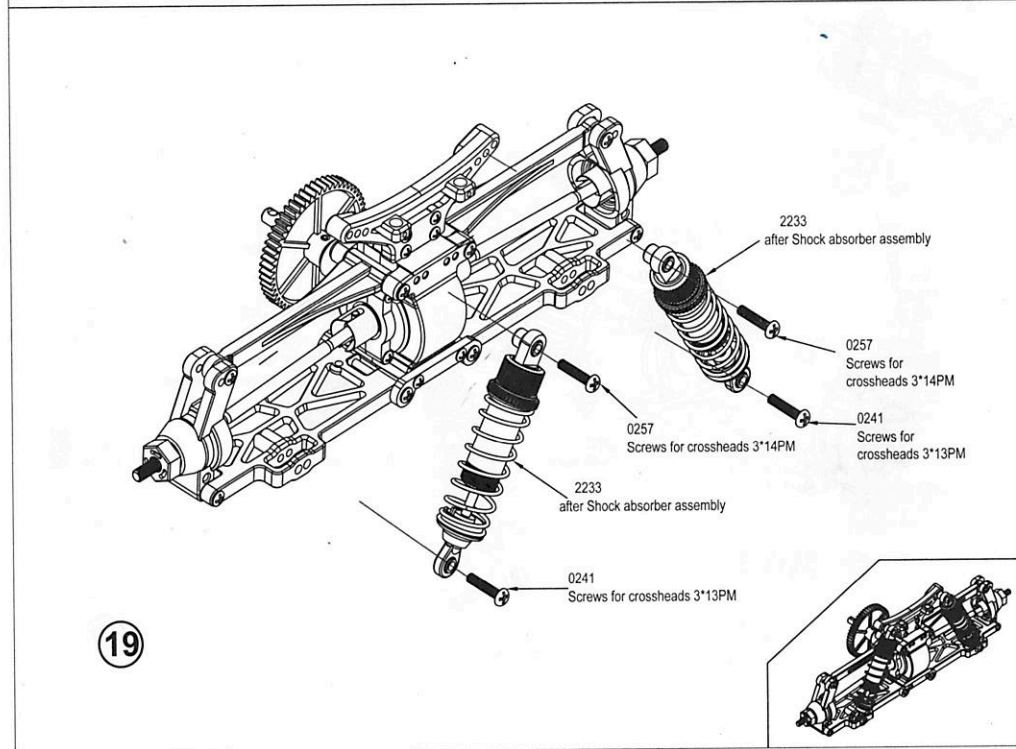
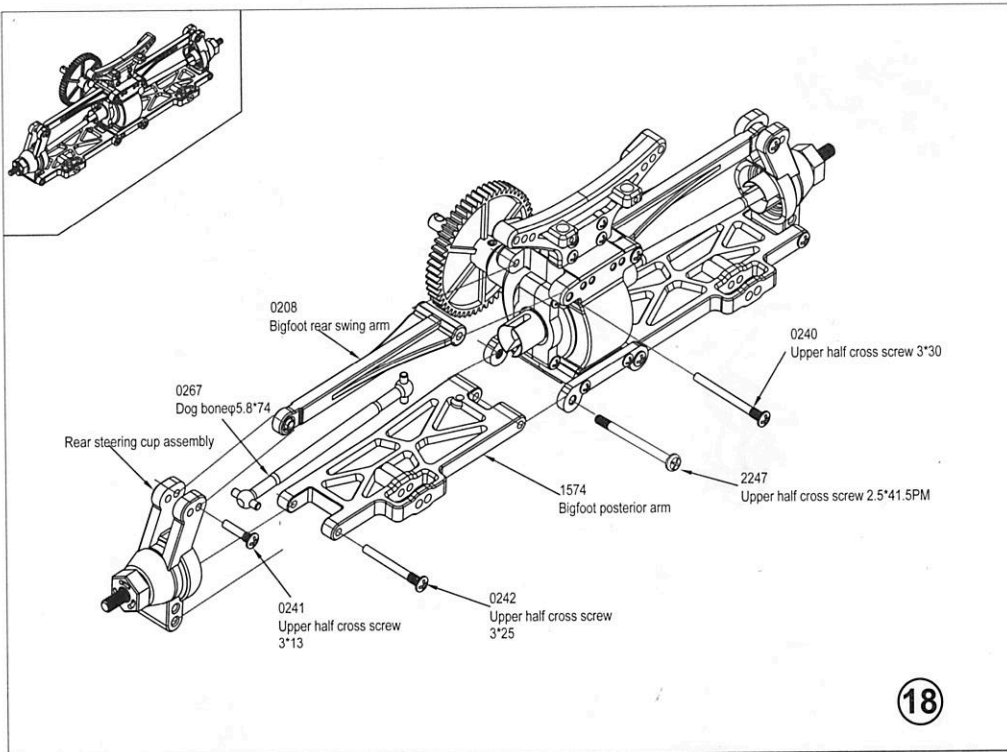

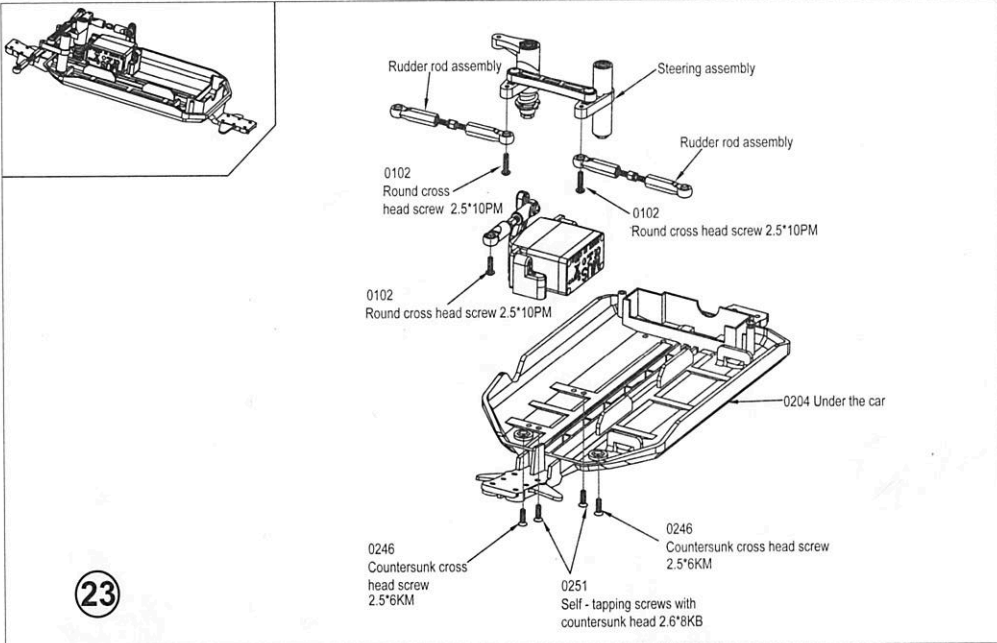

23

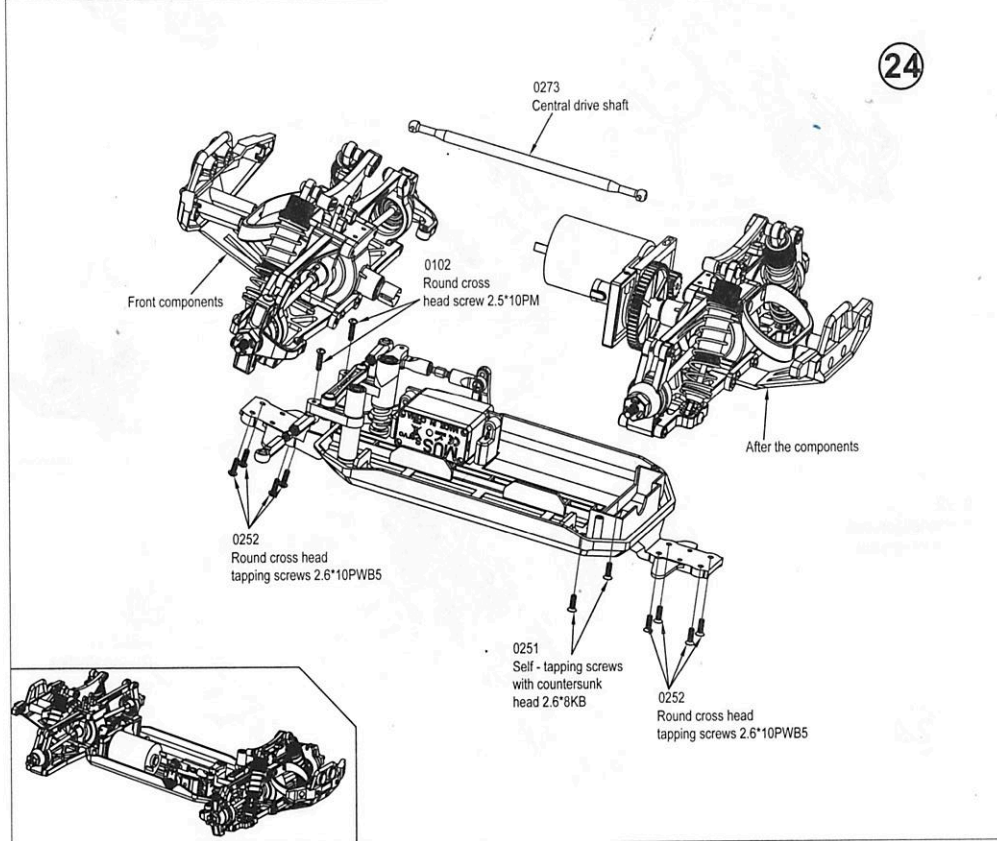

24

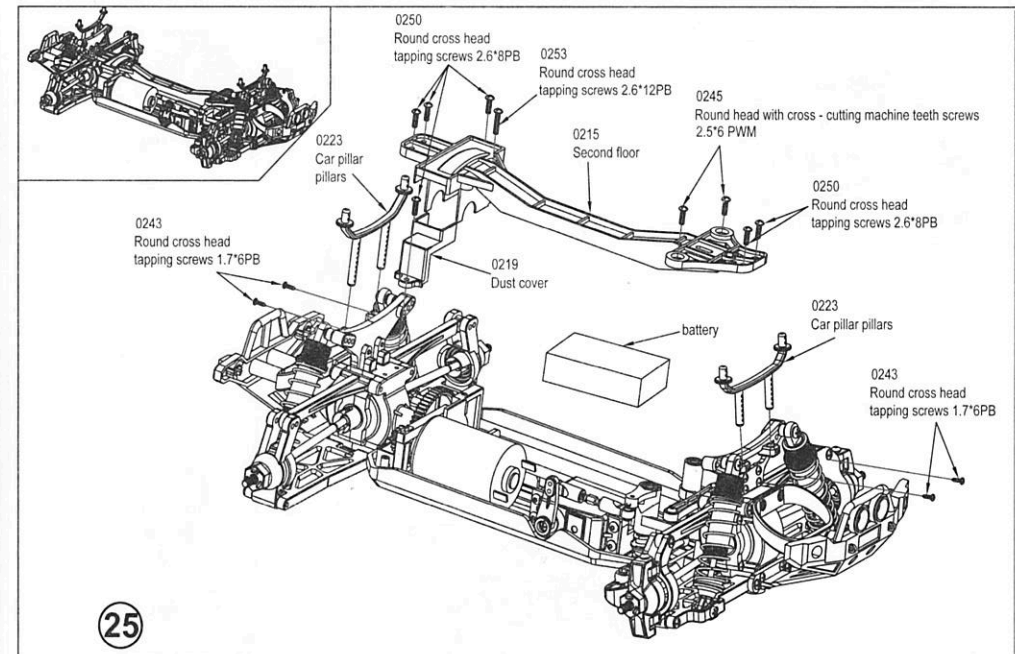

25

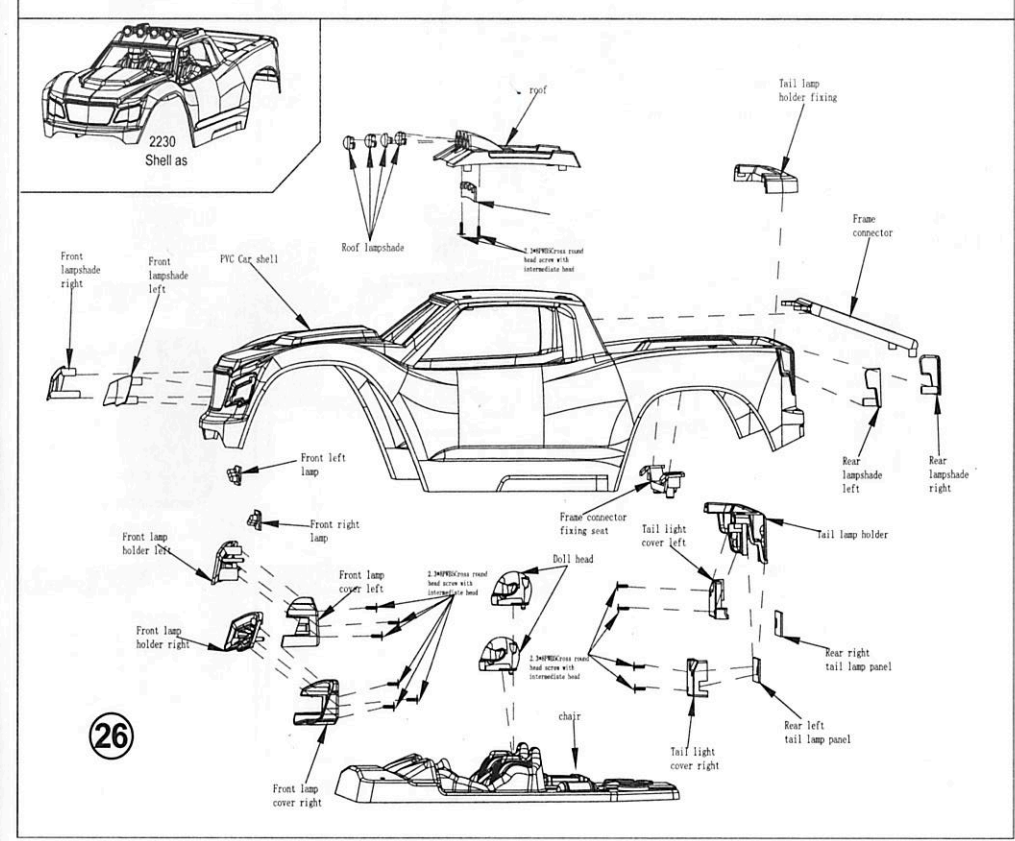

26

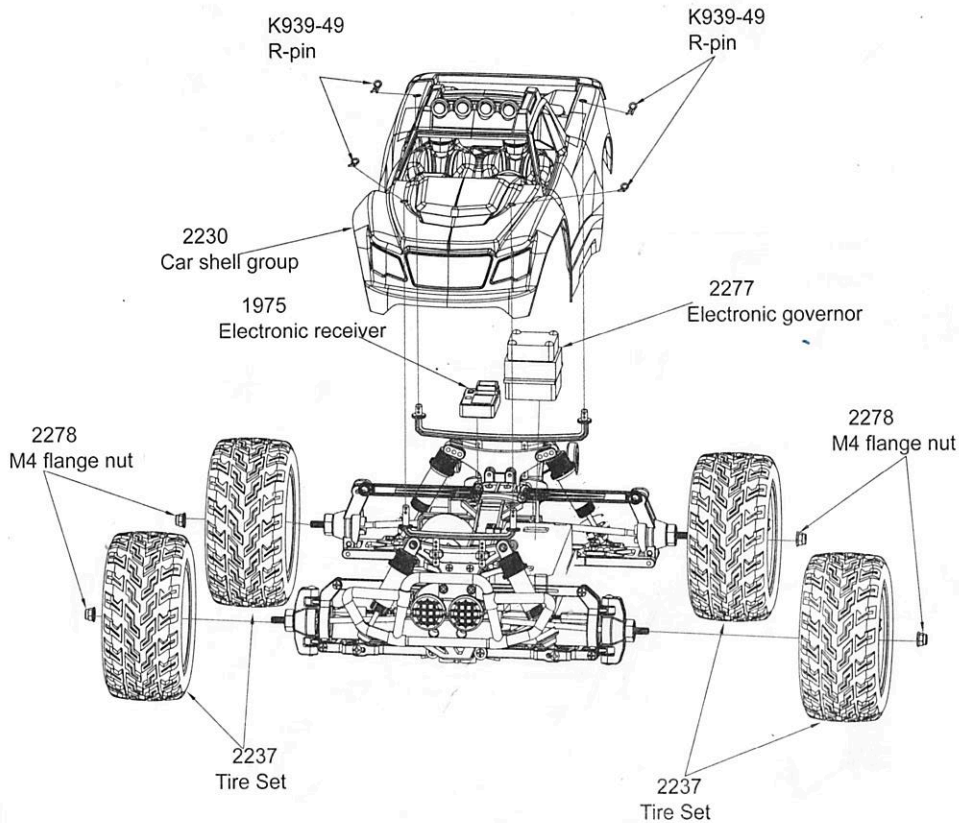

27

Sale parts view

 <p>1510 Vehicle components</p>	 <p>0213 Gear cover assembly</p>	 <p>0214 Hexagon adapter assembly</p>	 <p>0215 Second floor components</p>
 <p>0216 Rudder base assembly</p>	 <p>0217 Rudder rocker arm assembly</p>	 <p>0218 Steering linkage arm assembly</p>	 <p>0219 Dust cover assembly</p>
 <p>2232 Deceleration large tooth components</p>	 <p>0221 Shock absorber components</p>	 <p>0222 Anti-collision support components</p>	 <p>1418 Shell pillar components</p>
 <p>2234 Receiver board assembly</p>	 <p>2231 Differential component</p>	 <p>0226 Door type seat assembly</p>	 <p>0227 Steering cup assembly</p>
 <p>0228 Rear wheel seat assembly</p>	 <p>0233 Ball cap - long components</p>	 <p>2176 Ball head assembly</p>	 <p>A303-28 Upper half screw 3 * 36 PMO black zinc plated hardened component</p>

Sale parts view

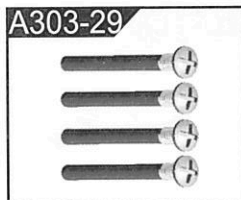

A303-29
3 * 30 PM D5.5 Cross round head with half-plated carbon steel plated black zinc components

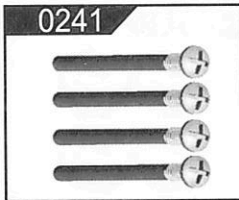

0241
3 * 13 PM screw assembly



0242
3 * 25 PM screw assembly



A303-32
Round cross self-tapping ST1.7 * 6 PB D3 black zinc plating components



0386
2 * 8KM screw assembly



A949-43
Round head with screws M2.5 * 6 * 6 group



0246
2.5 * 6 KM screw assembly



L959-57
Round head tapping screws 2.6 * 8 * 10 sets



L959-54
Self-tapping screws 2.6 * 8 * 10 countersunk head

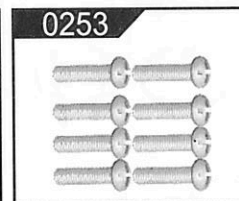

0253
ST 2.6 * 12 PB screw assembly

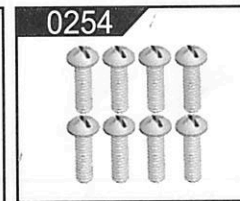

0254
ST 3 * 10 PB screw assembly



0255
3 * 10 PWM7 screw assembly



0256
3 * 12 PM screw assembly

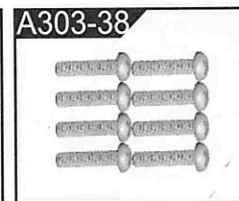

A303-38
3 * 14 PM D5.5 cross-head black zinc plated components

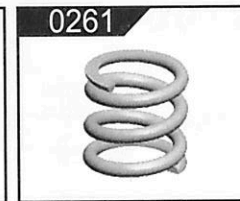

0261
Buffer spring assembly

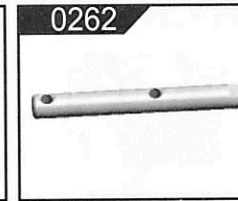

0262
Deceleration shaft $\phi 5 * 45$ mm components



0263
In the cup $\phi 10 * 25$ mm components



0264
Differential access cup $\phi 11 * 25$ mm components

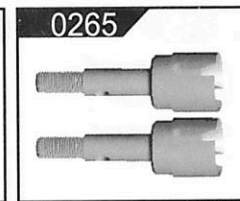

0265
Rear axle $\phi 11 * 36$ mm components

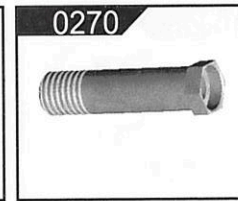

0270
Buffer sleeve H9 * 37 mm components

Sale parts view



0272
Steering column H6 * 40 mm components

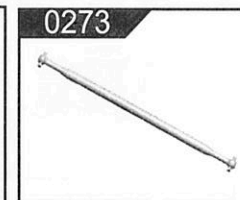

0273
Central drive shaft $\phi 5.8 * 135$ mm components



0274
3 * 10 PM screw assembly



0275
3 * 10 PM half-tooth screw assembly



0276
E-type buckle components



0279
Rudder rod assembly



0280
Tie rod assembly

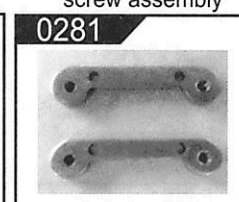

0281
Forearm code component

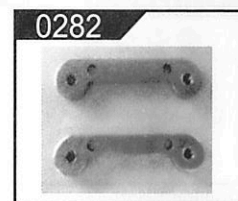

0282
Rear arm assembly



K949-82
Rolling bearings 5X10X4 group



0285
Ball bearing 10 * 15 * 4 groups



0286
Oil-bearing copper sets of 4 * 8 * 3 groups



2235
3660 Brushless motor

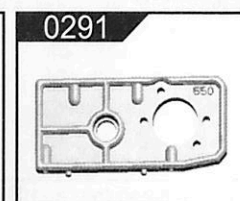

0291
550 Motor Mount Components



0292
Middle cup assembly

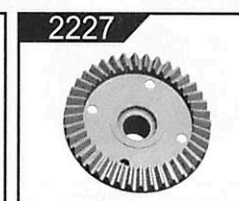

2227
Umbrella tooth



2228
Driving gear set



2229
19T motor tooth components





0298
Green shell paper components

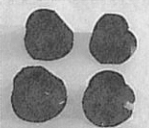

0299
Optical axis 2 * 9 components

Sale parts view

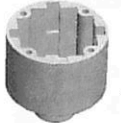
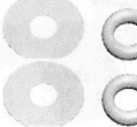
1573 	0206 	1574 	0208 
igfoot front lower arm assembly	Bigfoot front swing arm assembly	Bigfoot rear swing arm assembly	Bigfoot rear swing arm assembly
1965 	1419 	0267 	1953 
Front collision avoidance group	Rear impact team	Dog bone $\phi 5.8 \times 76$ mm components	Long CVD Drive Shaft Assembly
L959-65 	1652 	1374 	0102 
M4 locking nut group	Battery 7.4V 2200MAH-18650 group	USB Charger	Phillips head screws 2.5 * 10 PM group
1968 	1972 	K939-49 	K939-57 
Tire components	Shock absorber assembly	R-type pin 1 * 22.2MM group	Axle fixed group
2236 	K949-07 	K949-52 	K949-70 
6 kg 3-wire steering gear unit	Front differential gearbox	Planetary gear shaft group	Differential O-Ring Flat Division

Sale parts view

2132 	1511 	1654 	1655 
V8-104018 remote control	Battery cover	M3-Machine screw	Shock sealing cap group
1314 	1962 	0574 	0575 
Shock absorber O circle group	Roof group	Shell connector group	Lampshade group
2230 	1975 	1969 	1847 
Car shell group	Electronic receiver	Shock absorber cylinder block	Axis group
1971 	0129 	1973 	1974 
Shock absorber spring set	Cross pan head screw 2.3 * 8pwb w = 5 sets	2.6 * 12pwb5 screw set	2.3 * 4pwb8 screw set
2209 	2210 	1989 	0252 
Differential gear set	Asteroid tooth group	Zinc alloy cross sleeve	2.6 * 10pwb5 screw set

Sale parts view

2233



Rear shock absorber set