

1:12 Electric 4WD Climbing car



Caution: This model is not a toy, it is designed for user over 14 years of age.

Please use this instruction and the R/C system instruction at the same time.

The instruction is suitable for a type of model whose number is 12427

Safety and caution	1-2
Troubleshooting • Product introduction	2-3
Instruction of common tools and installation the electronic part...	4-5
Practice and maintenance.....	5-7
Assemble exploded view	8-18
Fittings view	19-25

Safety and Cautions

- *Never run the model on public roads or streets, as it could endanger traffic.
- *Never run the model in crowded areas, near or toward people or animals, to prevent property damage and/or personal injury.
- *Never run the model near rivers, ponds or lakes as to prevent R/C car from dropping into the water.
- *Make sure that no one else is using the same frequency as yours in your running area. Using the same frequency at the same time, whether it is driving, flying or sailing, can cause loss of control with R/C model, resulting in serious accidents.
- *To avoid a runaway R/C model or loss of control, always follow the procedure below:
 1. Fully extend transmitter antenna.
 2. Switch on transmitter.
 3. Switch on R/C model.
- *Follow reverse procedure to shut down.
- *Never touch or hinder rotating tire.
- *Never run R/C model in the rain or let run over puddles, as water may cause trouble with R/C model.
- *Motor and battery get very hot after running. Take care when handle them.
- *Retract transmitter antenna when not in use.
- *Remove the batteries from model and transmitter when they are not in use.

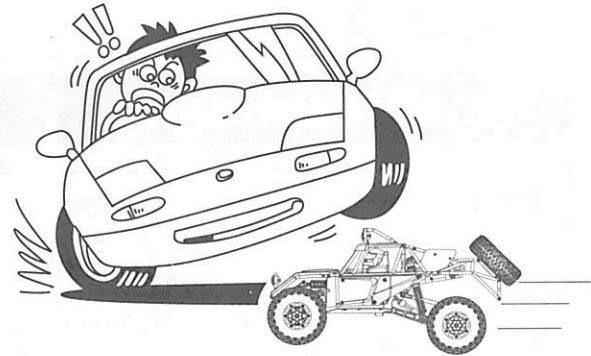

Cautions when handling batteries

- *Do not dismantle the battery or charger and do not cut any battery cables. This may cause short-circuit and/or damage to the product.
- *Change battery with compatible charger following proper procedure that is called out in the instructions. Do not modify charger or charge battery in improper way.
- *Do not recharge battery that is still warm from use as it may damage the battery. Allow the battery to cool off prior to recharging.
- *Make sure to disconnect charger cables from R/C model and electric outlet when not in use.
- *Remove transmitter battery when not using it for a long time as it may leak and damage transmitter when left for a long period.
- *Never incinerate used batteries, as they can explode causing serious accidents.



Safety precautions

Do not operate the model on public roads, in crowded places or near infants, it may cause accidents or injury.

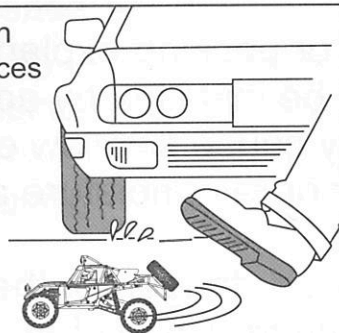

As the product includes small and sharp parts, assemble and store this product only in places out of the reach of children.

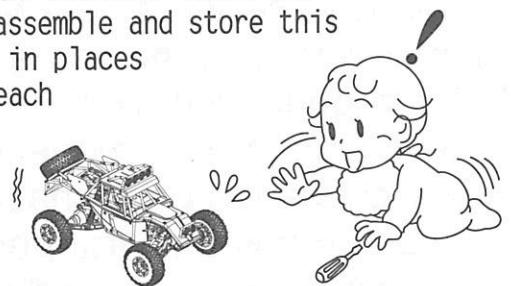

As the front end of the antenna may be dangerous, do not aim it toward faces.



During the car running and after, the motor will be hot. Please do not touch it until it has had time to cool down.



Don't use the same frequency with others at the same time. Or the car will lose control or even lead to serious accidents.

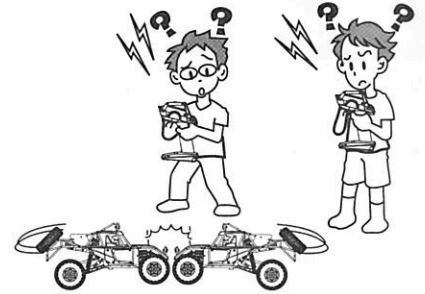

Troubleshooting

Description	Cause	Solution
The car does not operate at all.	Transmitter or receiver is off.	Turn on both transmitter and receiver.
	Batteries are not placed properly in the transmitter.	Place batteries in the transmitter properly.
	The drive battery is not charged enough.	Charge the drive battery.
The car does not follow your operation and control distance not enough long.	Someone else is using the same radio frequency as you are using.	Change your radio frequency to the one no one else is using, wait until the driver using the same radio frequency finishes driving, or drive your car at a different place.
	There is not enough power in the transmitter or receiver batteries.	Replace the transmitter batteries with new ones and charge the drive battery.
	Not tighten antenna on the transmitter/not fully extend antenna.	Make sure insert antenna into the transmitter and fully extend antenna.



CAUTION

- * Please observe the operation manual or packing explanation to install and use, and some parts should be installed by adults.
- * The product contains small parts, it may cause swallow or choke.
- * Never run an R/C model in the seep or rain, moisture areas, or it may cause the parts malfunction.
- * Please throw the wrapper in time to avoid danger for the children.
- * Regularly examine for damage to the charge, wire, plug, bodyshell or other parts. In the event of any damage, it must not be used until the damage has been repaired.
- * The charge, battery box and battery must insert with the appointed power source of product symbol same.
- * This product must only be used with the original collocation charger.
- * The product is contains the functional outshoots are may be dangerous to the children.

- * Apart the charger and toy before clean.
- * As the front end of the antenna may be dangerous,do not aim it toward anyone's body,face or eyes.
- * Batteries are to be inserted with the correct polarity.
- * Use the "AA" non-rechargeable or "AA" rechargeable batteries.
- * Non-rechargeable batteries are not to be recharged.
- * Rechargeable batteries should only be charged under adult supervision.
- * Rechargeable batteries must be removed from model before charger.
- * Different types of batteries or old and new batteries are not to be mixed.
- * Exhausted batteries are to be remove in time.
- * The supply terminals are not to be short-circuited.
- * Never short circuit the batteries. throw it in a fire or attempt to open their outer casings.
- * Please remove the batteries when not in use.
- * Please retain these instructions for future reference.

Product Introduction

- ★Type: 1:12 Electric 4WD Climbing car
- ★Product size:420*245*180mm
- ★Wheelbase:253mm
- ★The minimum distance of front and rear wheel: 160mm
- ★Ground clearance:40mm
- ★Transmission ratio:1:9.12
- ★Tire diameter: 93MM;wheel width:32mm
- ★ESC receiving server:two in one circuit
- ★Motor:540 brush motor
- ★Remote control: 2.4G Remote control
- ★Remote control distance:≥100M
- ★Remote control battery: 4 AA batteries (not included)
- ★Battery: Lithium battery 7.4V 1500 mAh
- ★Charger: lipo balance
- ★Charging time:3 hours
- ★Use time: 10 minutes
- ★Server:25 g servos
- ★Car shell: antiknock PVC printing car shell, beautiful Crashworthiness
- ★Driving speed: 50km/h.

Proportional R/C Using Instruction

- ① Turn left the steering wheel, the car will turn left. Turing left angle can be adjusted by the degree of wheel twisting.

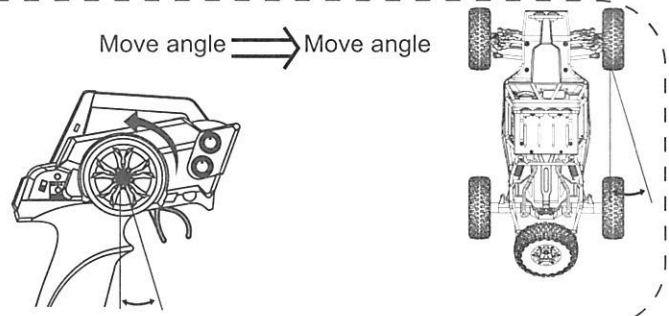

- ② Turn right the steering wheel, the car will turn right. Turing right angle can be adjusted by the degree of wheel twisting.

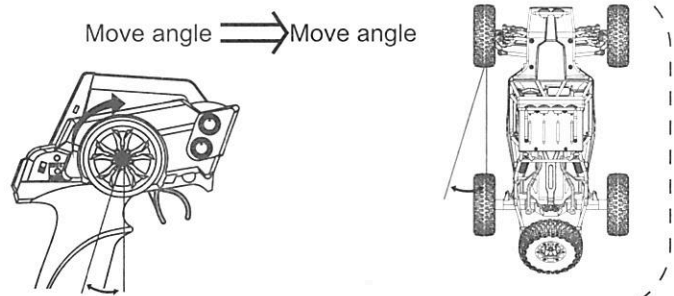

- ③ Pull the throttle trigger backward, the car will forward. Adjusting the angle of throttle trigger can adjust forward speed of the car. During the car forward, quickly push the trigger forward to stop it.

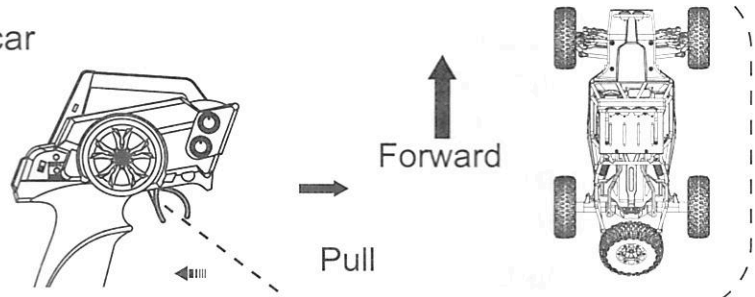

- ④ Loosen the trigger to make it return the neutral position when brake. Push the throttle trigger forward, the car will backward. Adjusting forward angle of throttle trigger adjust backward speed of the car.

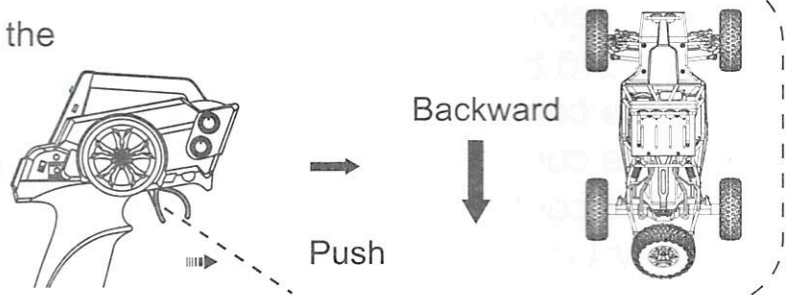

Introduce the common tools and assemble the electron parts

Tools needed for assembly

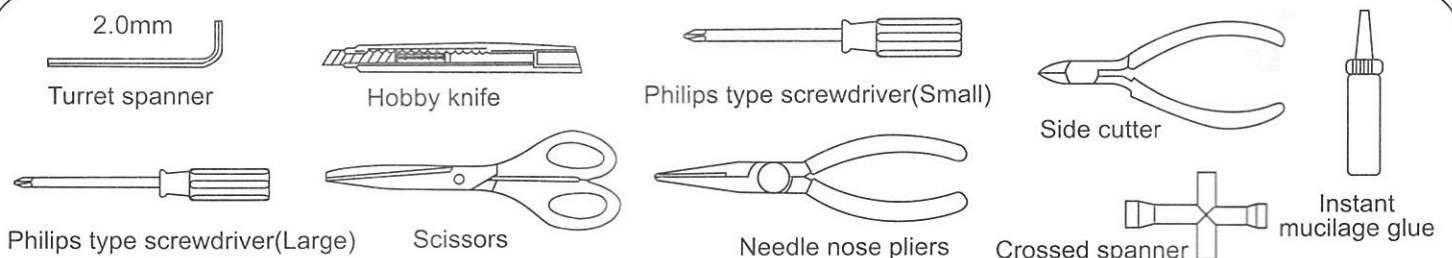

Charge caution

CHARGING BATTERY

- 1) Please firstly check and confirm input voltage of the charge is consistent with local voltage, output voltage of the charge is consistent with battery voltage.
- 2) Battery must be used up before you charge, Charging time is not more than 3 hours.
- 3) Be careful to make sure there is adult to control when charging.

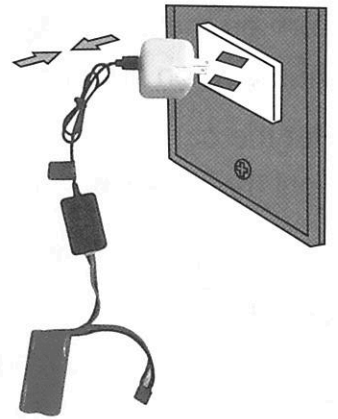

Assemble the electron parts

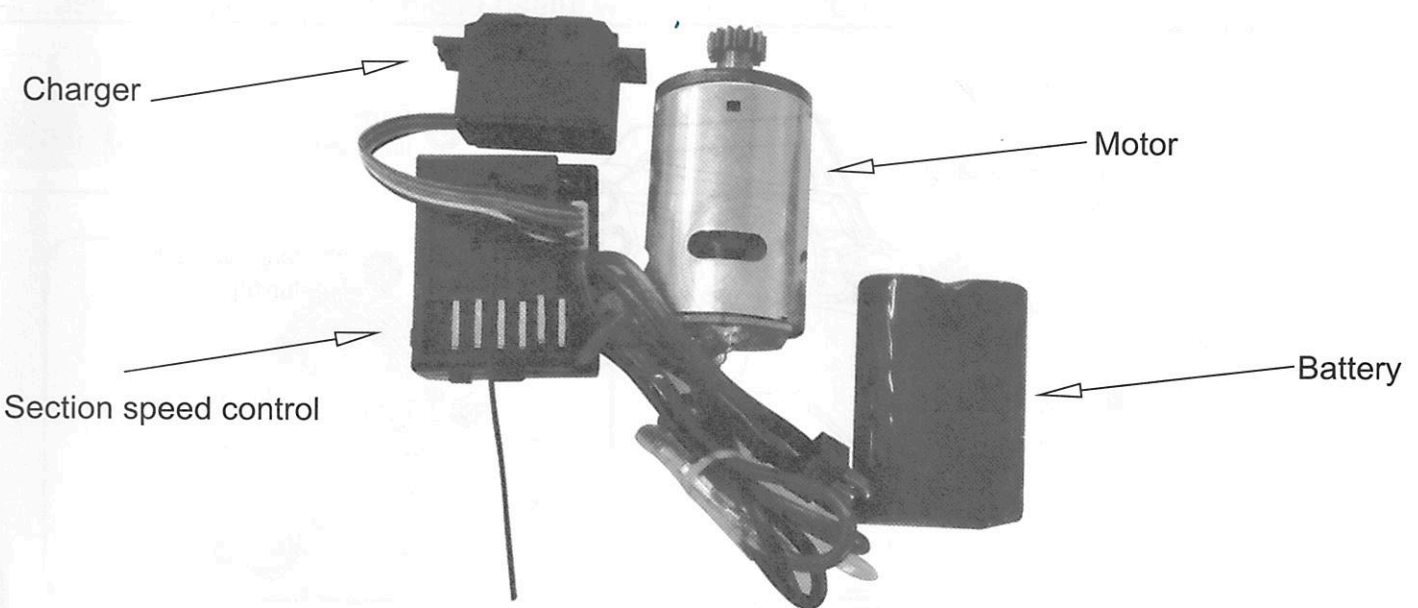

HOW TO CODE

1. Turn on the remote controller, and the power light on the remote controller will flash red and green. Then turn on the model car, and the light on the receiver will flash.
2. Turn the steering wheel on the remote controller until the power light on the controller turns green, and light on the receiver stops flashing, which means they are coded.

PRACTICE AND MAINTENANCE

Operating program

- 1> Turn on the switch ① of transmitter and make sure the power indicator is ② steady light, then turn on the car.
- 2> Put the car on the frame or stand. If wheel is running self-motion, adjust the trim ⑤ of transmitter until the wheel is still.
- 3> Slip the trigger ③ of transmitter slowly, you can observe the car whether it can go ahead or go back.
- 4> Turn steering adjusting wheel ④ of transmitter to left or right, and make sure the steering of front wheels follow the instruction.
- 5> Put the car on the ground and stand behind the back of the car. Squeeze the throttle trigger ③ of transmitter gently. If the car does not move in a straight line, you can adjust the trim ⑥ of transmitter until the car moves in straight line.
- 6> OK, ready to run.

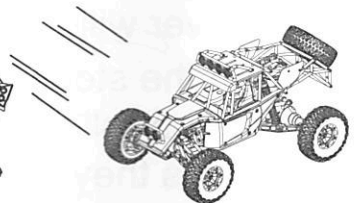
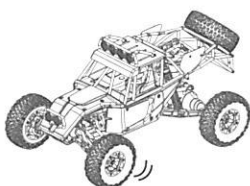
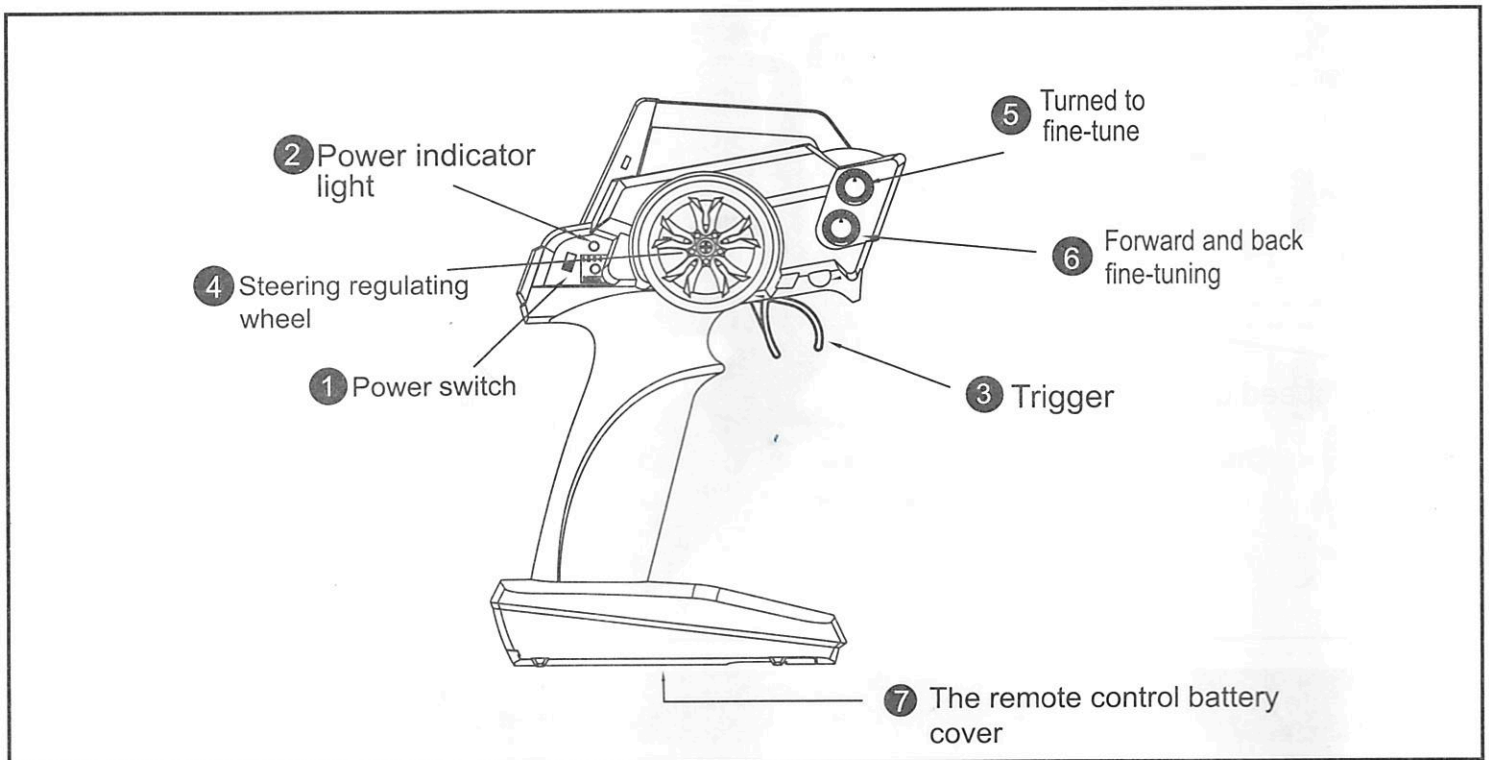

Practice

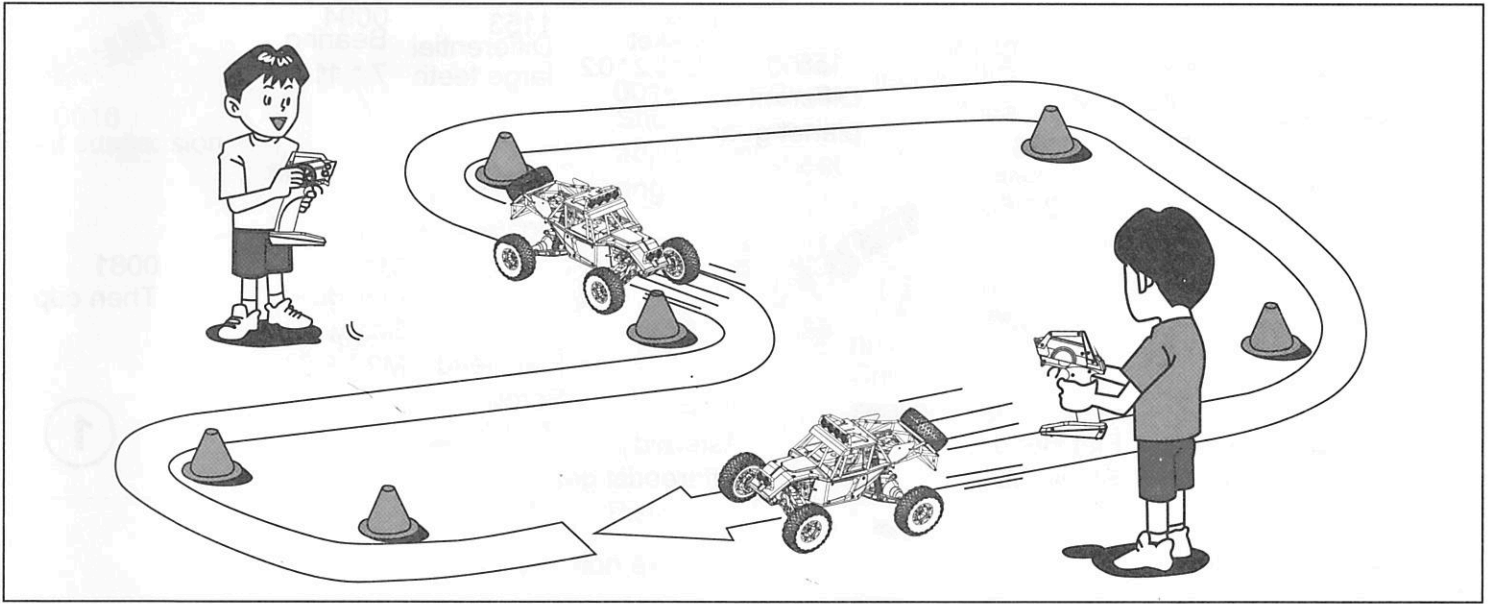

Let's practice! Make R/C car circuit at a wide and safe location using corner pylons (separately available), empty cans or such. Running fast at straight section and slow down at curved section is a basic speed control technique useful when driving R/C car.

Maintain

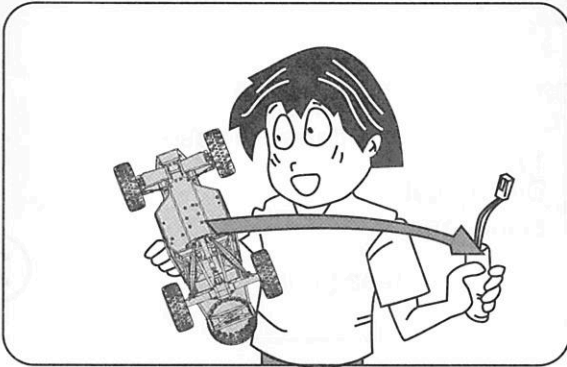

When the car is not in use, you should remove the battery from the car.

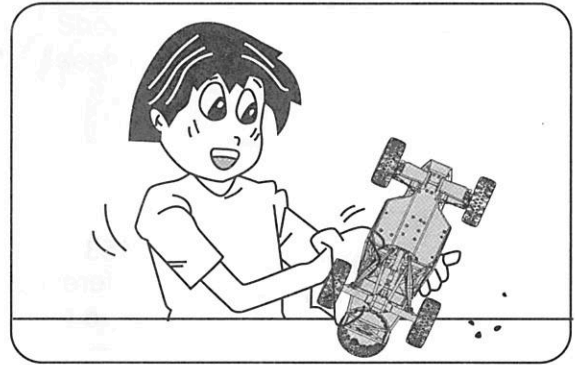

Completely remove sand, mud, dirt etc.

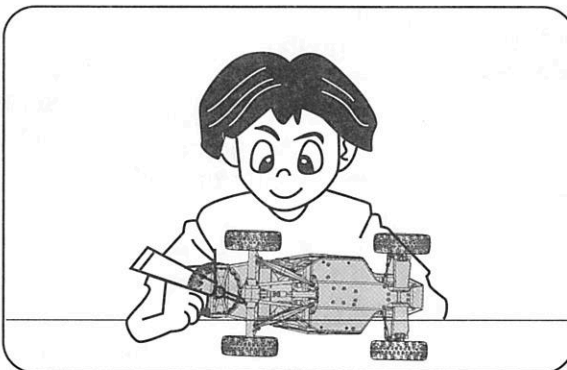

Metal outside should apply the rust prevention oil.

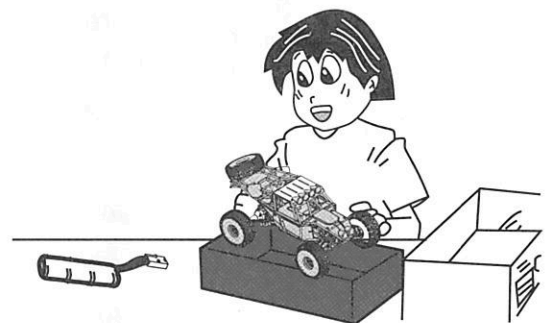

Store the car and batteries separately when not in use.

Assembly Exploded Diagram

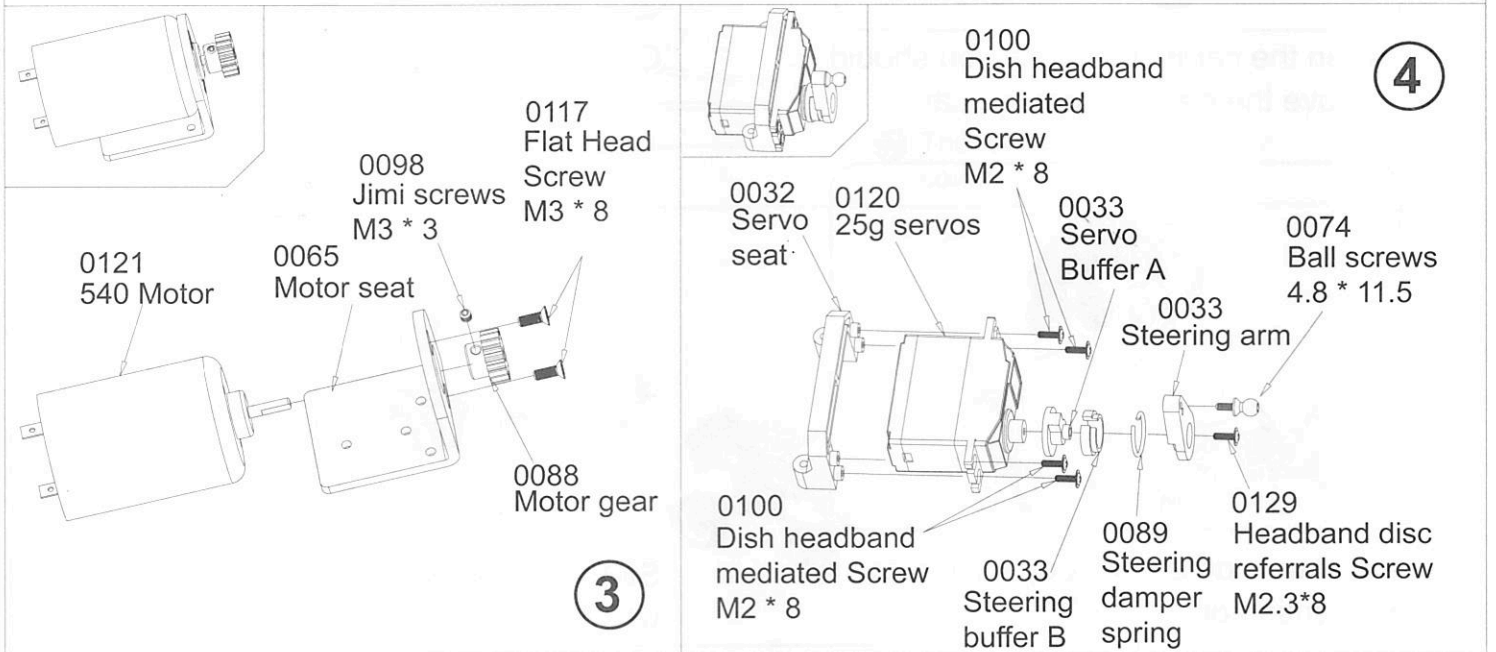
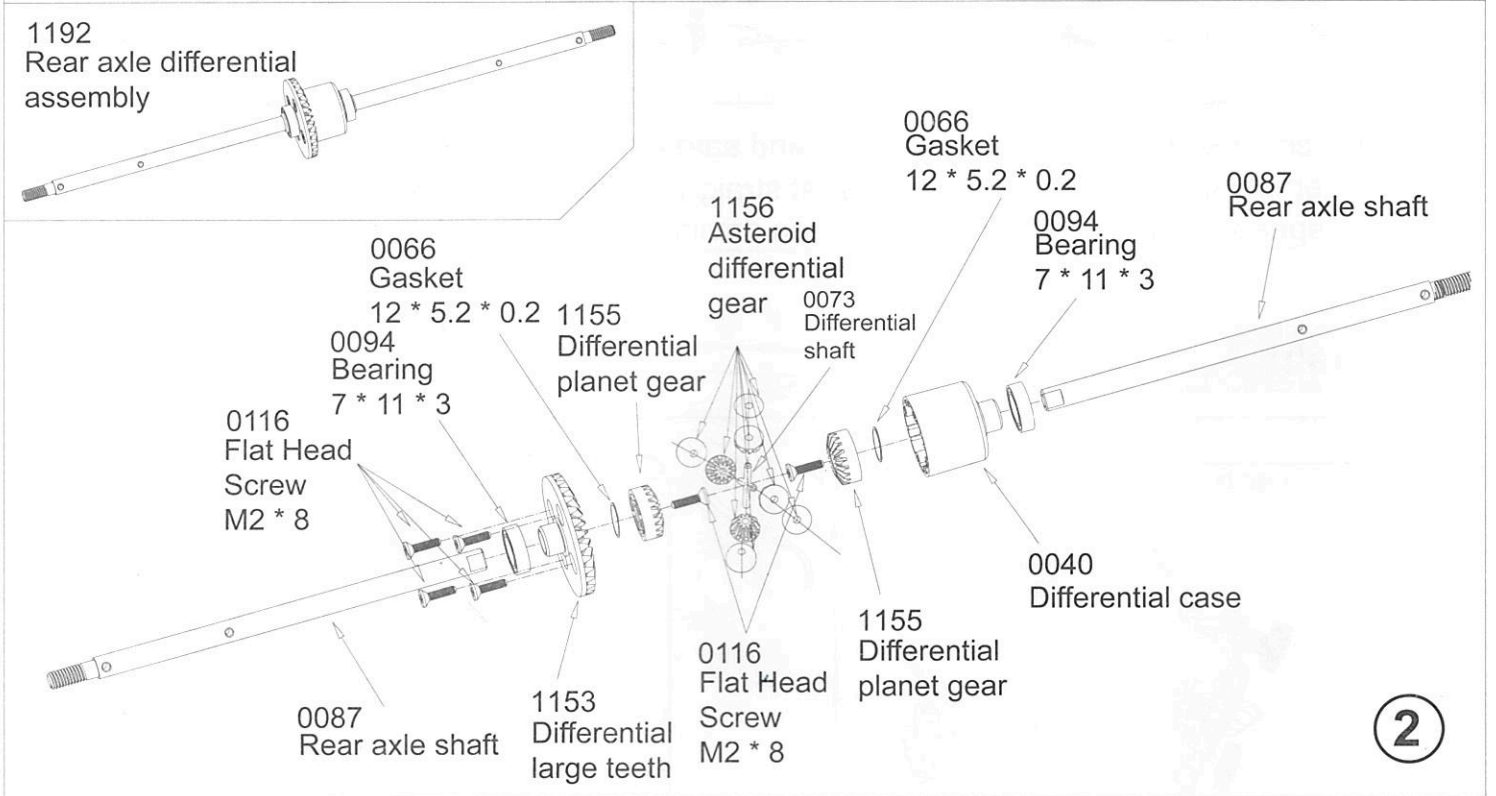
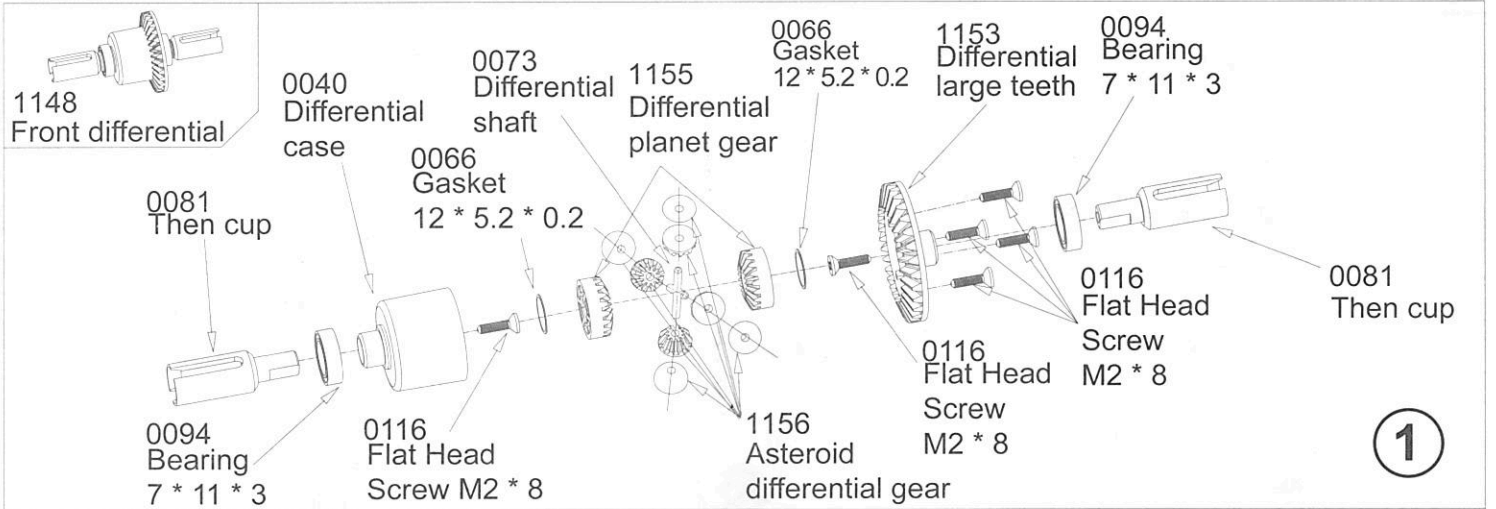

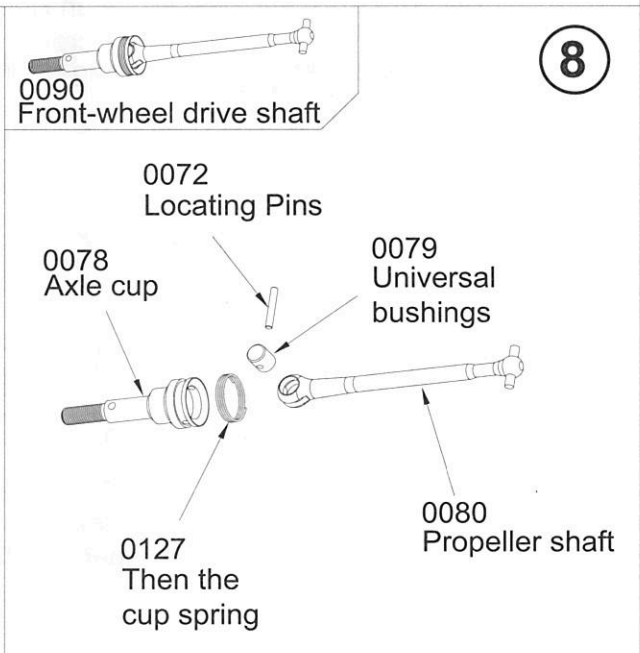
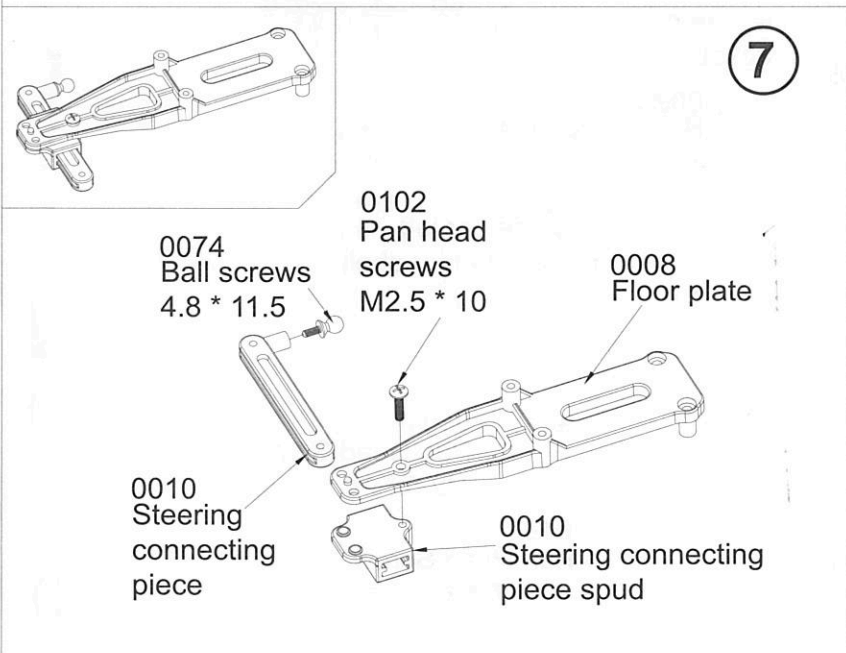
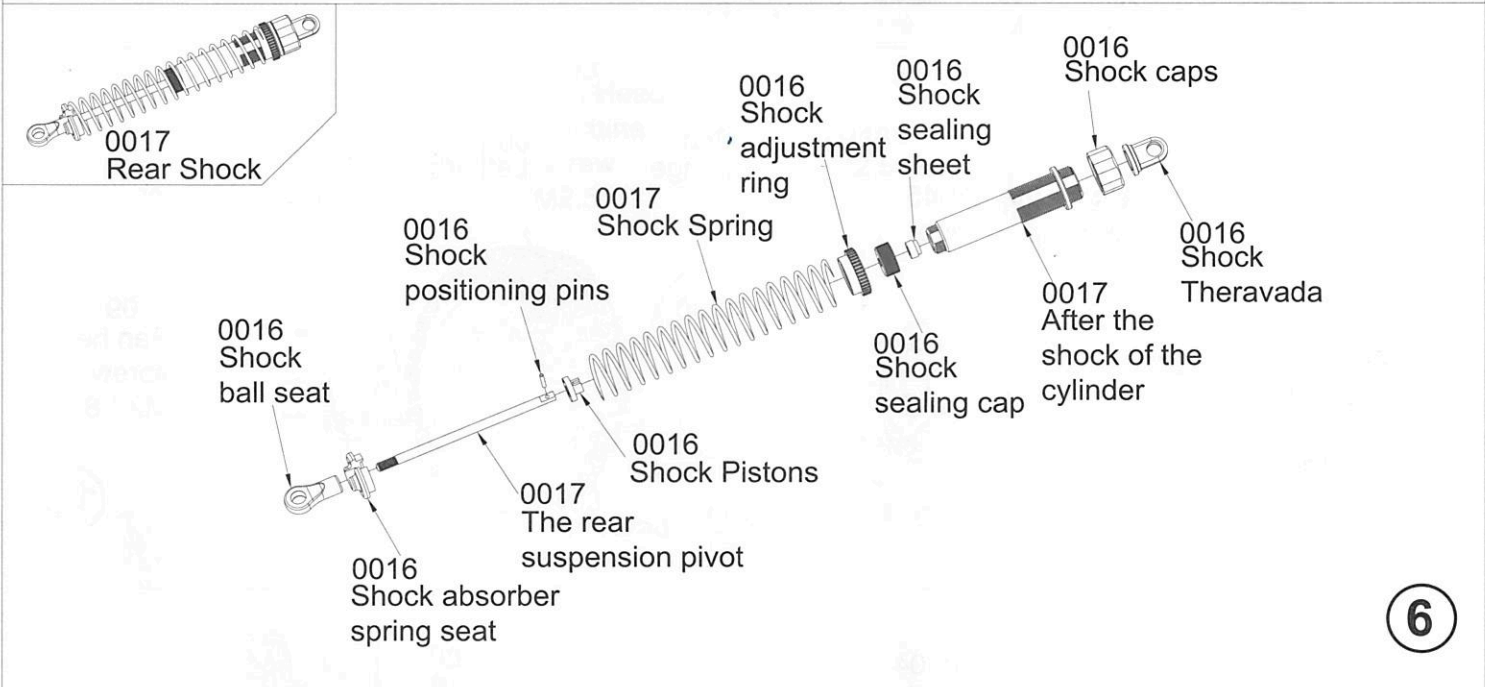
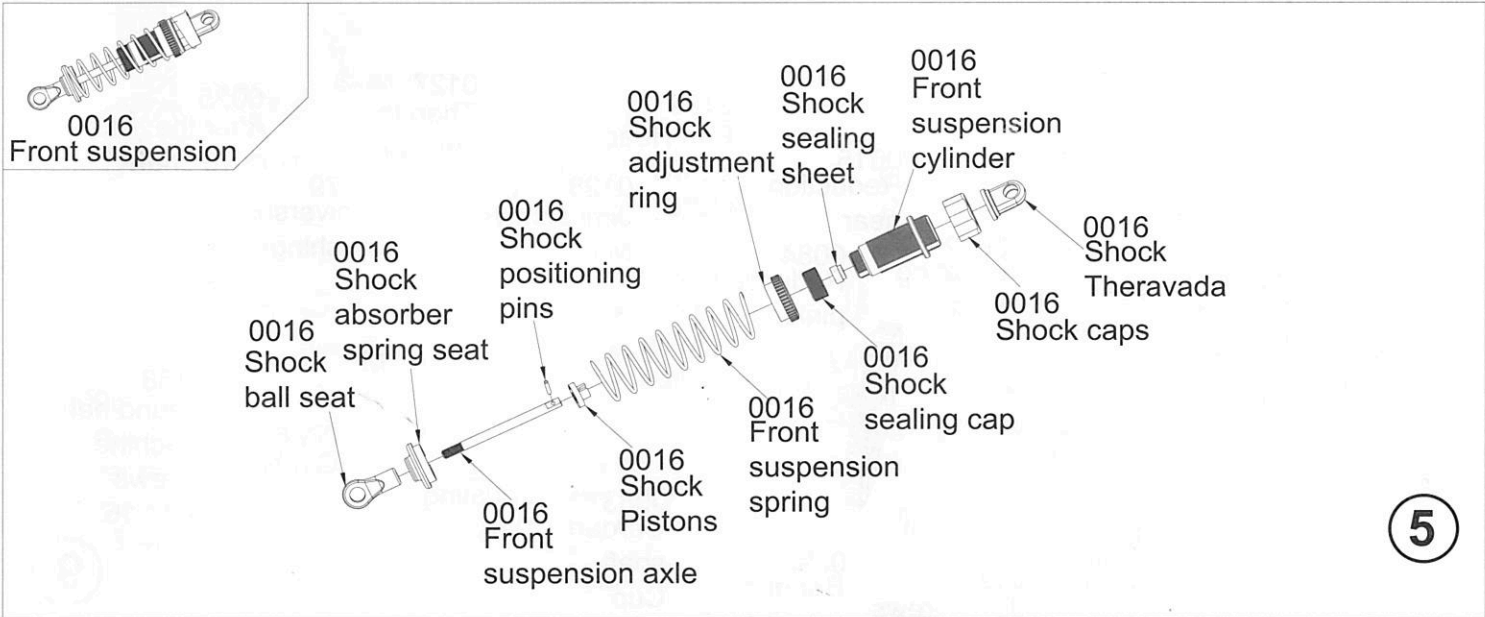

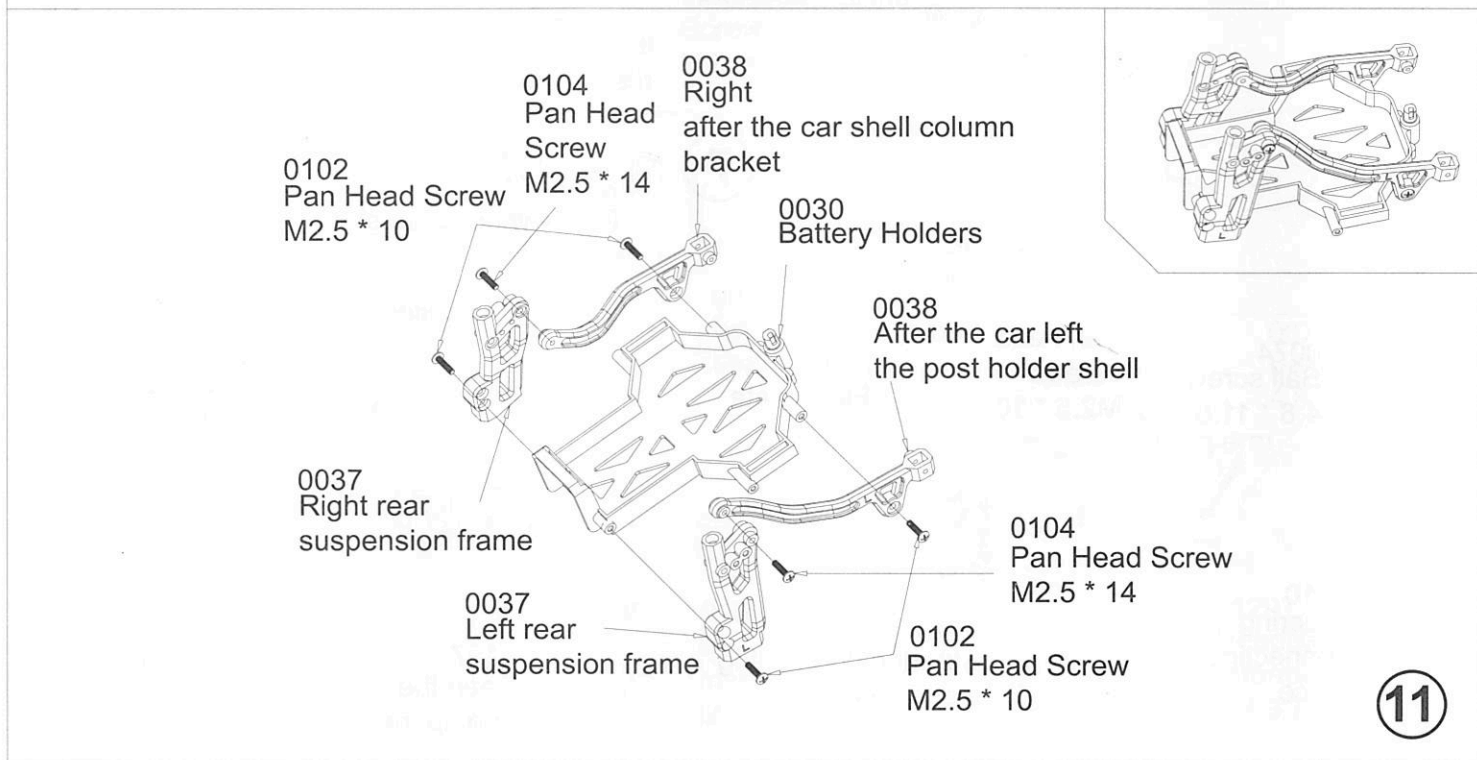
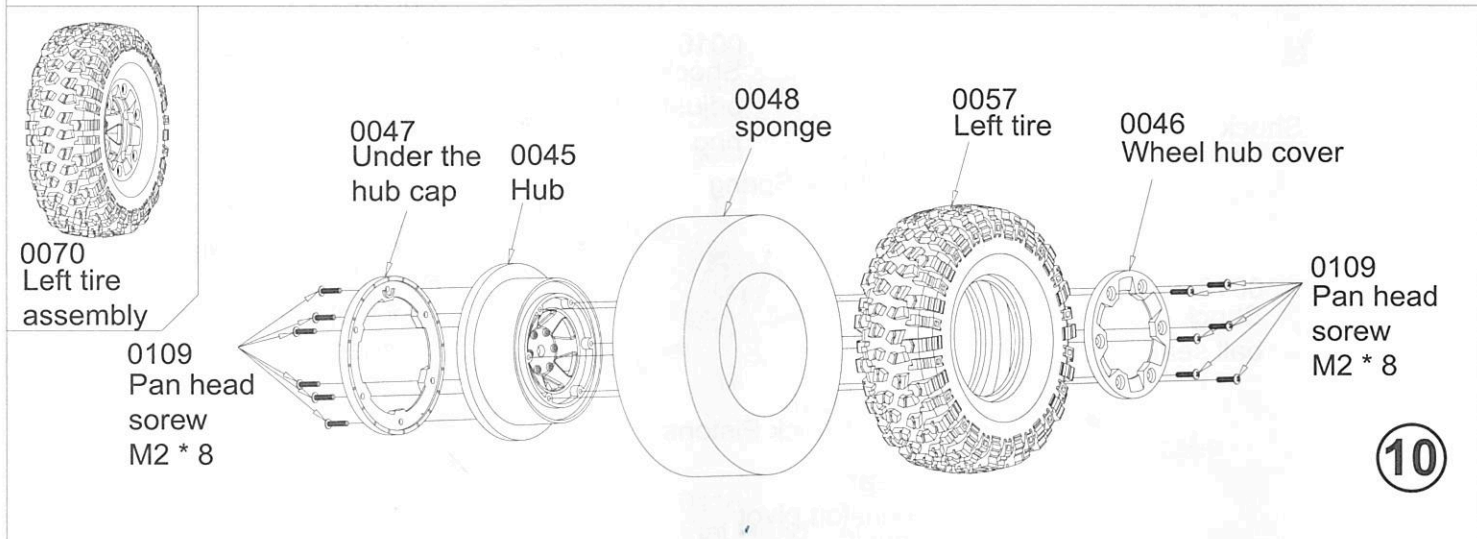
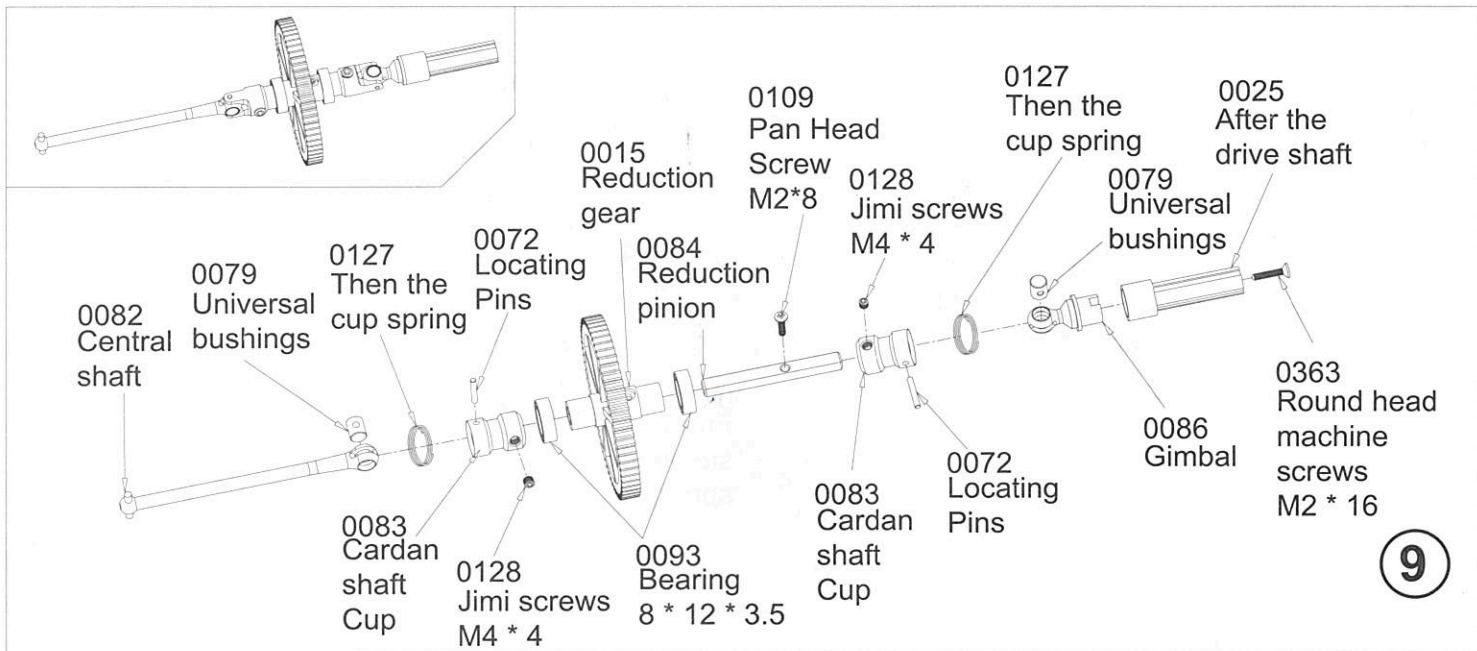

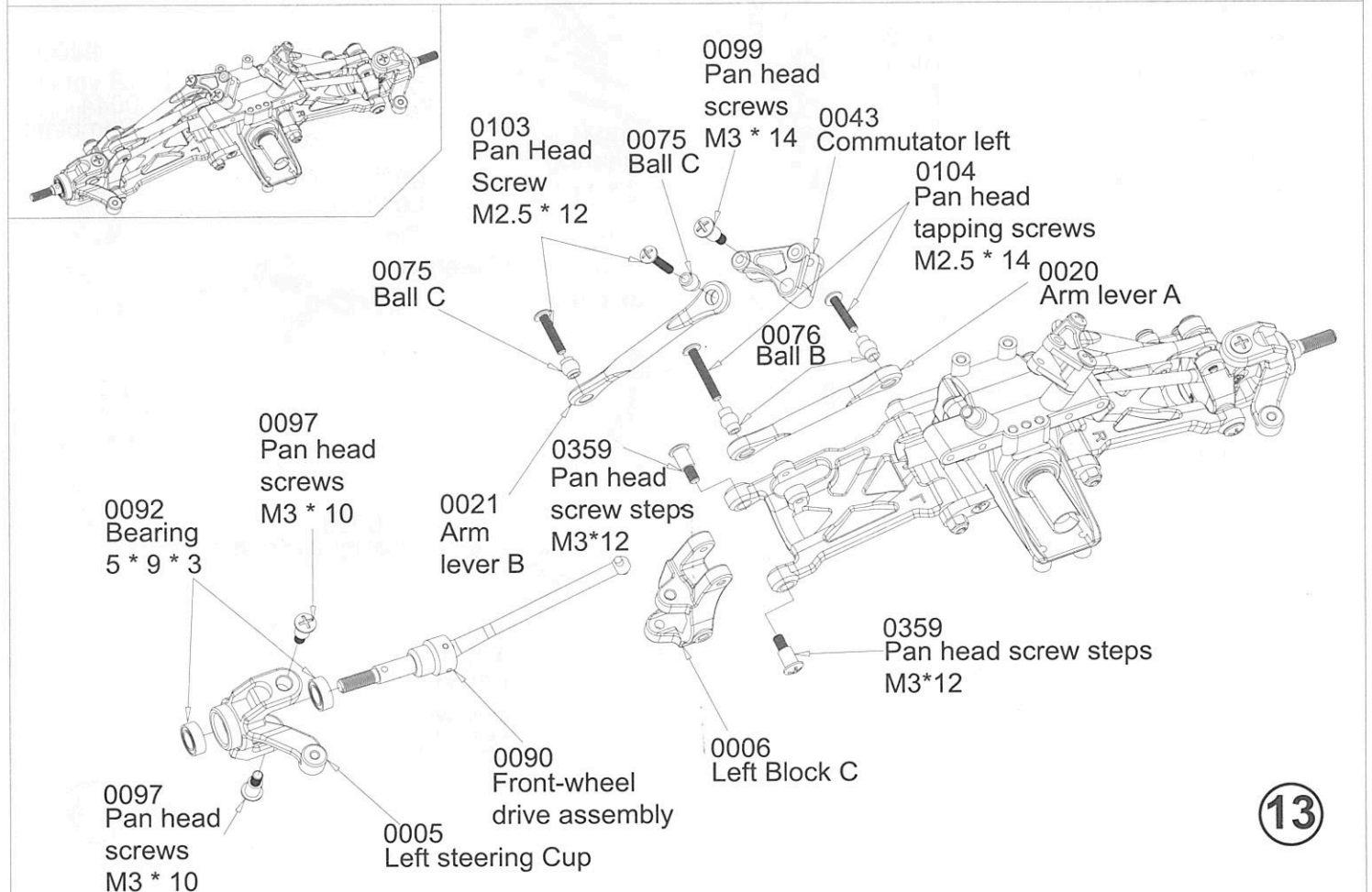
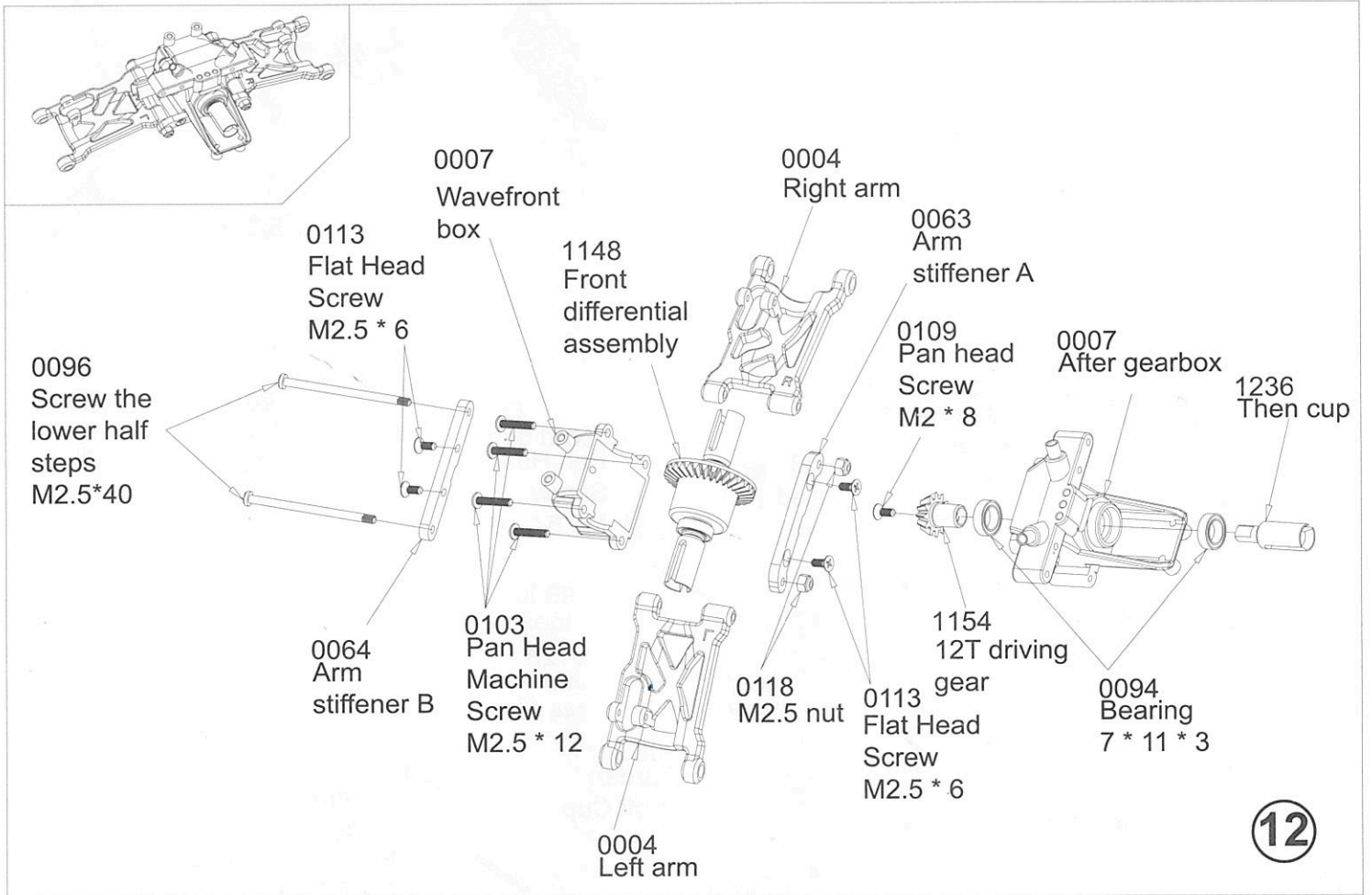

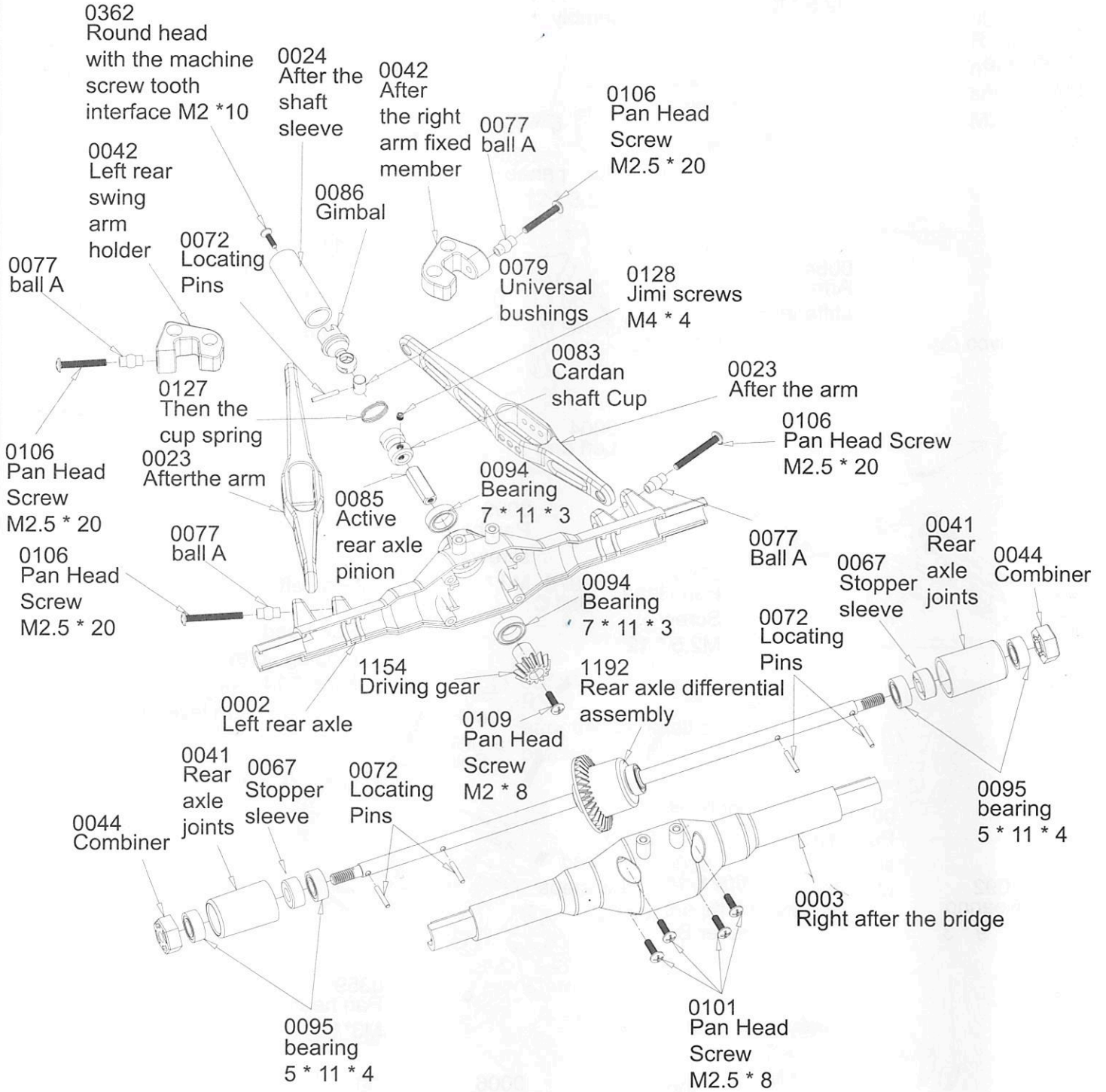
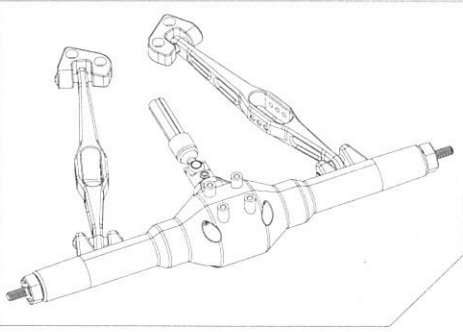

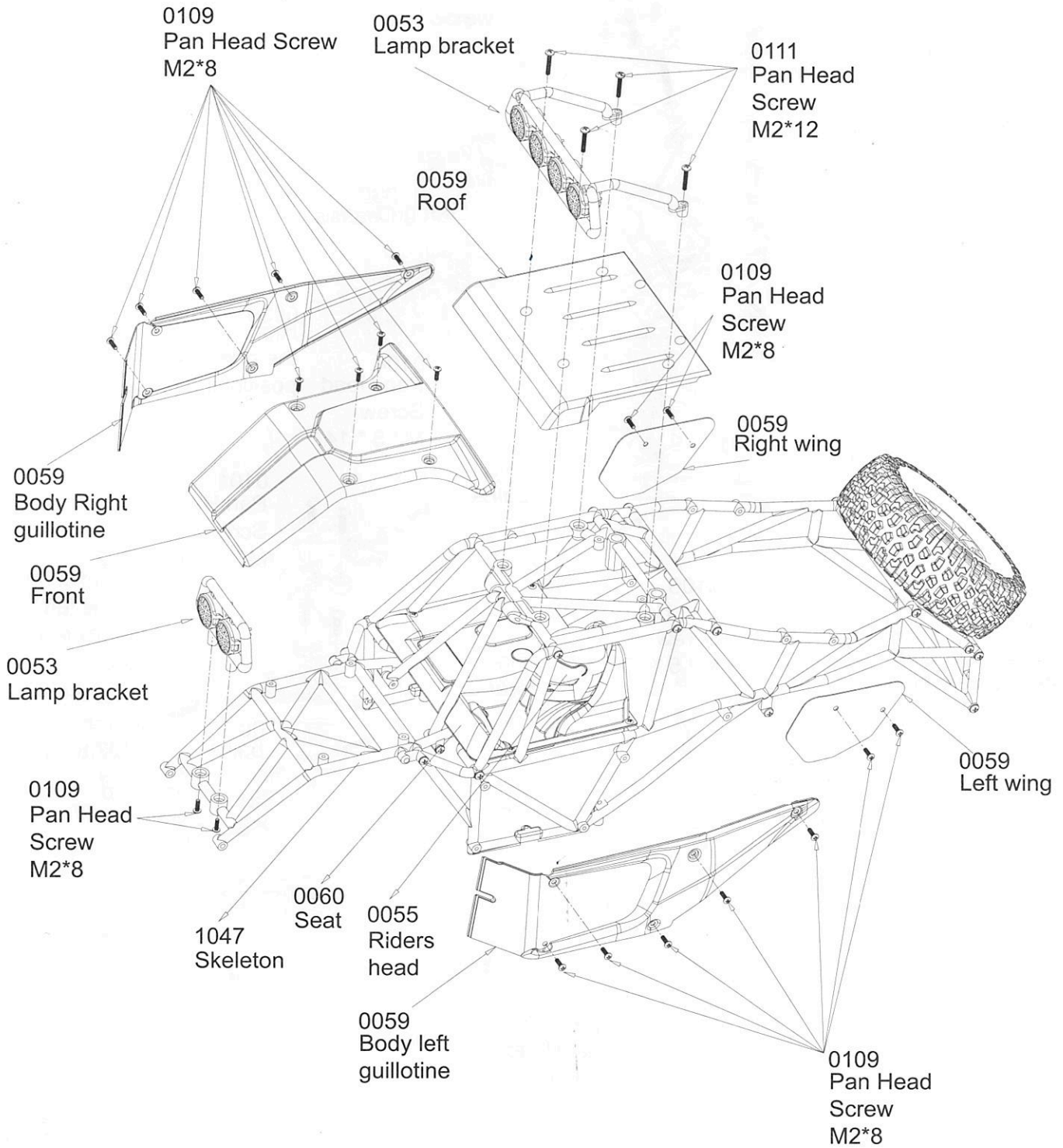
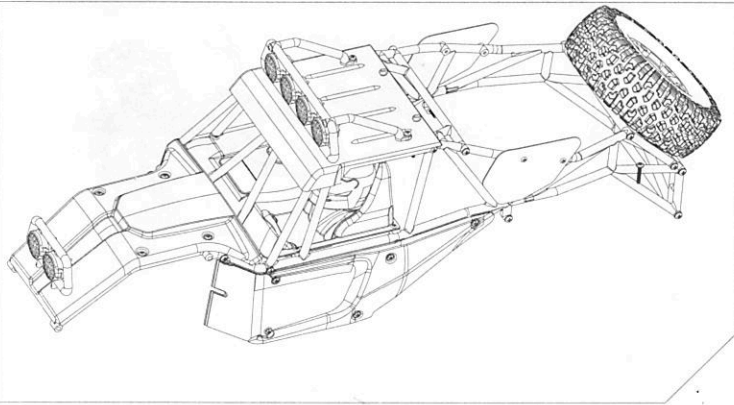

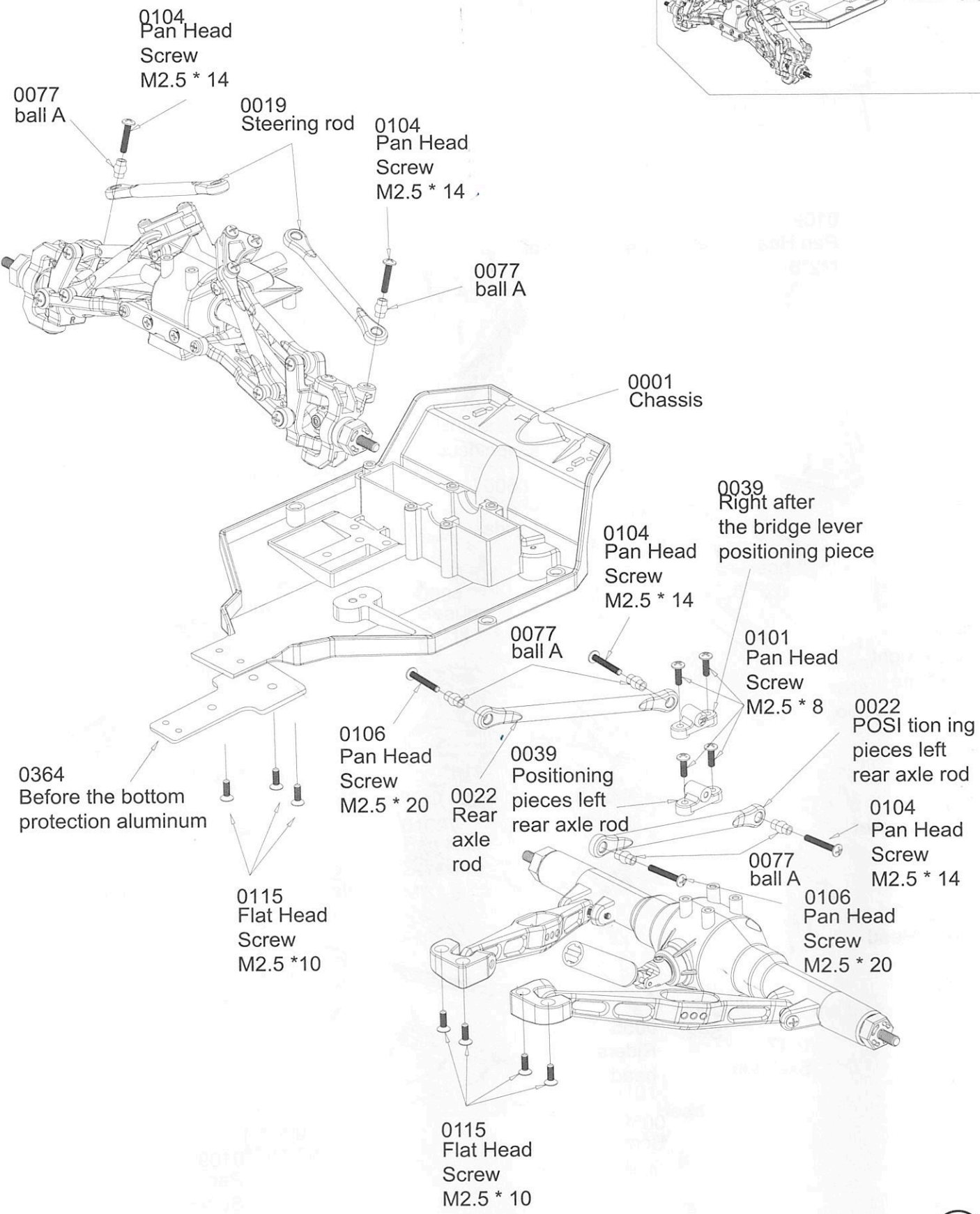

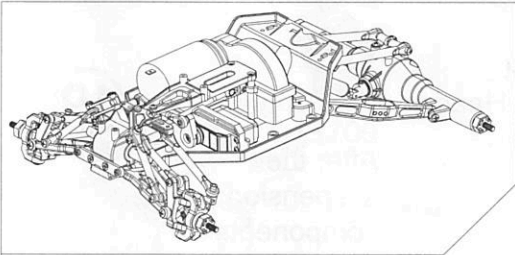

0105
Pan Head
Screw
M2.5 * 16

0102
Pan Head Screw
M2.5 * 10

0009
Dust cover

17

0108
Pan Head Screw
M3 * 7

0018
Steering rod

0114
Flat Head Screw
M2.5 * 8

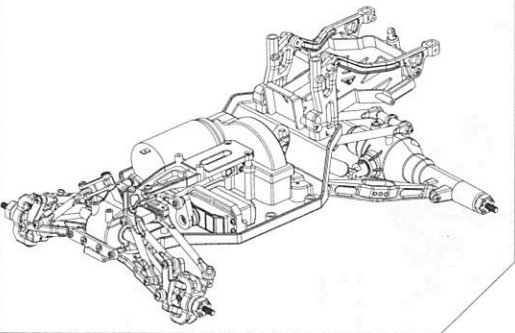

Battery holder assembly

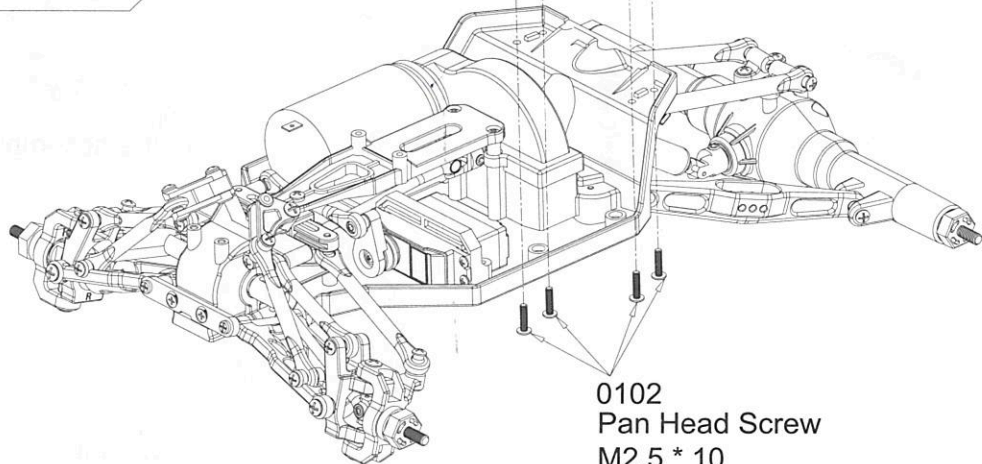

0102
Pan Head Screw
M2.5 * 10

18

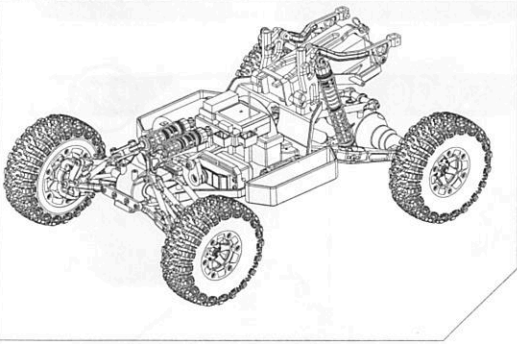

0062
Car shell folder

0031
Battery layering

0123
battery

0056
Circuit board

0069
Pan Head
Screw
M2*4

0100
Pan Head
Screw
M2*8

0056
switch

0068
Counterweight

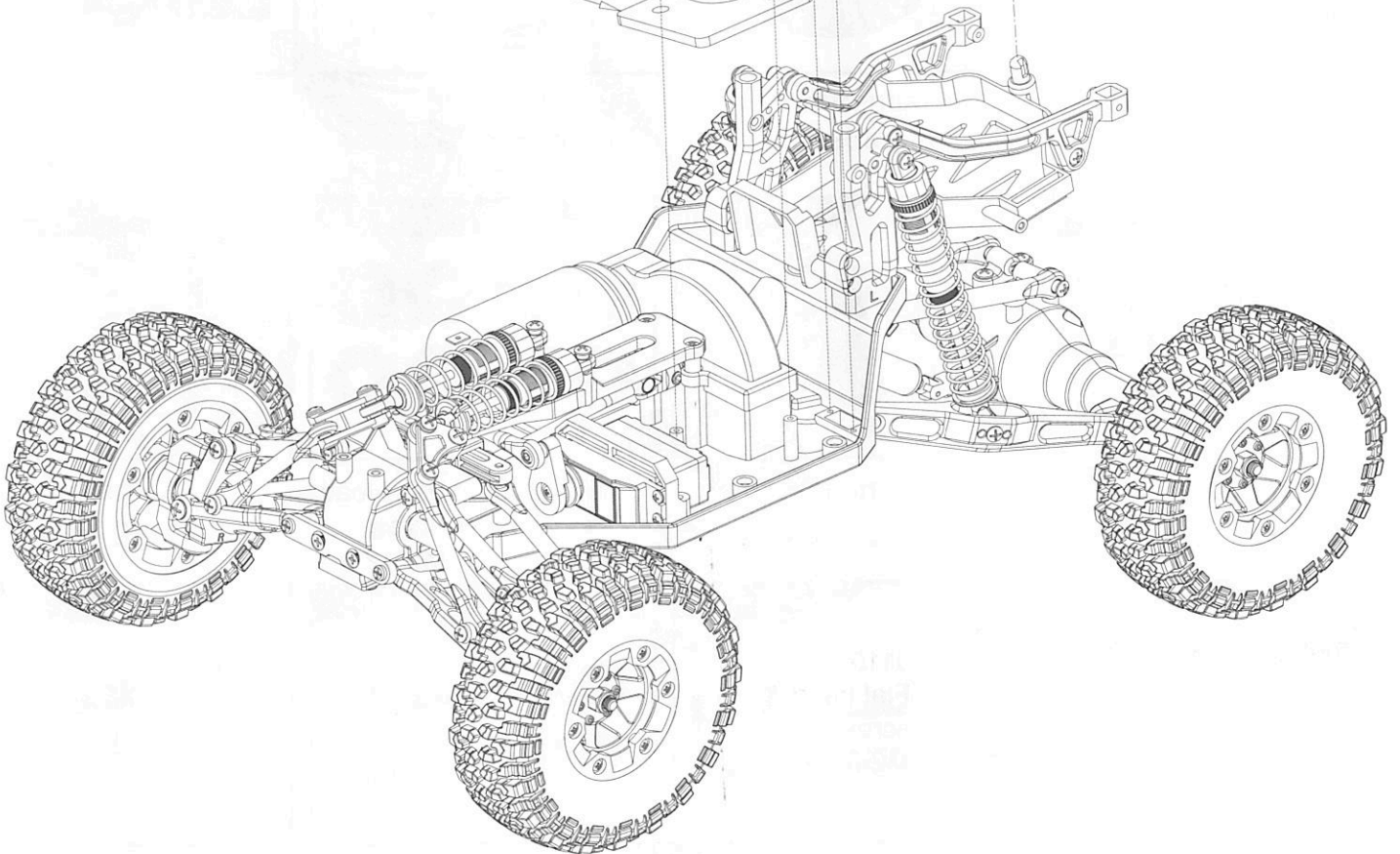

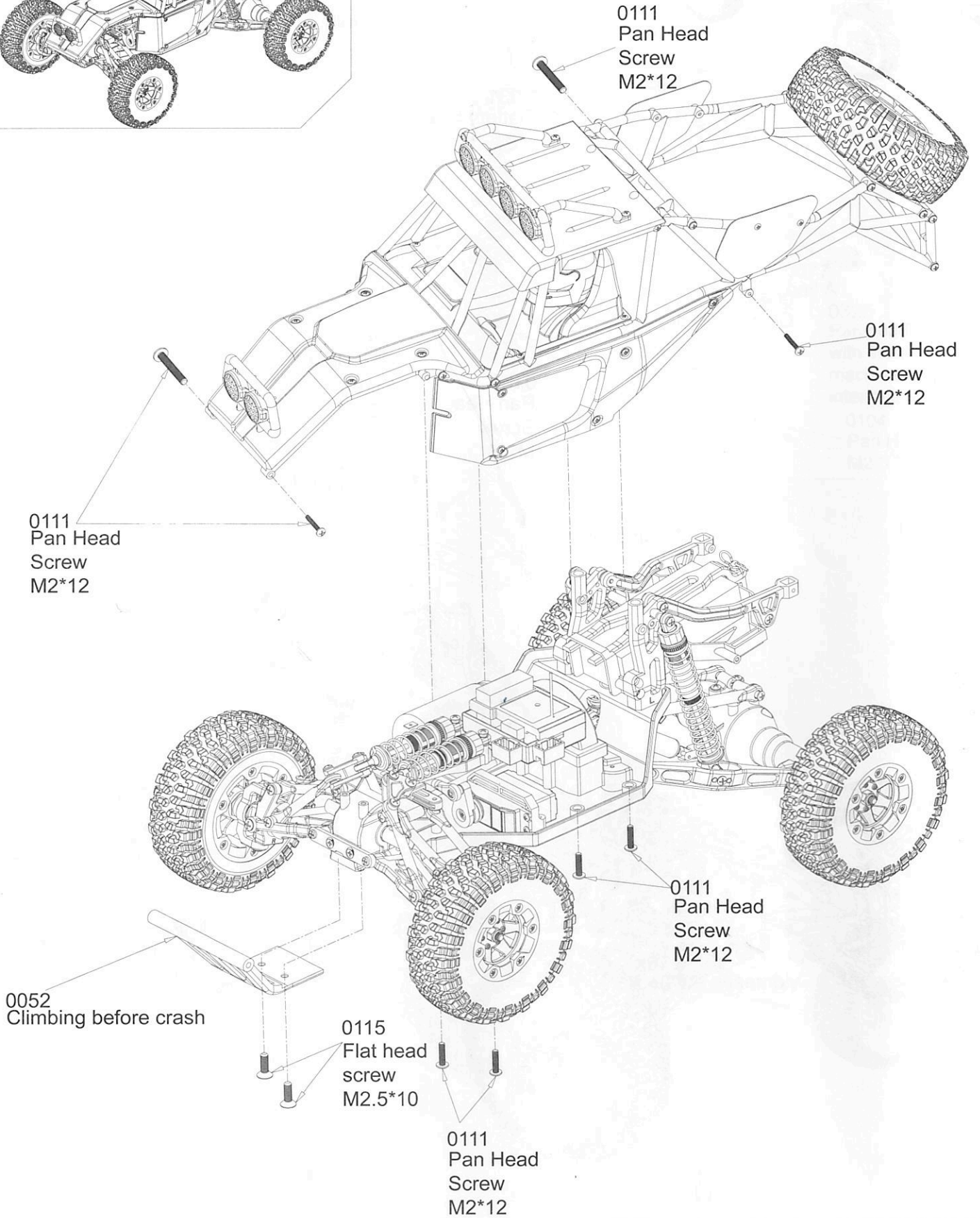
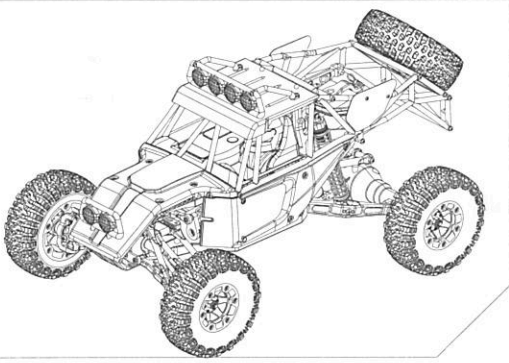

Sale parts view

0001

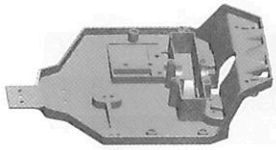

Chassis

0002



Left rear axle

0003



Right after the bridge

0004



Left/Right arm

0005



Left/Right steering Cup

0006



Left/Right Block C

0007

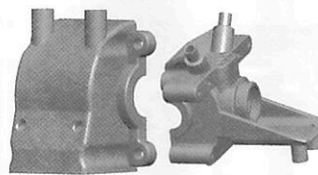

Wavefront box

0008



Floor board assembly

0009

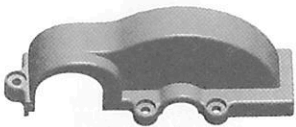

Dust cover

0010

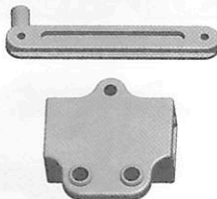

Steering connecting piece

1153



Differential planet teeth

1154



12T driving gear

1155



Differential planet gear

1156

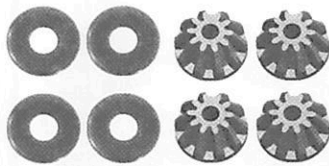

Asterold differential gear

0015

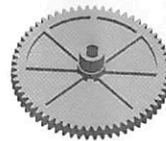

Reduction gear

0016



Front suspension

0017

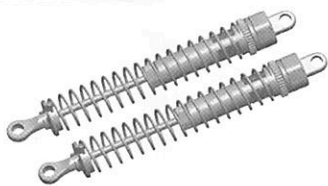

Rear Shock

0018

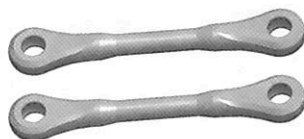

Steering rod

0019



Steering rod

0020



Arm leverA

Sale parts view

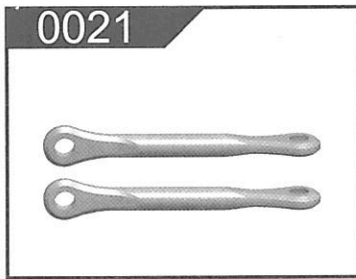

0021

Arm lever B

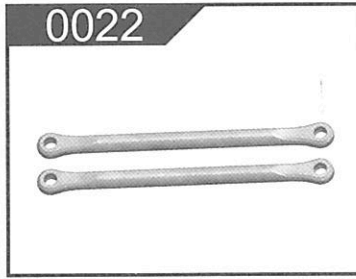

0022

Rear axle rod

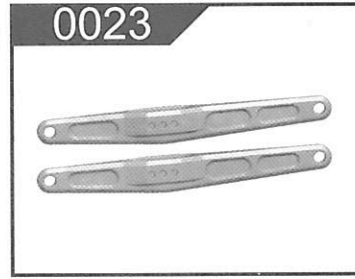

0023

After the arm

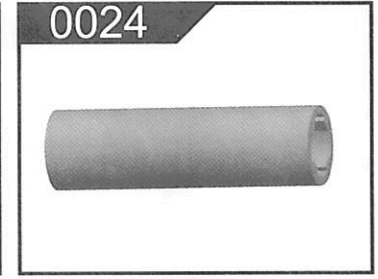

0024

After the shaft sleeve

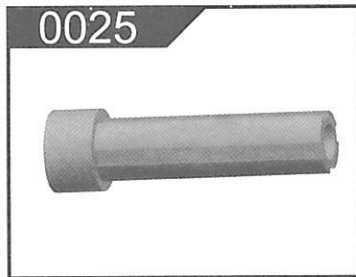

0025

After the drive shaft

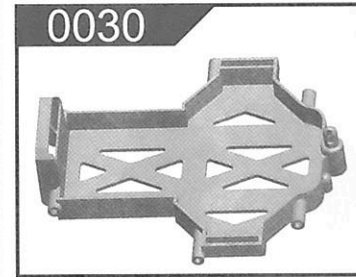

0030

Battery Holders

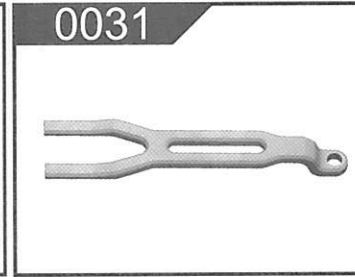

0031

Battery layering

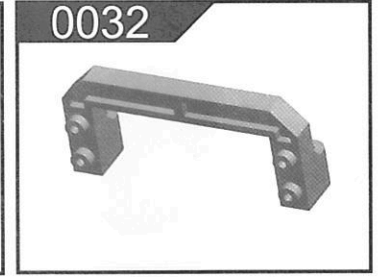

0032

Servo seat

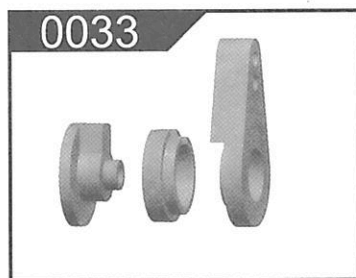

0033

Steering arm

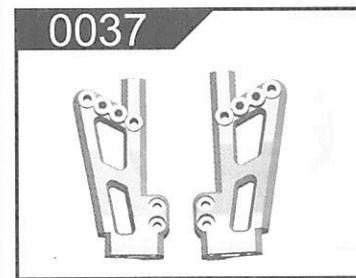

0037

Left/Right rear suspension frame

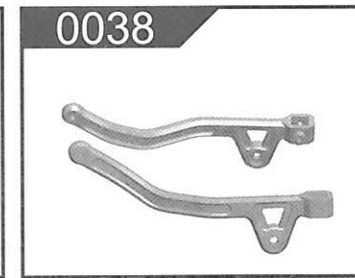

0038

Left/Right after the car shell column bracket

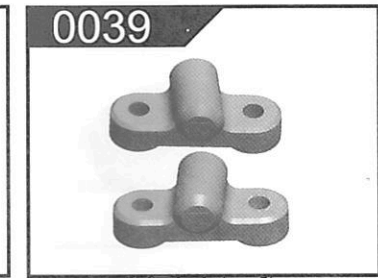

0039

Left/Right after the bridge lever positioning piece

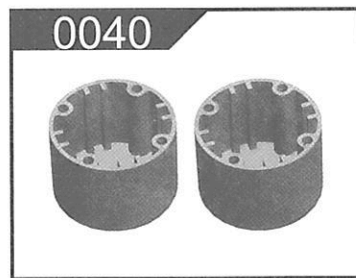

0040

Differential case

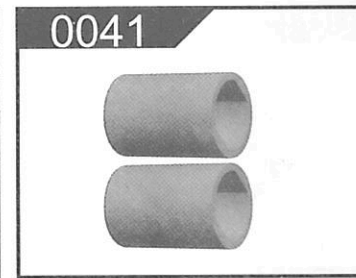

0041

Rear axle joints

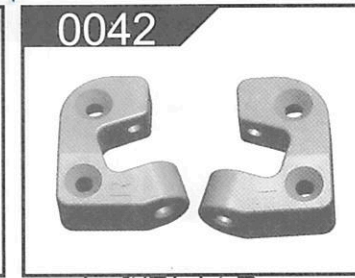

0042

Left/Right Rear swing arm holder

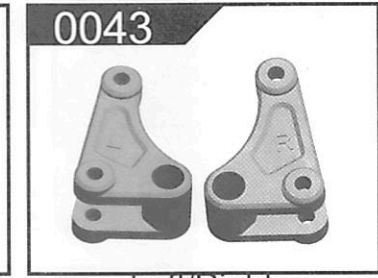

0043

Left/Right Commutator left

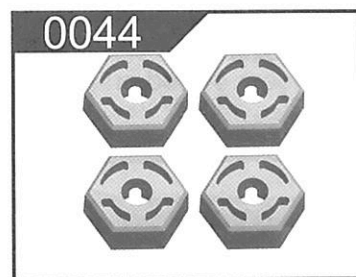

0044

Combiner

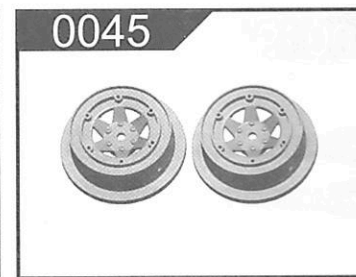

0045

Hub



0046

Wheel hub cover



0047

Under the hub cap

Sale parts view

0048

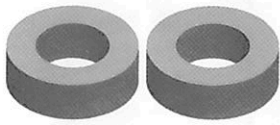

Sponge

1236

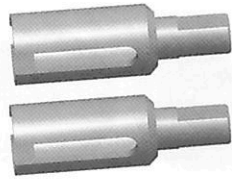

Differential Connecting Cup

1047



Rollcage Right

0364



Before the bottom protection aluminum

0052

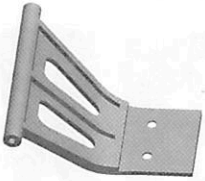

Climbing before crash

0053

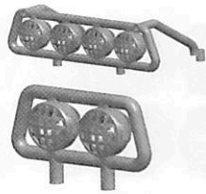

Headlight

0359



Pan head screw steps M3*12

0055



Riders head

0056

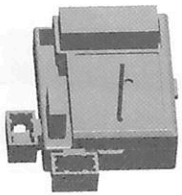

Circuit board

0057



Left tire

0058



Right Tire

0059

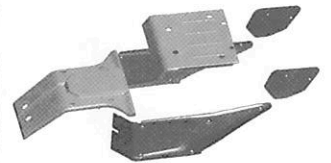

Body guillotine

0060

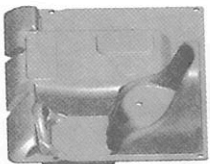

Seat

0062

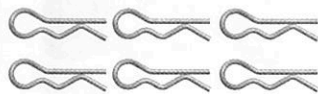

Car shell folder

0063



A swing arm stiffener

0064



Arm strengthen slice B

0065

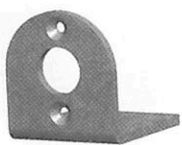

Motor seat

0066

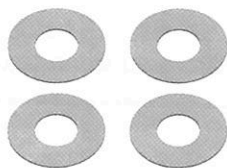

Gasket 12 * 5.2 * 0.2

0067

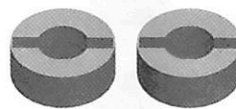

Shock adjustment ring

0068



Shock adjustment ring

Sale parts view

0069



M2 * 4 screws

0070



Left tire assembly

0071



Right tire assembly

0072



Locating Pins

0073



Differential shaft

0074



Ball screws 4.8*11.5

0075

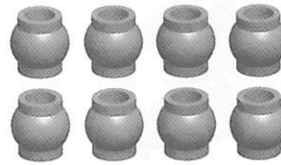

Ball C

0076

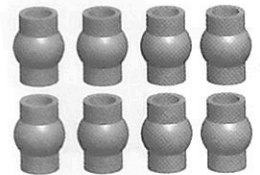

Ball B

0077

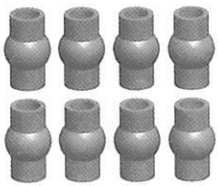

Ball A

0078

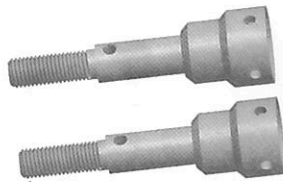

Axle cup

0079



Universal bushings

0080

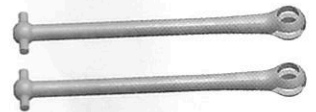

Propeller shaft

0081

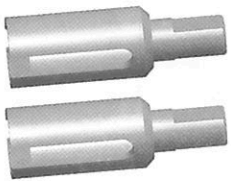

Differential Connecting Cup

0082



Central shaft

0083

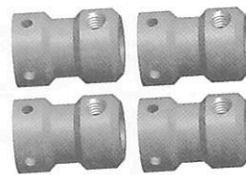

Cardan shaft Cup

0084



Reduction pinion

0085



Active rear axle pinion

0086



Gimbal

0087



Rear axle shaft

0088

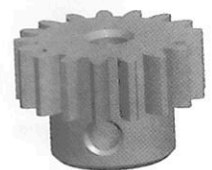

Motor gear

Sale parts view

0089



Steering damper spring

0090



Front-wheel
dive shaft

1148



Front differential

0092



Bearing 5*9*3

0093



Bearing 8*12*3.5

0094



Bearing 7*11*3

0095

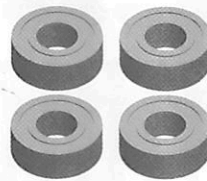

Bearing 5 * 11 * 4

0096



Screw the lower
haft steps M2.5*40

0097

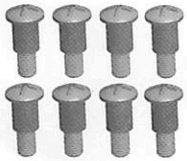

Pan head screws
M3*10

0098



Jimi screws
M3*3

0099

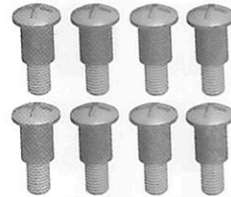

Pan head screws
M3*14

0100



Dish headband
mediated M2*8

0101



Pan Head Screw
M2.5*8

0102



Pan Head Screw
M2.5*10

0103



Pan Head Screw
M2.5*12

0104



Pan Head Screw
M2.5*14

0105

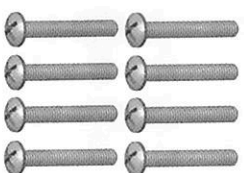

Pan Head Screw
M2.5*16

0106



Pan Head Screw
M2.5*20

0107



Pan Head
Screw M4*12

0108



Pan Head Screw
M3*7

Sale parts view



0109

Pan Head Screw
M2*8

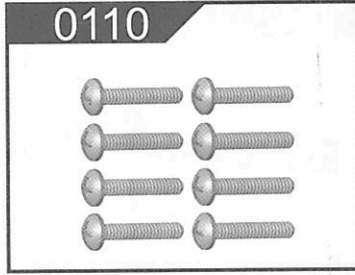

0110

Pan Head Screw
M2*10

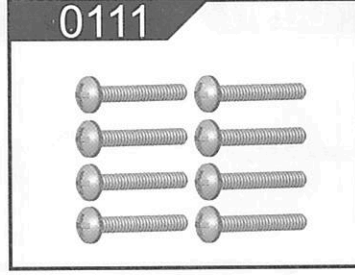

0111

Pan Head Screw
M2*12

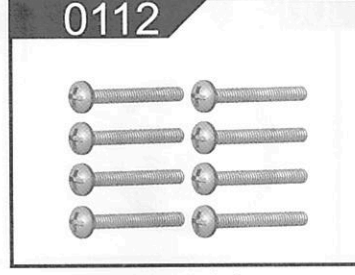

0112

Pan Head Screw
M2 * 20

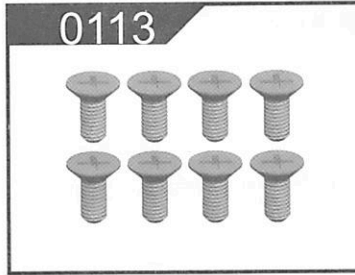

0113

Flat Head Screw
M2.5*6

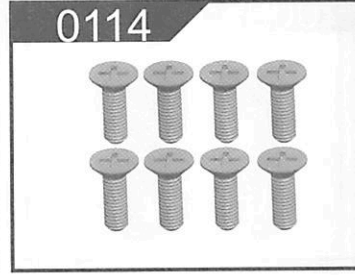

0114

Flat Head Screw
M2.5*8

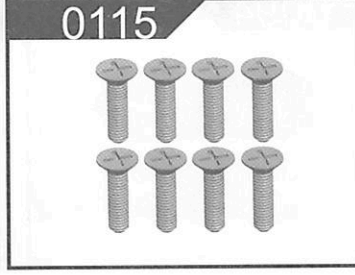

0115

Flat Head Screw
M2.5*10

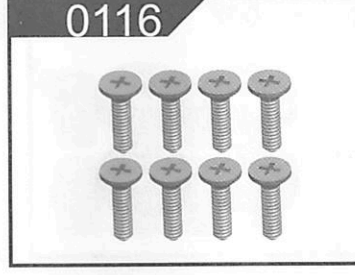

0116

Flat Head Screw
M2 * 8



0117

Flat Head Screw
M3*8

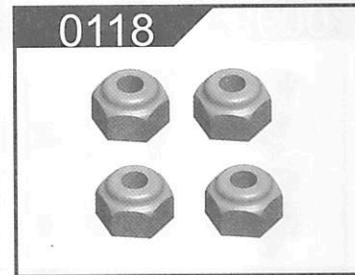

0118

M2.5 nut

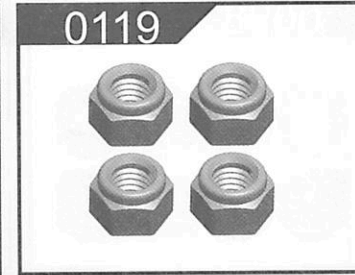

0119

M4 nut

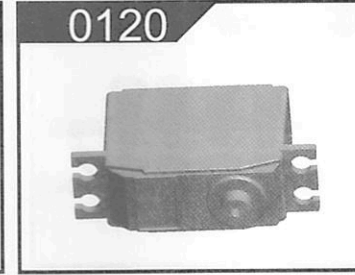

0120

25g servos

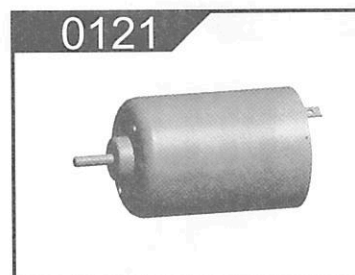

0121

540 Motor

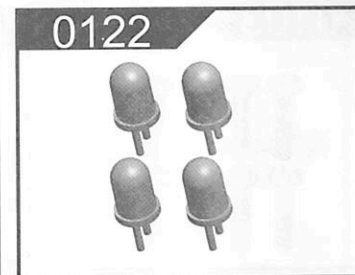

0122

Headlight



0123

Battery

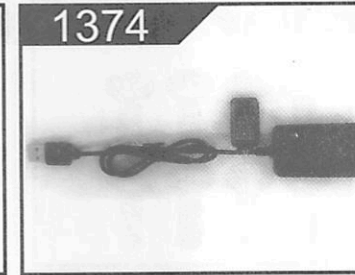

1374

Charger



0125

Medium plate headband
M2.5*8

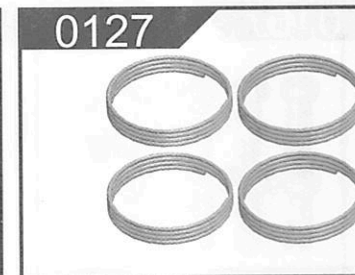

0127

Then the cup spring



0128

Jimi screws M4 * 4

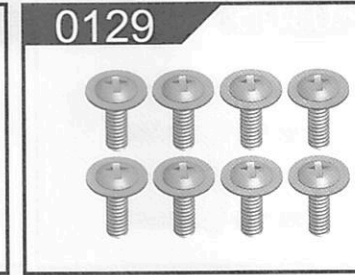

0129

Headband disc
referrals Screw M2.3*8

Sale parts view

0131

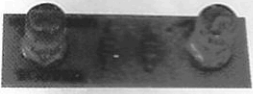

Climbing car headlights

0132



Climbing car headlights

1192



After the differential component

0325



Pan head with dielectric tooth machine screws
M2.5 * 16

0343



remote control

0362

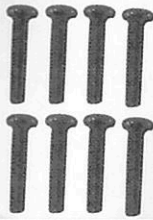

Round head with the machine screw tooth interface
M2*10

0363

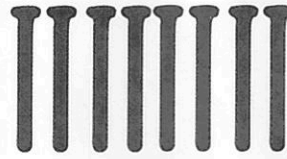

Round head machine screws
M2*16