

1:10 Electric 4WD Climbing car



Caution: This model is not a toy, it is designed for user over 14 years of age.
Please use this instruction and the R/C system instruction at the same time.
The instruction is suitable for a type of model whose number is 104009

Safety and caution	1-2
Troubleshooting • Product introduction	2-3
Instruction of common tools and installation the electronic part...	4-5
Practice and maintenance.....	5-7
Assemble exploded view	8-17
Fittings view	18-22

Safety and Cautions

- *Never run the model on public roads or streets, as it could endanger traffic.
- *Never run the model in crowded areas, near or toward people or animals, to prevent property damage and/or personal injury.
- *Never run the model near rivers, ponds or lakes as to prevent R/C car from dropping into the water.
- *Make sure that no one else is using the same frequency as yours in your running area. Using the same frequency at the same time, whether it is driving, flying or sailing, can cause loss of control with R/C model, resulting in serious accidents.
- *To avoid a runaway R/C model or loss of control, always follow the procedure below:
 1. Fully extend transmitter antenna.
 2. Switch on transmitter.
 3. Switch on R/C model.
- *Follow reverse procedure to shut down.
- *Never touch or hinder rotating tire.
- *Never run R/C model in the rain or let run over puddles, as water may cause trouble with R/C model.
- *Motor and battery get very hot after running. Take care when handle them.
- *Retract transmitter antenna when not in use.
- *Remove the batteries from model and transmitter when they are not in use.

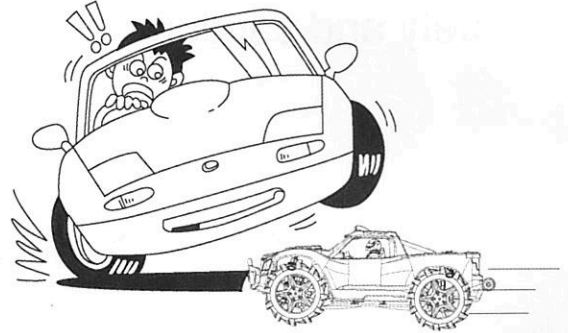

Cautions when handling batteries

- *Do not dismantle the battery or charger and do not cut any battery cables. This may cause short-circuit and/or damage to the product.
- *Change battery with compatible charger following proper procedure that is called out in the instructions. Do not modify charger or charge battery in improper way.
- *Do not recharge battery that is still warm from use as it may damage the battery. Allow the battery to cool off prior to recharging.
- *Make sure to disconnect charger cables from R/C model and electric outlet when not in use.
- *Remove transmitter battery when not using it for a long time as it may leak and damage transmitter when left for a long period.
- *Never incinerate used batteries, as they can explode causing serious accidents.



Safety precautions

Do not operate the model on public roads, in crowded places or near infants, it may cause accidents or injury.

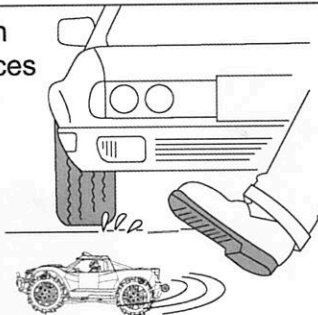

As the product includes small and sharp parts, assemble and store this product only in places out of the reach of children.



As the front end of the antenna may be dangerous, do not aim it toward faces.



During the car running and after, the motor will be hot. Please do not touch it until it has had time to cool down.



Don't use the same frequency with others at the same time. Or the car will lose control or even lead to serious accidents.

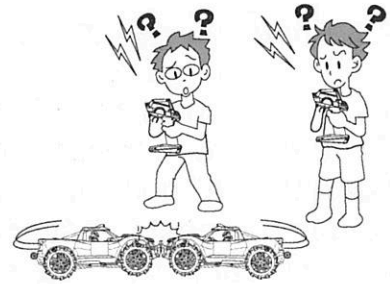

Troubleshooting

Description	Cause	Solution
The car does not operate at all.	Transmitter or receiver is off.	Turn on both transmitter and receiver.
	Batteries are not placed properly in the transmitter.	Place batteries in the transmitter properly.
	The drive battery is not charged enough.	Charge the drive battery.
The car does not follow your operation and control distance not enough long.	Someone else is using the same radio frequency as you are using.	Charge your radio frequency to the one no one else is using, wait until the driver using the same radio frequency finishes driving, or drive your car at a different place.
	There is not enough power in the transmitter or receiver batteries.	Replace the transmitter batteries with new ones and charge the drive battery.
	Not tighten antenna on the transmitter/not fully extend antenna.	Make sure insert antenna into the transmitter and fully extend antenna.



CAUTION

- * Please observe the operation manual or packing explanation to install and use, and some parts should be installed by adults.
- * The product contains small parts, it may cause swallow or choke.
- * Never run an R/C model in the seep or rain, moisture areas, or it may cause the parts malfunction.
- * Please throw the wrapper in time to avoid danger for the children.
- * Regularly examine for damage to the charge, wire, plug, bodyshell or other parts. In the event of any damage, it must not be used until the damage has been repaired.
- * The charge, battery box and battery must insert with the appointed power source of product symbol same.
- * This product must only be used with the original collocation charger.
- * The product is contains the functional outshoots are may be dangerous to the children.

- * Apart the charger and toy before clean.
- * As the front end of the antenna may be dangerous, do not aim it toward anyone's body, face or eyes.
- * Batteries are to be inserted with the correct polarity.
- * Use the "AA" non-rechargeable or "AA" rechargeable batteries.
- * Non-rechargeable batteries are not to be recharged.
- * Rechargeable batteries should only be charged under adult supervision.
- * Rechargeable batteries must be removed from model before charger.
- * Different types of batteries or old and new batteries are not to be mixed.
- * Exhausted batteries are to be removed in time.
- * The supply terminals are not to be short-circuited.
- * Never short circuit the batteries. throw it in a fire or attempt to open their outer casings.
- * Please remove the batteries when not in use.
- * Please retain these instructions for future reference.

Product Introduction

- ★ Type: 1:10 Electric 4WD Climbing car
- ★ Product size: 380*275*195mm
- ★ Wheelbase: 230mm
- ★ The minimum distance of front and rear wheel: 125mm
- ★ Ground clearance: 50mm
- ★ Transmission ratio: 1:10.28
- ★ Tire diameter: 105MM; wheel width: 52mm
- ★ ESC receiving server: three in one circuit
- ★ Motor: 550 brush motor
- ★ Remote control: 2.4G Remote control
- ★ Remote control distance: ≥100M
- ★ Remote control battery: 4AA batteries (not included)
- ★ Battery: Lithium battery 7.4V 1500 mAh
- ★ Charger: lipo balance
- ★ Charging time: 3 hours
- ★ Use time: 8 minutes
- ★ Server: 6kg servos
- ★ Car shell: antiknock PVC printing car shell, beautiful Crashworthiness
- ★ Driving speed: 45km/h.

Proportional R/C Using Instruction

- ① Turn left the steering wheel, the car will turn left. Turing left angle can be adjusted by the degree of wheel twisting.

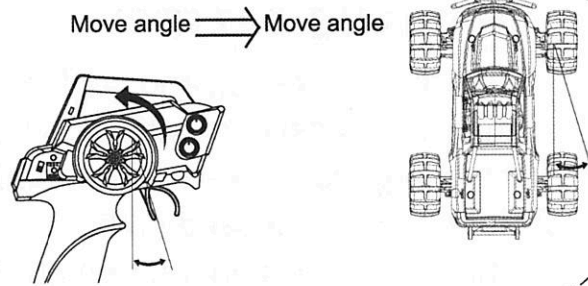

- ② Turn right the steering wheel, the car will turn right. Turing right angle can be adjusted by the degree of wheel twisting.

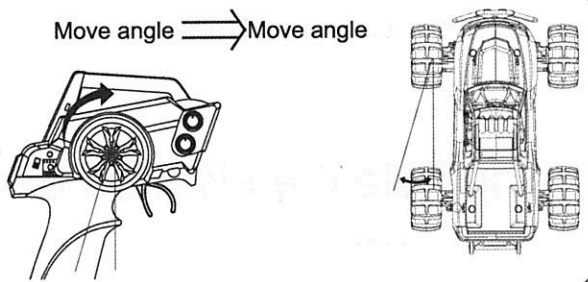

- ③ Pull the throttle trigger backward, the car will forward. Adjusting the angle of throttle trigger can adjust forward speed of the car. During the car forward, quickly push the trigger forward to stop it.

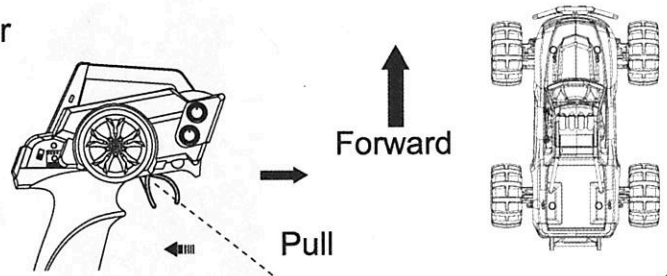

- ④ Loosen the trigger to make it return the neutral position when brake. Push the throttle trigger forward, the car will backward. Adjusting forward angle of throttle trigger adjust backward speed of the car.

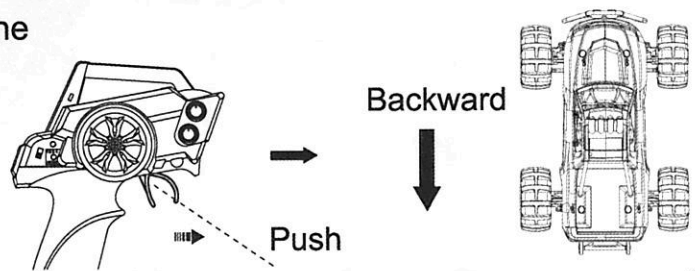

Introduce the common tools and assemble the electron parts

Tools needed for assembly

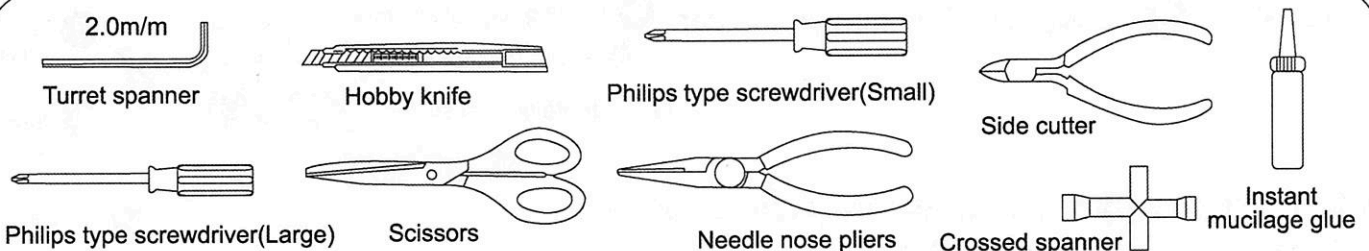

Charge caution

CHARGING BATTERY

- 1) Please firstly check and confirm input voltage of the charge is consistent with local voltage, output voltage of the charge is consistent with battery voltage.
- 2) Battery must be used up before you charge, Charging time is not more than 3 hours.
- 3) Be careful to make sure there is adult to control when charging.

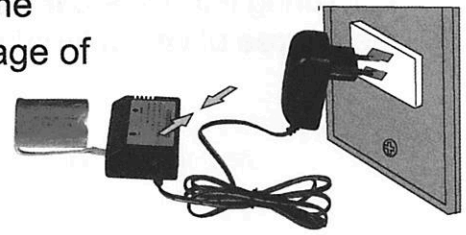

Assemble the electron parts

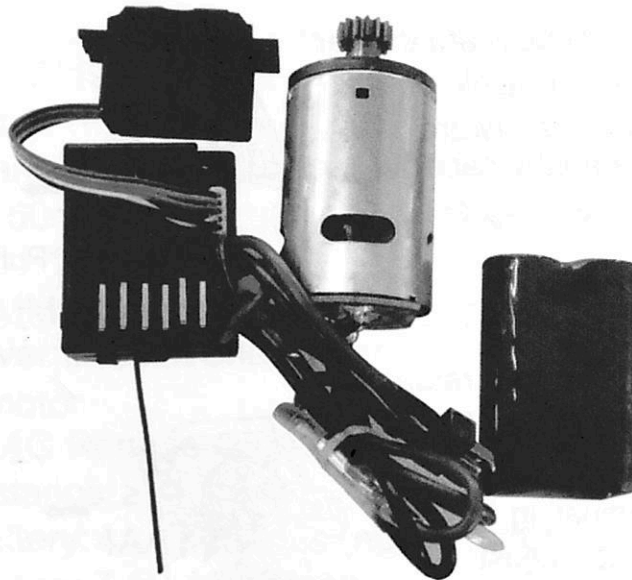

PRACTICE AND MAINTENANCE

Operating program

1> Turn on the switch ① of transmitter and make sure the power indicator is ② steady light, then turn on the car.

2> Slip the trigger ③ of transmitter slowly, you can observe the car whether it can go ahead or go back.

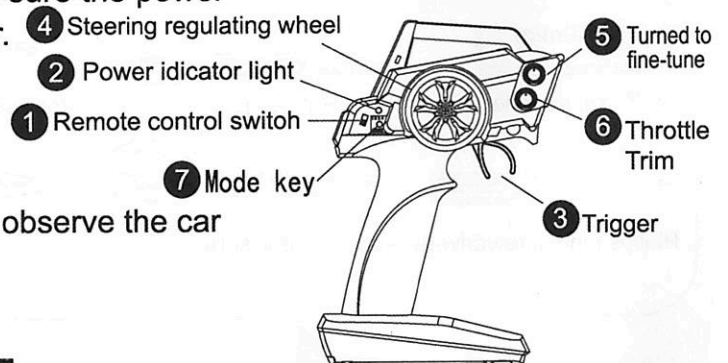

3> Turn steering regulating wheel ④ of transmitter to left or right, and make sure the steering of front wheels follow the instruction.

4> Put the car on the ground and stand behind the back of the car. Squeeze the throttle trigger ③ of transmitter gently. If the car does not move in a straight line, you can adjust the trim ⑤ of transmitter until the car moves in a straight line.

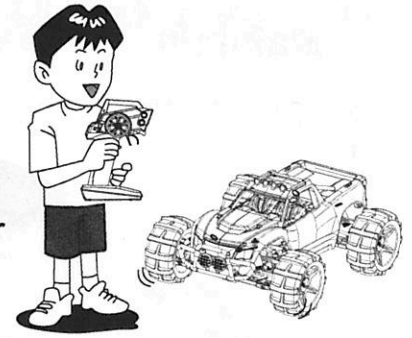

5> Throttle trim key ⑥, turn clockwise, the car became faster and faster; counterclockwise rotation, the speed will slow down.

6> Econometric model ⑦, the car is driving mode button, the car is no such function

7> OK, ready to run

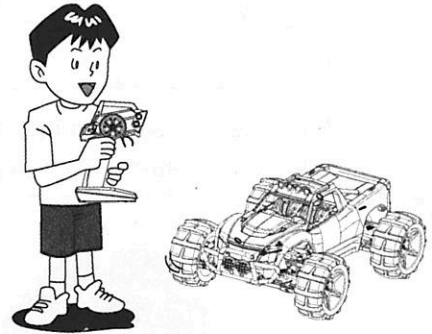
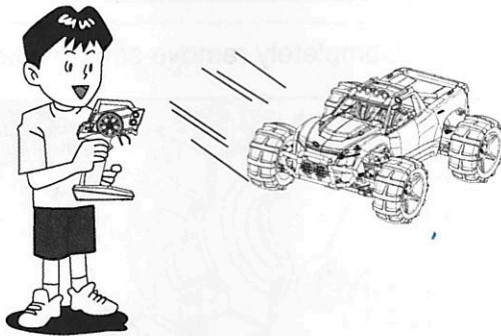

Practice

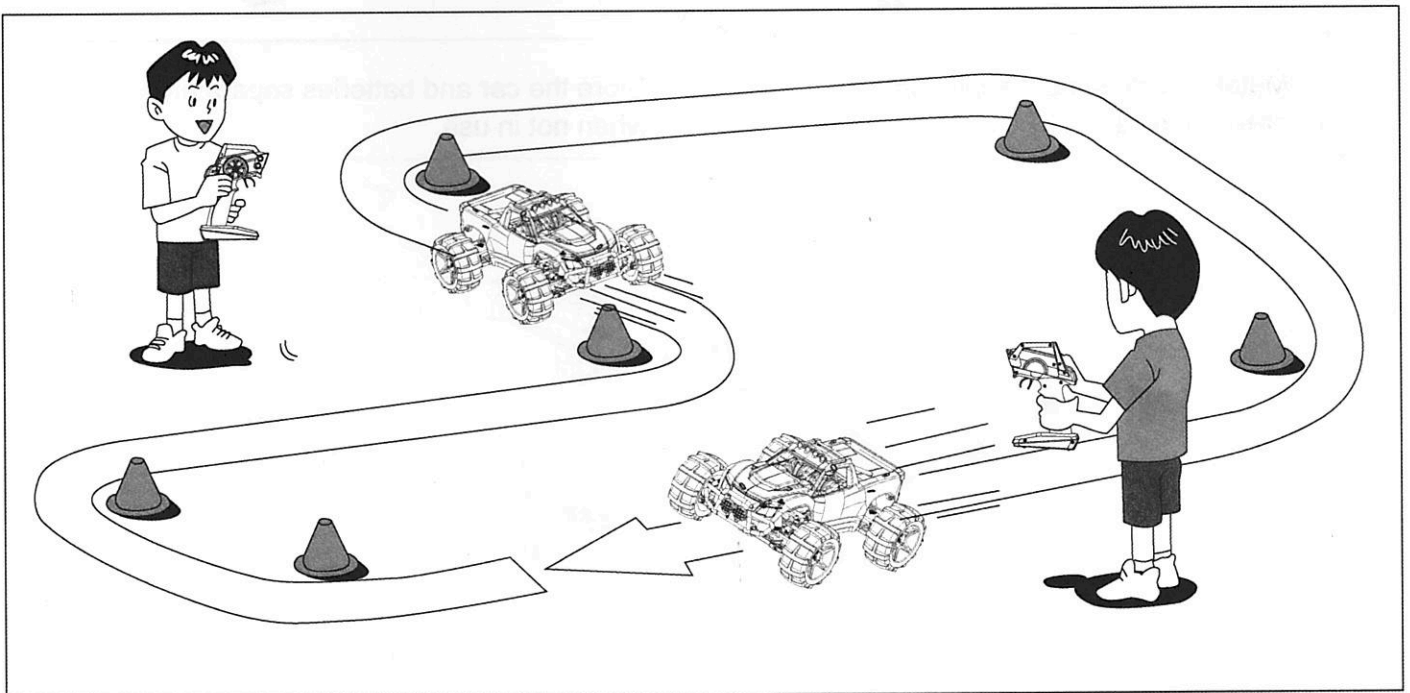

Let's practice! Make R/C car circuit at a wide and safe location using corner pylons (separately available), empty cans or such. Running fast at straight section and slow down at curved section is a basic speed control technique useful when driving R/C car.

Maintain

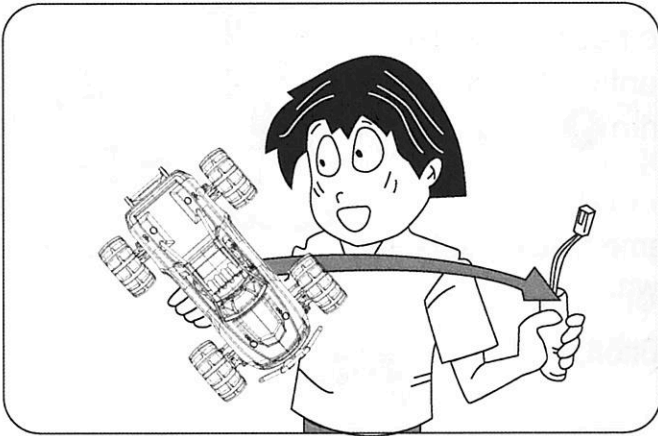

When the car is not in use, you should remove the battery from the car.

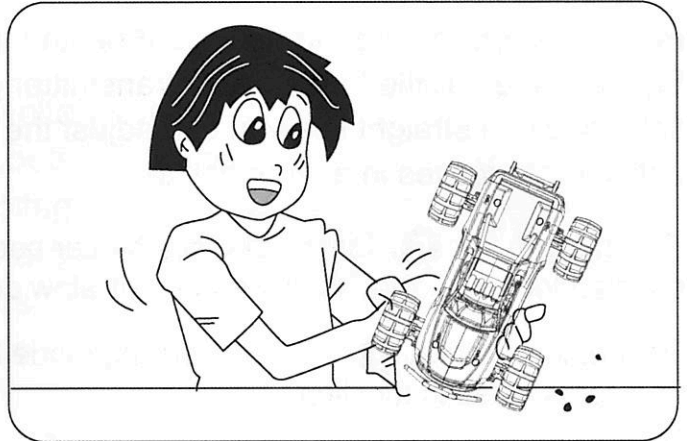

Completely remove sand, mud, dirt etc.

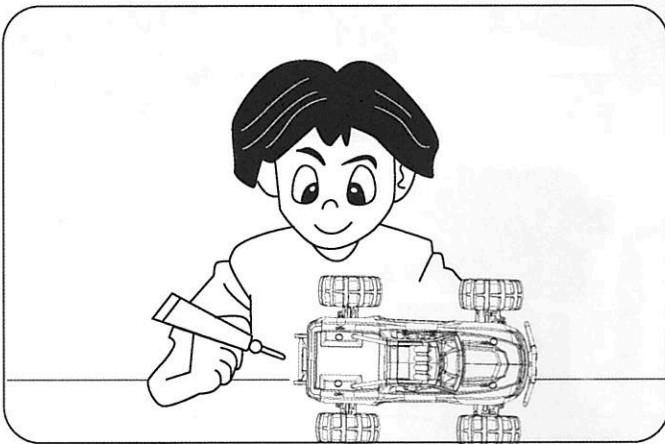

Metal outside should apply the rust prevention oil.

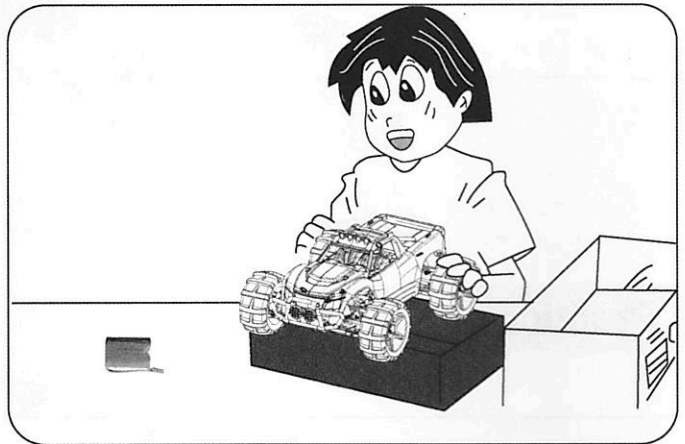

Store the car and batteries separately when not in use.

Assembly Exploded Diagram

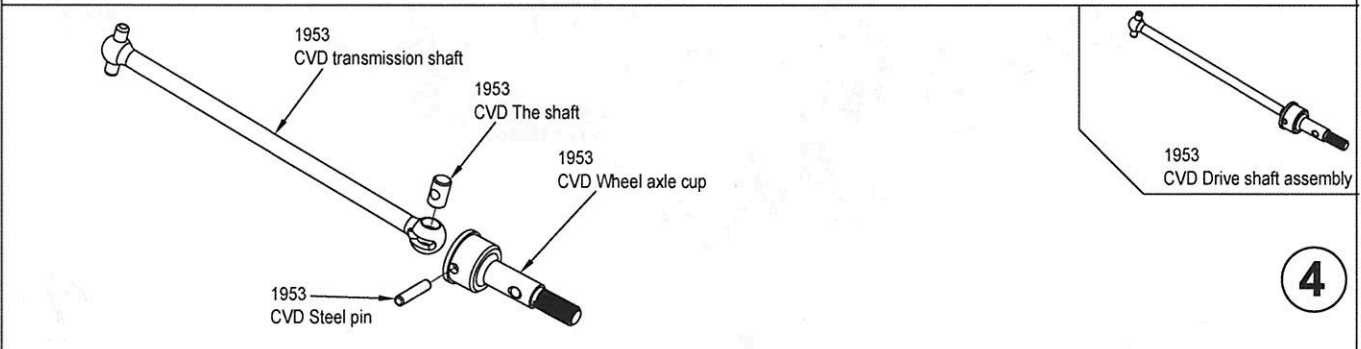
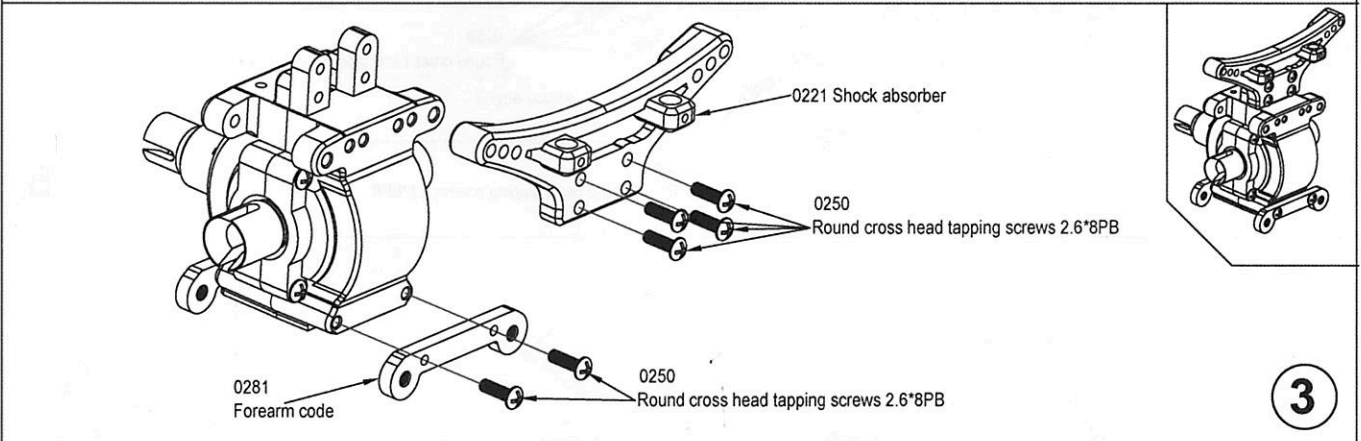
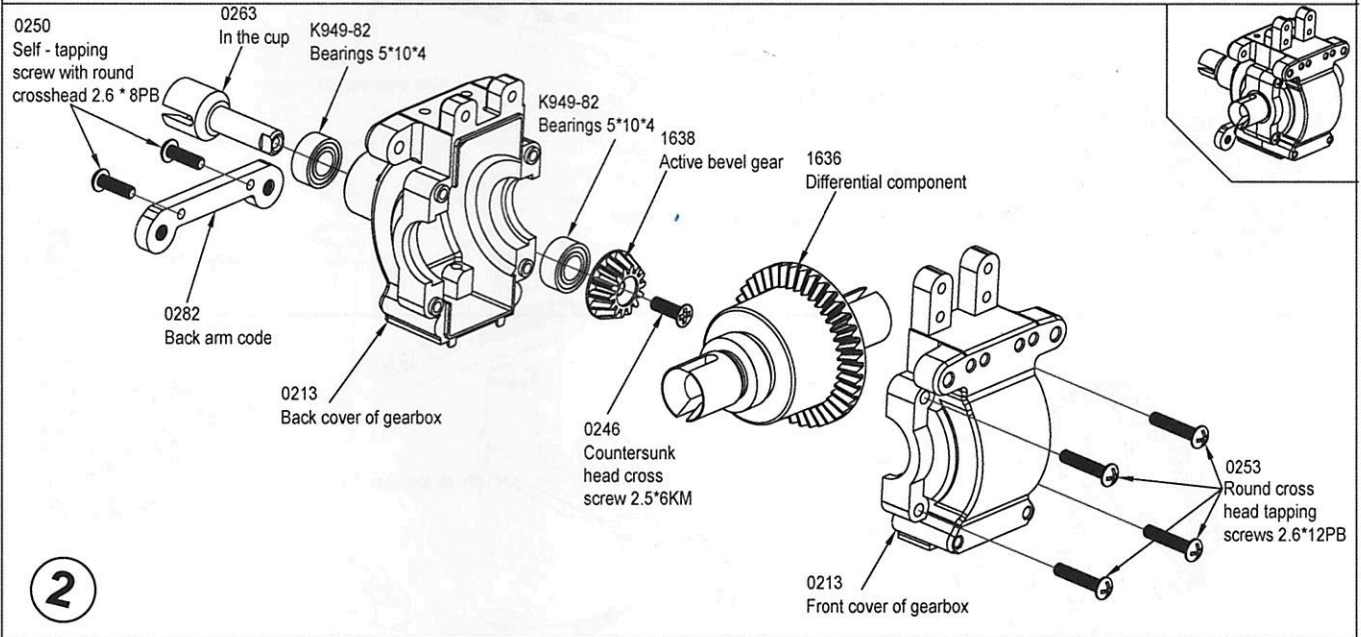
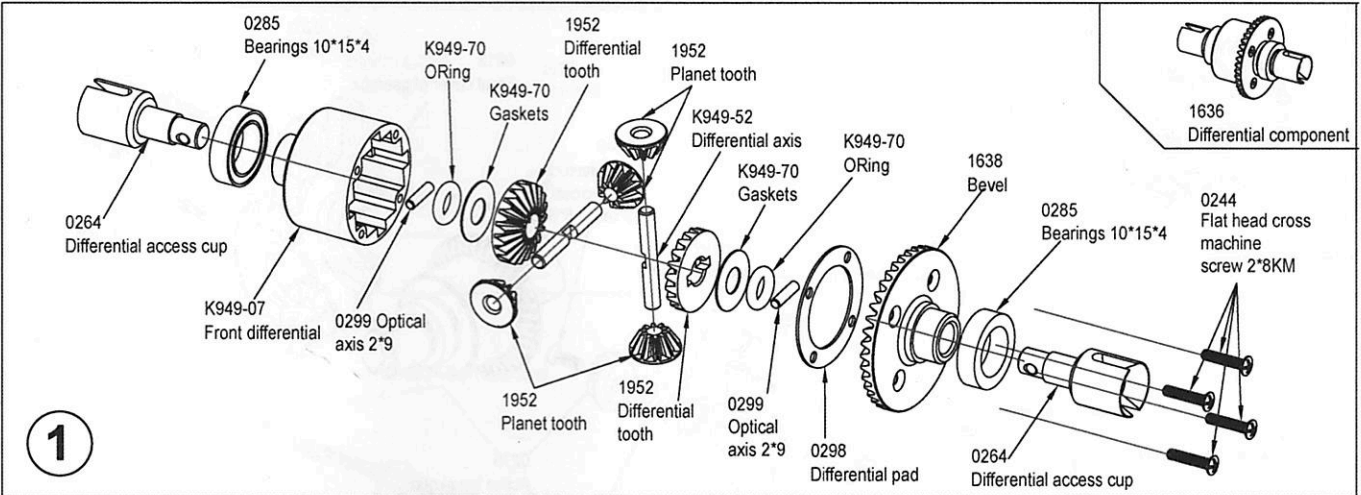

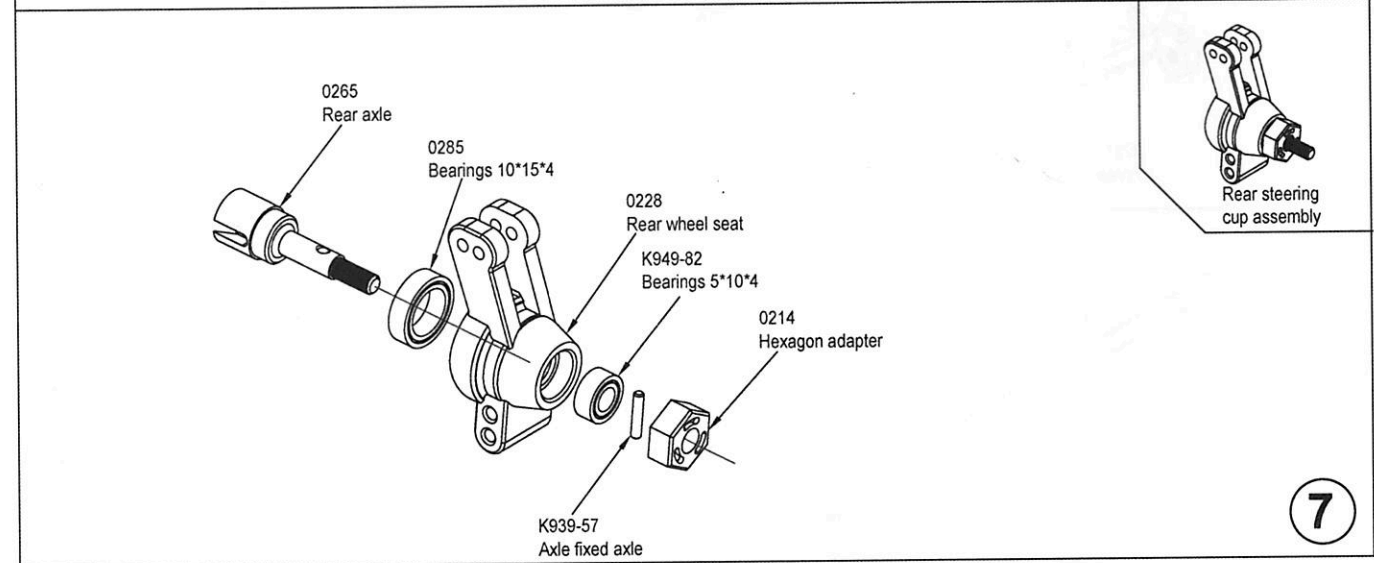
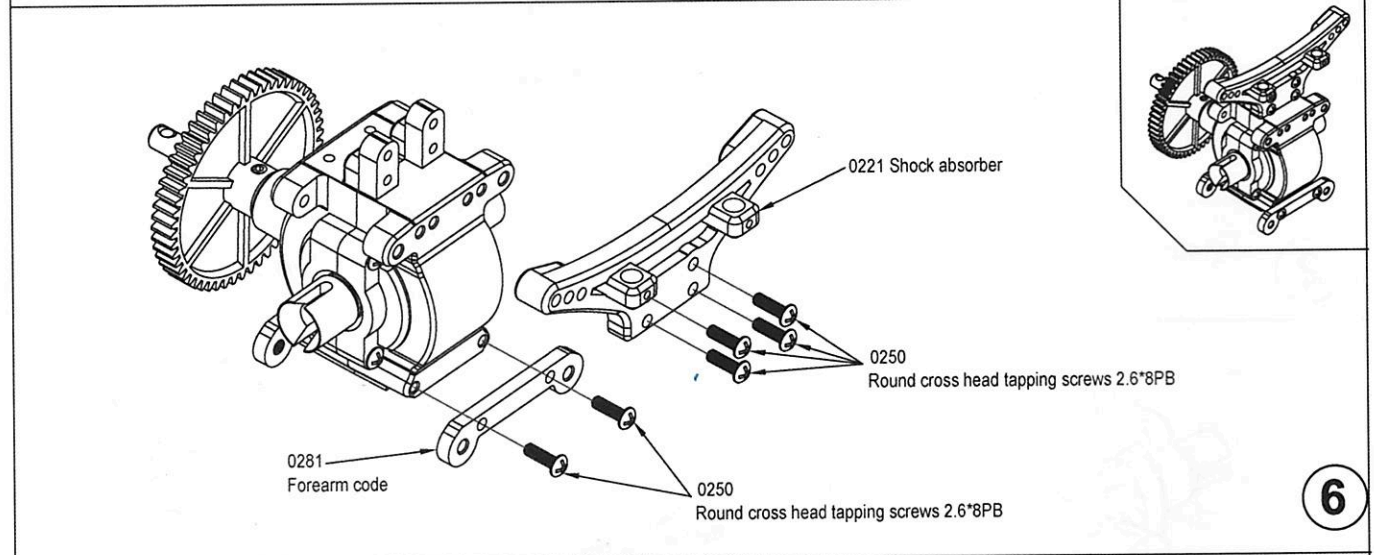
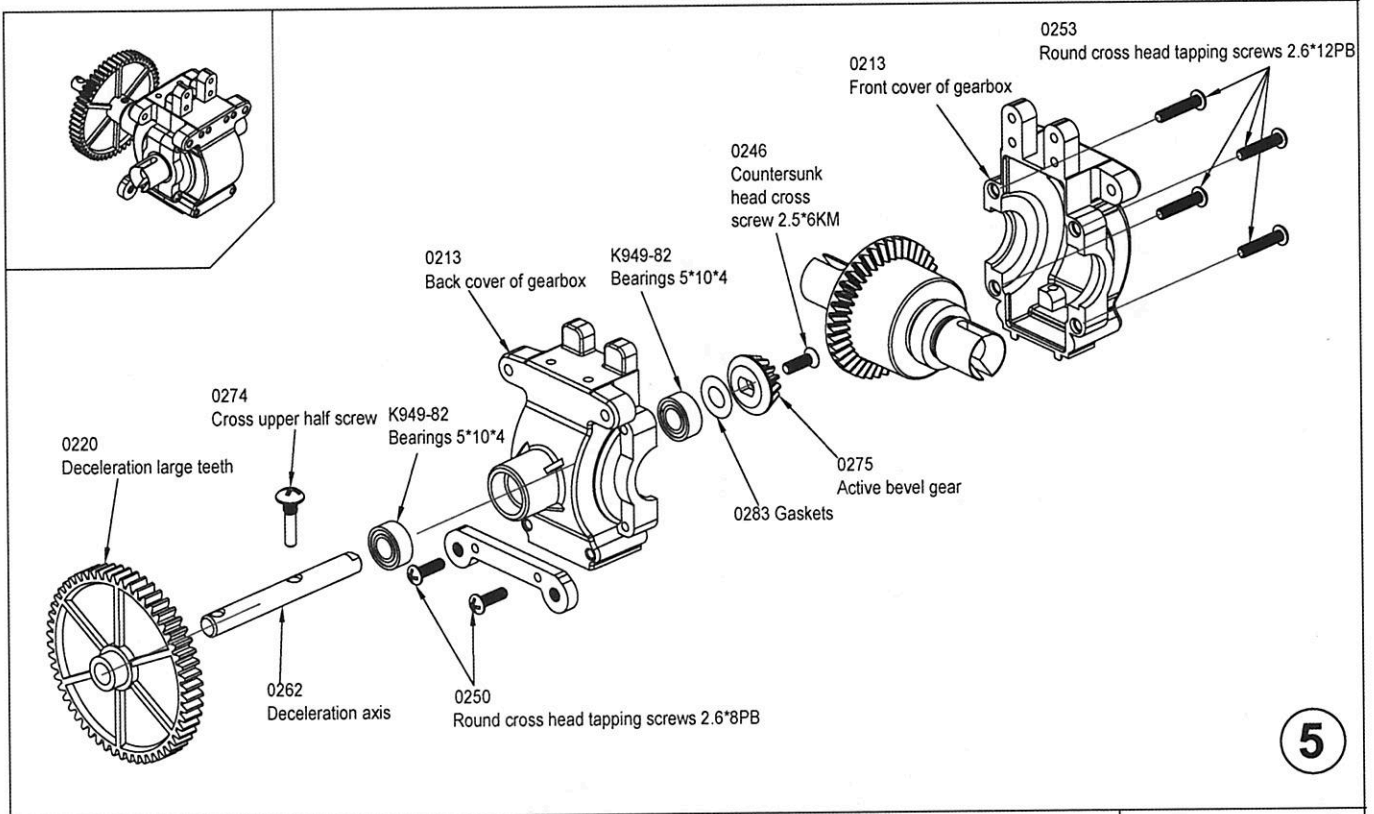

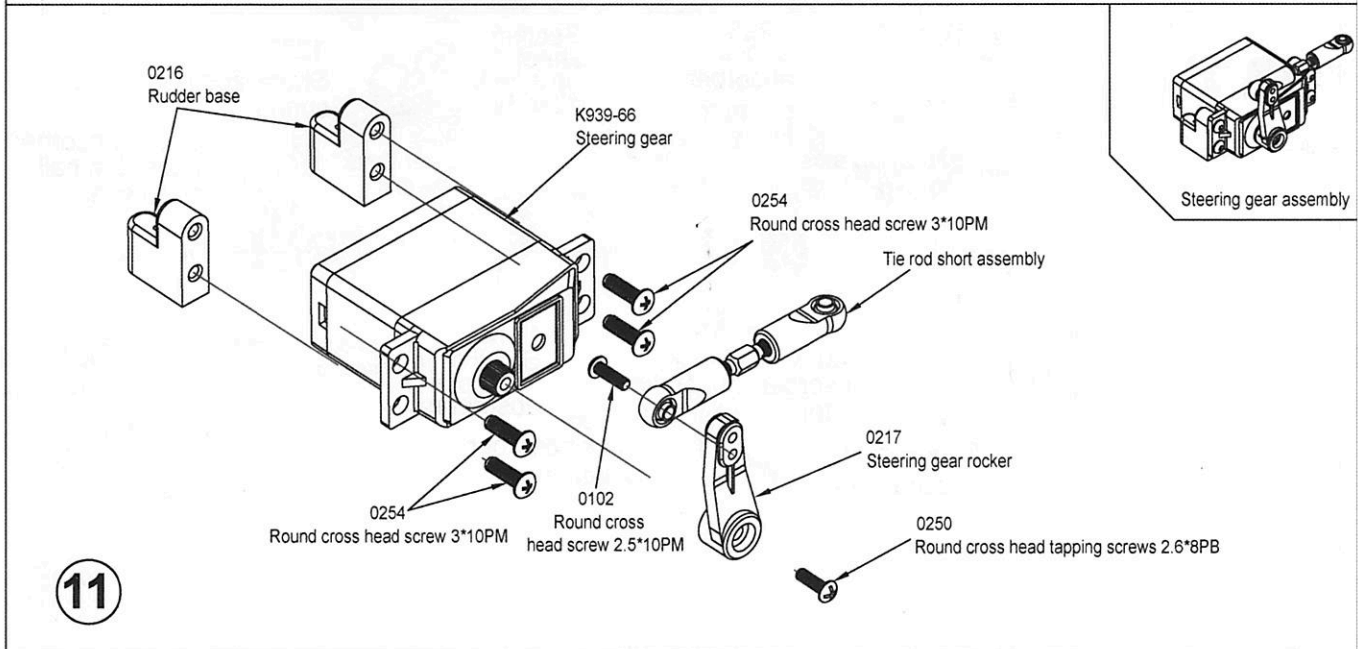
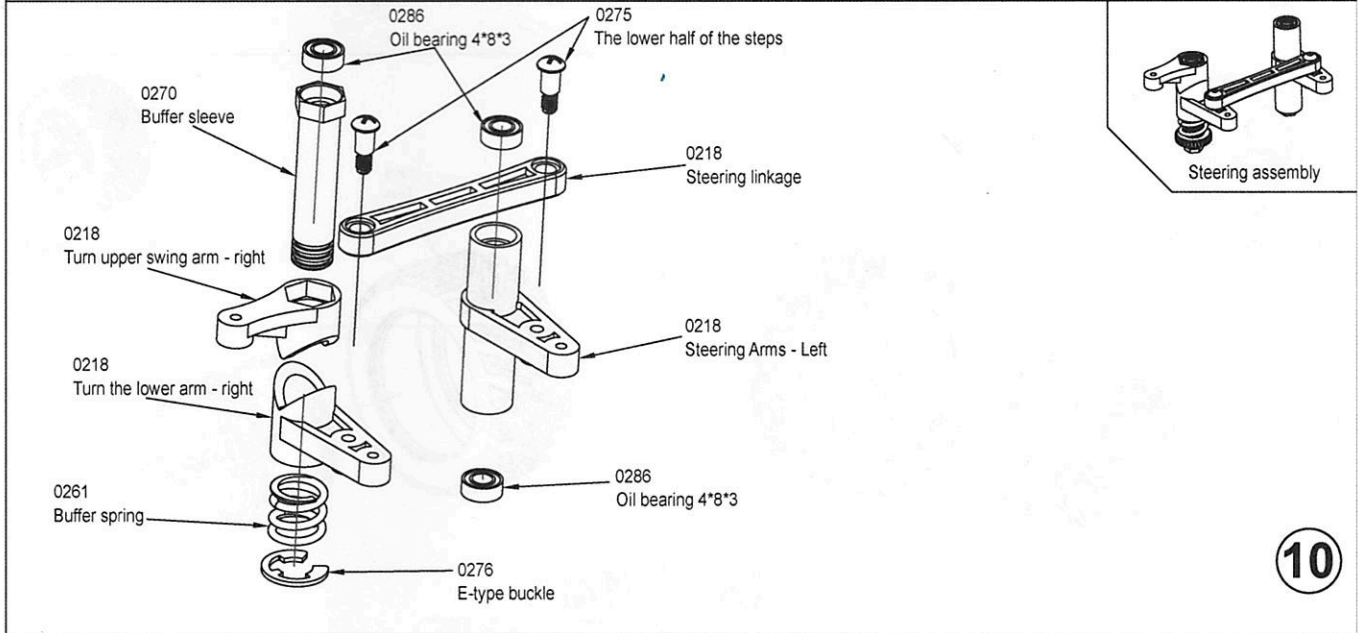
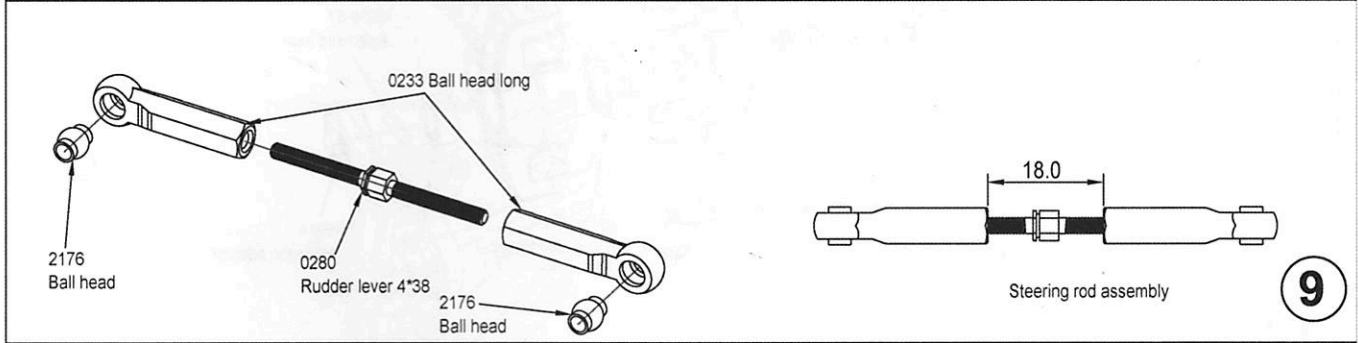
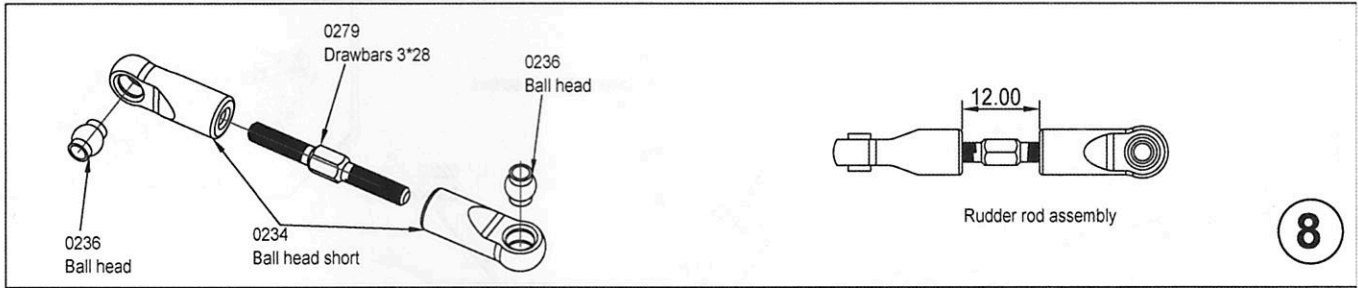

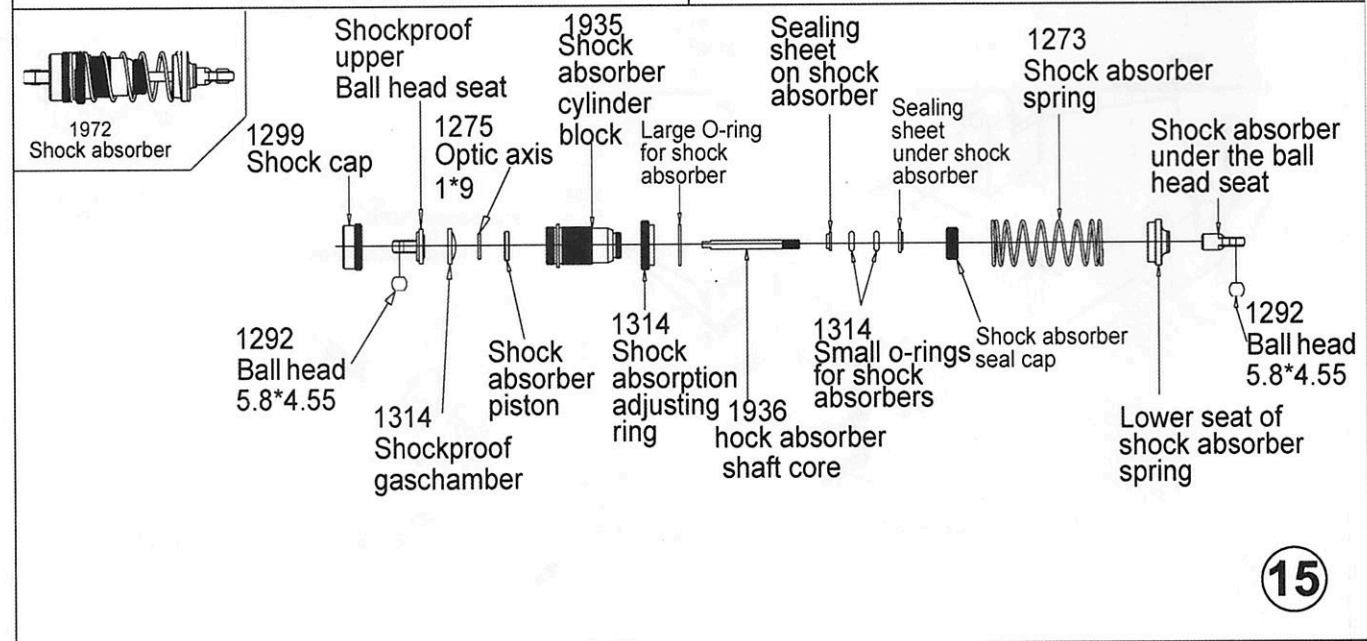
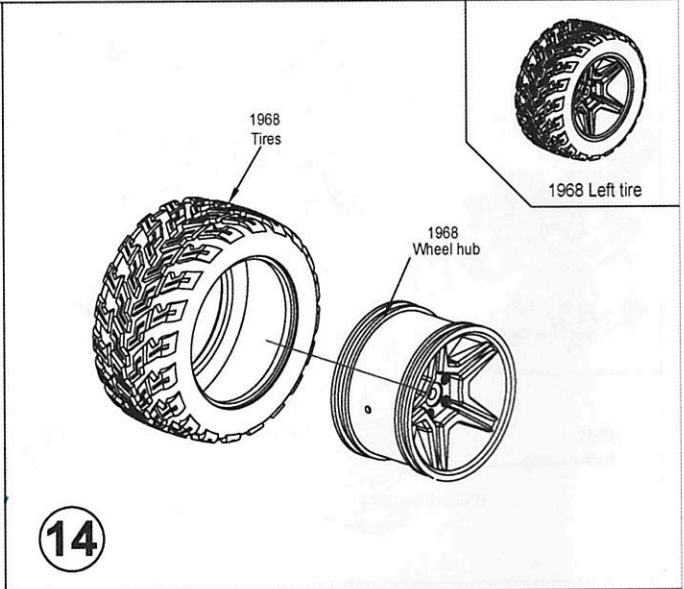
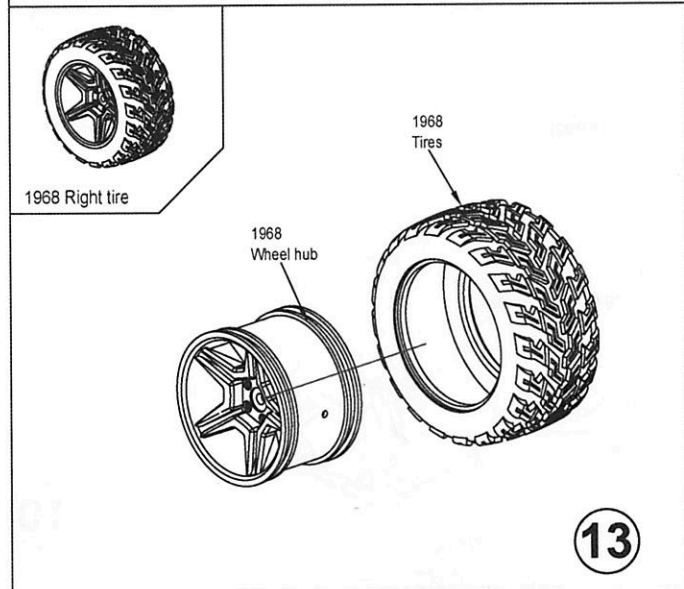
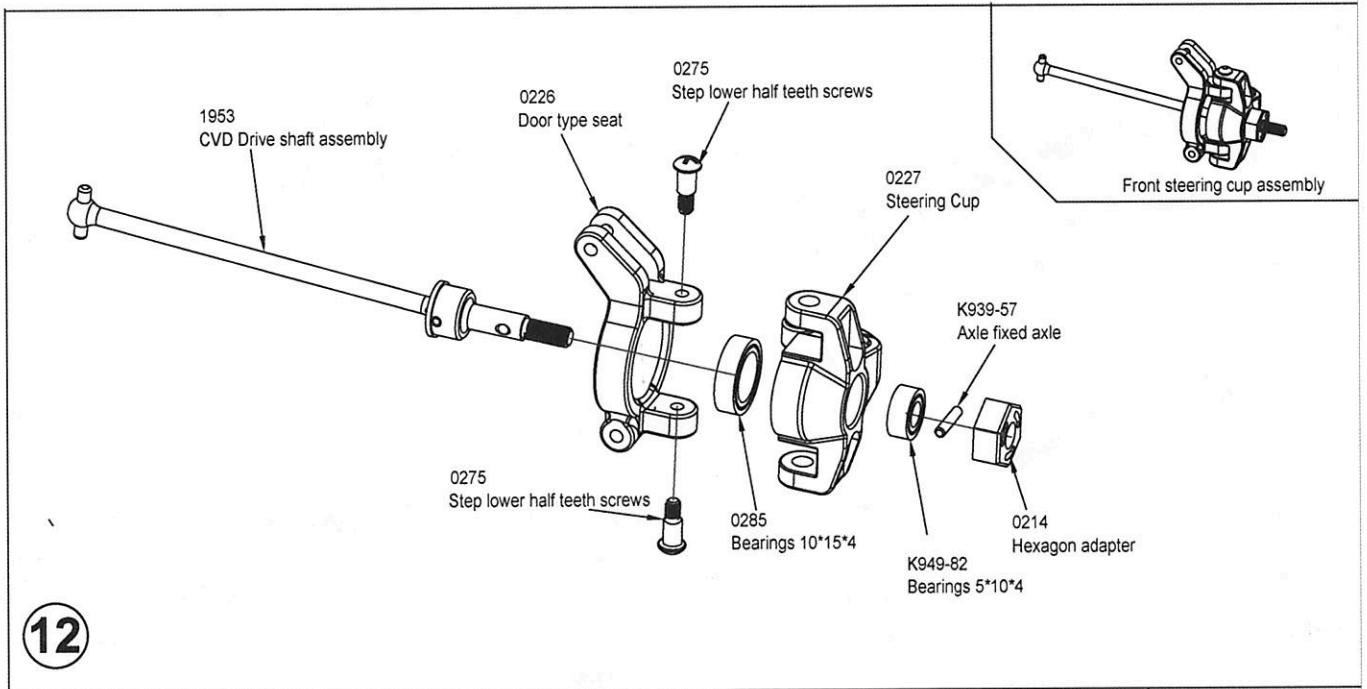

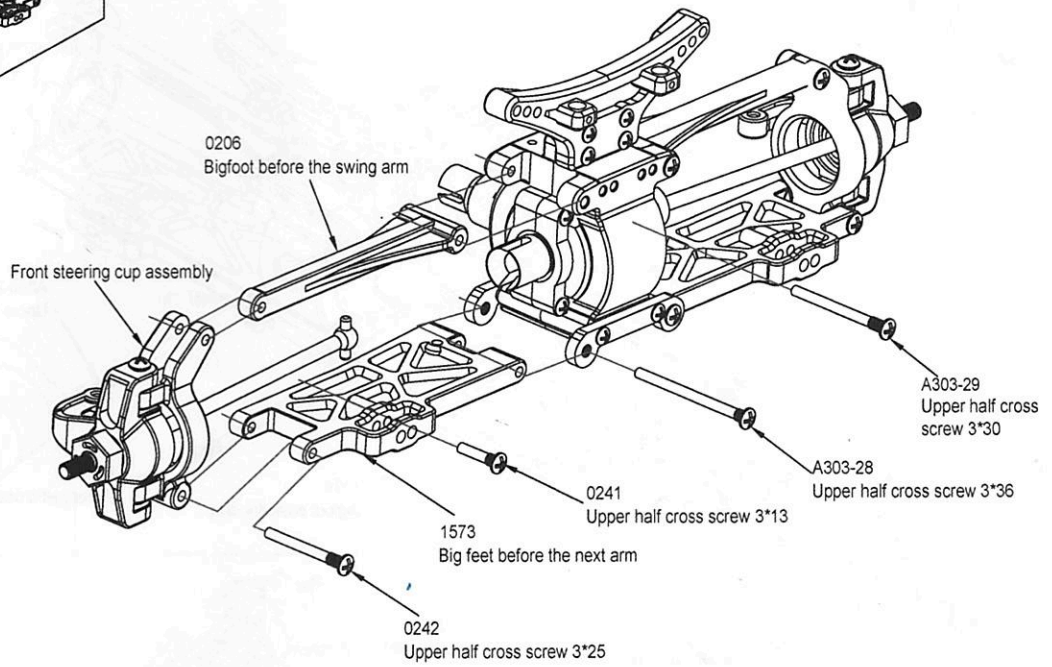
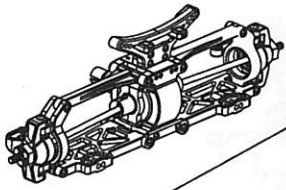

16

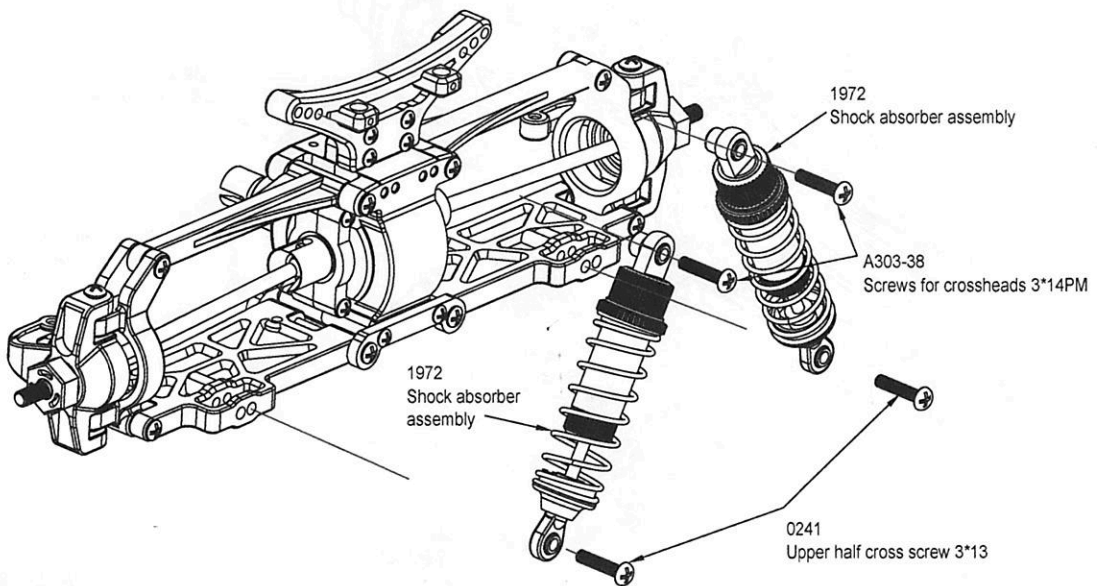
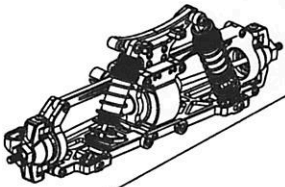

17

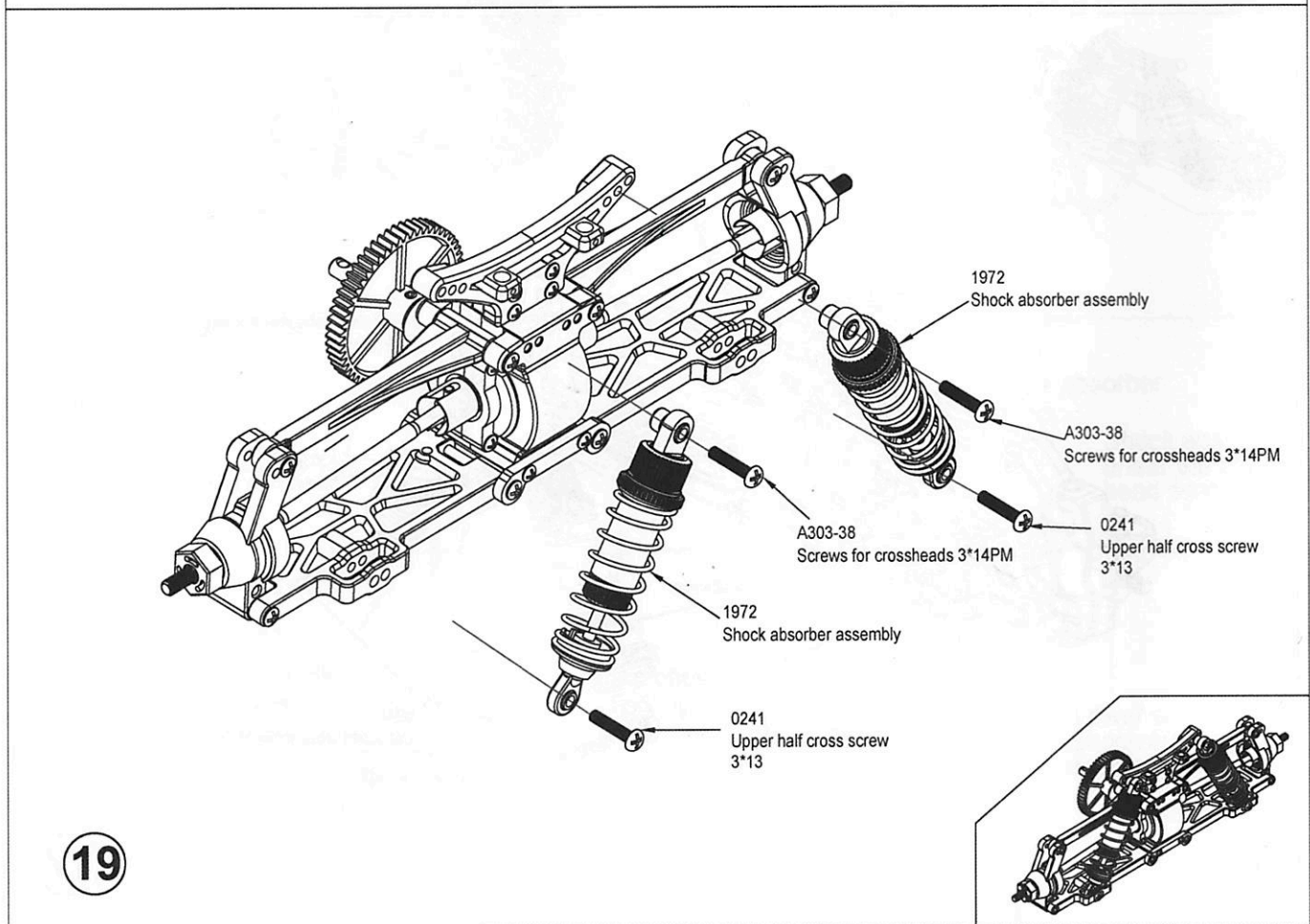
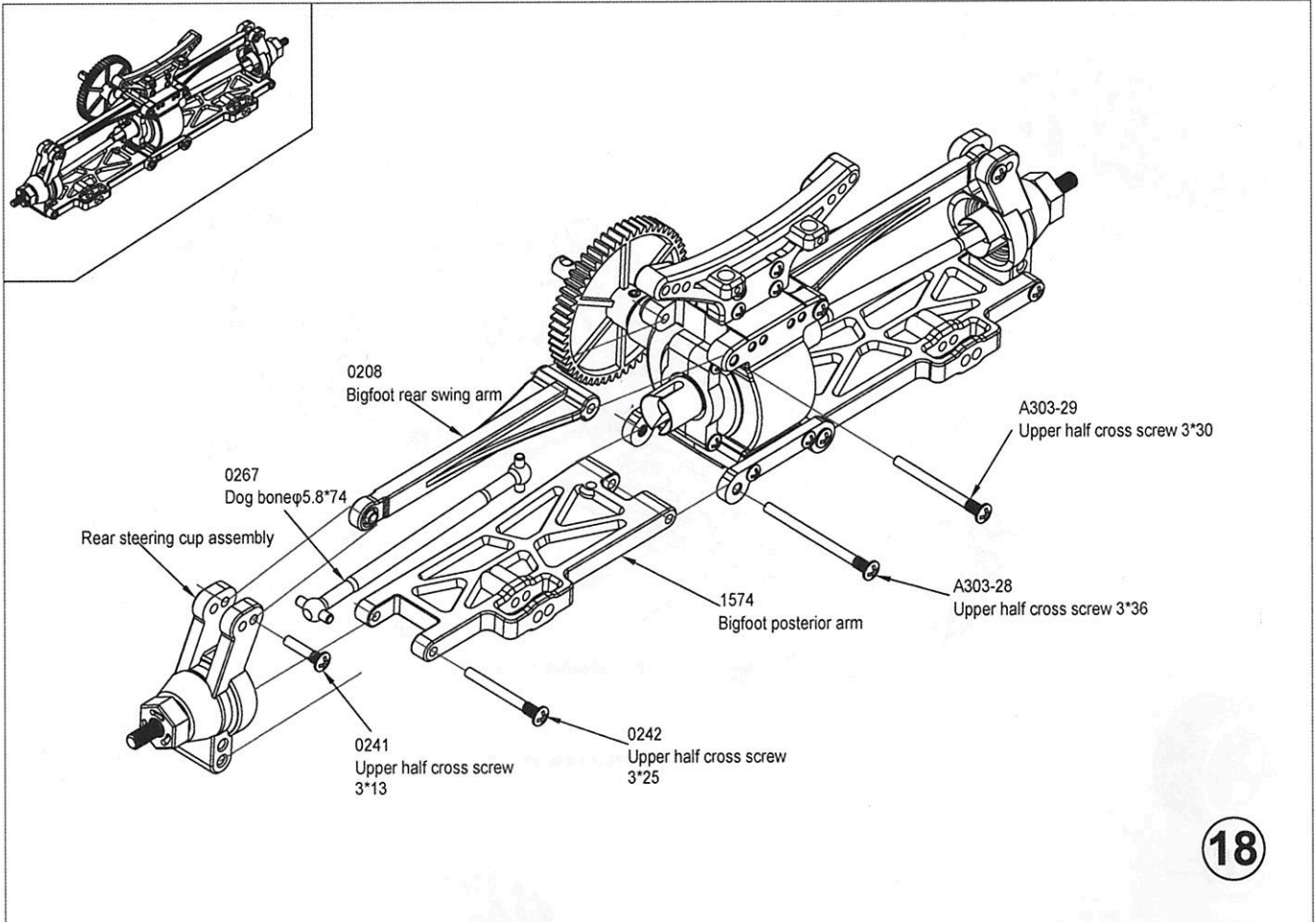

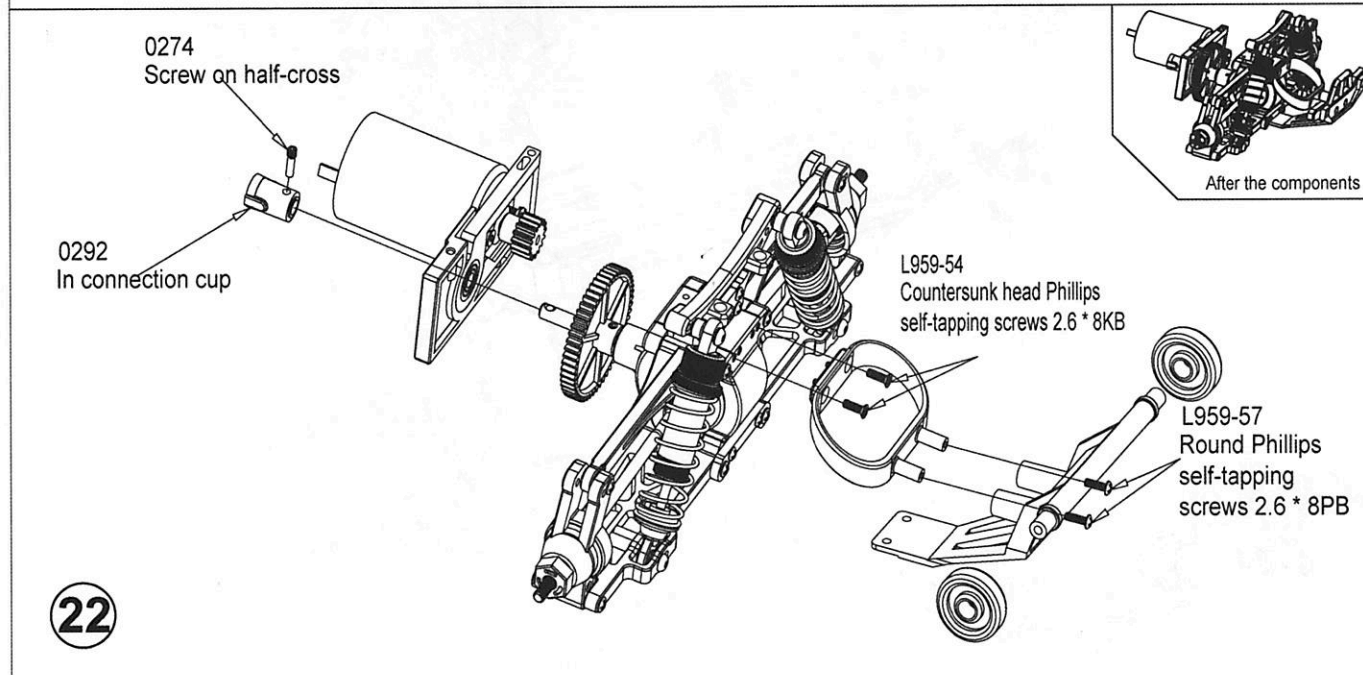
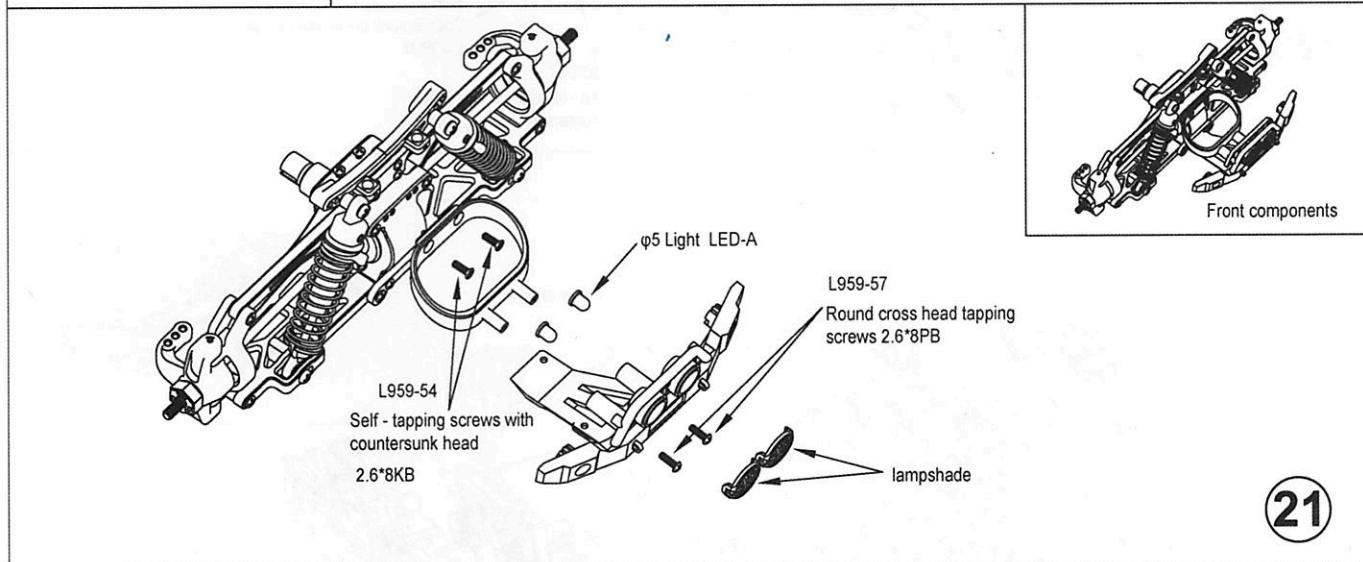
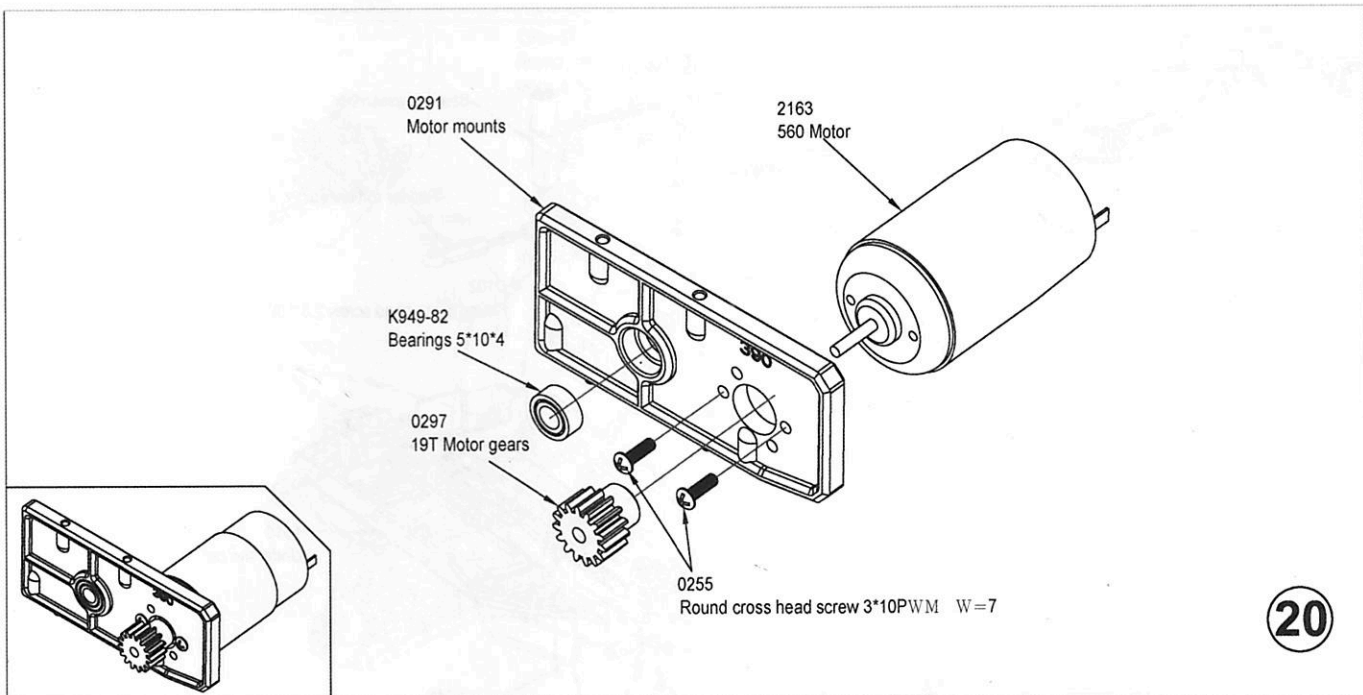

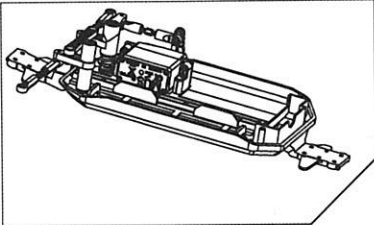

23

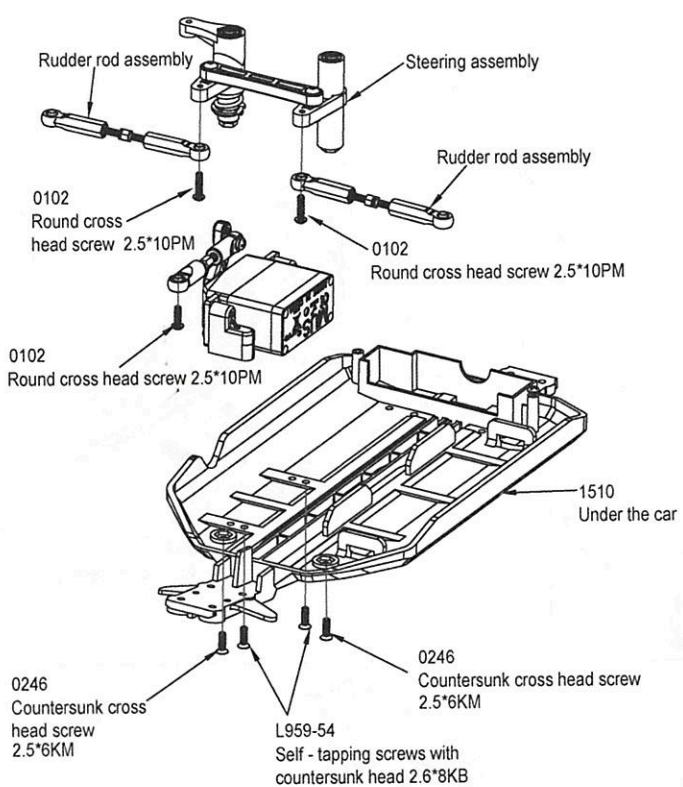

24

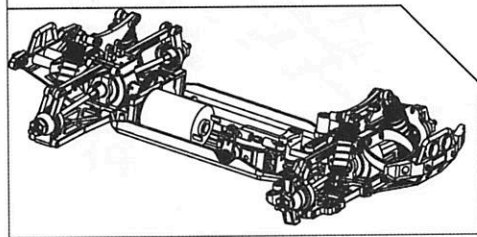
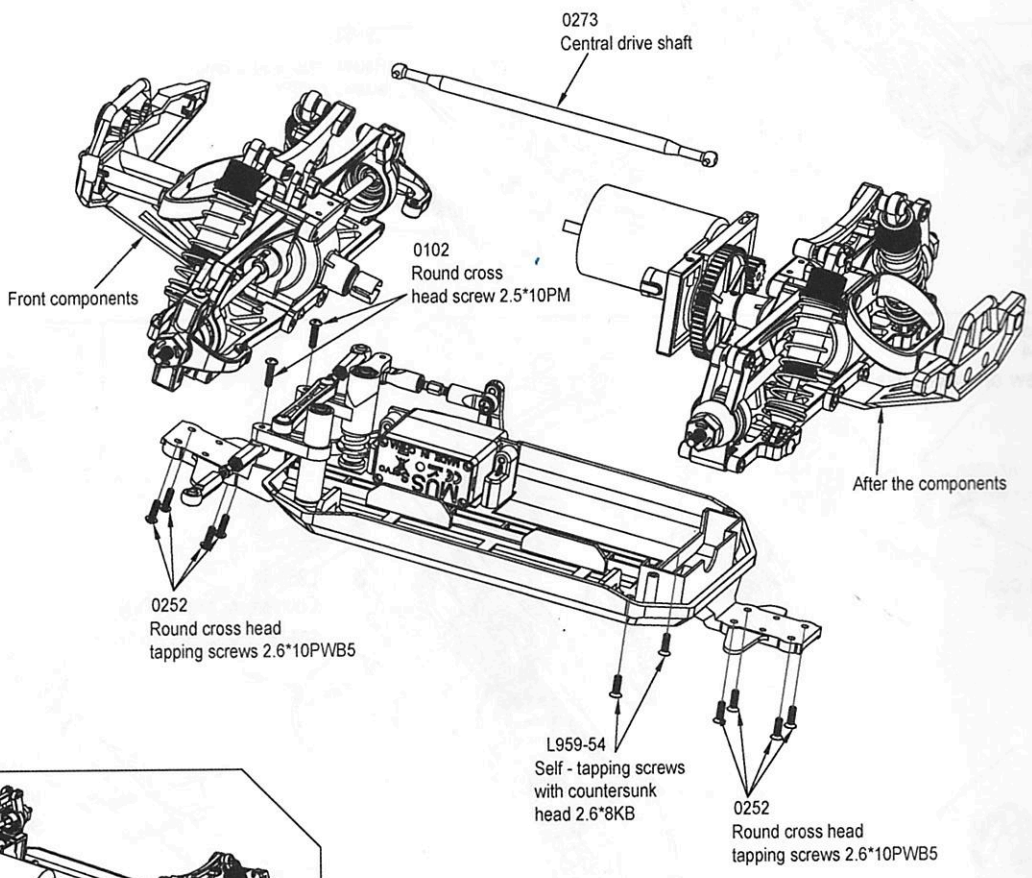

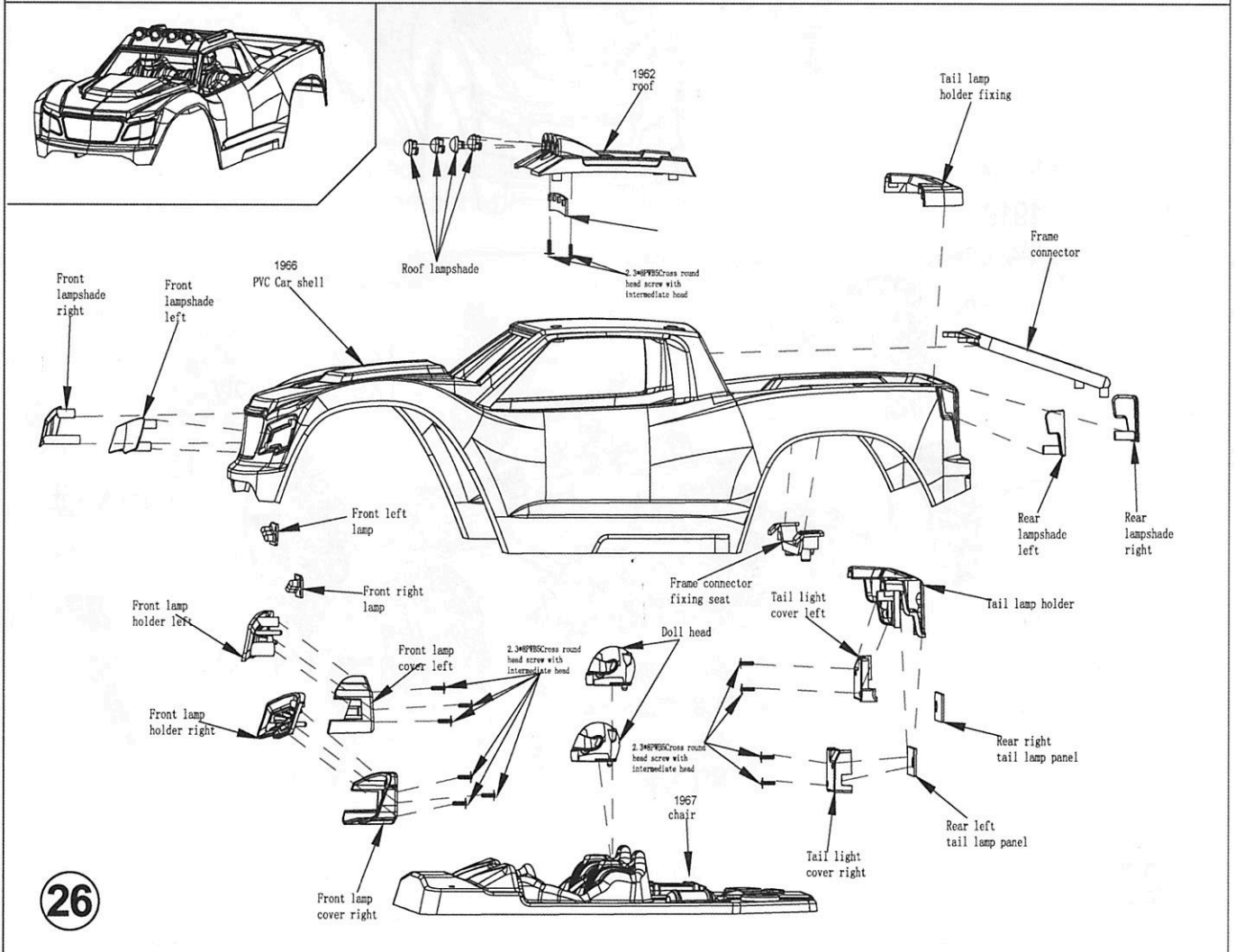
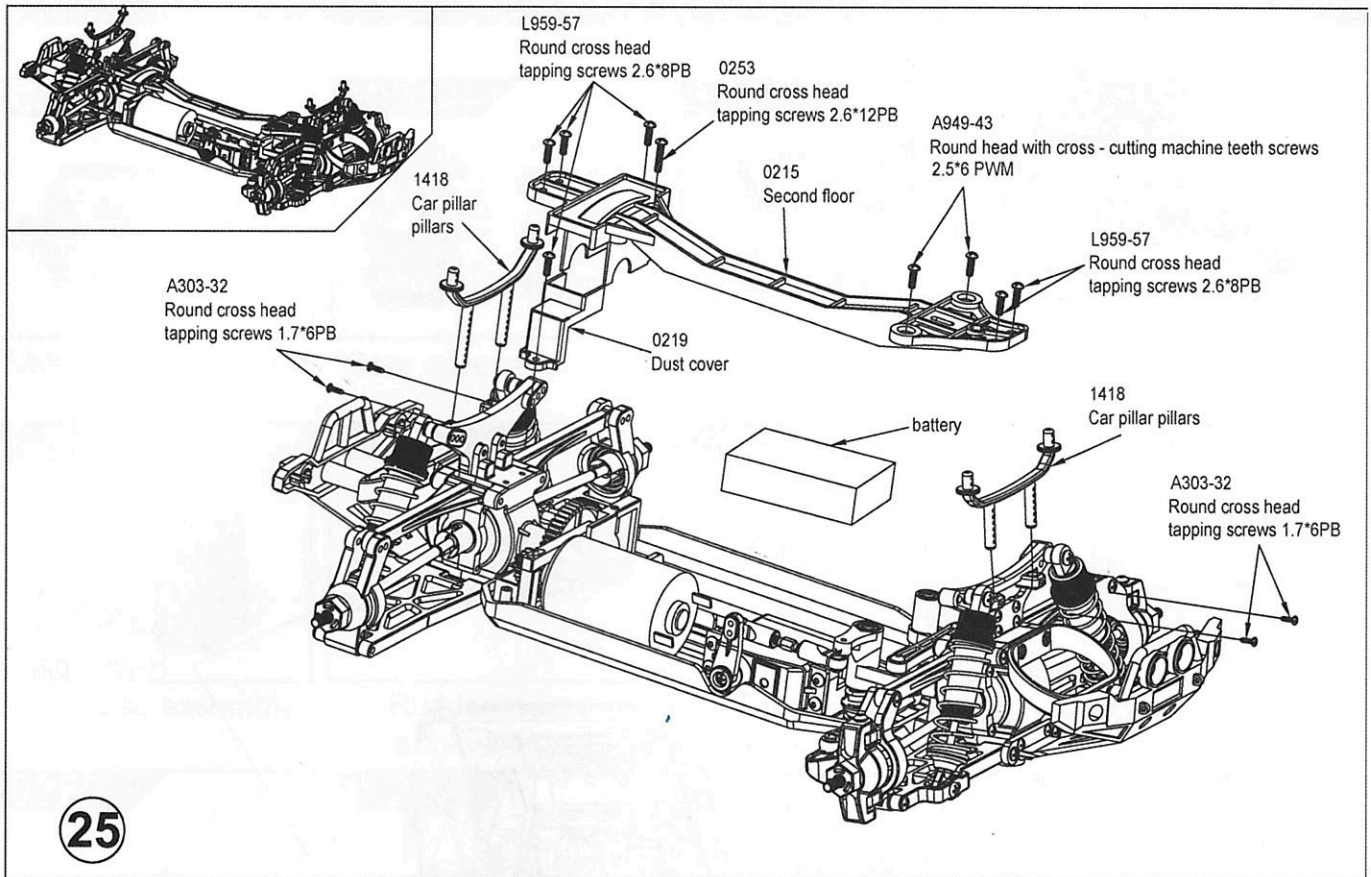

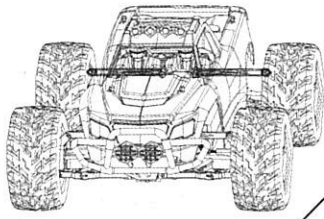

K939-49
R-type pin

K939-49
R-type pin

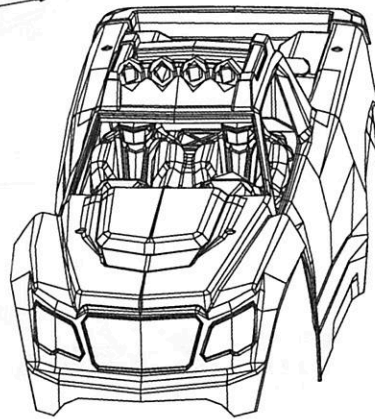

1910
M4 locknut

1968
Tire assembly

1910
M4 locknut

1968
Tire assembly

0119
M4 locknut

27

Sale parts view

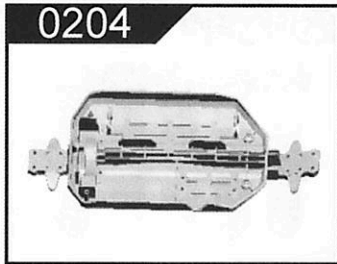

0204

Vehicle components

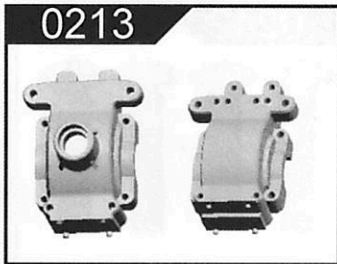

0213

Gear cover assembly



0214

Hexagon adapter assembly

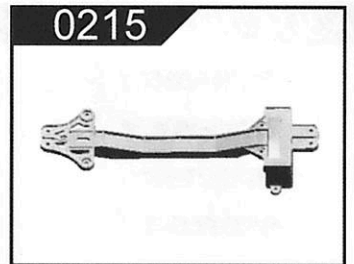

0215

Second floor components



0216

Rudder base assembly

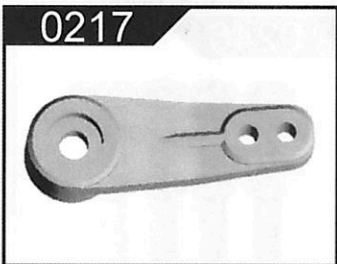

0217

Rudder rocker arm assembly



0218

Steering linkage arm assembly

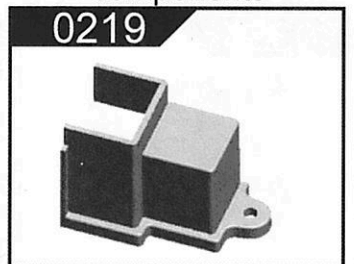

0219

Dust cover assembly

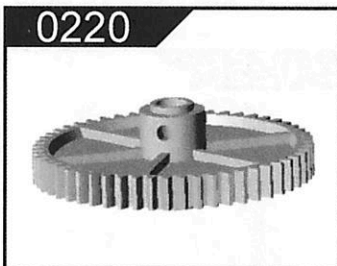

0220

Deceleration large tooth components



0221

Shock absorber components

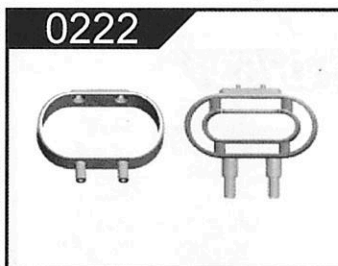

0222

Anti-collision support components

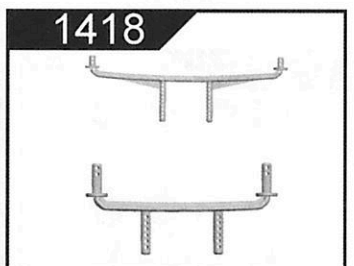

1418

Shell pillar components

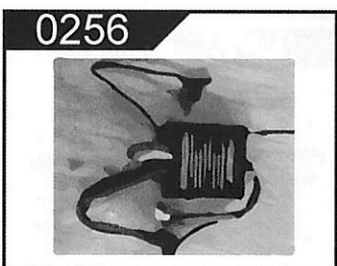

0256

Receiver board assembly



1636

Differential component



0226

Door type seat assembly

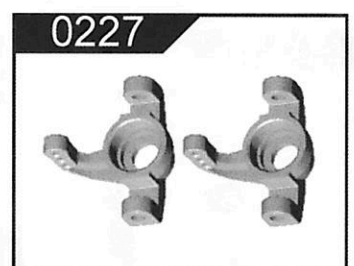

0227

Steering cup assembly



0228

Rear wheel seat assembly



0233

Ball cap - long components

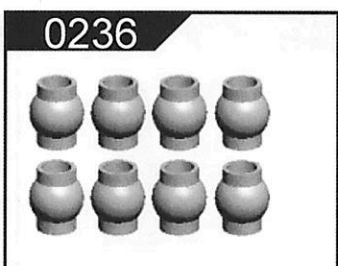

0236

Ball head assembly



A303-28

Upper half screw 3 * 36 PMO black zinc plated hardened component

Sale parts view

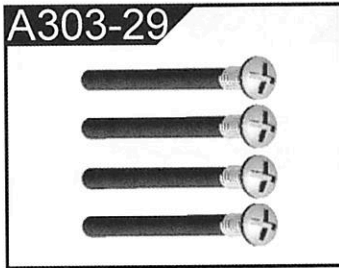

A303-29

3 * 30 PM D5.5 Cross round head with half-plated carbon steel plated black zinc components

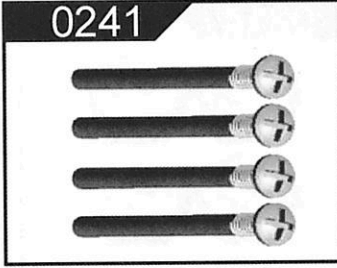

0241

3 * 13 PM screw assembly

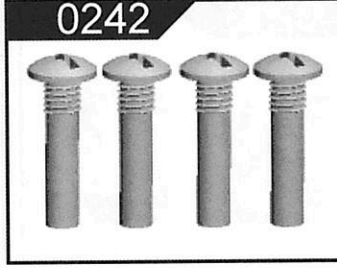

0242

3 * 25 PM screw assembly



A303-32

Round cross self-tapping ST1.7 * 6 PB D3 black zinc plating components



0386

2 * 8KM screw assembly



A949-43

Round head with screws M2.5 * 6 * 6 group



0246

2.5 * 6 KM screw assembly



L959-57

Round head tapping screws 2.6 * 8 * 10 sets



L959-54

Self-tapping screws 2.6*8*10countersunk head

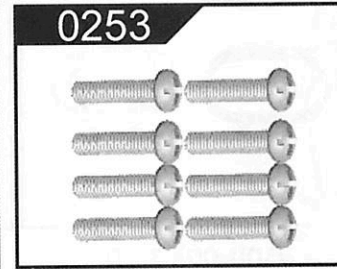

0253

ST 2.6 * 12 PB screw assembly



0254

ST 3 * 10 PB screw assembly



0255

3 * 10PWM7 screw assembly



0256

3 * 12 PM screw assembly

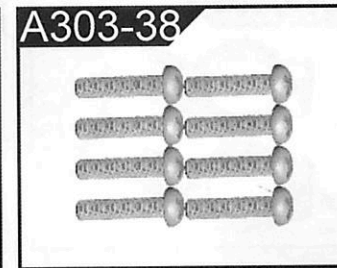

A303-38

3 * 14 PM D5.5 cross-head black zinc plated components

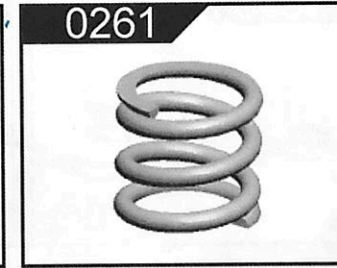

0261

Buffer spring assembly

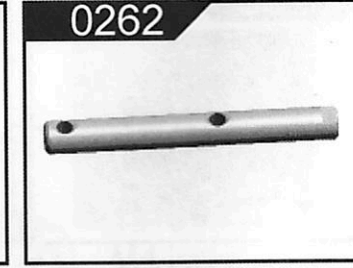

0262

Deceleration shaft $\phi 5 * 45\text{mm}$ components



0263

In the cup $\phi 10 * 25$ mm components



0264

Differential access cup $\phi 11 * 25\text{mm}$ components

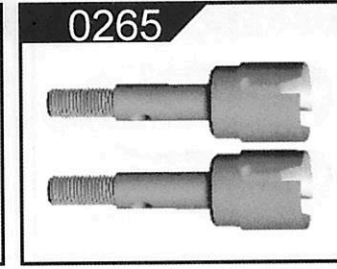

0265

Rear axle $\phi 11 * 36$ mm components

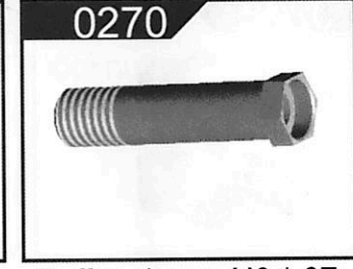

0270

Buffer sleeve H9 * 37 mm components

Sale parts view

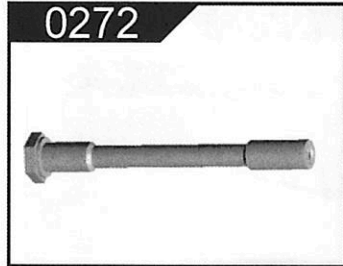

0272
Steering column H6 * 40
mm components

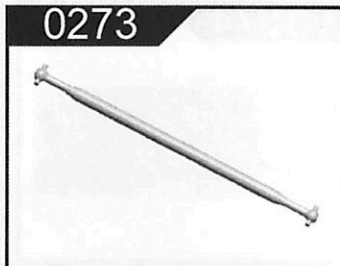

0273
Central drive shaft
φ5.8*135mm components



0274
3 * 10 PM screw
assembly



0275
3 * 10PM half-tooth
screw assembly



0276
E-type buckle
components



0279
Rudder rod assembly



0280
Tie rod assembly

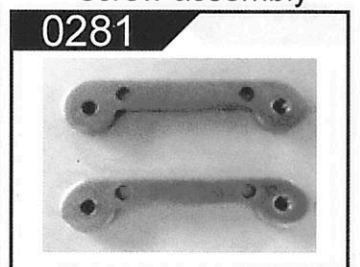

0281
Forearm code
component

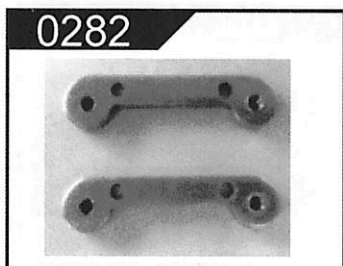

0282
Rear arm assembly

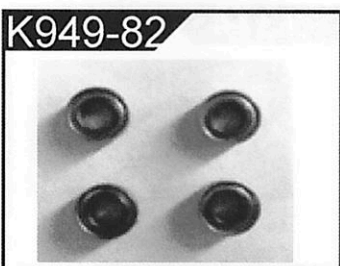

K949-82
Rolling bearings
5X10X4 group



0285
Ball bearing 10 * 15 * 4
groups



0286
Oil-bearing copper
sets of 4 * 8 * 3 groups

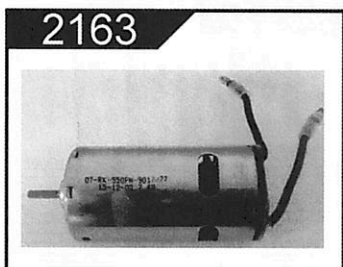

2163
560 motor components

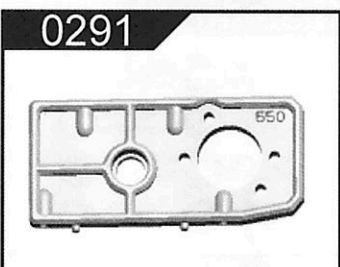

0291
550 Motor Mount
Components



0292
Middle cup assembly



1952
Differential gear
assembly

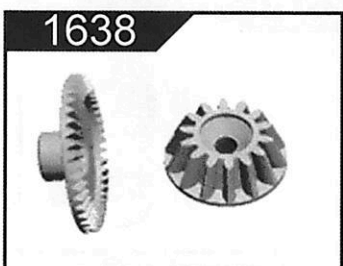

1638
Active bevel gear
assembly



0297
19T motor tooth
components



0298
Green shell paper
components

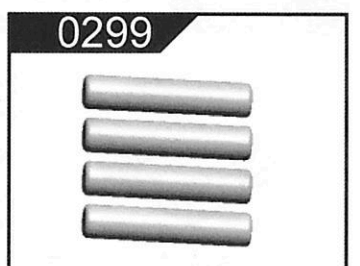

0299
Optical axis 2 * 9
components

Sale parts view

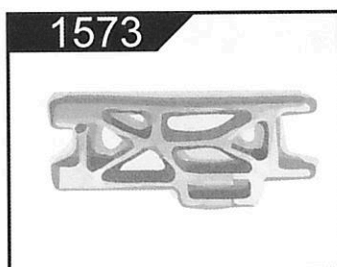

1573

Bigfoot front lower arm assembly

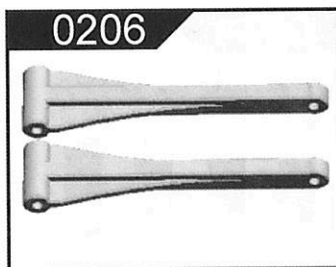

0206

Bigfoot front swing arm assembly

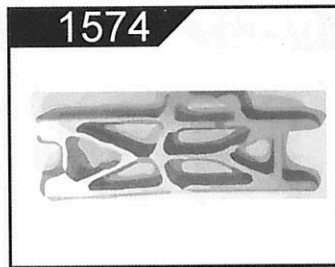

1574

Bigfoot rear swing arm assembly

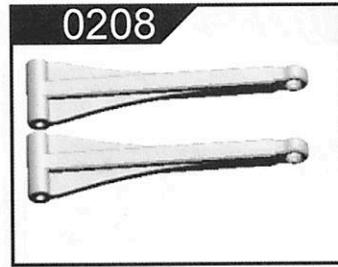

0208

Bigfoot rear swing arm assembly

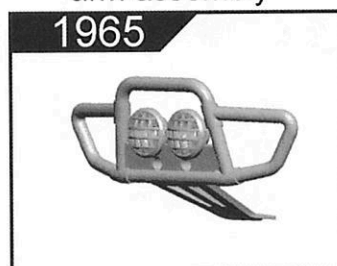

1965

Front collision avoidance group

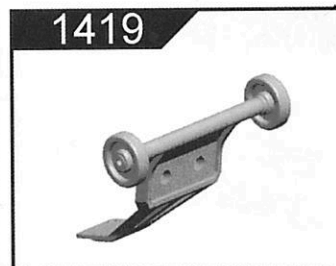

1419

Rear impact team

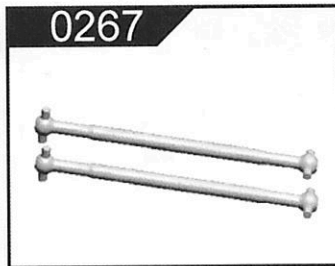

0267

Dog bone $\phi 5.8 \times 76$ mm components

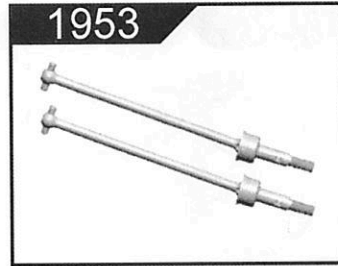

1953

Long CVD Drive Shaft Assembly

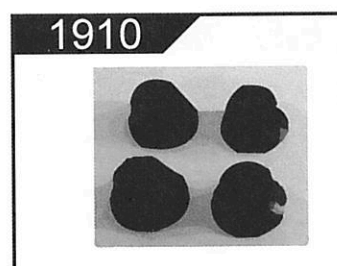

1910

M4 locking nut group

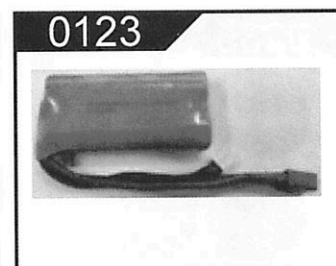

0123

Battery 7.4V 1500MAH-18650 group

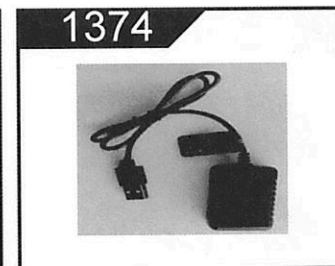

1374

USB Charger

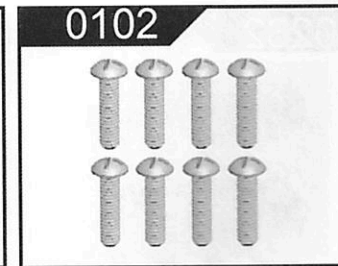

0102

Phillips head screws 2.5 * 10 PM group



1968

Tire components

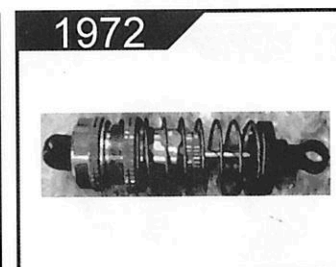

1972

Shock absorber assembly

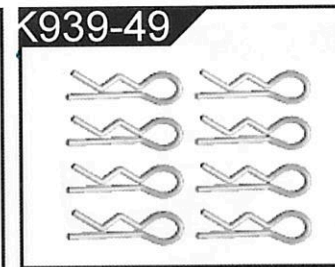

K939-49

R-type pin 1 * 22.2MM group

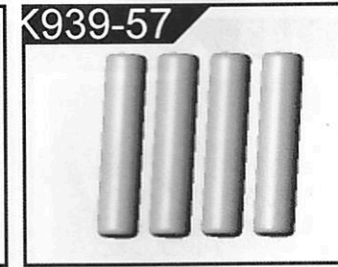

K939-57

Axle fixed group

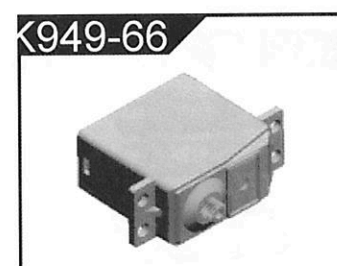

K949-66

6 kg 5-wire steering gear unit



K949-07

Front differential gearbox

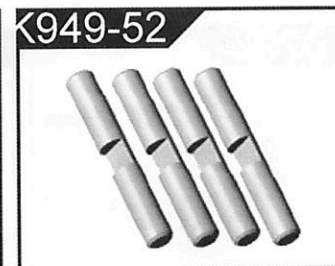

K949-52

Planetary gear shaft group

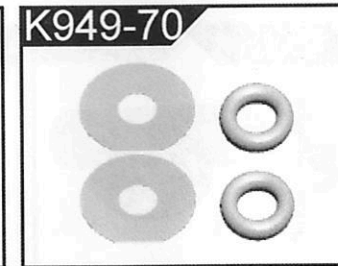

K949-70

Differential O-Ring Flat Division

Sale parts view

1669



V2-144001
remote control

1511



Battery cover

1654

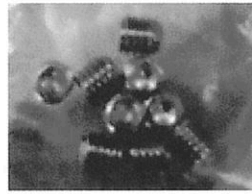

M3-Machine screw

1655



Shock sealing
cap group

1314

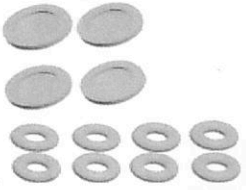

Shock absorber
O circle group

1962



Roof group

0574



Shell connector group

0575

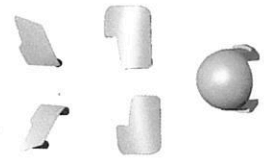

Lampshade group

1966

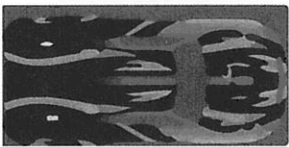

Spare tire rack group

1967



Shell Group

1969

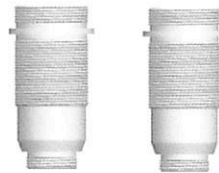

Shock absorber
cylinder block

1970

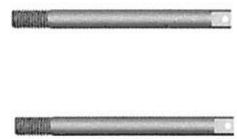

Axis group

1971

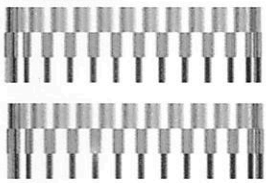

Shock absorber
spring set

0129



Cross pan head screw
2.3 * 8pwb w = 5 sets

1973



2.6 * 12pwb5 screw set

1974



2.3 * 4pwb8 screw set

2176

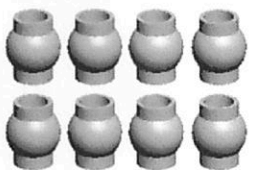

Alloy ball
joint assembly