

1:14 Brushless four wheel drive car

14+

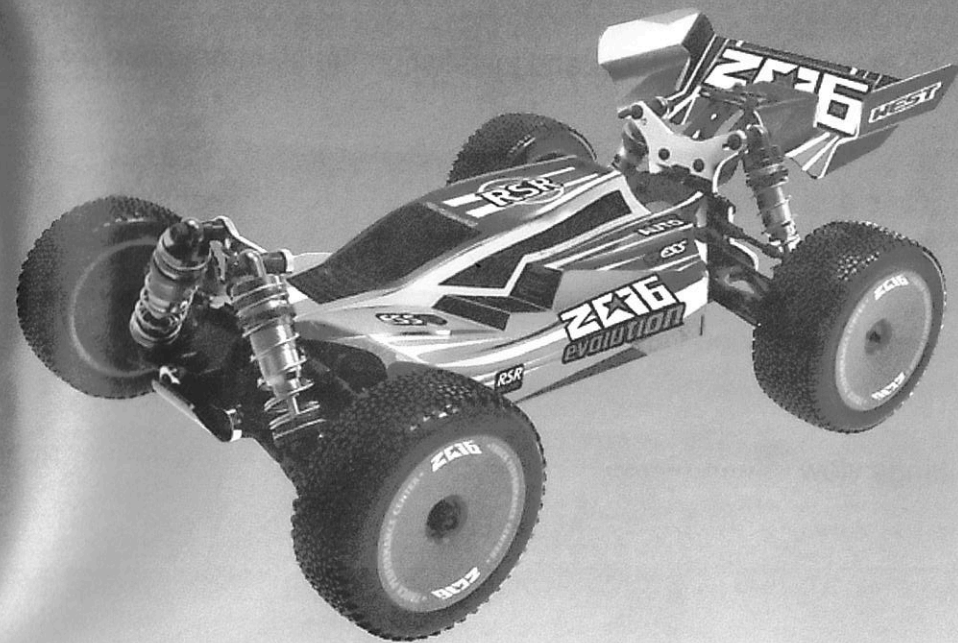

Caution: This model is not a toy, it is designed for user over 14 years of age.

Please use this instruction and the R/C system instruction at the same time.

The instruction is suitable for a type of model whose number is 144010

Safety and caution	1-2
Troubleshooting • Product introduction	2-3
Instruction of common tools and installation the electronic part... 3-4	
Practice and maintenance.....	5
Assemble exploded view	6-14
Fittings view	15-20

Safety and Cautions

- *Never run the model on public roads or streets, as it could interfere with traffic.
- *To prevent property damage and/or personal injury. Never run the model in crowded areas, near or toward people or animals.
- *Never run the model near rivers, ponds or lakes.
- *Make sure that no one else is using the same frequency in your running area. Using the same frequency at the same time, can cause loss of control with R/C model, resulting in serious accidents.
- *To avoid a runaway R/C model or loss of control always follow the procedure below;
 1. Fully extend transmitter antenna.
 2. Switch the transmitter on.
 3. Switch on the R/C model.
- *Follow reverse procedure to shut down.
- *Never touch or block rotating tire.
- *Never run R/C model in the rain or in puddles, as water may cause trouble with R/C model.
- *Motor and battery get very hot after running. Take care when handle them.
- *Retract transmitter antenna when not in use.
- *Remove the batteries from model and transmitter when they are not in use.



Cautions when handling batteries

- *Do not dismantle the battery or charger and do not cut and battery cables. Altering the battery may cause short-circuit and/or damage to the product.
- *Charge battery with compatible charger following proper procedure outlined in the instructions. Do not modify charger or charge battery in improper way.
- *Do not recharge battery if it is still warm from use as it may damage the battery. Allow the battery to cool off prior to recharging.
- *Make sure to disconnect charger from R/C model and electrical outlet when not in use.
- *Remove transmitter battery when not using it for a long period of time as it may leak and damage transmitter.
- *Never incinerate used batteries, as they can explode causing serious accidents.



Safety precautions

<p>Do not operate the model on public roads, in crowded places or near infants, it may cause accidents or injury.</p>	<p>The product includes small and sharp parts, assemble and store this product only in places out of the reach of children.</p>
<p>The front end of the antenna may be dangerous, do not aim it toward faces.</p>	<p>During and after operation, the motor will be hot. Please do not touch it until it has had time to cool down.</p>

When multiple vehicles are being operated nearby, Ensure that each vehicle and controller pair are set to different frequencies. Or else the car will lose control and may lead to damage, serious accidents or injury.

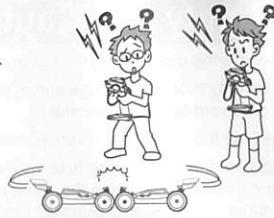

Troubleshooting

Description	Cause	Solution
The car does not operate at all.	Transmitter or receiver is off.	Turn on both transmitter and receiver.
	Batteries are not installed properly in the transmitter.	Place batteries in the transmitter properly.
	The drive battery is not charged enough.	Charge the drive battery.
The car does not follow your operation and control distance is not long enough.	Someone else is using the same radio frequency as you are using.	Change your radio frequency to the one no one else is using, wait until the driver using the same radio frequency finishes driving, or drive your car at a different place.
	There is not enough power in the transmitter or receiver batteries.	Replace the transmitter batteries with new ones and charge the drive battery.
	Antenna not fully tightened on the transmitter/not fully extend.	Make sure to insert the antenna into the transmitter and fully extend the antenna.

CAUTION

- * Please review the operation manual and packing explanation to install and use, some parts should be installed by adults.
- * The product contains small part, which may cause choking.
- * Never run the R/C model in the rain or wet areas, it may cause electronic parts to malfunction.
- * Dispose of the package appropriately and keep out of reach of children.
- * Inspect the RC car for damage to the charge, wire, plug, bodyshell or other parts prior to operation. If damage is found, repair the broken parts before use.
- * The charger, battery box and battery must be only be used with the designated Speed RC charging system.
- * This product must only be used with the original Speed RC charger.
- * This product may be dangerous to the children.

Proportional R/C Using Instruction

- ① Turn the steering wheel left, the car will turn left. Steering angle can be adjusted by increasing/decreasing the degree of wheel rotation.

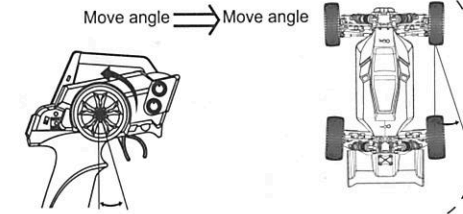

- ② Turn the steering wheel right, the car will turn right. Steering angle can be adjusted by increasing/decreasing the degree of wheel rotation.

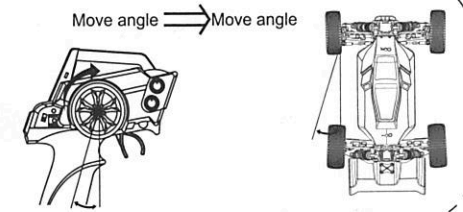

- ③ Pull the throttle trigger backward, the car will drive forward. Adjusting the angle of throttle trigger can adjust forward speed of the car. To stop the car, quickly push the trigger forward.

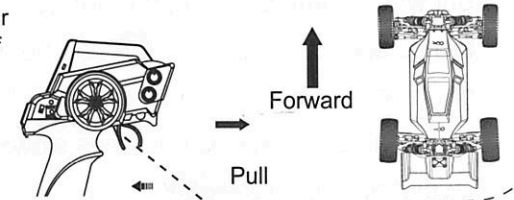

- ④ Loosen the trigger to allow it return the neutral position. Push the throttle trigger forward, the car will reverse. Adjusting forward angle of throttle trigger adjust reverse speed of the car.

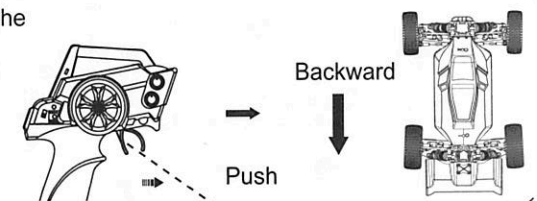

Introduce the common tools and assemble the electron parts

Tools needed for assembly

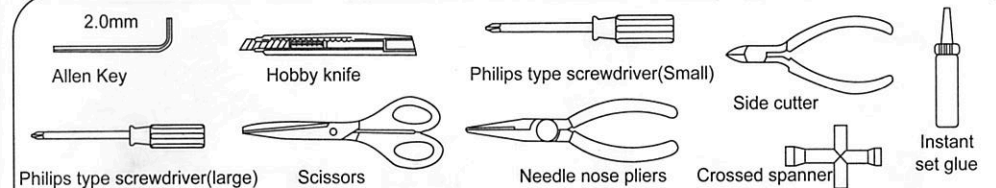

PRACTICE AND MAINTENANCE

Operating program

1. Turn on the power switch **1** on the remote and make sure the power indicator **2** flashes red, then turn on the model car's power switch.
2. Gently trigger the remote control to observe if the car can move forward and backward.
3. Turn the remote control steering wheel **4** to the left or right and make sure that the front wheel's steering follows the command.
4. The model car on the ground, and standing behind the model car, gently hook the remote control throttle trigger **3**, if the model car does not go straight, rotate the remote control front wheel trim **5**, the model car to the right side, the front wheel Turn the trim to the left, the model car leans to the left, and the front wheel trims to the right to rotate until the model car can go straight.
5. Throttle speed adjustment **6** can adjust the model car speed, rotate to the right, hook the trigger model car speed becomes faster, turn left, hook the trigger model car speed becomes slower.
6. If everything operates OK, the SPEED RC is ready to run.

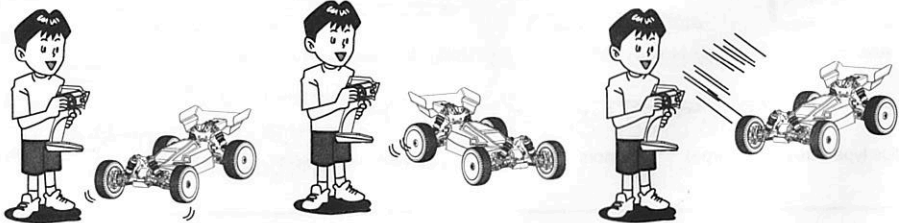
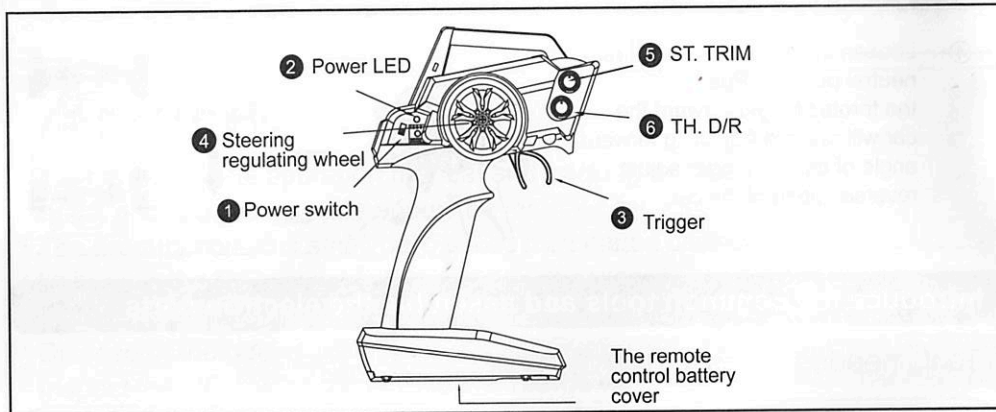

Practice

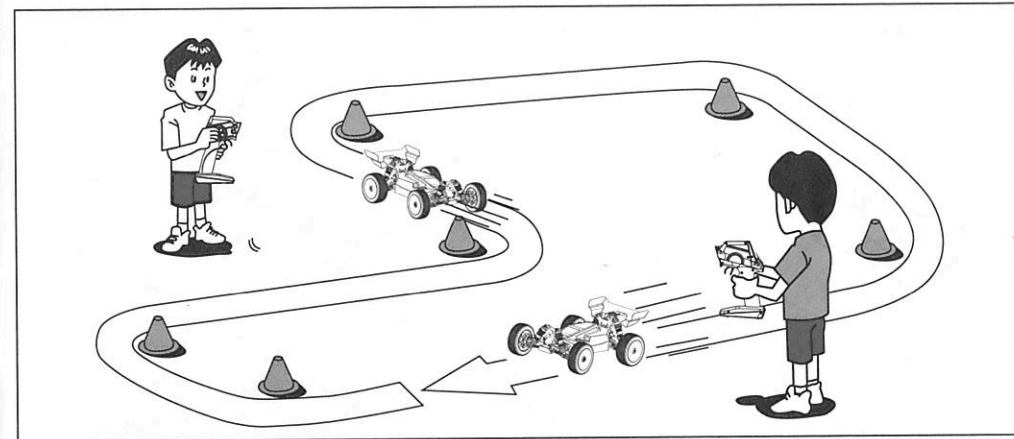

Let's practice! Make an R/C car circuit at a wide and safe location using corner pylons (available separately), empty cans or such. Drive fast on straight section and slow down for curved sections.

Maintain

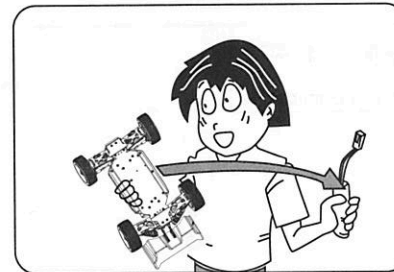

When the car is not in use, you should remove the battery from the car.



Completely remove sand, mud, dirt etc.

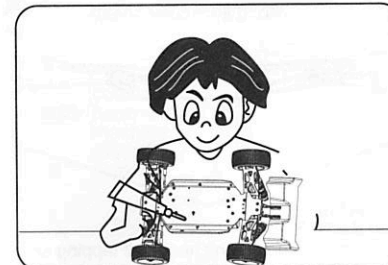

Apply the rust prevention oil to metal parts.

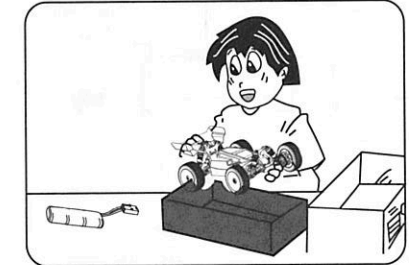

Store the car and batteries separately when not in use.

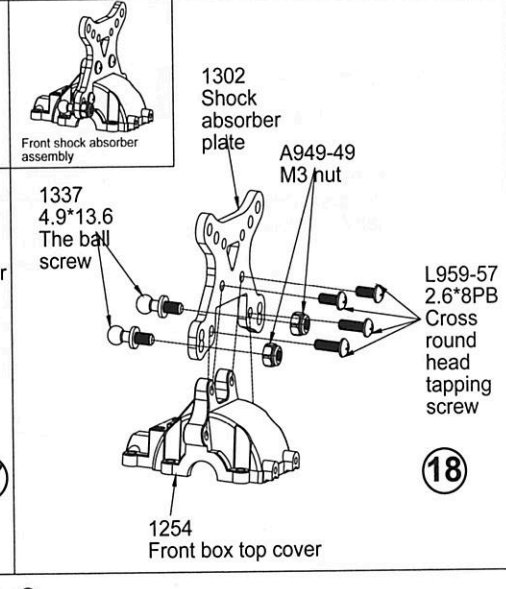
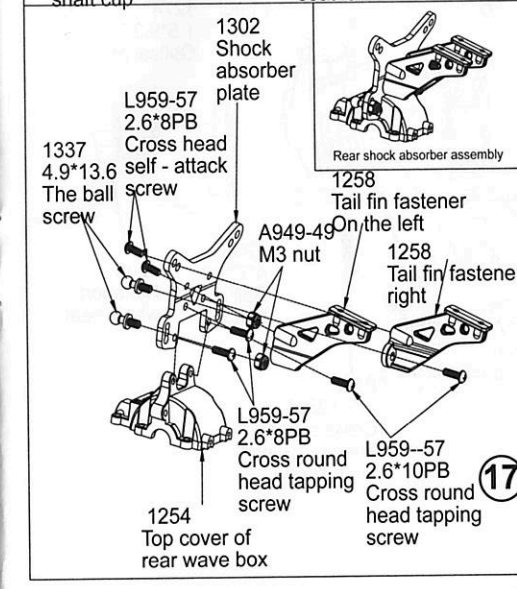
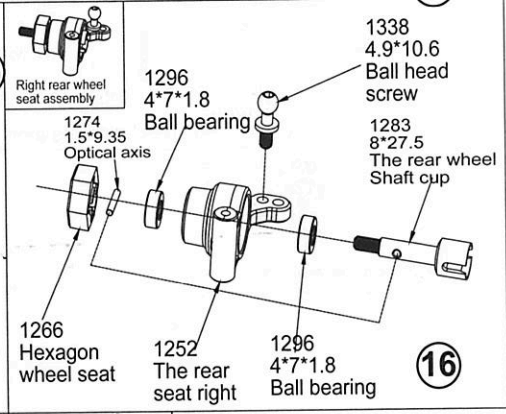
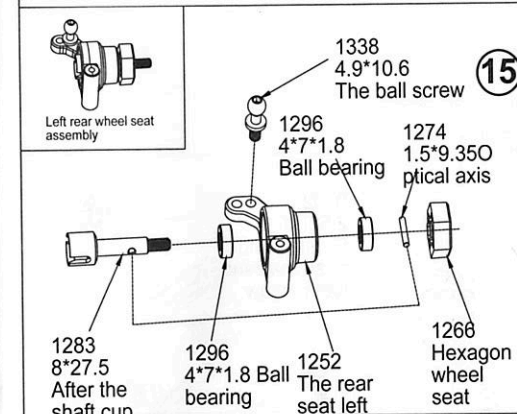
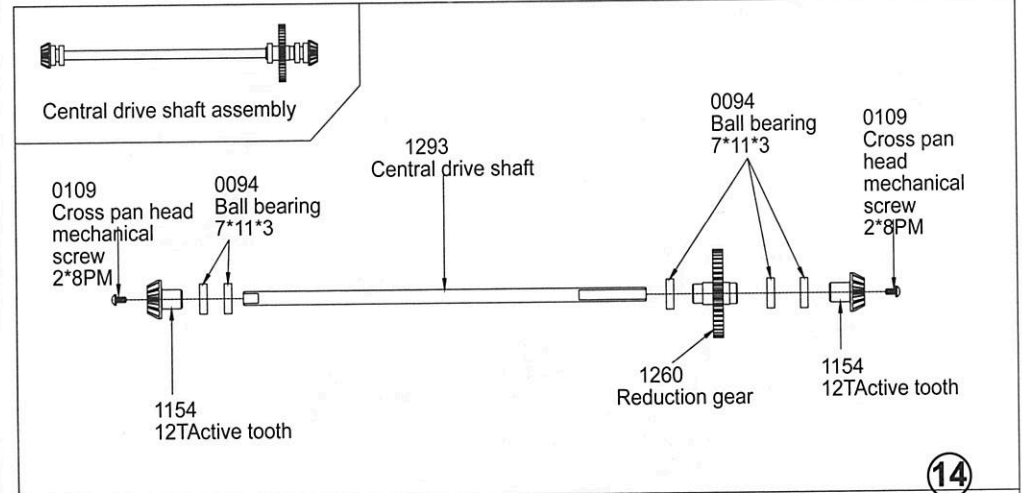
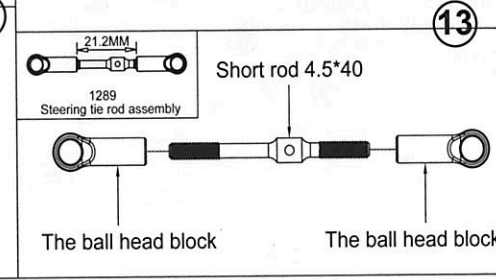
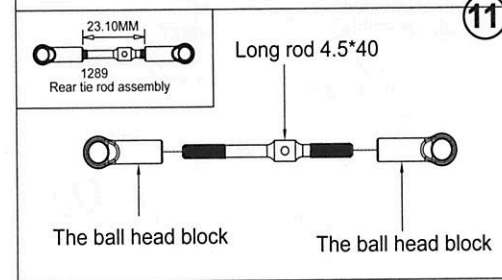
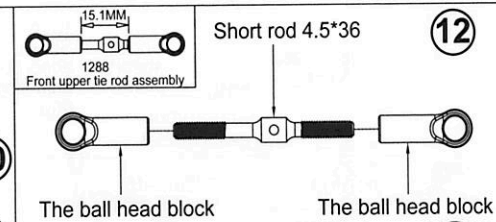
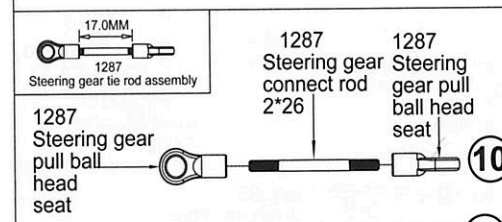
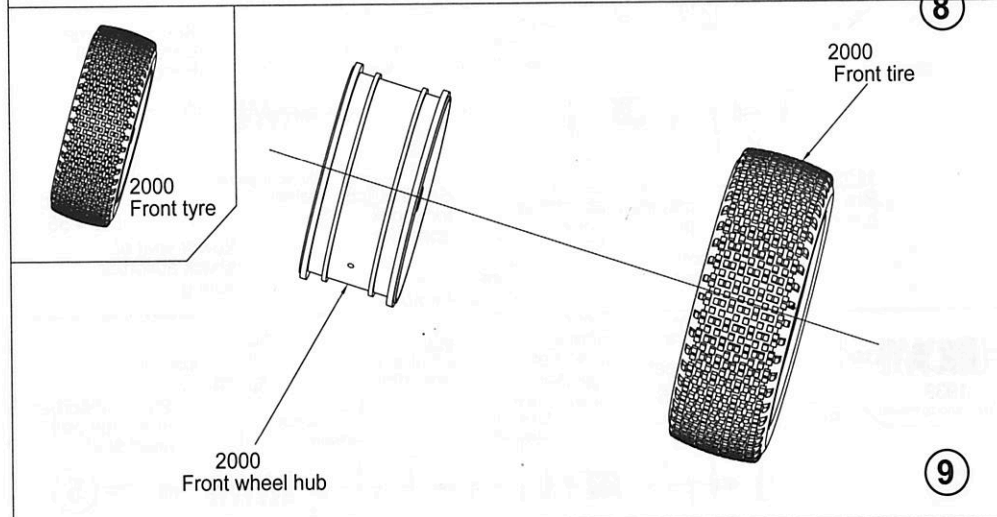
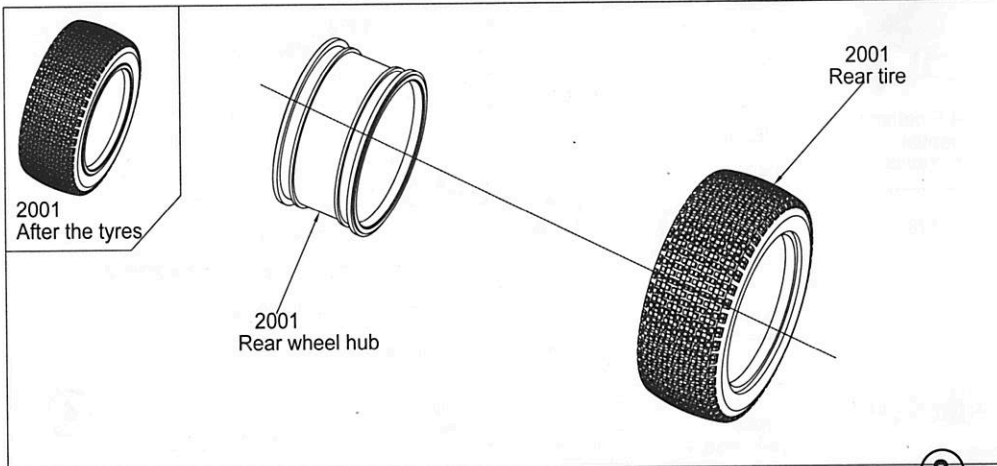

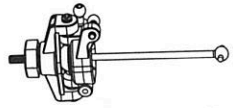

Front right steering seat assembly

0102
2.5*10PM
Cross round
head machine
tooth screw

19

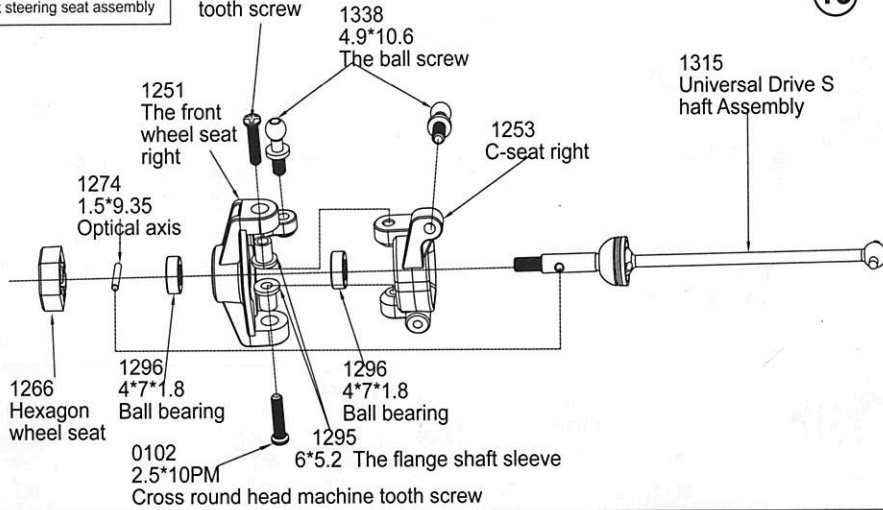

1266
Hexagon
wheel seat

1296
4*7*1.8
Ball bearing

1296
4*7*1.8
Ball bearing

0102
2.5*10PM
Cross round head machine tooth screw

1295
6*5.2 The flange shaft sleeve

1315
Universal Drive S
haft Assembly

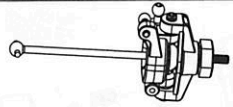

Front turn left to seat assembly

20

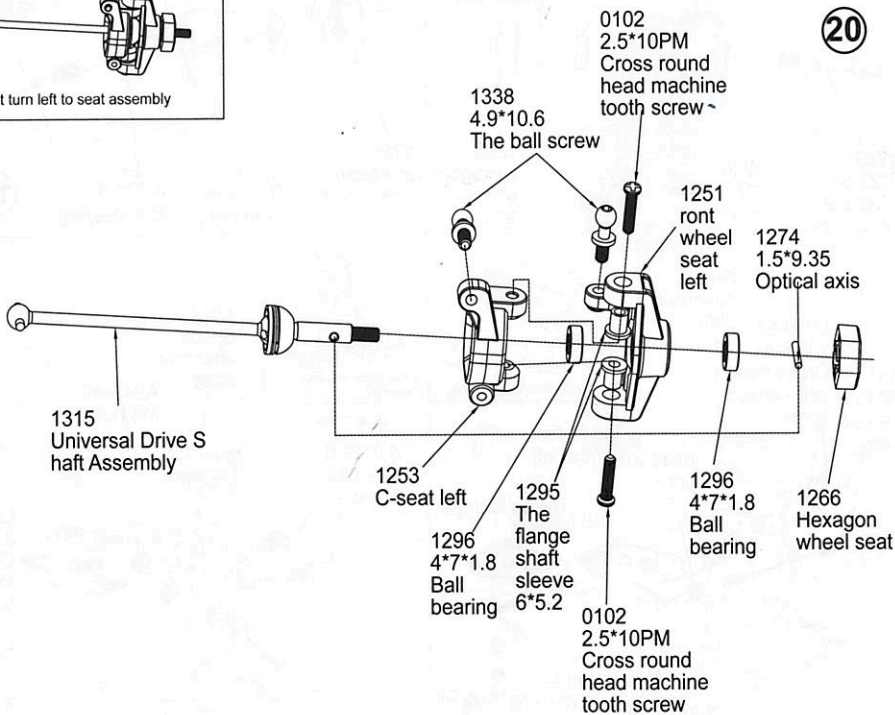

1315
Universal Drive S
haft Assembly

1253
C-seat left

1296
4*7*1.8
Ball bearing

0102
2.5*10PM
Cross round
head machine
tooth screw

1295
The flange
shaft
sleeve
6*5.2

1296
4*7*1.8
Ball
bearing

1274
1.5*9.35
Optical axis

1338
4.9*10.6
The ball screw

0102
2.5*10PM
Cross round
head machine
tooth screw ~

1251
ront
wheel
seat
left

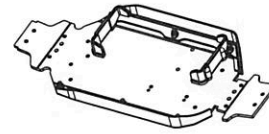

1261
Battery
compartment
partition-A

1323
2.6*5KB
Cross countersunk
head self tapping
screw

1255
Bottom edge left

21

1249
Vehicle bottom

1255
Bottom rail right

1323
2.6*5KB Cross countersunk head self tapping screw

L959-54
2.6*8KB Cross
countersunk
head self tapping
screw

1323
2.6*5KB
Cross countersunk
head self tapping
screw

1261
Battery
compartment
partition-B

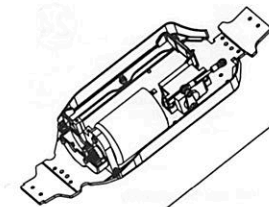

Brushless
motor group

2003
Steering gear components

22

1262
Bottom of
reduction gear
box

1287
Steering gear tie rod assembly

L959-54
2.6*8KB
Cross countersunk head self tapping
screw

0114
2.5*8KM
Countersunk hear screw

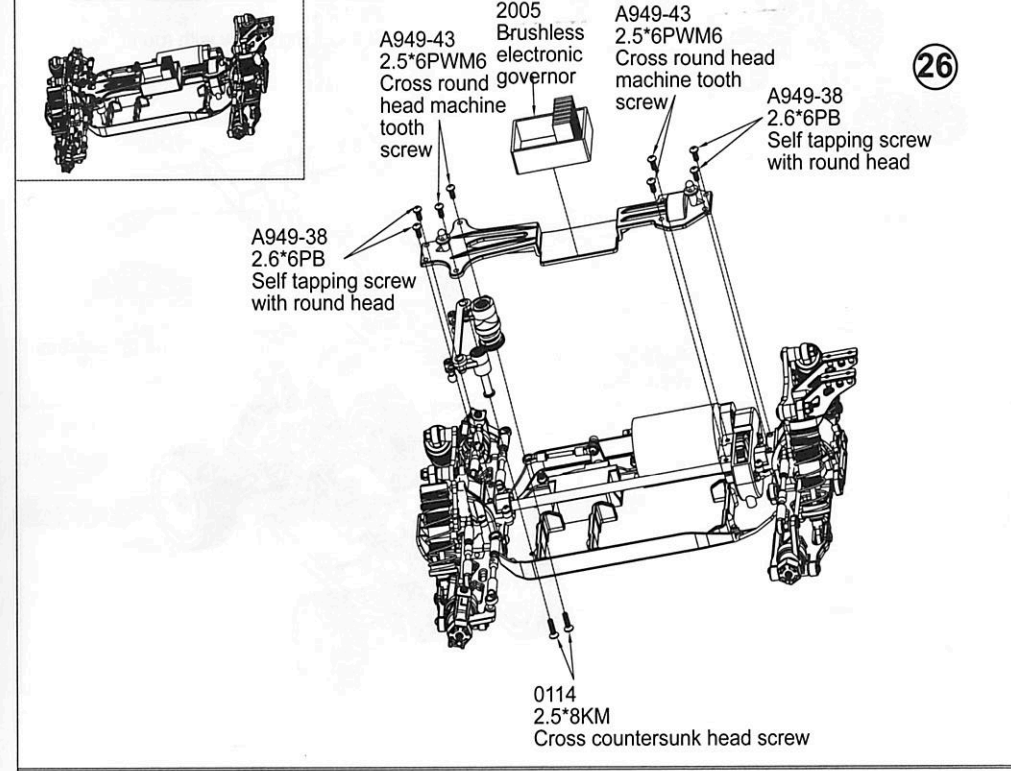
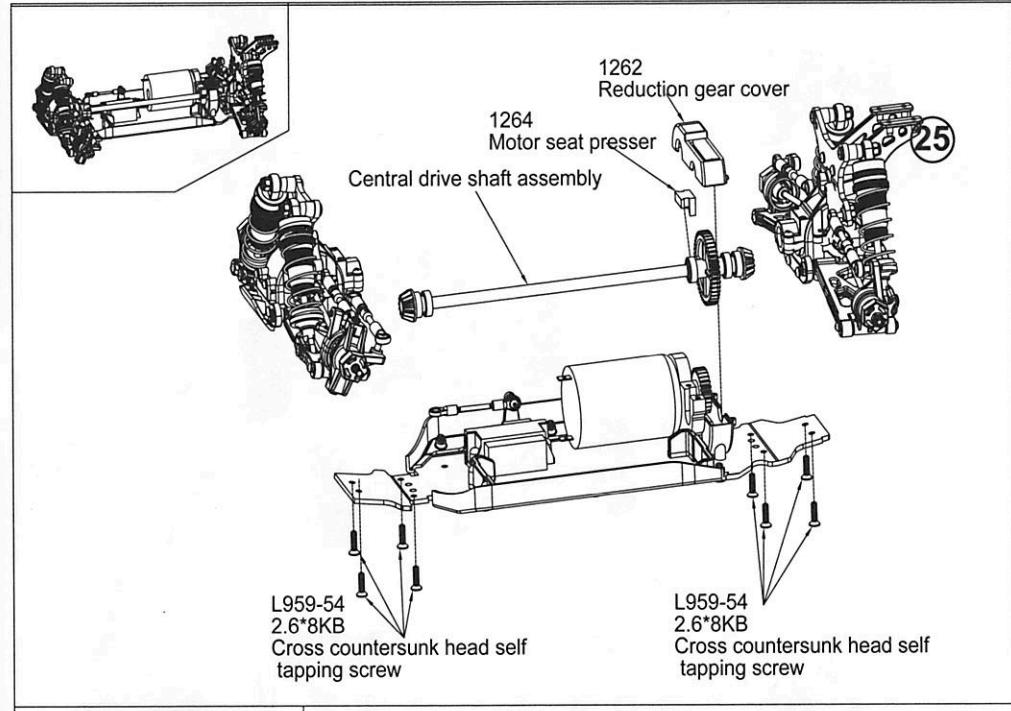
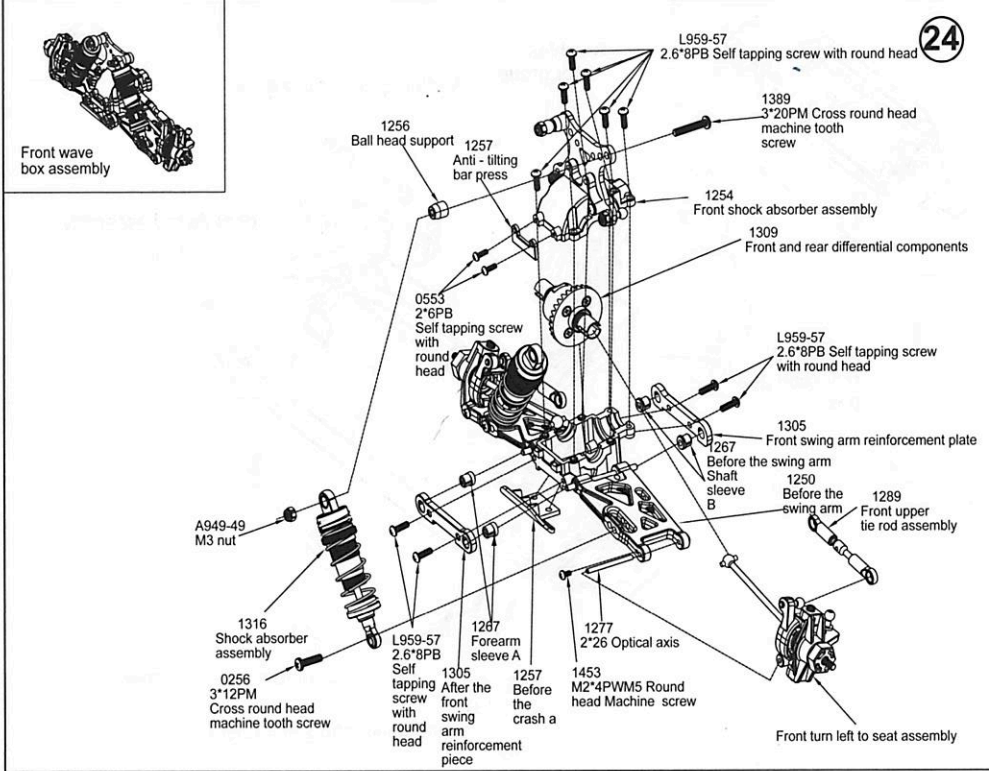
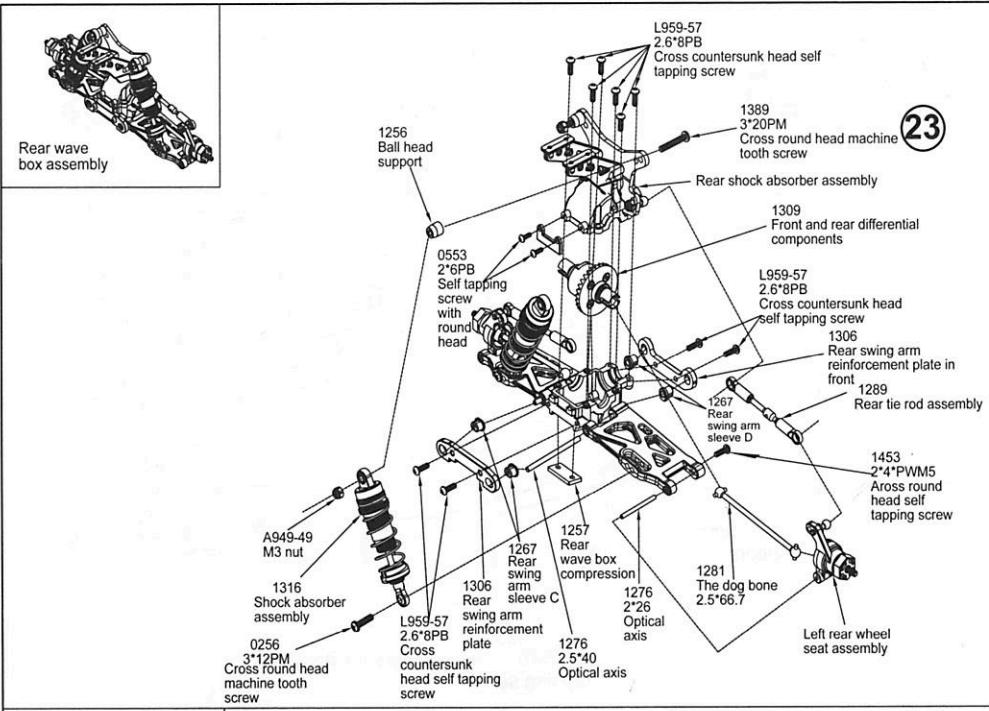

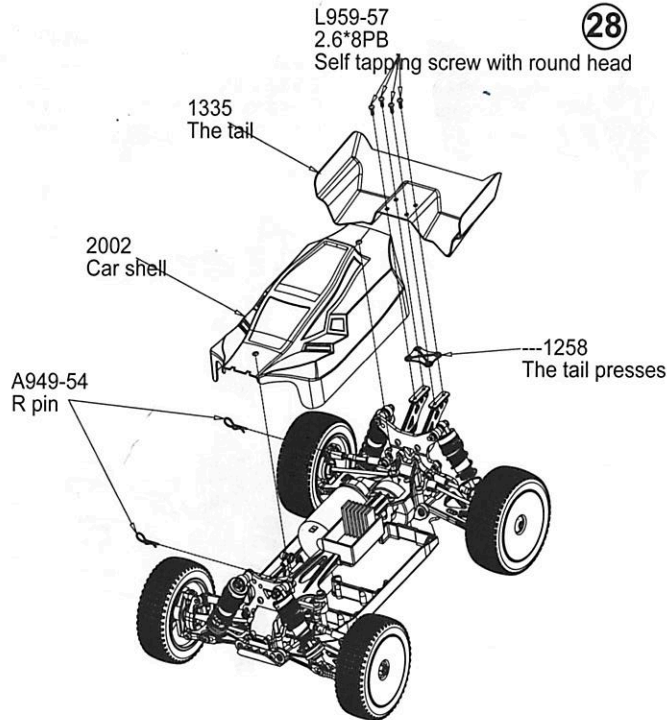
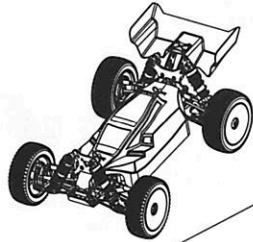
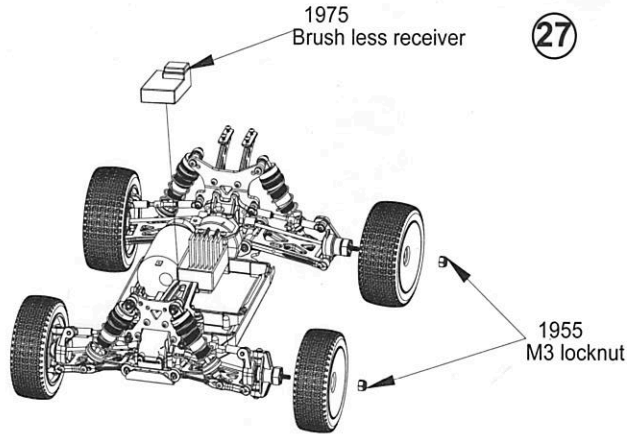
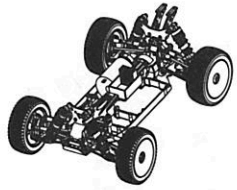

Sale parts view

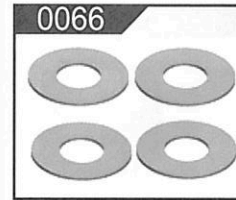

12*5.2*0.2
Stainless steel gasket

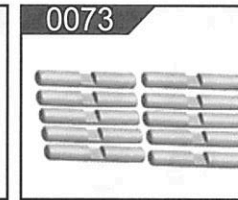

Planet gear axis

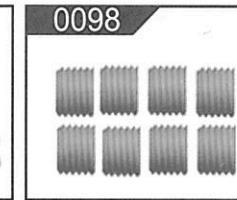

M3*3 Include screw

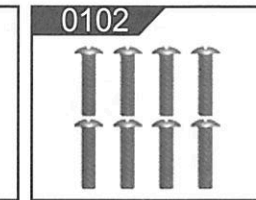

2.5*10PM
Cross round head screw

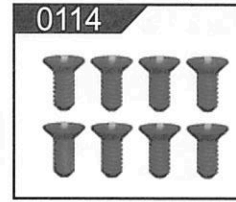

2.5*8KMCross
countersunk head screw



3*8KMCross
countersunk head screw

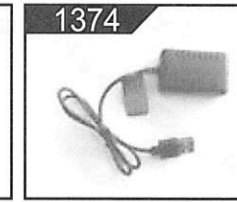

USB Charger

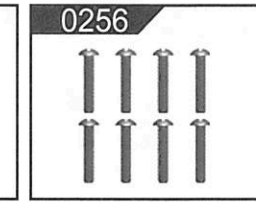

3*12PM
Cross round head screw

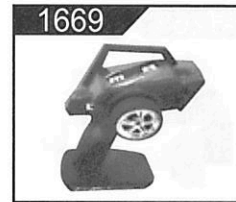

V2-144001
Remote controller



2*6KM Cross
countersunk head screw



2*6PB
self tapping screw
with round head

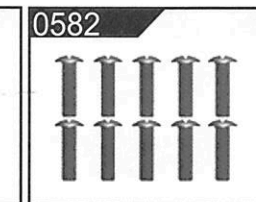

ST2*7PB screw
assembly

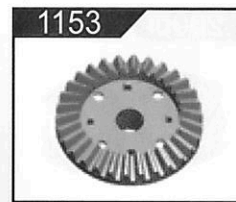

30T Differential
largeTeeth(Hardware)

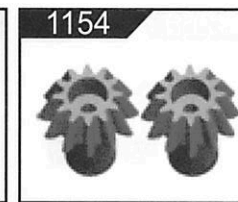

12T ActiveTeeth
(Hardware) Grou

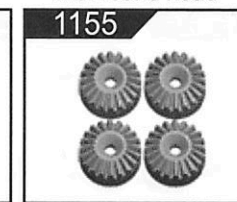

24t differential gear
(hardware) group

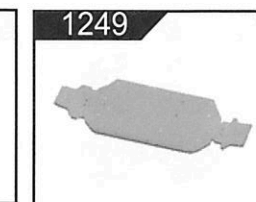

Chassis Plate

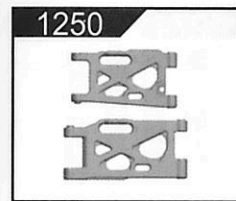

Front and rear arms

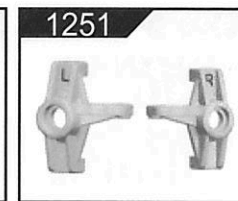

Front seat
assembly



Rear seat assembly



C-seat assembly

Sale parts view



1254
Wave box upper and lower cover group



1255
Left and right sides

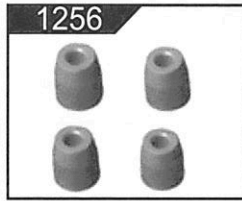

1256
Support piece as-ball head

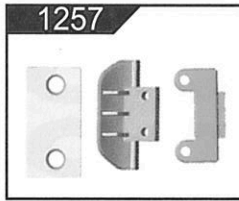

1257
Collision avoidance parts group



1258
Tail firmware Wing group



1259
Two floor group

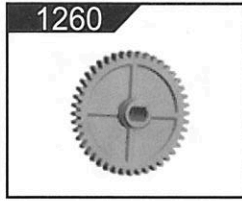

1260
Gear reducer gear

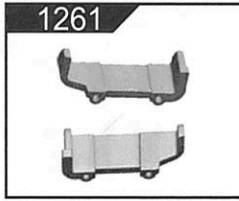

1261
Battery holder



1262
Reduction gearbox



1263
Rocker arm of steering gear

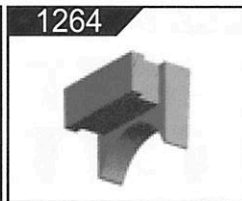

1264
Motor seat pressure piece

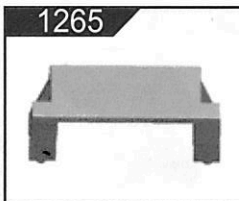

1265
Steering gear base



1266
hub drive hex

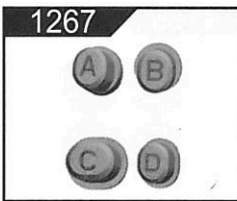

1267
Front and rear swing arm shaft sleeve



1268
Steering clutch group

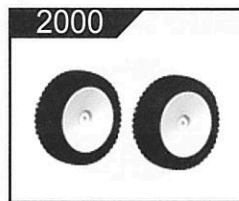

2000
Front tire

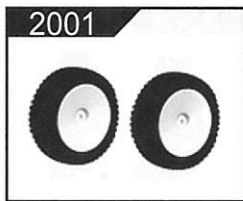

2001
Rear tire



1271
10T Differential Astero Teeth (Hardware) Group

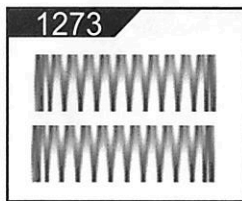

1273
Shock absorber spring

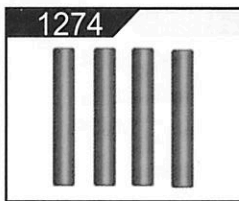

1274
1.5*9.35 universal shaft group

Sale parts view

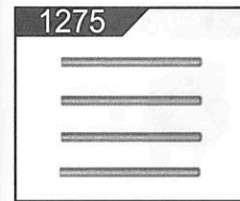

1275
1*9 Optic axis

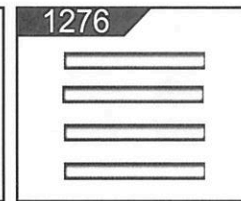

1276
2.5*40 Optical axis

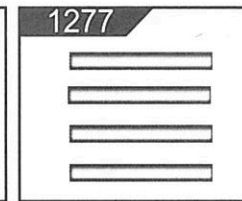

1277
2 * 26 Optical axis

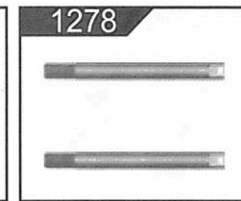

1278
Shock absorber shaft component

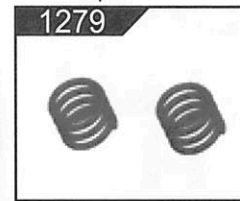

1279
Buffer spring assembly

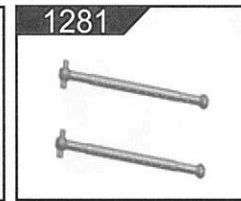

1281
Dog bone assembly

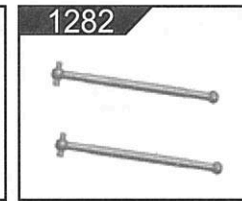

1282
universal shaft assembly

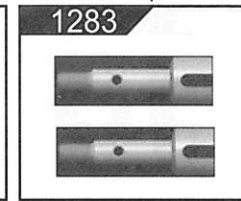

1283
Rear Wheel Cup Component

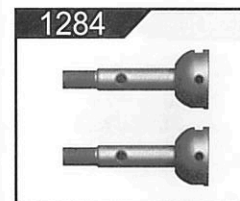

1284
Front Wheel axis Component

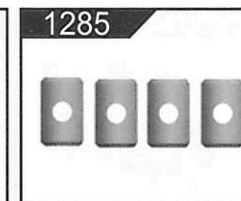

1285
Cross shaft assembly

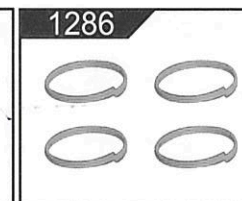

1286
Universal cup spring assembly

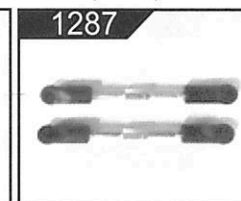

1287
Steering gear lever assembly

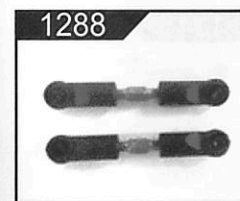

1288
Short pull bar assembly

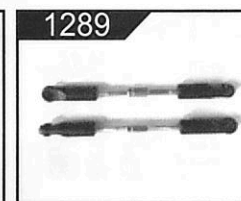

1289
Long pull bar assembly

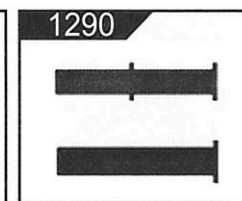

1290
Steering column assembly



1291
Steering column sleeve component

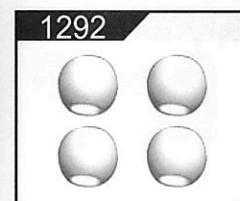

1292
Ball head group



1293
Central Transmission Axis Component



1294
6*2.7 Flange axis sleeve



1295
6*5.2 Flange axis sleeve

Sale parts view



1296
4*7*1.8
Ball bearing set

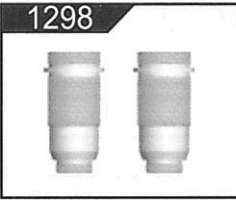

1298
Cylinder as-shock
absorber

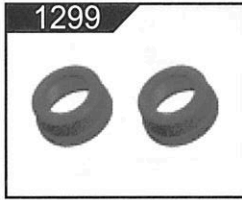

1299
Shockproof hat group

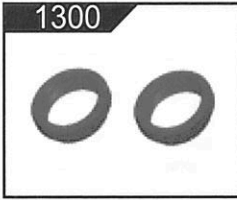

1300
Adjusting ring group

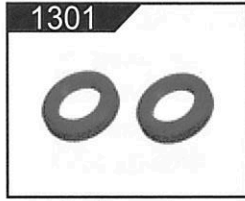

1301
Spring seat

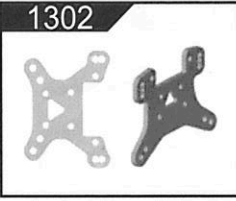

1302
Shock absorber plate group



2006
Motor seat

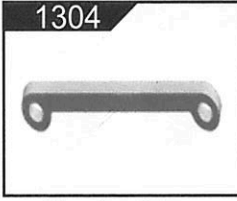

1304
Steering linkage

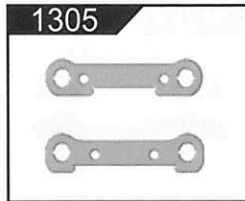

1305
Front swing arm
reinforcement



1306
Rear swing arm
reinforcement



2003
Brush less
steering gear



2004
Brushless motor



1309
Differential

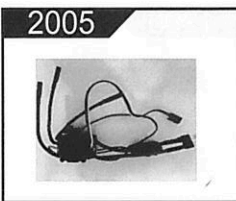

2005
Brushless /
electronic governor

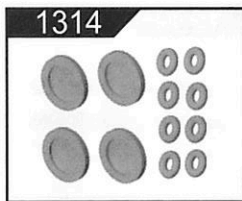

1314
O-ring as-shock



1315
Universal drive shaft

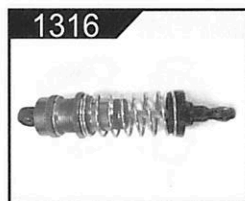

1316
Shock absorber



1323
2.6*5KB
Countersunk head
tapping screw



2002
Car shell
components

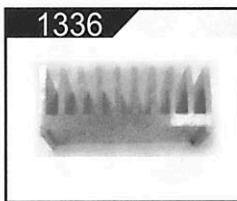

1336
Heat sink

Sale parts view

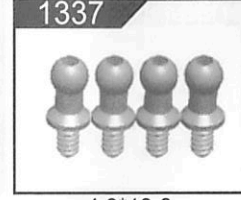

1337
4.9*13.6
Ball head screw set

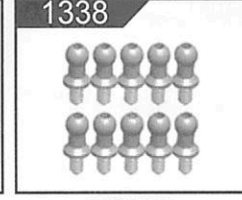

1338
4.9*10.6
Ball head screw set



A202-04
4.0*9.5
Ball head screw set



A202-15
2*8KB Cross
countersunk head screw set

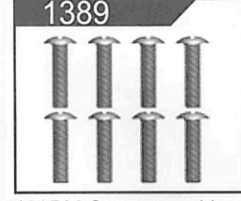

1389
3*20PM Cross round head
machine tooth

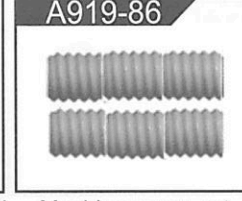

A919-86
Machine screw set



A949-22
Velcro



A949-35
7*11*3
Ball bearing



A949-38
2.6*6PB Round head self
tapping screw



A949-43
M2.5*6*6
Round head belt screw



A949-49
M3 Nut



A959-B-15
Motor gear



A959-B-23
Battery

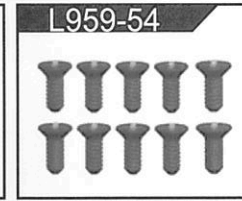

L959-54
2.6*8KB
Countersunk head
tapping screw



L959-57
2.6*8PB
Round head self
tapping screw

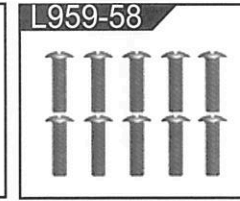

L959-58
ST2.6*10 PB
screwassembly

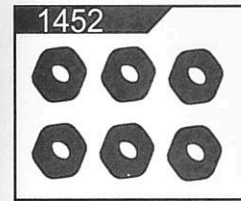

1452
M3 flange nut

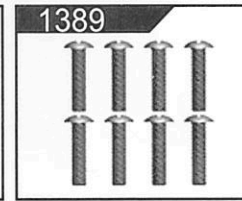

1389
3 * 20pm Cross
round head
machine screw

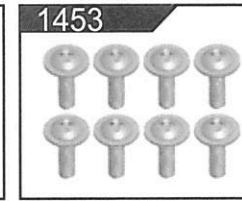

1453
2*4PWM5
Cross round head
machine screw

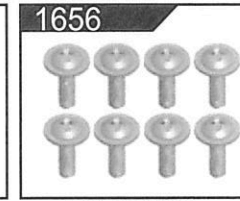

1656
2.5*8PWM6
Cross round head
machine screw

Sale parts view

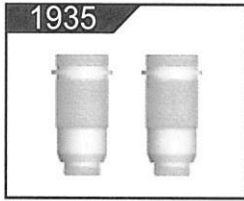

1935
Front shock
block group

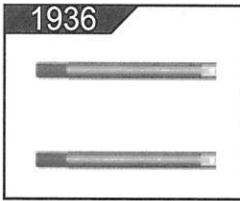

1936
Front shock
absorber axis group

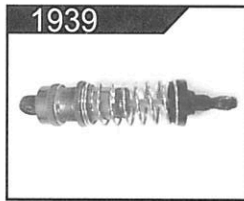

1939
Front shock mount

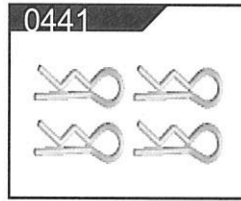

0441
1.0*18
R Type Pin



1280
Cup as-differential

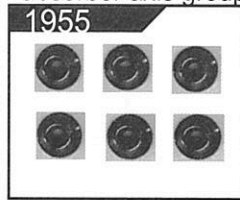

1955
M3 flange lock nut

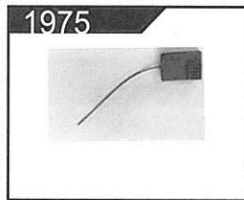

1975
Brush less receiver

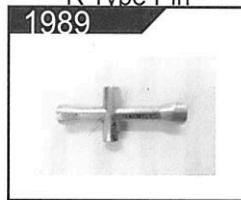

1989
Zinc alloy cross
sleeve group