

1:10 Electric 4WD Climbing car



Caution: This model is not a toy, it is designed for user over 14 years of age.
Please use this instruction and the R/C system instruction at the same time.
The instruction is suitable for a type of model whose number is 104016

Safety and caution	1-2
Troubleshooting • Product introduction	2-3
Instruction of common tools and installation the electronic part...	4-5
Practice and maintenance.....	5-7
Assemble exploded view	8-17
Fittings view	18-23

Safety and Cautions

- *Never run the model on public roads or streets, as it could endanger traffic.
- *Never run the model in crowded areas, near or toward people or animals, to prevent property damage and/or personal injury.
- *Never run the model near rivers, ponds or lakes as to prevent R/C car from dropping into the water.
- *Make sure that no one else is using the same frequency as yours in your running area. Using the same frequency at the same time, whether it is driving, flying or sailing, can cause loss of control with R/C model, resulting in serious accidents.
- *To avoid a runaway R/C model or loss of control, always follow the procedure below:
 1. Fully extend transmitter antenna.
 2. Switch on transmitter.
 3. Switch on R/C model.
- *Follow reverse procedure to shut down.
- *Never touch or hinder rotating tire.
- *Never run R/C model in the rain or let run over puddles, as water may cause trouble with R/C model.
- *Motor and battery get very hot after running. Take care when handle them.
- *Retract transmitter antenna when not in use.
- *Remove the batteries from model and transmitter when they are not in use.

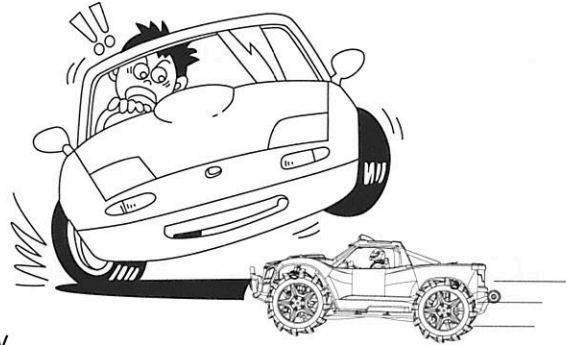

Cautions when handling batteries

- *Do not dismantle the battery or charger and do not cut any battery cables. This may cause short-circuit and/or damage to the product.
- *Change battery with compatible charger following proper procedure that is called out in the instructions. Do not modify charger or charge battery in improper way.
- *Do not recharge battery that is still warm from use as it may damage the battery. Allow the battery to cool off prior to recharging.
- *Make sure to disconnect charger cables from R/C model and electric outlet when not in use.
- *Remove transmitter battery when not using it for a long time as it may leak and damage transmitter when left for a long period.
- *Never incinerate used batteries, as they can explode causing serious accidents.



Safety precautions

Do not operate the model on public roads, in crowded places or near infants, it may cause accidents or injury.

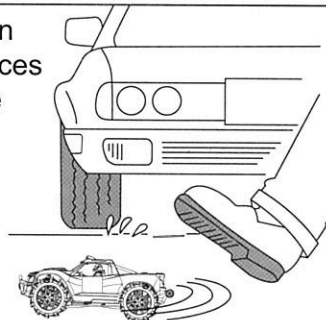

As the product includes small and sharp parts, assemble and store this product only in places out of the reach of children.

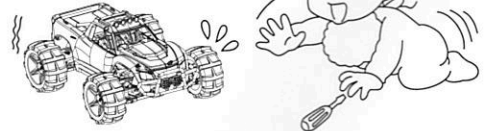

As the front end of the antenna may be dangerous, do not aim it toward faces.



During the car running and after, the motor will be hot. Please do not touch it until it has had time to cool down.

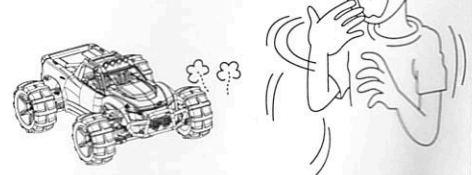

Don't use the same frequency with others at the same time. Or the car will lose control or even lead to serious accidents.

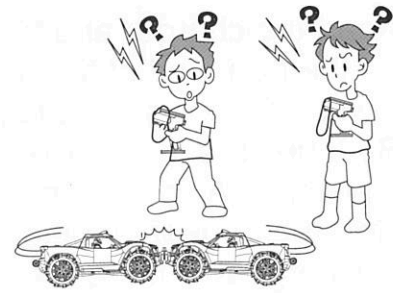

Troubleshooting

Description	Cause	Solution
The car does not operate at all.	Transmitter or receiver is off.	Turn on both transmitter and receiver.
	Batteries are not placed properly in the transmitter.	Place batteries in the transmitter properly.
	The drive battery is not charged enough.	Charge the drive battery.
The car does not follow your operation and control distance not enough long.	Someone else is using the same radio frequency as you are using.	Change your radio frequency to the one no one else is using, wait until the driver using the same radio frequency finishes driving, or drive your car at a different place.
	There is not enough power in the transmitter or receiver batteries.	Replace the transmitter batteries with new ones and charge the drive battery.
	Not tighten antenna on the transmitter/not fully extend antenna.	Make sure insert antenna into the transmitter and fully extend antenna.



CAUTION

- * Please observe the operation manual or packing explanation to install and use, and some parts should be installed by adults.
- * The product contains small parts, it may cause swallow or choke.
- * Never run an R/C model in the seep or rain, moisture areas, or it may cause the parts malfunction.
- * Please throw the wrapper in time to avoid danger for the children.
- * Regularly examine for damage to the charge, wire, plug, bodyshell or other parts. In the event of any damage, it must not be used until the damage has been repaired.
- * The charge, battery box and battery must insert with the appointed power source of product symbol same.
- * This product must only be used with the original collocation charger.
- * The product is contains the functional outshoots are may be dangerous to the children.

- * Apart the charger and toy before clean.
- * As the front end of the antenna may be dangerous,do not aim it toward anyone's body,face or eyes.
- * Batteries are to be inserted with the correct polarity.
- * Use the "AA" non-rechargeable or "AA" rechargeable batteries.
- * Non-rechargeable batteries are not to be recharged.
- * Rechargeable batteries should only be charged under adult supervision.
- * Rechargeable batteries must be removed from model before charger.
- * Different types of batteries or old and new batteries are not to be mixed.
- * Exhausted batteries are to be remove in time.
- * The supply terminals are not to be short-circuited.
- * Never short circuit the batteries. throw it in a fire or attempt to open their outer casings.
- * Please remove the batteries when not in use.
- * Please retain these instructions for future reference.

Product Introduction

- ★Type: 1:10 Electric 4WD Climbing car
- ★Product size:397*276*165mm
- ★Wheelbase:230mm
- ★The minimum distance of front and rear wheel: 125mm
- ★Ground clearance:50mm
- ★Transmission ratio:1:10.28
- ★Tire diameter: 105MM;wheel width:52mm
- ★ESC receiving server:Independent receiver
- ★Motor:3660 Brushless motor
- ★Remote control: 2.4G Remote control
- ★Remote control distance:≥100M
- ★Remote control battery: 4AA batteries (not included)
- ★Battery:Lithium battery 7.4V 2200 mAh
- ★Charger: lipo balance
- ★Charging time:3 hours
- ★Use time: 8 minutes
- ★Server:6kg servos
- ★Car shell: antiknock PVC printing car shell, beautiful Crashworthiness
- ★Driving speed: 55km/h.

Proportional R/C Using Instruction

- ① Turn left the steering wheel, the car will turn left. Turning left angle can be adjusted by the degree of wheel twisting.

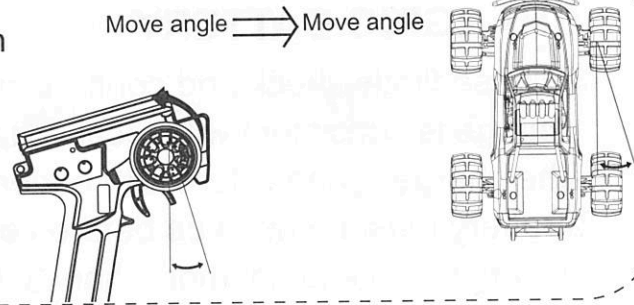

- ② Turn right the steering wheel, the car will turn right. Turning right angle can be adjusted by the degree of wheel twisting.

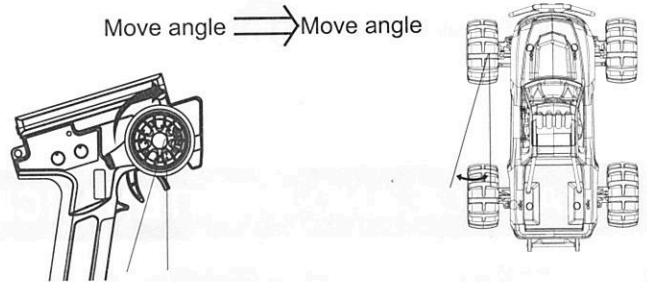

- ③ Pull the throttle trigger backward, the car will forward. Adjusting the angle of throttle trigger can adjust forward speed of the car. During the car forward, quickly push the trigger forward to stop it.

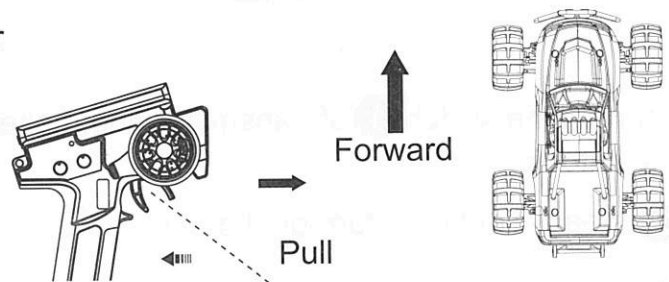

- ④ Loosen the trigger to make it return the neutral position when brake. Push the throttle trigger forward, the car will backward. Adjusting forward angle of throttle trigger adjust backward speed of the car.

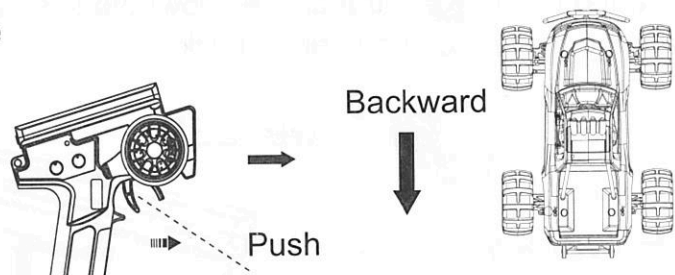

Introduce the common tools and assemble the electron parts

Tools needed for assembly

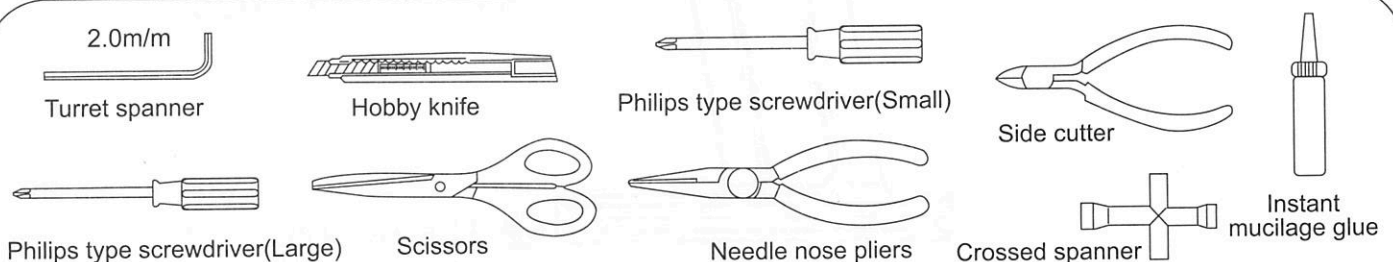

Charge caution

CHARGING BATTERY

- 1) Please firstly check and confirm input voltage of the charge is consistent with local voltage, output voltage of the charge is consistent with battery voltage.
- 2) Battery must be used up before you charge, Charging time is not more than 3 hours.
- 3) Be careful to make sure there is adult to control when charging.

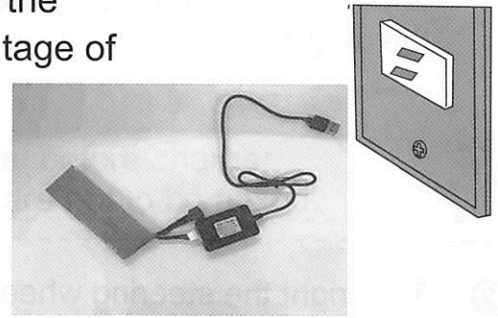

PRACTICE AND MAINTENANCE

Operating program

1> Turn on the switch ① of transmitter and make sure the power indicator is

② steady light, then turn on the car.

2> Slip the trigger ③ of transmitter slowly, you can observe the car whether it can go ahead or go back.

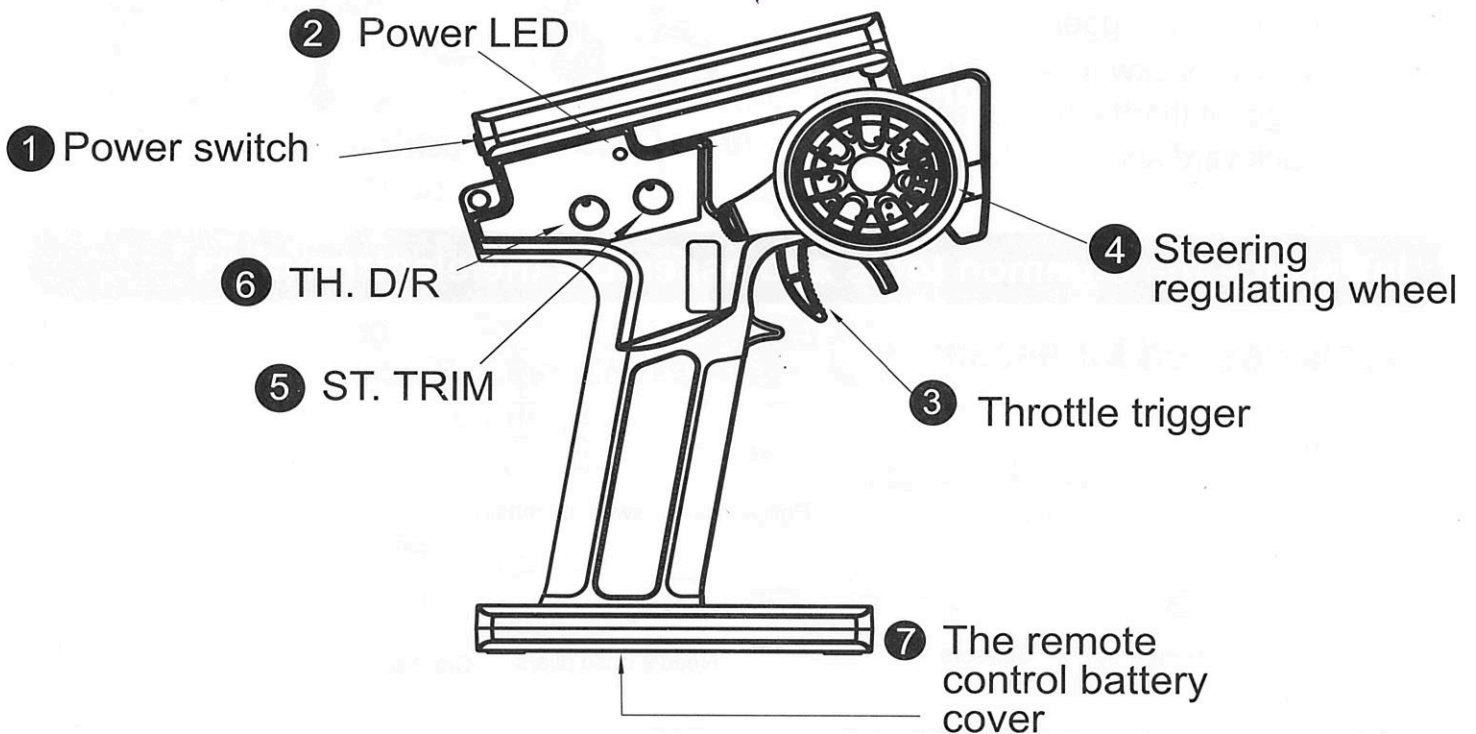

3> Turn steering regulating wheel ④ of transmitter to left or right, and make sure the steering of front wheels follow the instruction.

4> Put the car on the ground and stand behind the back of the car. Squeeze the throttle trigger ③ of transmitter gently. If the car does not move in a straight line, you can adjust the trim ⑤ of transmitter until the car moves in a straight line.

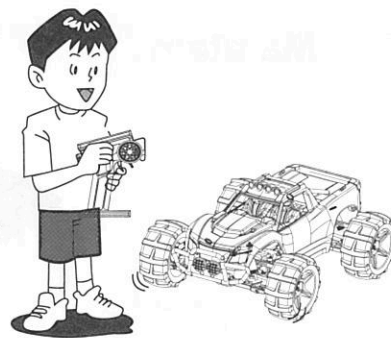

5> Throttle trim key ⑥, turn clockwise, the car became faster and faster; counterclockwise rotation, the speed will slow down.

6> OK, ready to run

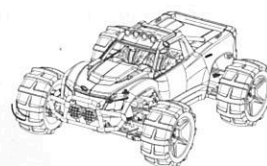
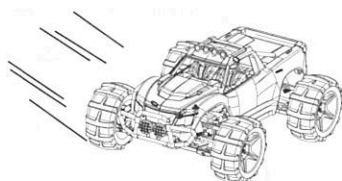

Practice

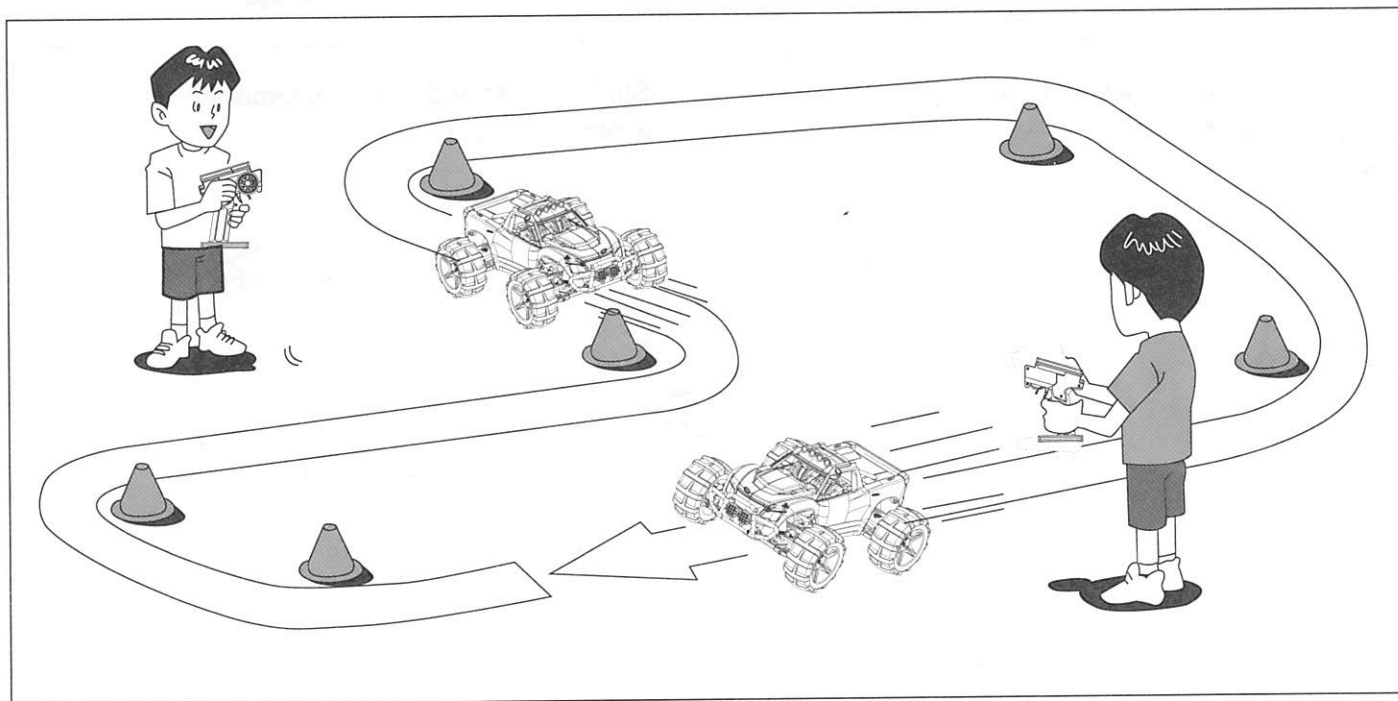

Let's practice! Make R/C car circuit at a wide and safe location using corner pylons (separately available), empty cans or such. Running fast at straight section and slow down at curved section is a basic speed control technique useful when driving R/C car.

Maintain

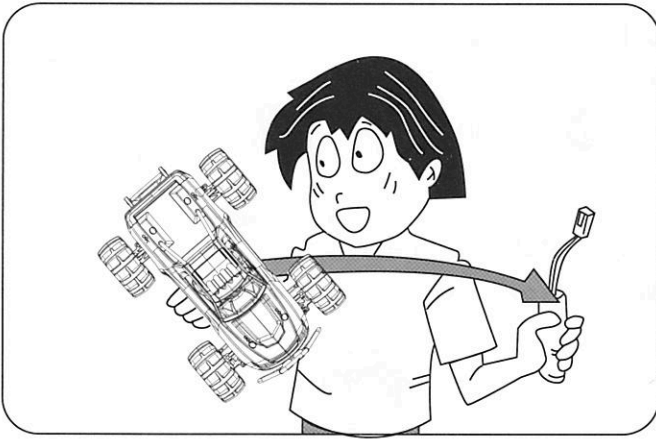

When the car is not in use, you should remove the battery from the car.

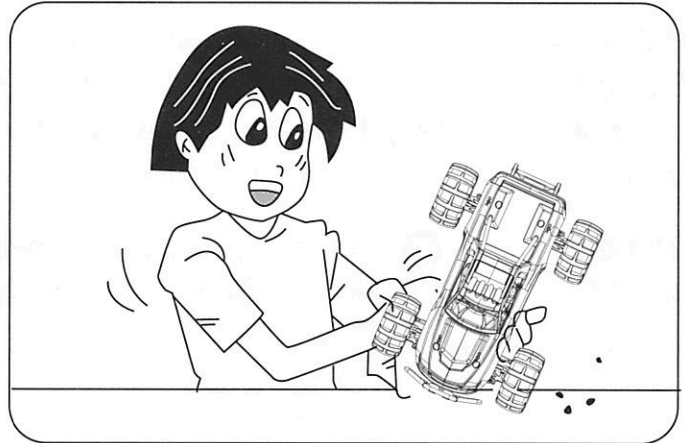

Completely remove sand, mud, dirt etc.

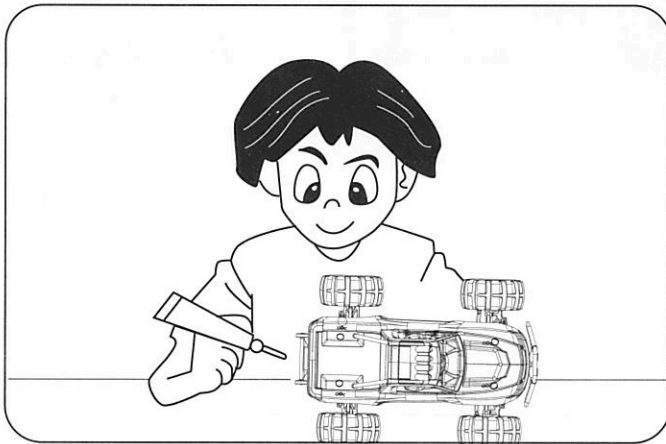

Metal outside should apply the rust prevention oil.

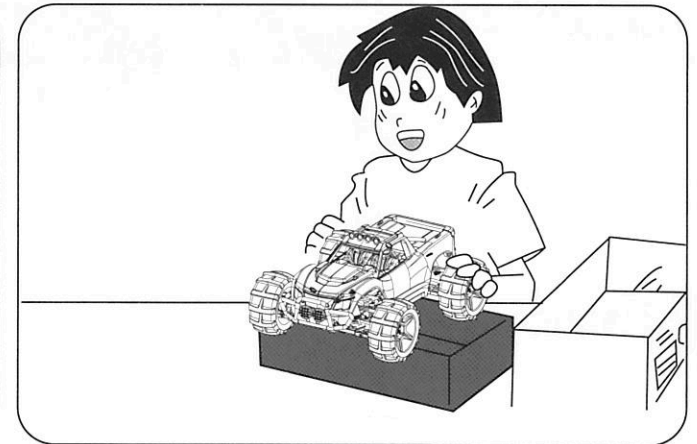

Store the car and batteries separately when not in use.

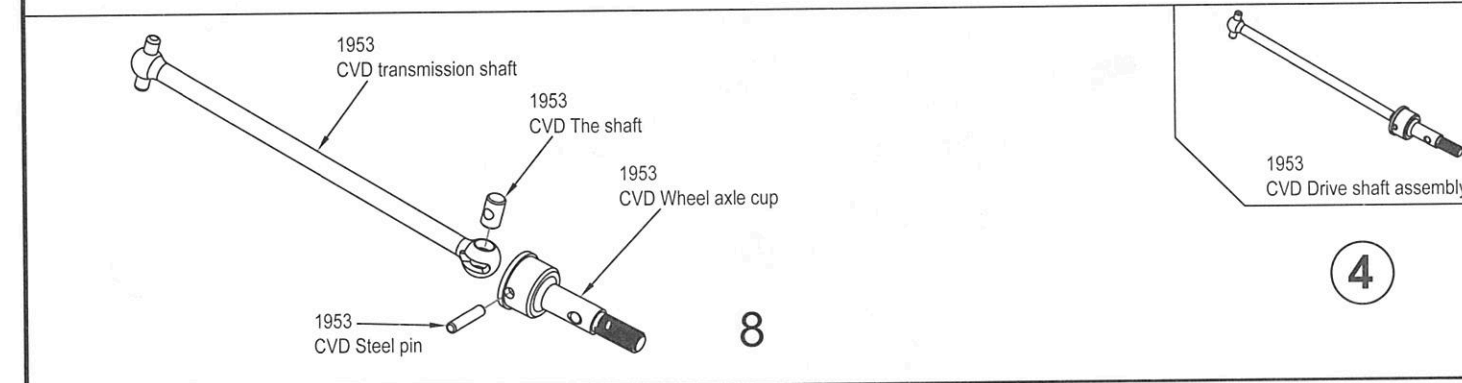
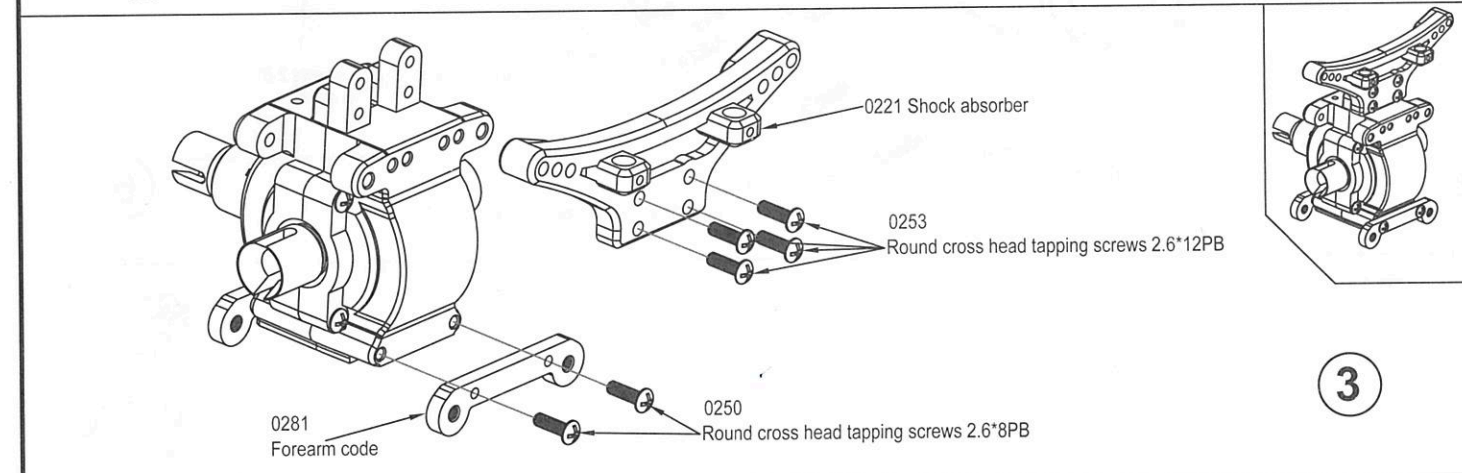
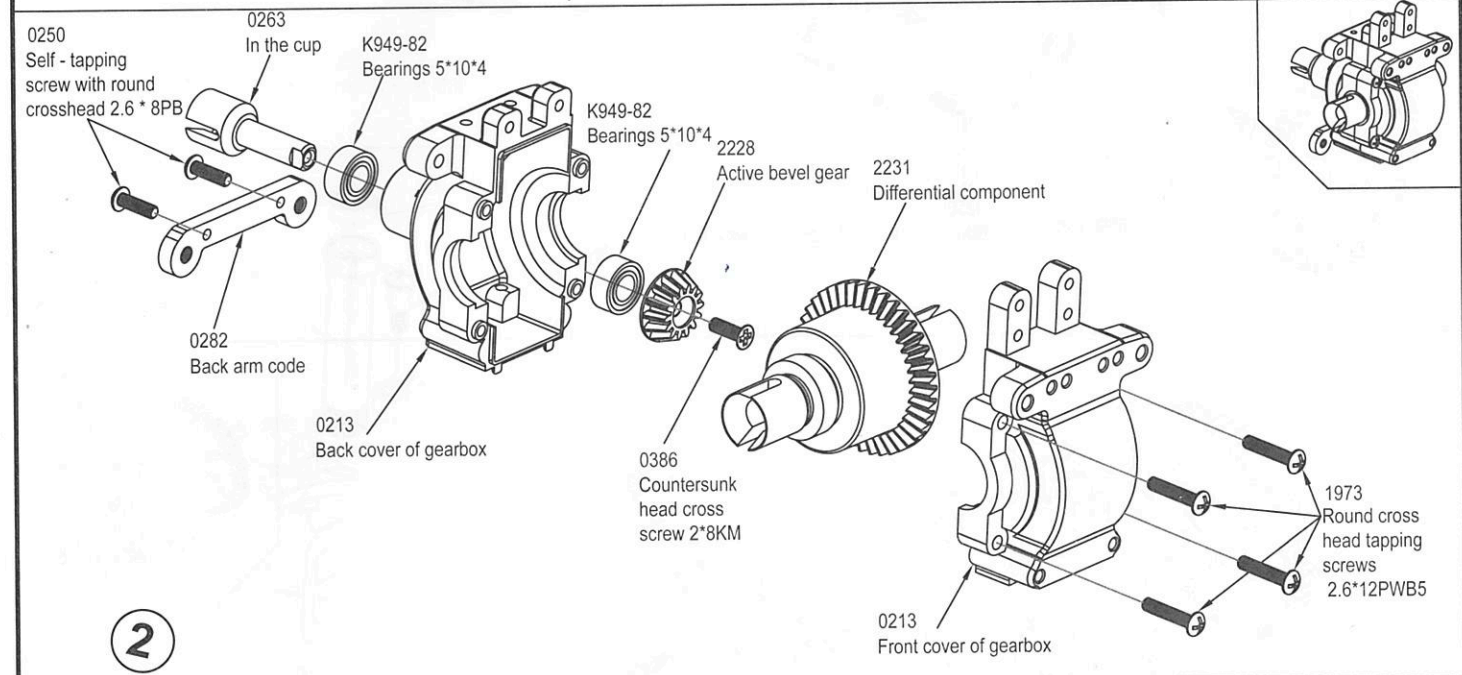
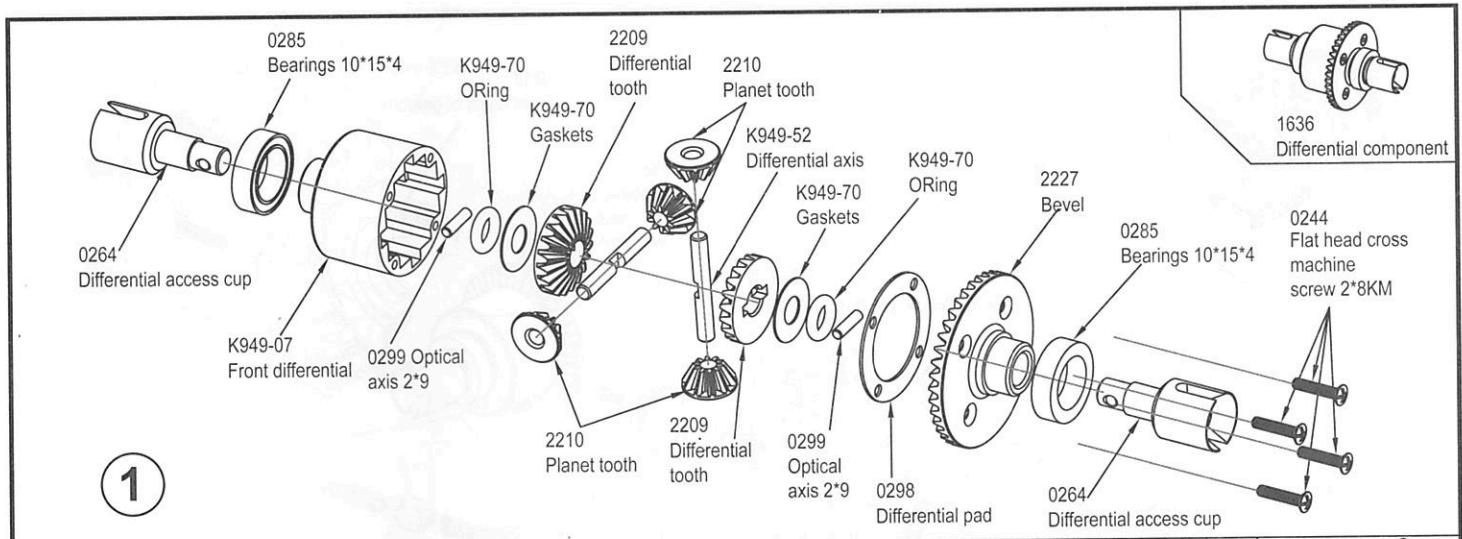

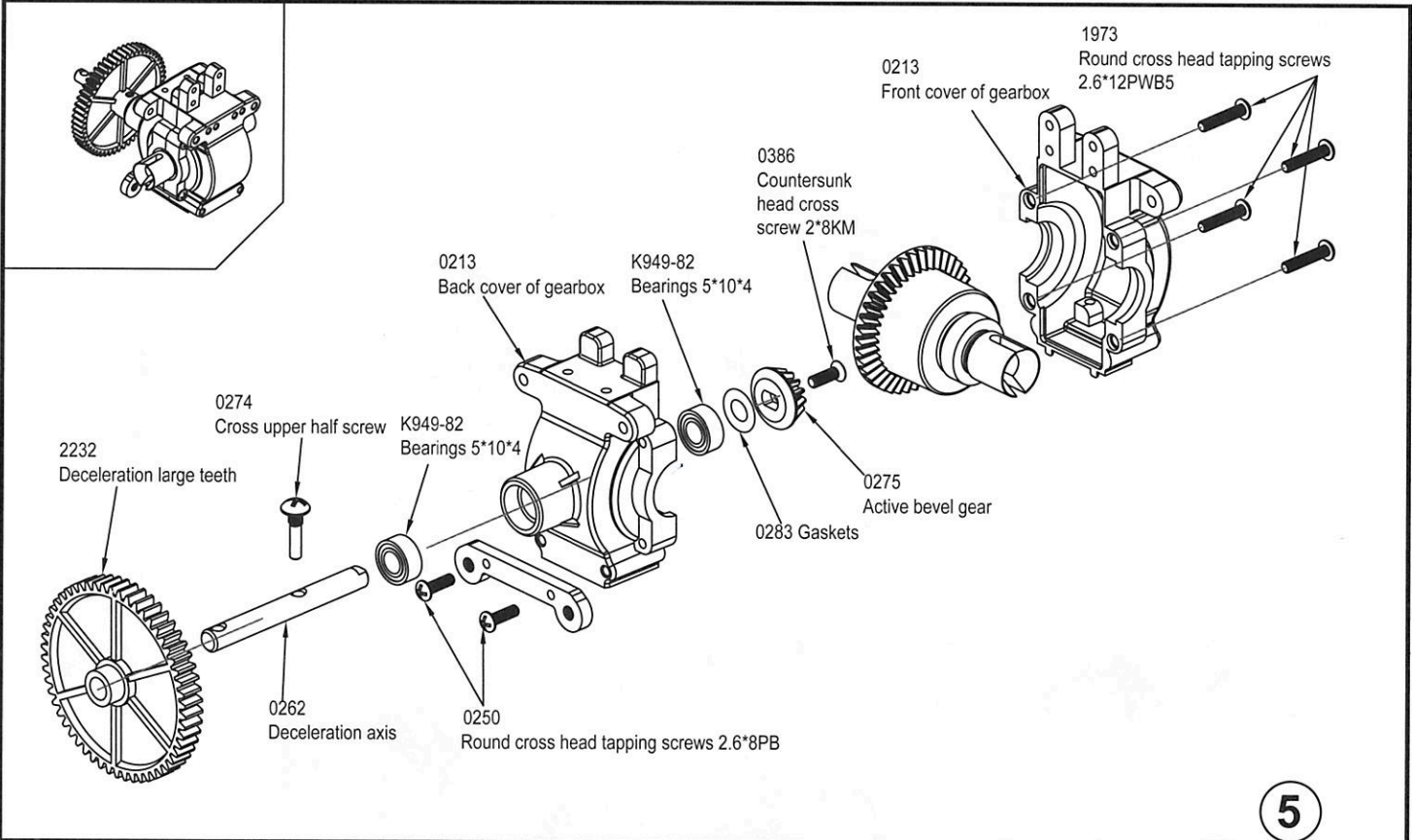

5

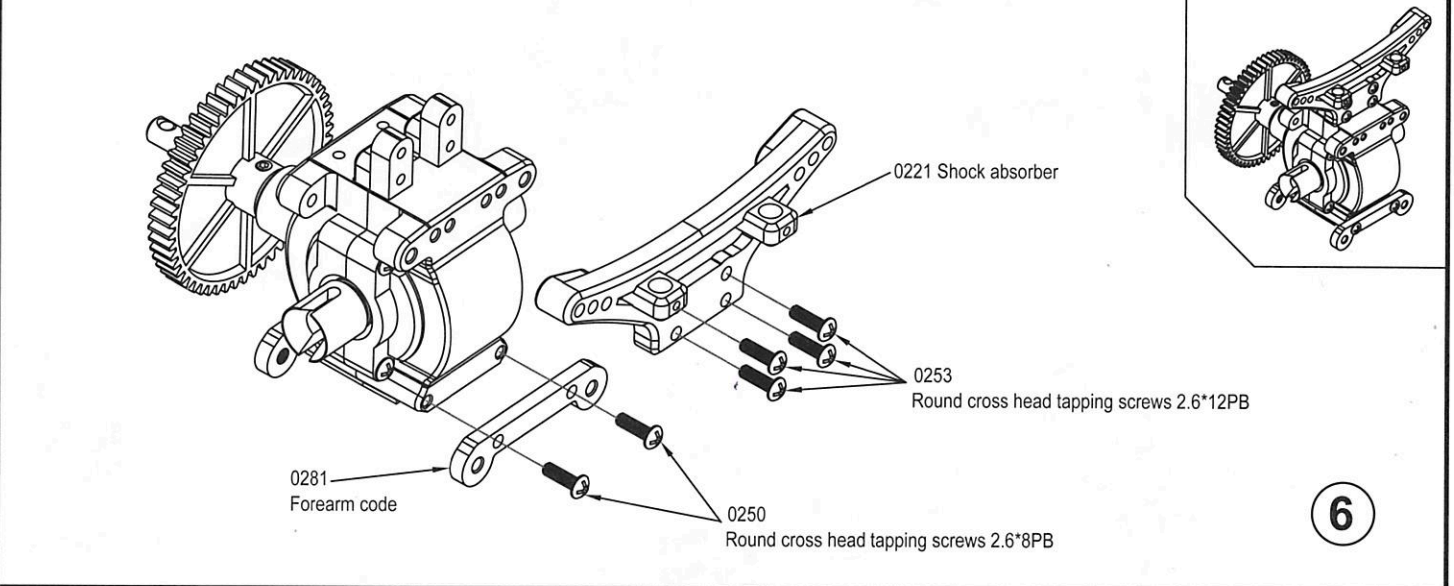

6

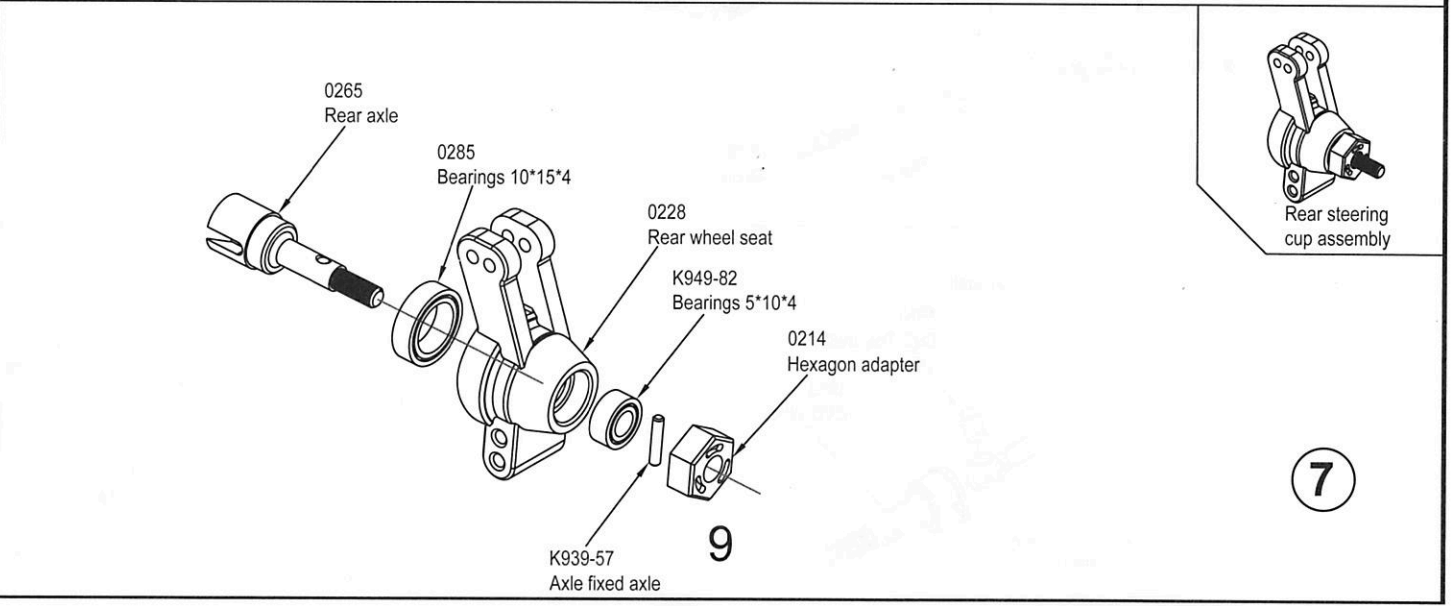

7

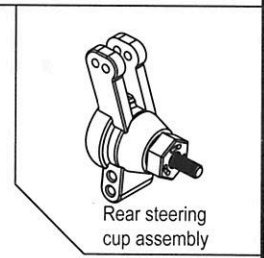
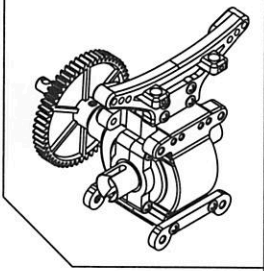

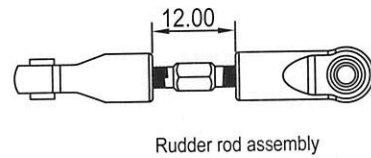
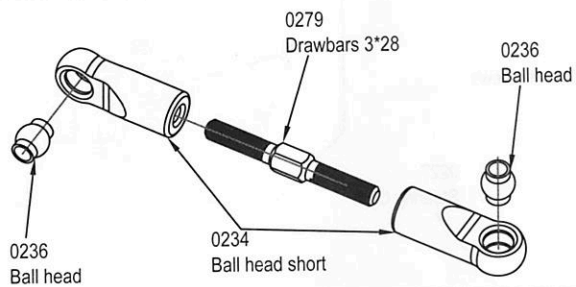

8

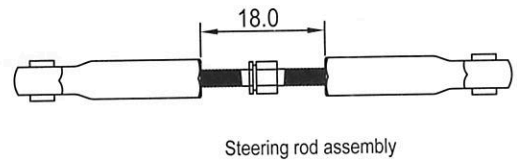
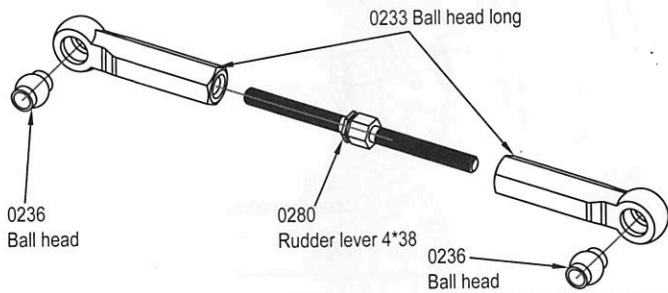

9

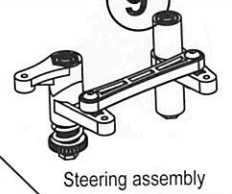
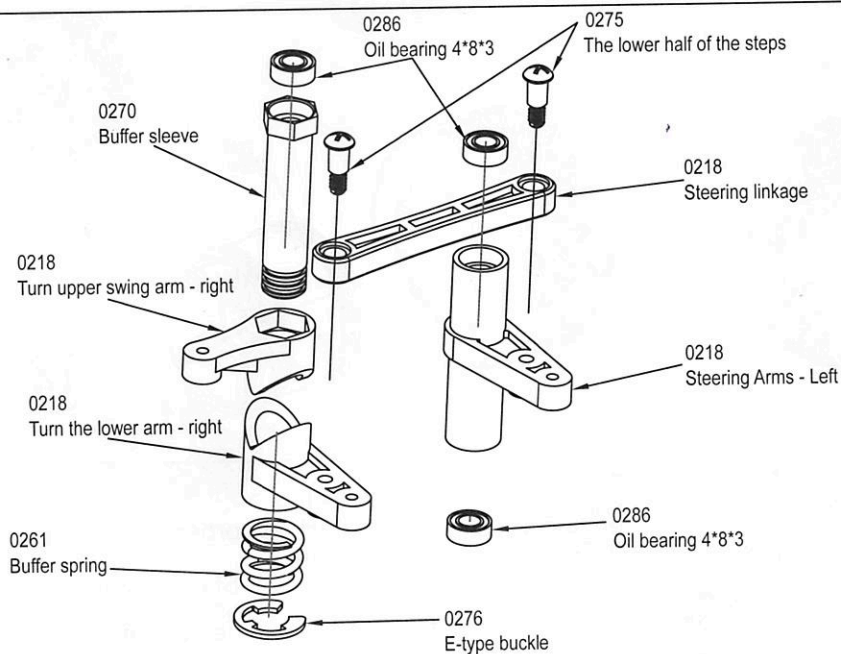

10

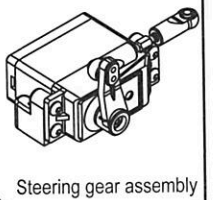
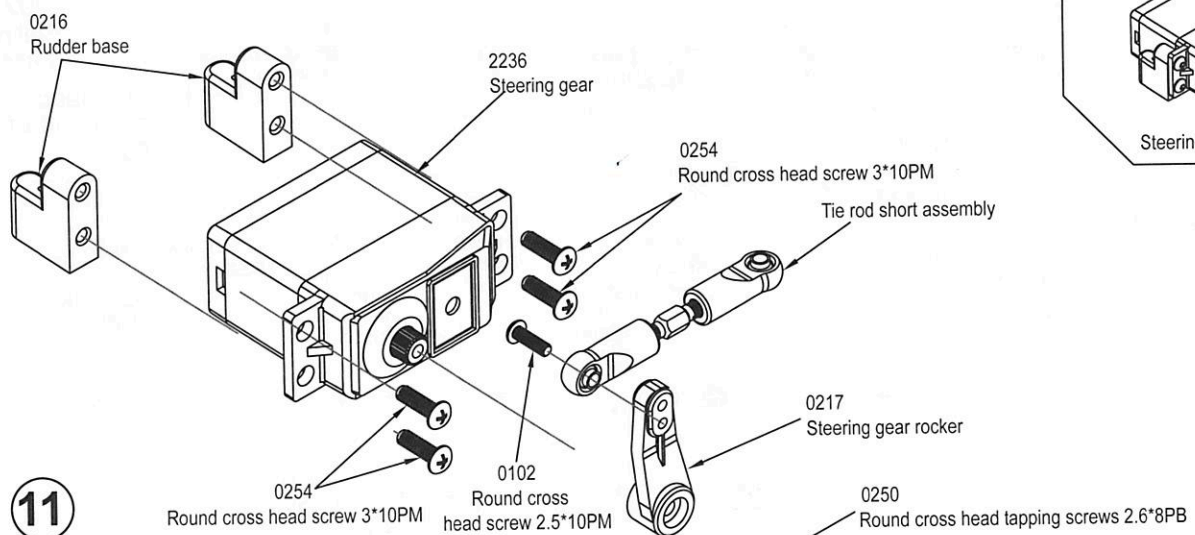

11

10

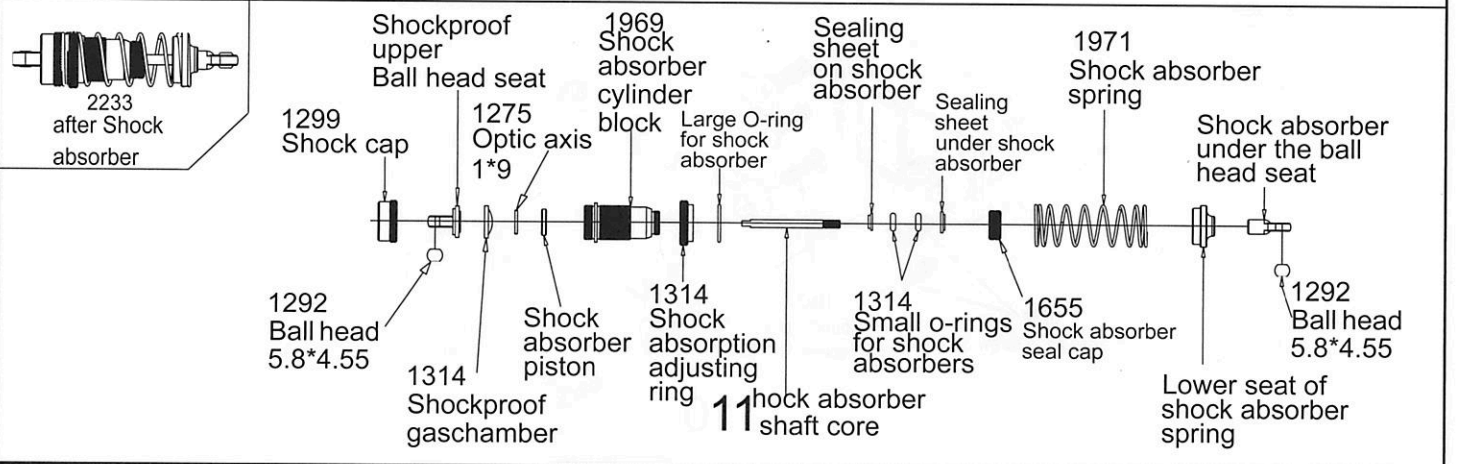
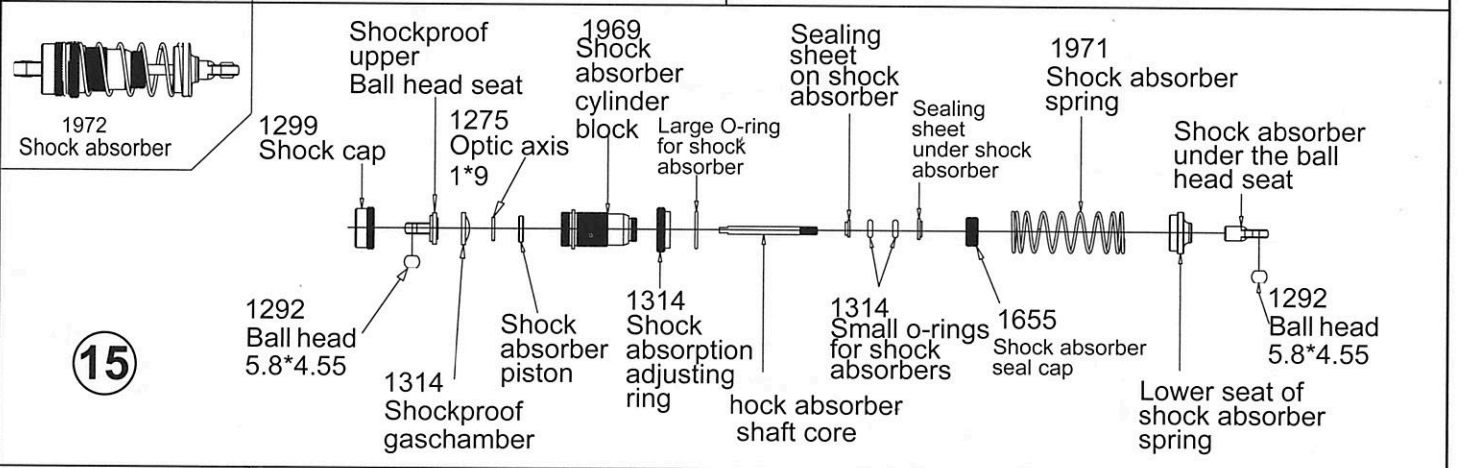
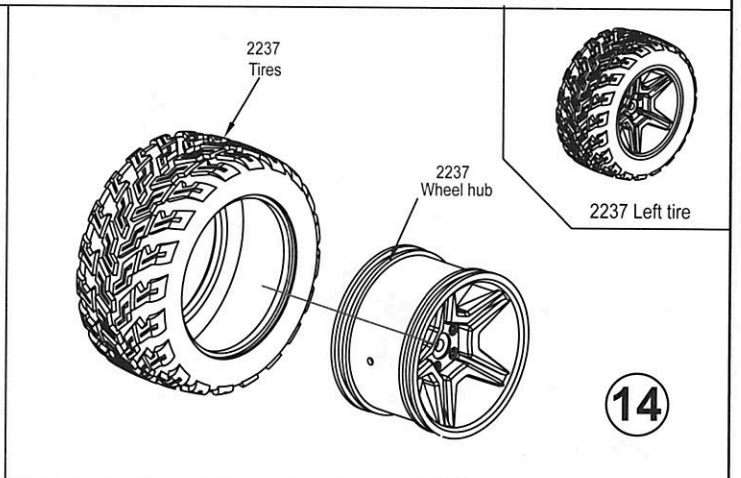
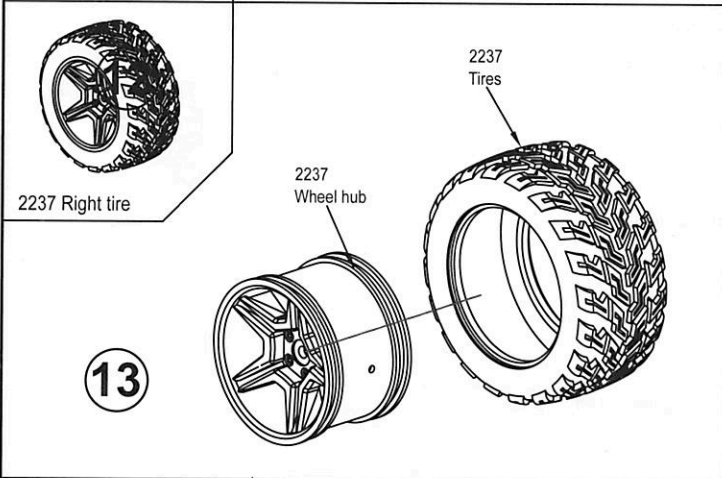
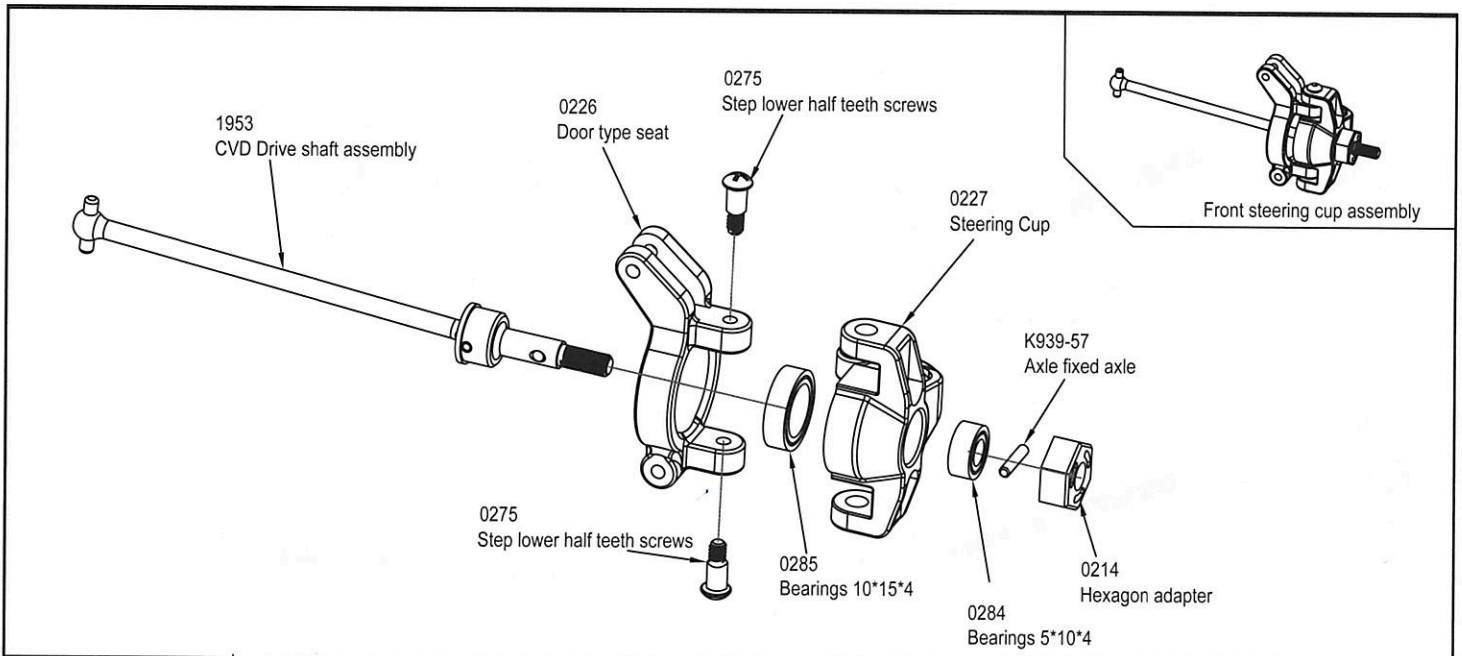

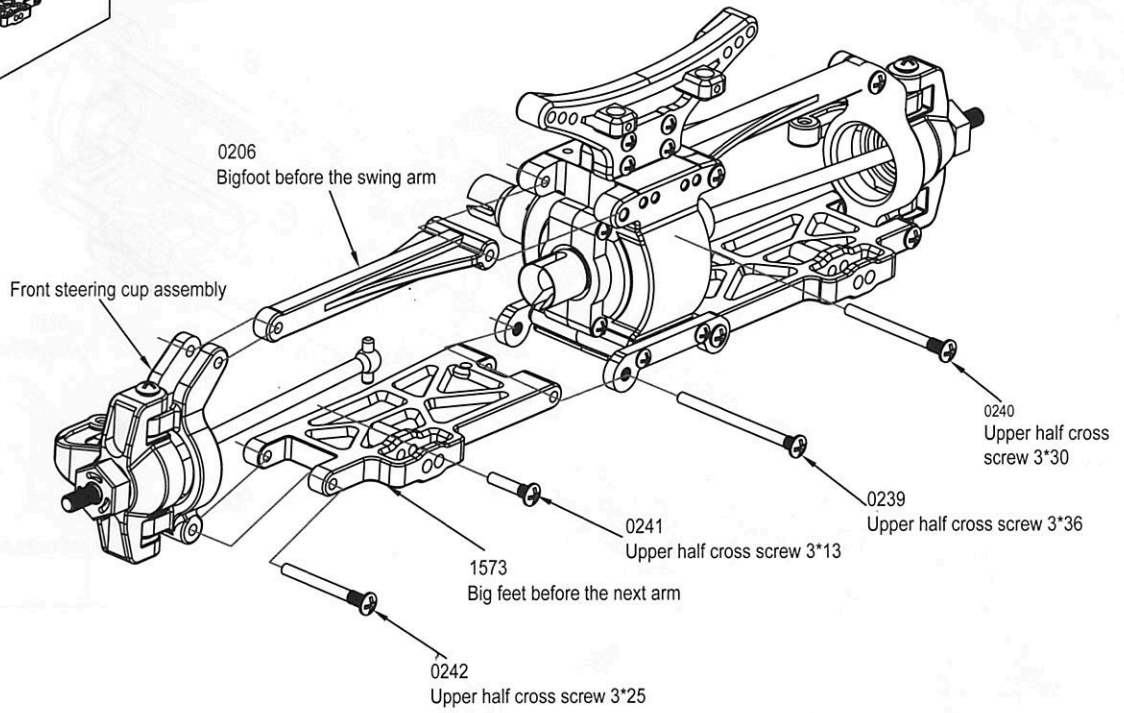
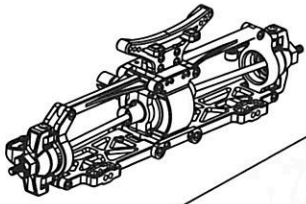

16

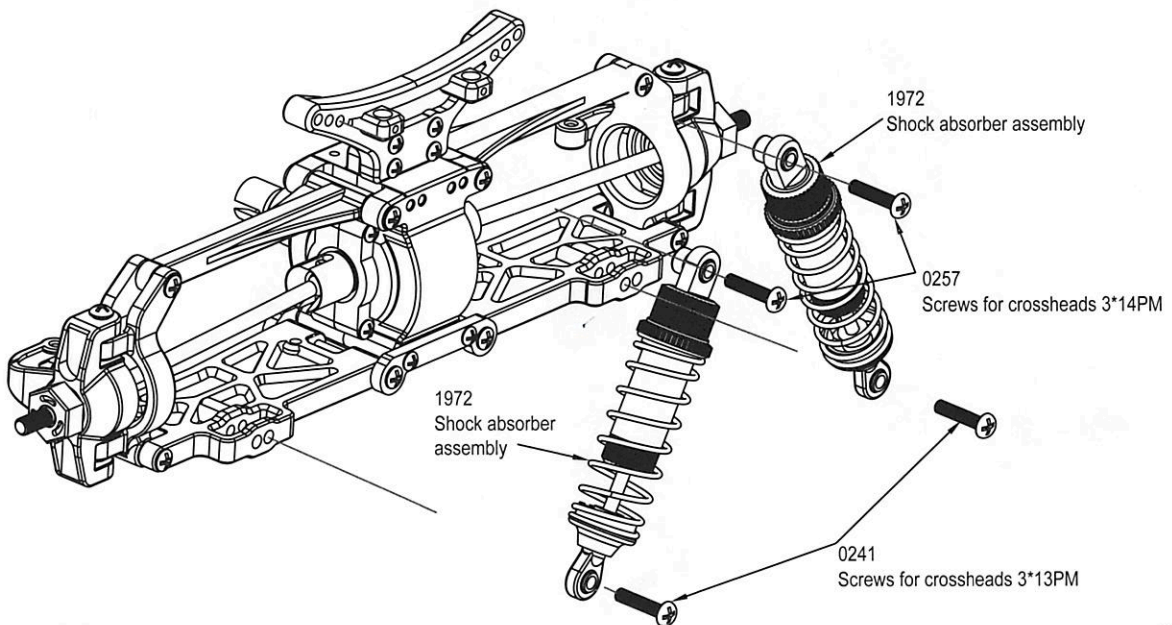
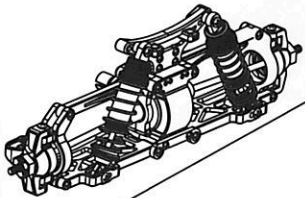

17

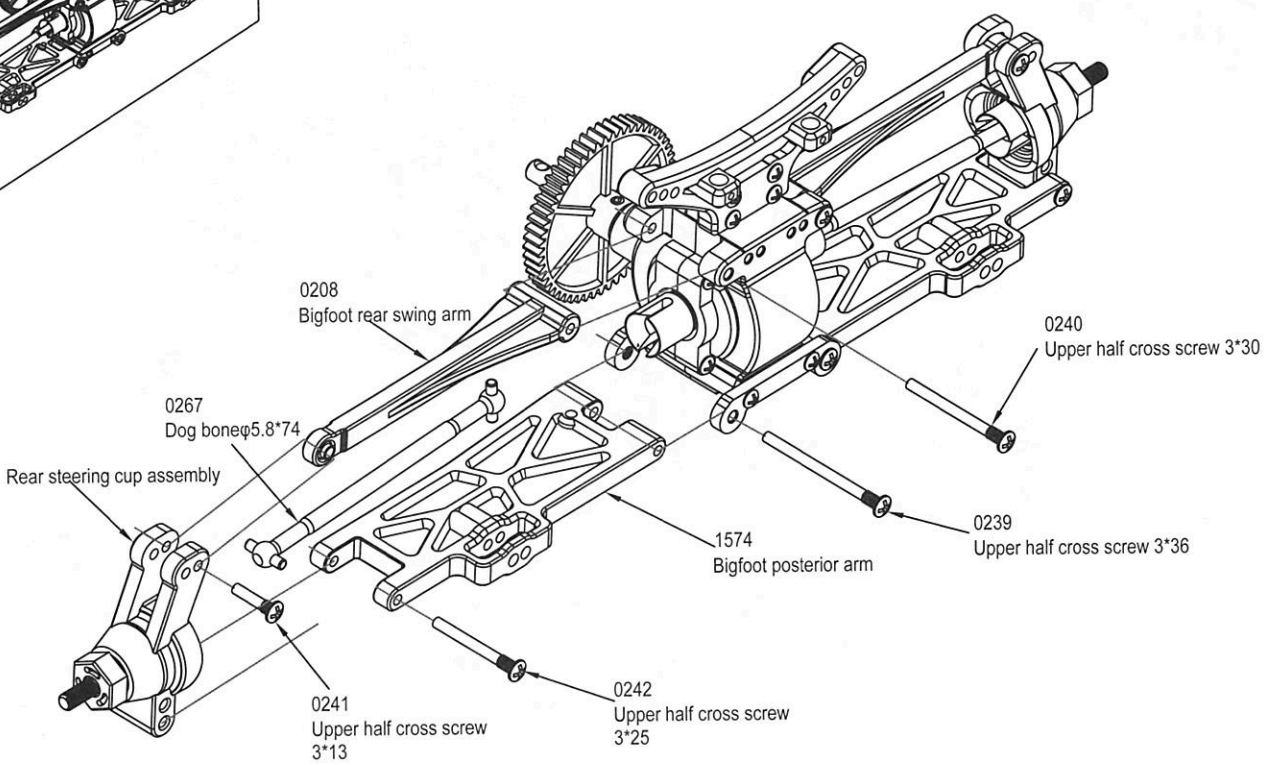
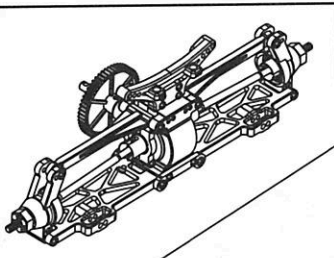

18

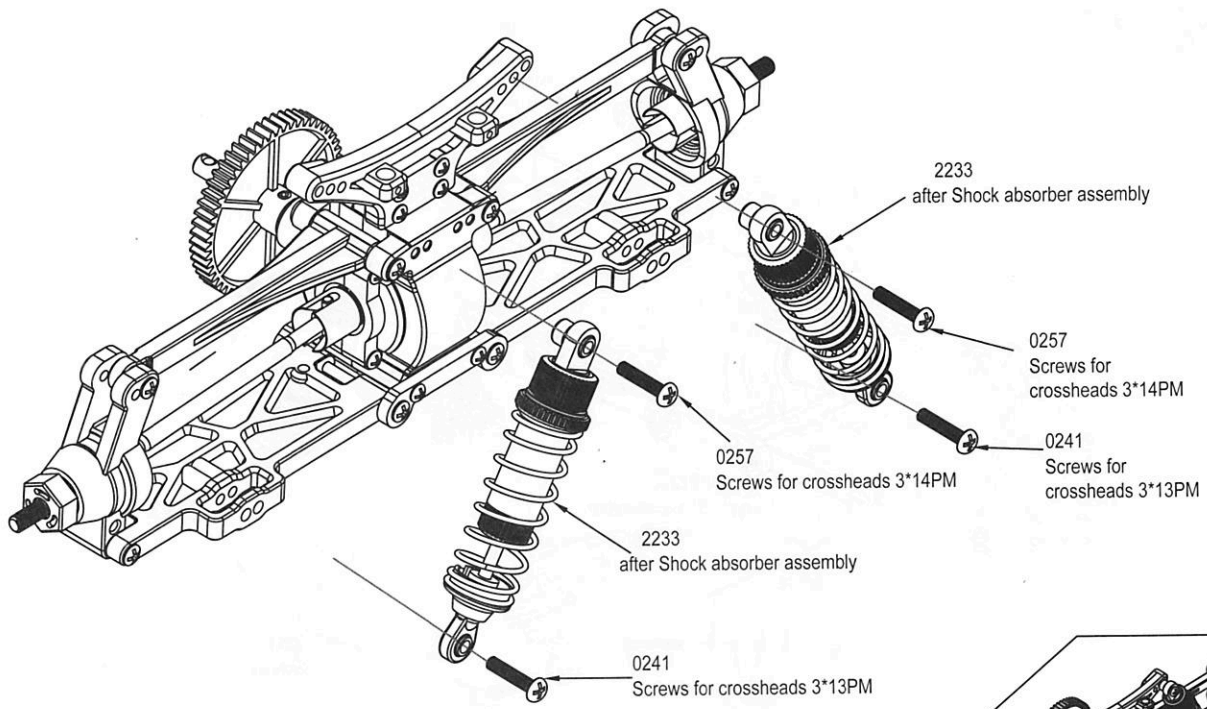

19

13

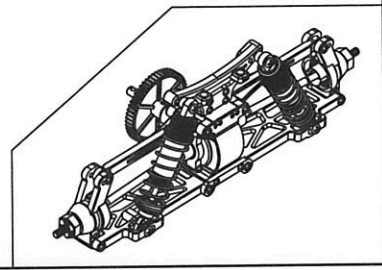

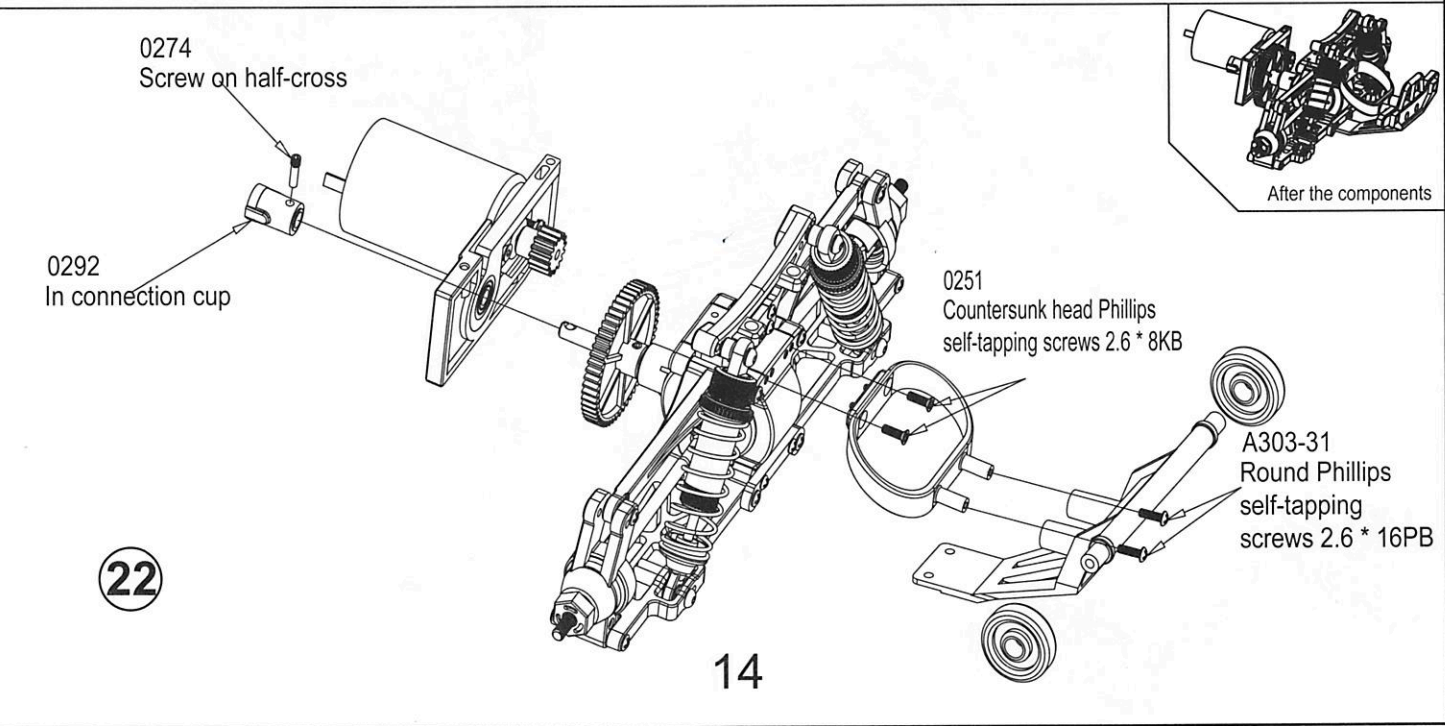
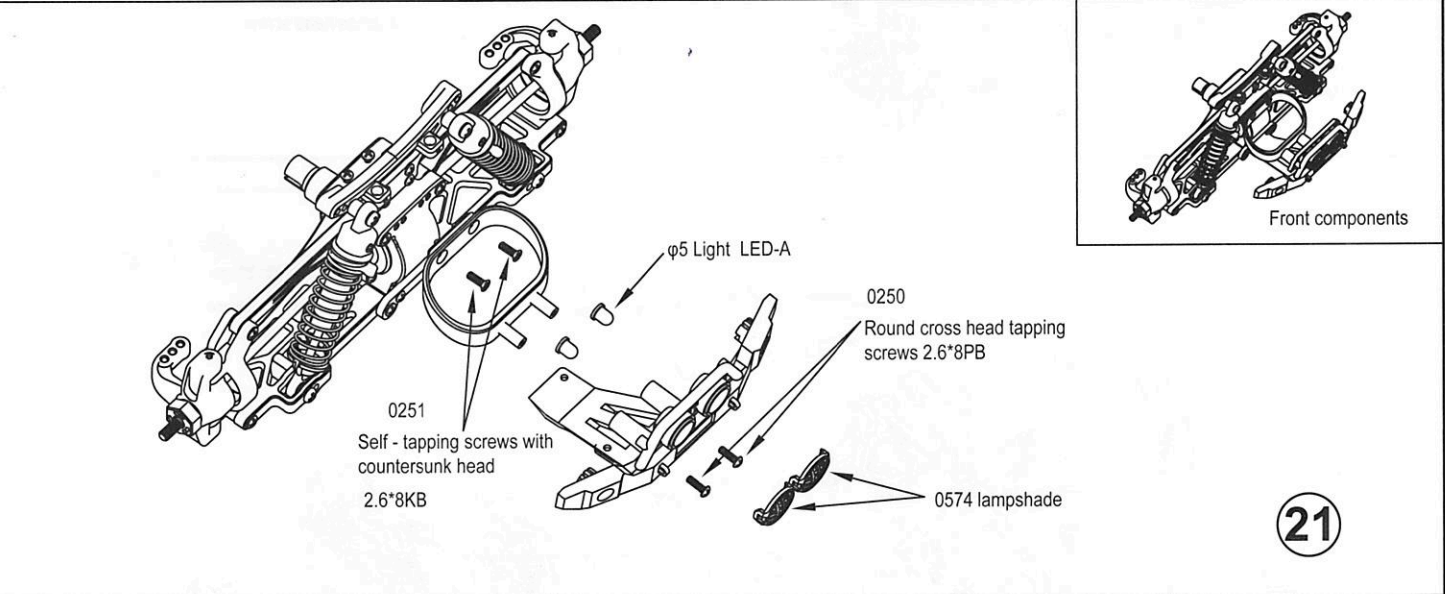
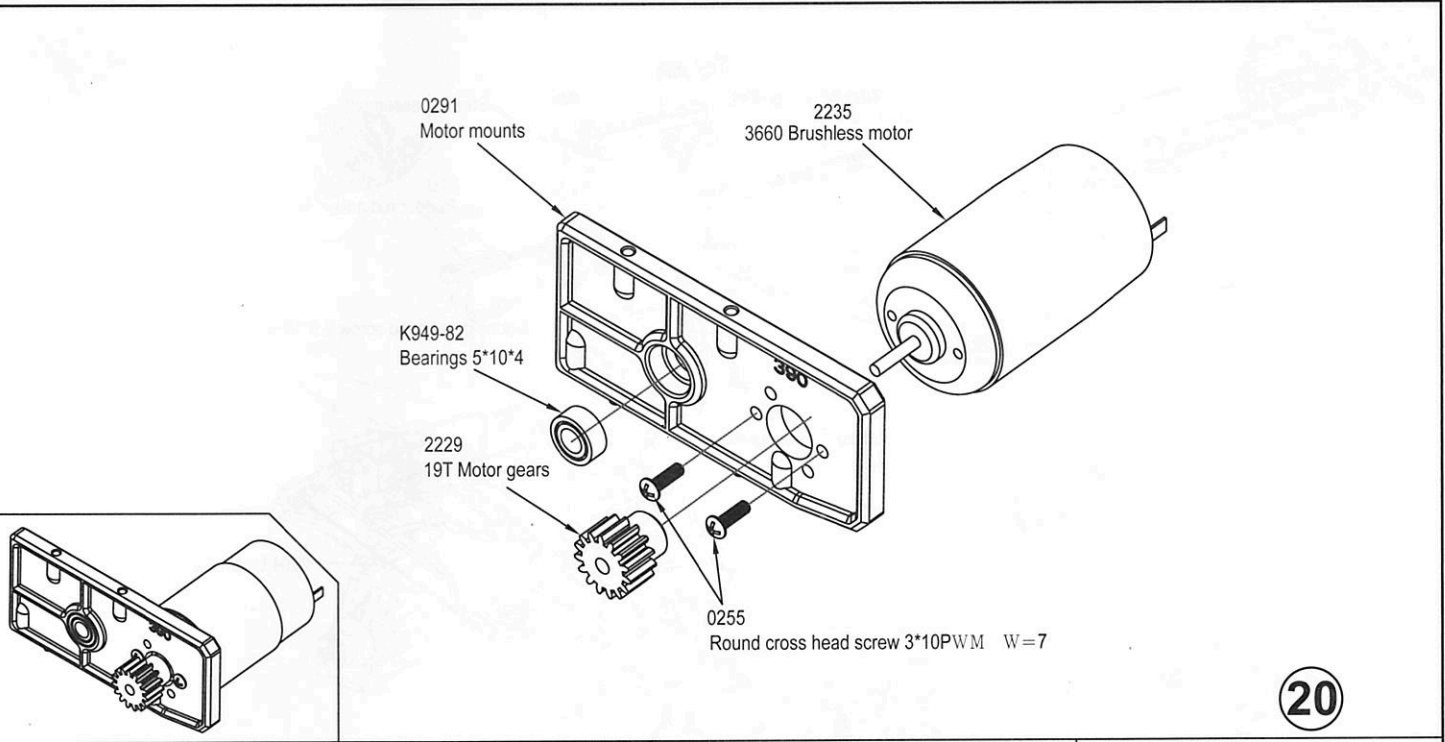

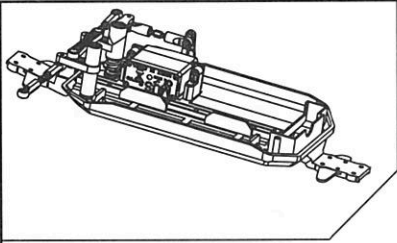

23

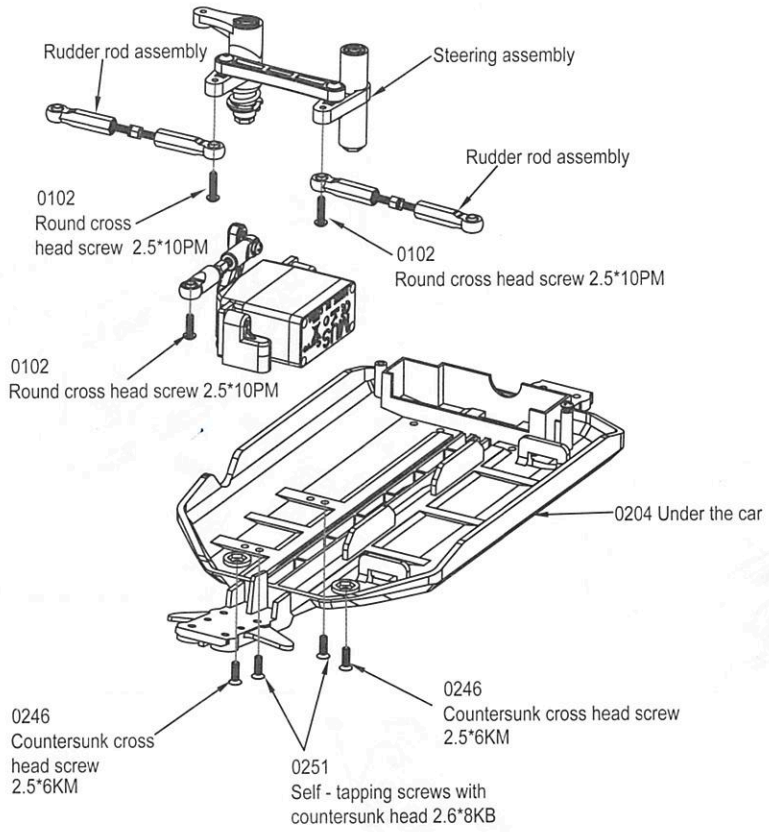

24

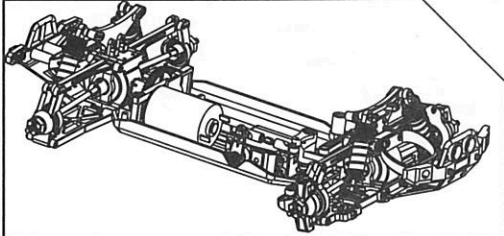
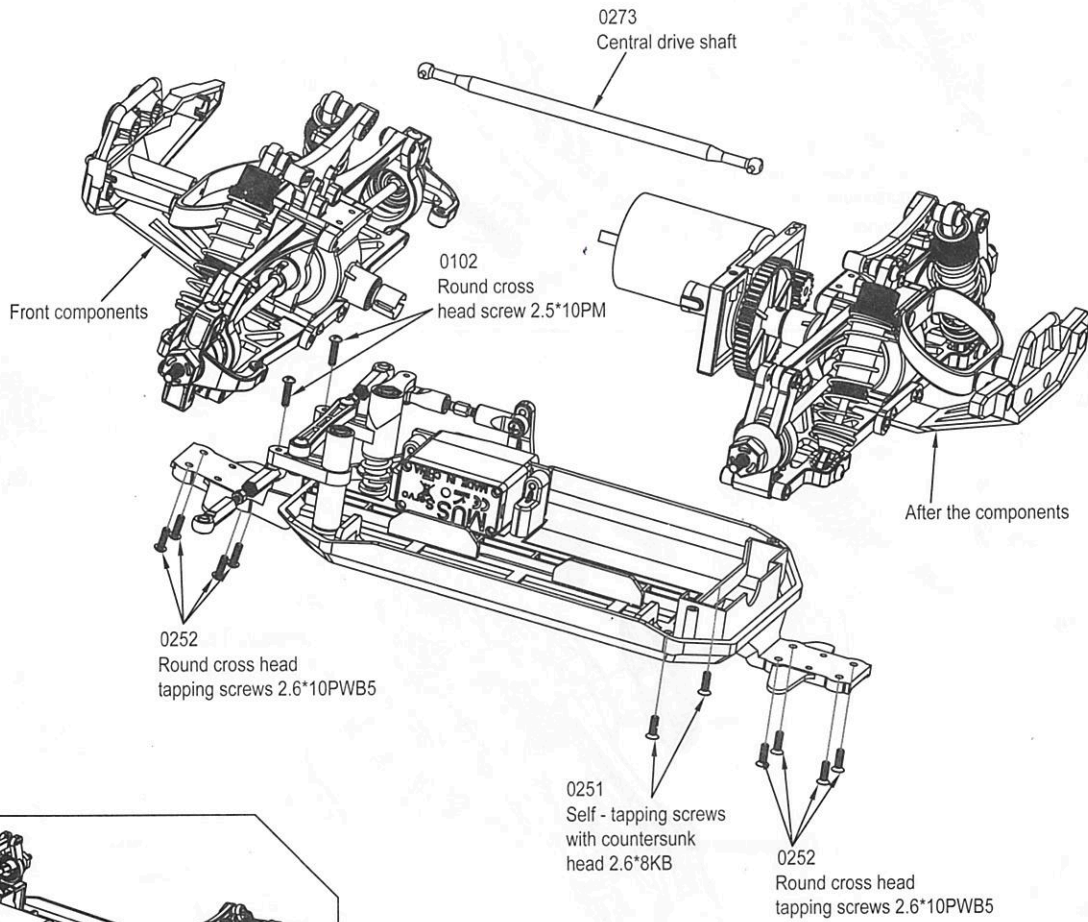

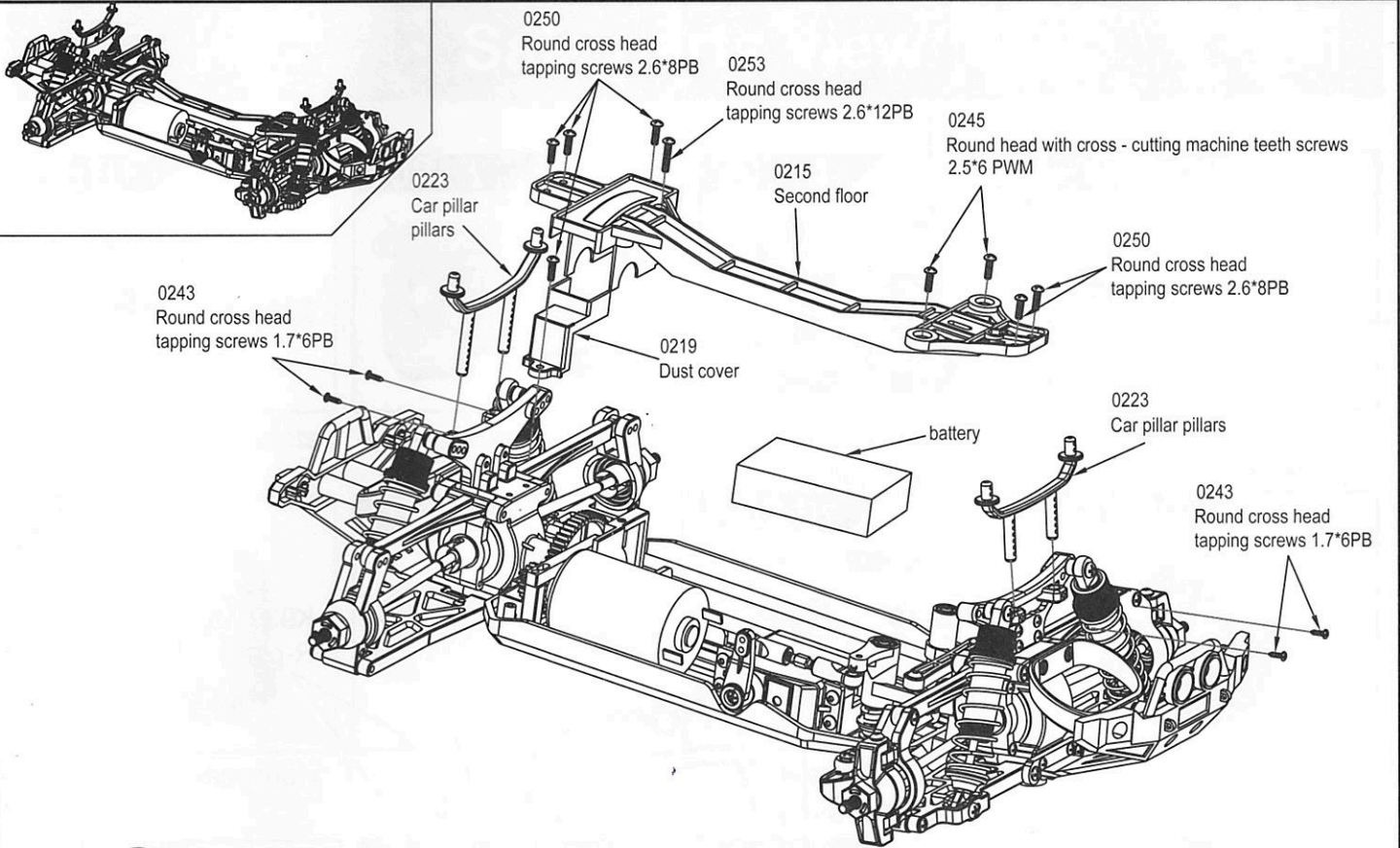

25

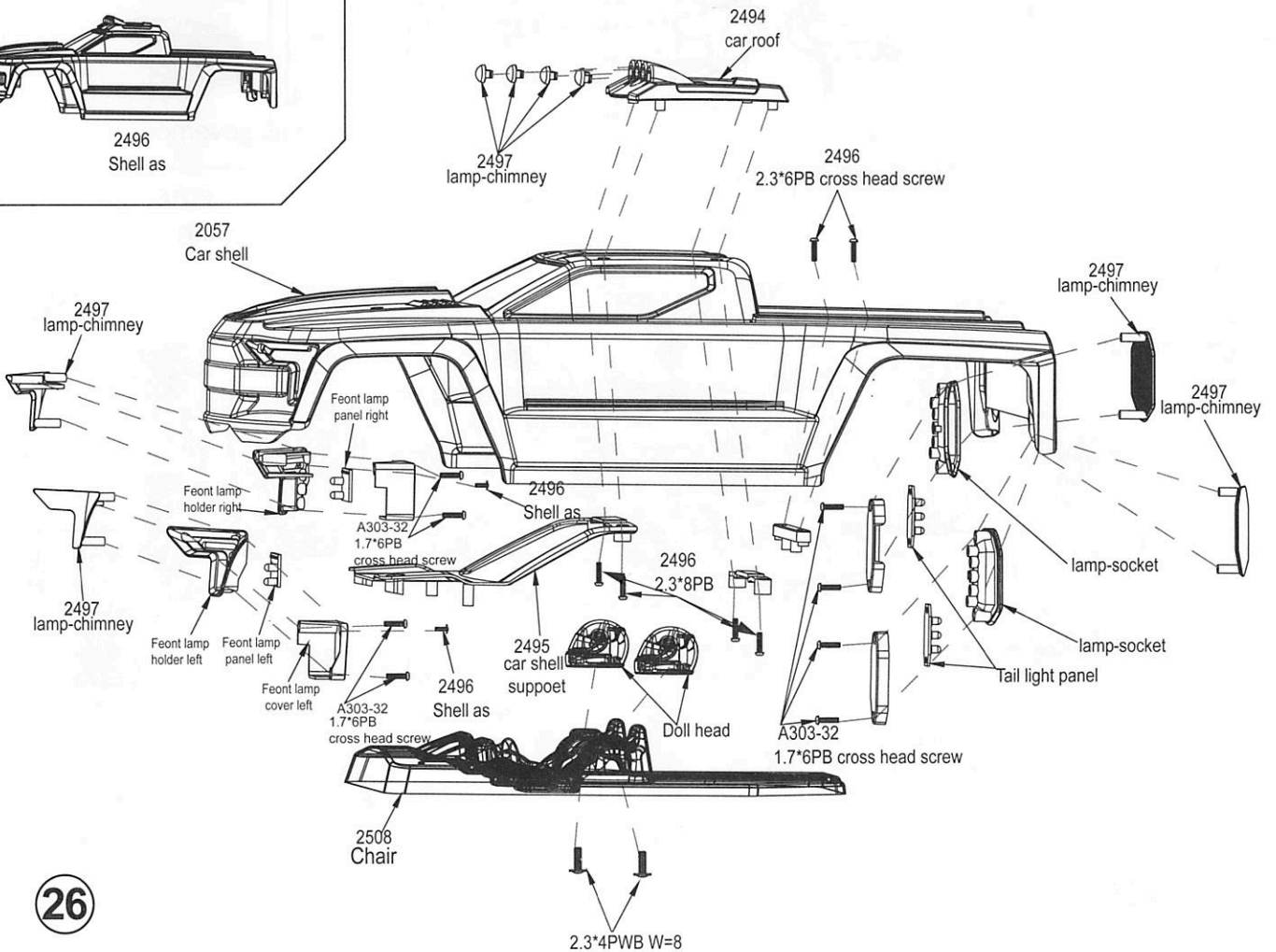
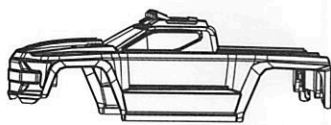

26

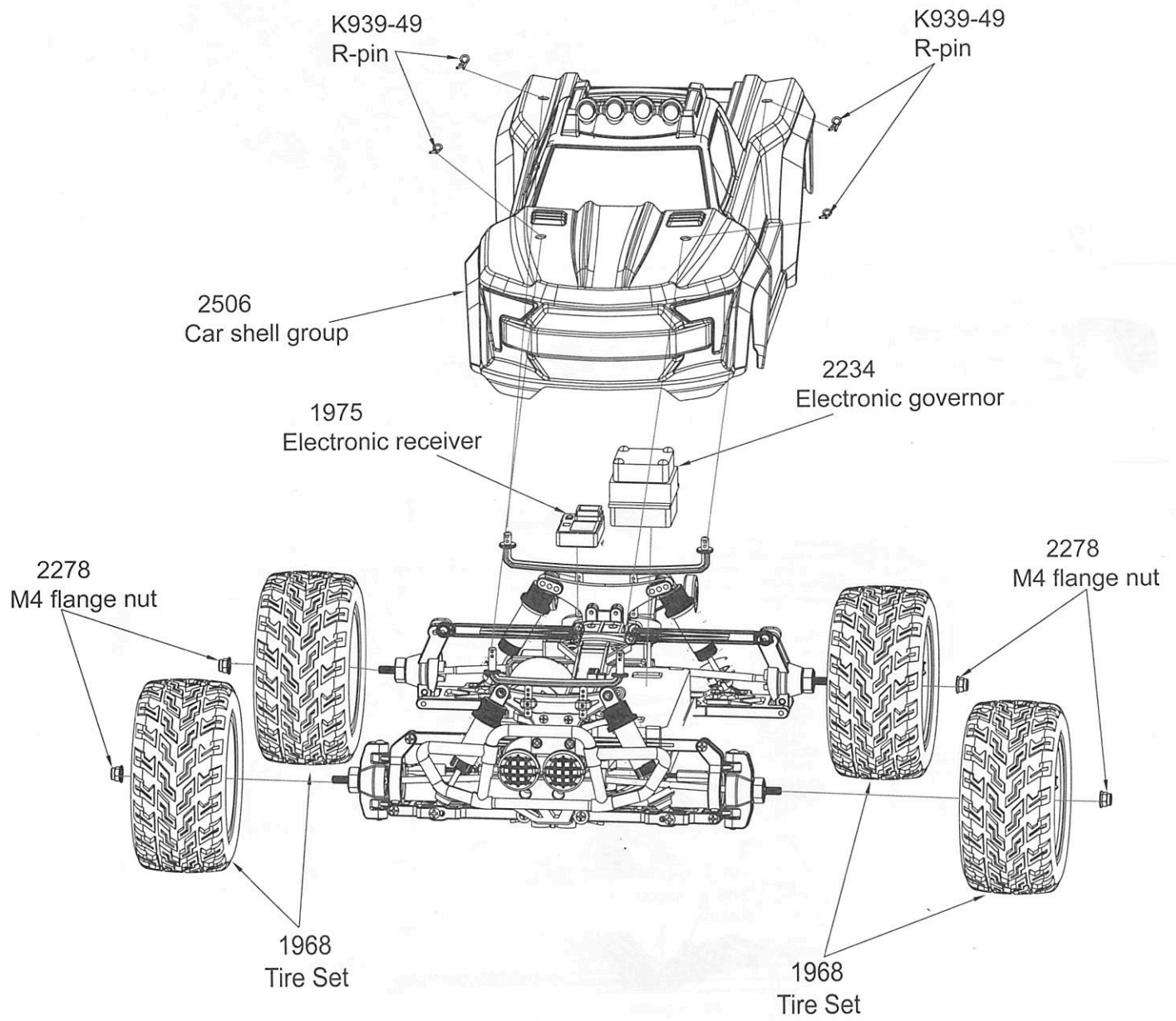
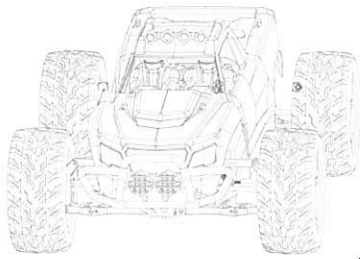

27

Sale parts view

1510

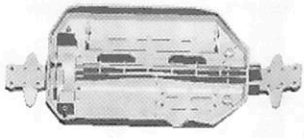

Vehicle components

0213

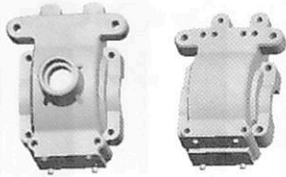

Gear cover assembly

0214



Hexagon adapter assembly

0215



Second floor components

0216



Rudder base assembly

0217

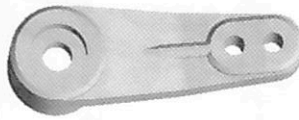

Rudder rocker arm assembly

0218

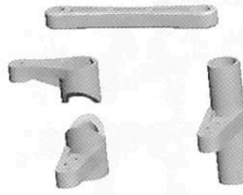

Steering linkage arm assembly

0219

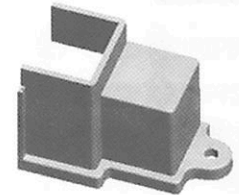

Dust cover assembly

2232

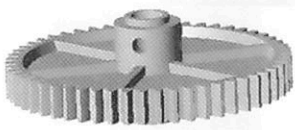

Deceleration large tooth components

0221



Shock absorber components

0222

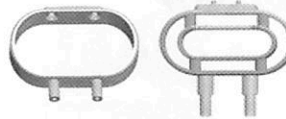

Anti-collision support components

1418



Shell pillar components

2277

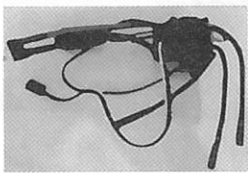

Receiver board assembly

2231



Differential component

0226



Door type seat assembly

0227



Steering cup assembly

0228



Rear wheel seat assembly

0233

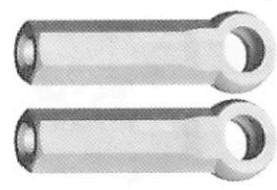

Ball cap - long components

2176

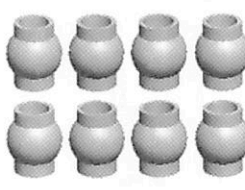

Ball head assembly

2247

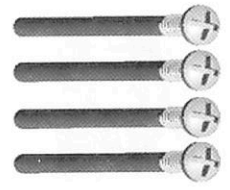

2.5*41.5 PMO Lower half screw

Sale parts view



A303-29
3 * 30 PM D5.5 Cross round head with half-plated carbon steel plated black zinc components

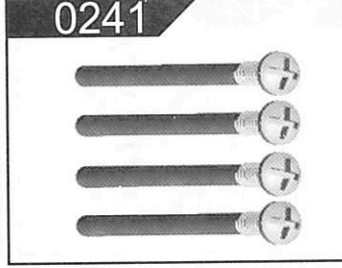

0241
3 * 13 PM screw assembly



0242
3 * 25 PM screw assembly



A303-32
Round cross self-tapping ST1.7 * 6 PB D3 black zinc plating components



0386
2 * 8KM screw assembly



A949-43
Round head with screws M2.5 * 6 * 6 group



0246
2.5 * 6 KM screw assembly



L959-57
Round head tapping screws 2.6 * 8 * 10 sets



L959-54
Self-tapping screws 2.6*8*10 countersunk head

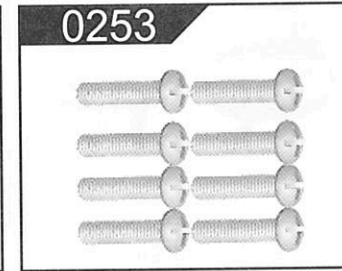

0253
ST 2.6 * 12 PB screw assembly



0254
ST 3 * 10 PB screw assembly



0255
3 * 10PWM7 screw assembly



0256
3 * 12 PM screw assembly

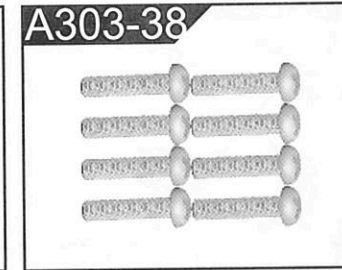

A303-38
3 * 14 PM D5.5 cross-head black zinc plated components

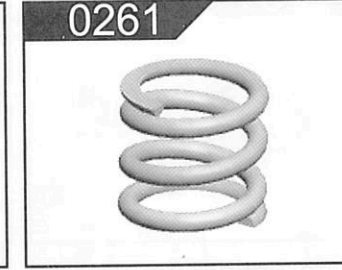

0261
Buffer spring assembly

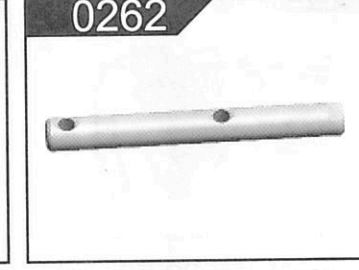

0262
Deceleration shaft $\phi 5 * 45\text{mm}$ components



0263
In the cup $\phi 10 * 25$ mm components



0264
Differential access cup $\phi 11 * 25\text{mm}$ components

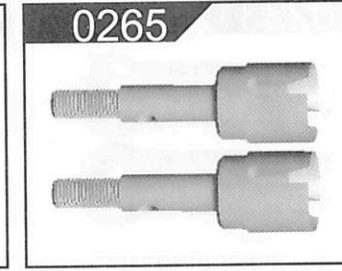

0265
Rear axle $\phi 11 * 36$ mm components

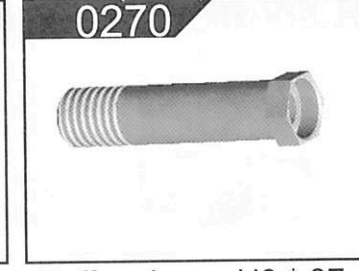

0270
Buffer sleeve H9 * 37 mm components

Sale parts view

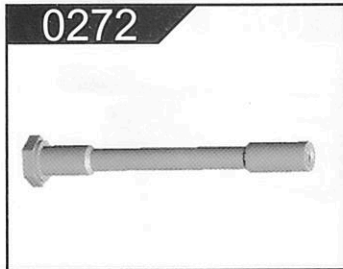

0272
Steering column H6 * 40
mm components

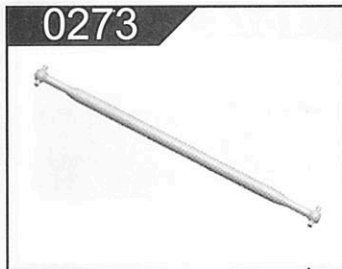

0273
Central drive shaft
φ5.8*135mm components



0274
3 * 10 PM screw
assembly



1016
3 * 11PM half-tooth
screw assembly



0276
E-type buckle
components

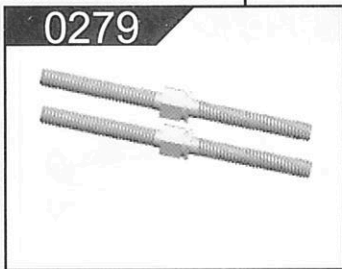

0279
Rudder rod assembly



0280
Tie rod assembly

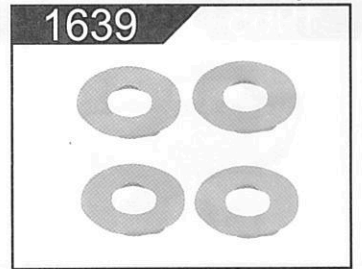

1639
8 * 5.1 * 0.5 Gasket

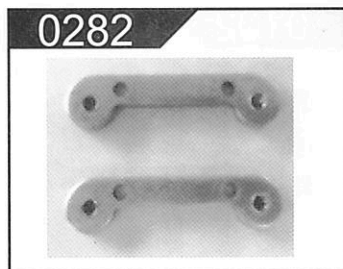

0282
Rear arm assembly

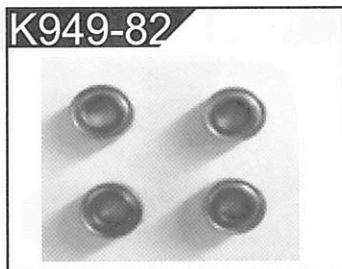

K949-82
Rolling bearings
5X10X4 group



0285
Ball bearing 10 * 15 * 4
groups



0286
Oil-bearing copper
sets of 4 * 8 * 3 groups

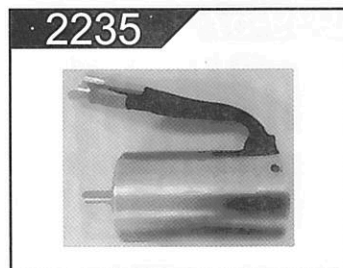

2235
3660 Brushless motor



0291
550 Motor Mount
Components



0292
Middle cup assembly



2227
Umbrella tooth



2228
Driving gear set



2229
19T motor tooth
components



0298
Green shell paper
components



0299
Optical axis 2 * 9
components

Sale parts view

1573



Bigfoot front lower arm assembly

0206

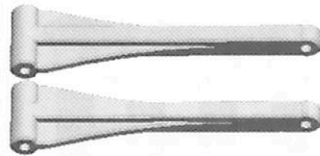

Bigfoot front swing arm assembly

1574



Bigfoot rear swing arm assembly

0208

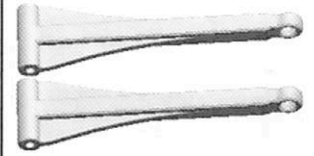

Bigfoot rear swing arm assembly

1965

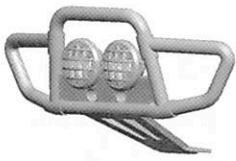

Front collision avoidance group

1419



Rear impact team

0267



Dog bone $\phi 5.8 \times 76\text{mm}$ components

1953



Long CVD Drive Shaft Assembly

2278

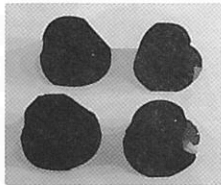

M4 locking nut group

1652

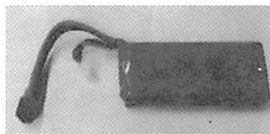

Battery 7.4V 2200MAH-18650 group

1374



USB Charger

0102



Phillips head screws 2.5 * 10 PM group

1968



Tire components

1972



Shock absorber assembly

K939-49

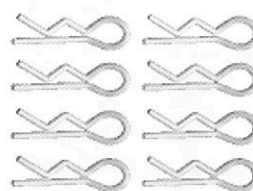

R-type pin 1.1 * 22.2MM group

K939-57

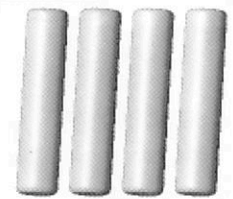

Axle fixed group

2236



6 kg 3-wire steering gear unit

k949-07



Front differential gearbox

K949-52



Planetary gear shaft group

K949-70

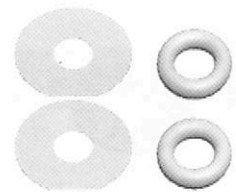

Differential O-Ring Flat Division

Sale parts view

2186



V8-104018
remote control

1511



Battery cover

1654



M3-Machine screw

1655



Shock sealing
cap group

1314

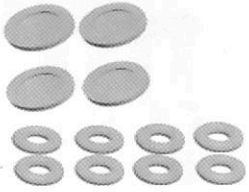

Shock absorber
O circle group

2496



Roof group

2495



Shell connector group

2497



Lampshade group

2506



Car shell group

1975

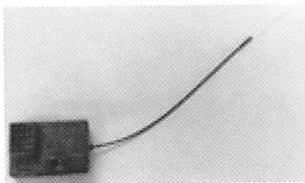

Electronic receiver

1969

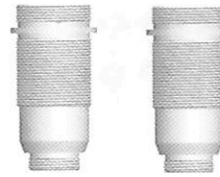

Shock absorber
cylinder block

1847

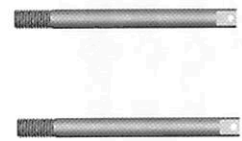

Axis group

1971

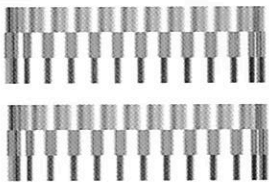

Shock absorber
spring set

0129



Cross pan head screw
2.3 * 8pwb w = 5 sets

1973



2.6 * 12pwb5 screw set

1974



2.3 * 4pwb8 screw set

2209

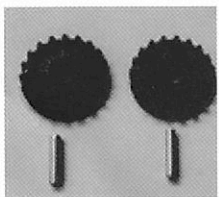

Differential gear set

2210

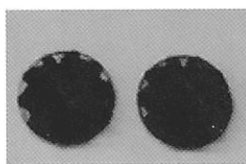

Asteroid tooth group

1989

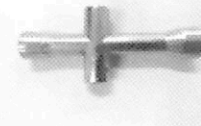

Zinc alloy
cross sleeve

0252

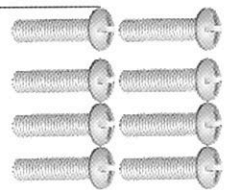

2.6 * 10pwb5 screw set

Sale parts view

2233



Rear shock absorber set

2219

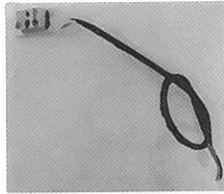

Car shell
adapter plate

2220

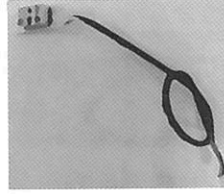

Underbody
adapter plate

A303-31

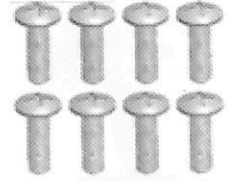

ST 2.6 * 16PB
Round head tapping screw

2498



Roof light panel

2507



PVC-Car shell

2508

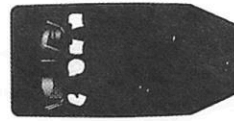

PVC-chair

0555



ST2.3 * 6PB cross
round head tapping screw

2505



ST2.3 * 8PB cross
round head tapping screw

0429



ST1.8 * 3PWB4
screw assembly